

SLIDING DOOR SYSTEM: ASSEMBLY & INSTALLATION

S150

Version 2.2 2015-11-23

4.02.3.c

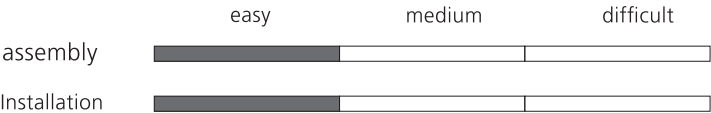

subject to technical changes



CONTENT

General infomation and tools_ page 03

Accessories_ page 04

Detail drawings_ page 05

Cutting dimension_ page 06

Assembly instruction_ page 08

Installation instruction_ page 09



Version Information:

Version 2: Cutting dimensions removed / only as chart in commerce portal available

Version 2.1: Frame screws 32mm / Manufacturer disclosure added

Version 2.2: handle half-round / no longer available

GENERAL INFORMATION AND TOOLS

GENERAL INFORMATION:

raumplus sliding door systems offer a wide range of variety and versatility. There are systems with and without bottom tracks, a great number of panel variations, doors for sloped ceilings and corner solutions or doors for special application purposes (lockable, application as room divider etc.).

These directions were created by people for people. We have made an effort to develop the instructions and pictures so that they are logical and easy to understand. If you should nevertheless find something to be unclear, please let us know so that we may revise that section.

Technical details are subject to change.

First of all, get a general idea about which raumplus series you would like to assemble.

Please make sure that you have received all items by checking the delivery sheet. Please also look out for possible transport damage. In case of any damage please contact your supplier immediately. The single components are numbered on the detail drawing as well as on the delivery sheet – please check.

REMARKS: First of all, please read our measurement instructions in order to find the correct measurements.

WERKZEUG:

- Aluminium saw
- Allen keys 4/5mm
- Drilling machine
- Drills set
- Rubber mallet
- Pencil
- water levels
- Adhesive tape
- Percussion drilling machine
- Plumb-line (optionally)
- Straight edge

ACCESSORIES

ACCESSORIES:

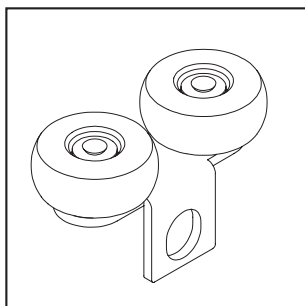

1_

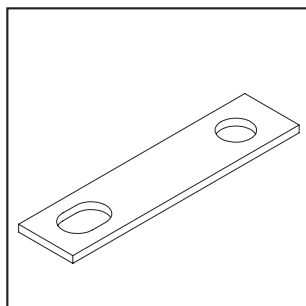

2_

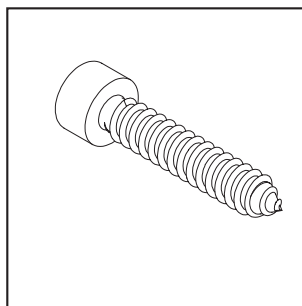

3_

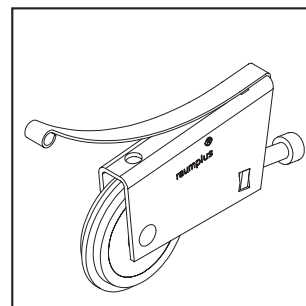

4_

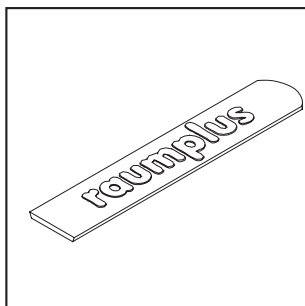

5_

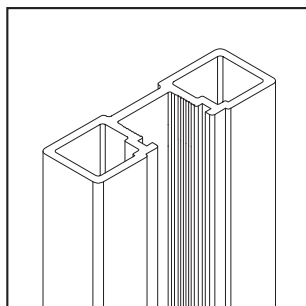

6_

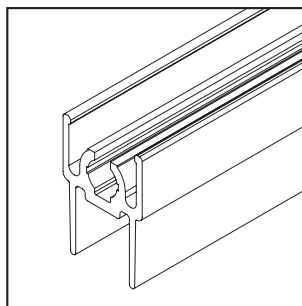

7_

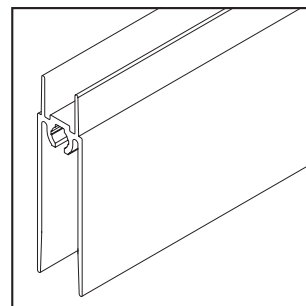

8_

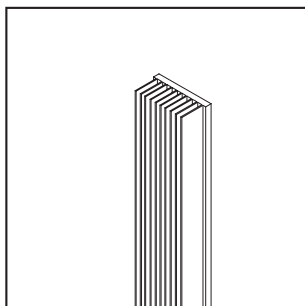

9_

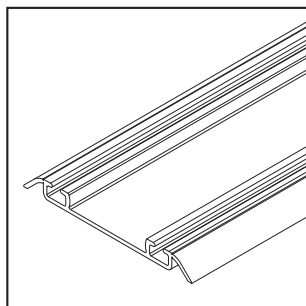

10_

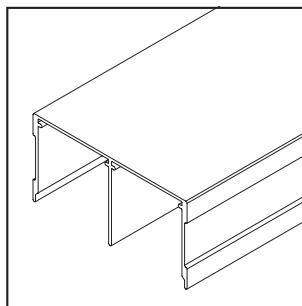

11_

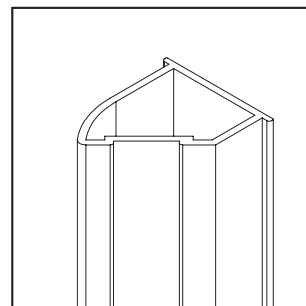

12_

1_ Top roller (item-no.: 10.01.016)

2_ Reinforcement for punching holes
(item-no.: 10.01.270)

3_ Frame screws 32mm (item-no.: 10.07.012)

4_ Bottom roller incl. antijump (item-no.: 10.01.120)

5_ Plugs for punching holes (item-no.: 10.07.05x)

6_ Vertical profile S150 (item-no.: 18.21.0xx)

7_ Top rail (item-no.: 15.12.0xx)

8_ Bottom rail (item-no.: 15.04.0xx)

9_ Dust excl. brush grey (item-no.: 10.07.020)

10_ Bottom track doub. (item-no.: 15.05.0xx)

11_ Top track double S34 (item-no.: 15.25.0xx)

12_ Corner profile (item-no.: 14.07.0xx)

13_ Corner stop f.double top track
(item-no.: 10.08.28x) (w/o illustr.)

14_ Double side tape for corner
(item-no.: 25.12.046) (w/o illustr.)

15_ Punching machine (Artikel-Nr.: 30.11.037)

EXPLODED DRAWING

SLIDING DOOR S 150

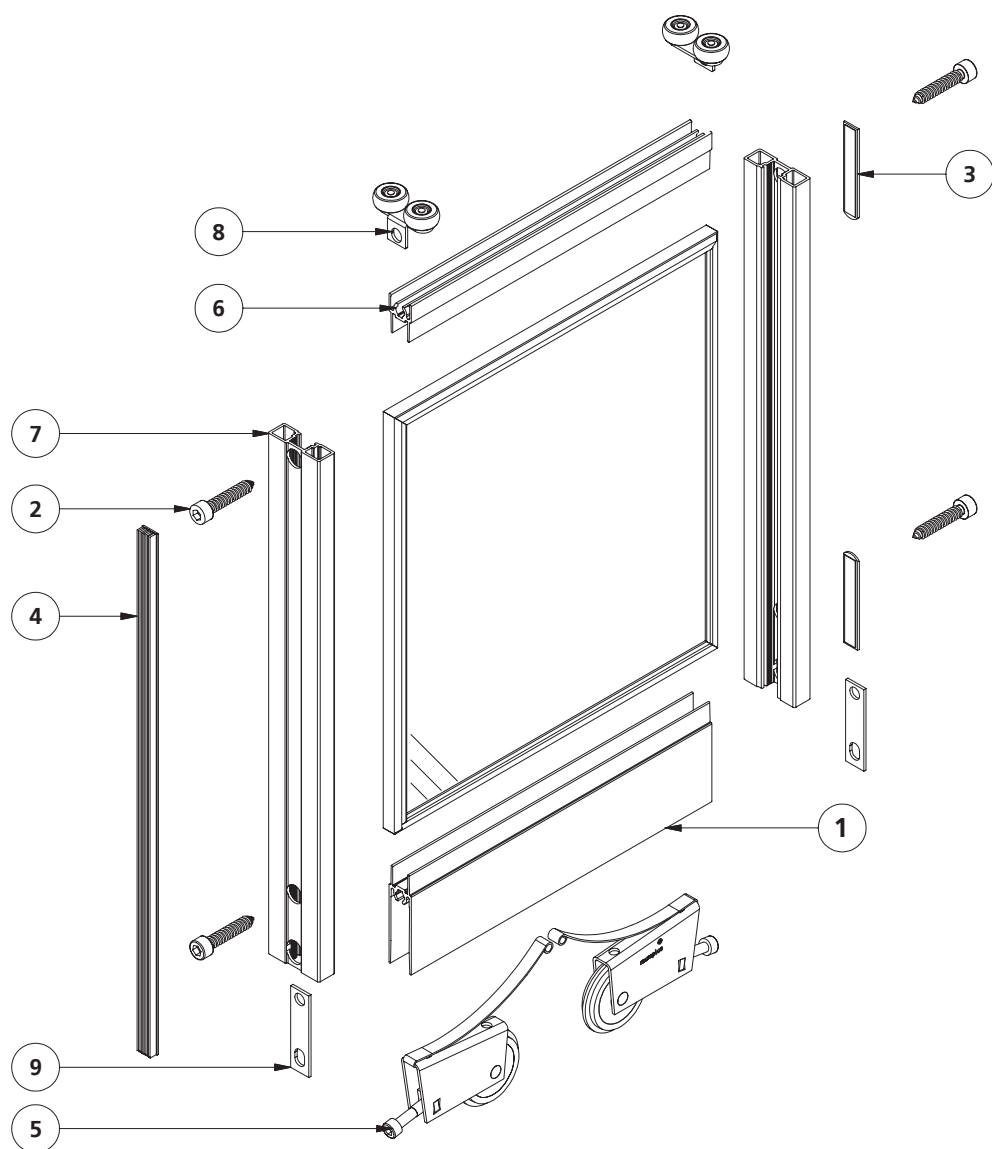

item list			
Object	Quantity	Description	Item number
1	1	Bottom rail	15.04.0xx
2	4	Frame screws 32mm	10.07.012
3	2	Plugs for punching holes	10.07.051
4	1	Dust excl. brush grey 2,6m	10.07.023
5	2	Bottom roller incl. antijump	10.01.120
6	1	Top rail	15.12.0xx
7	2	Vertical profile S150	18.21.0xx
8	2	Top roller	10.01.016
9	2	Reinforcement for punching holes	10.01.270

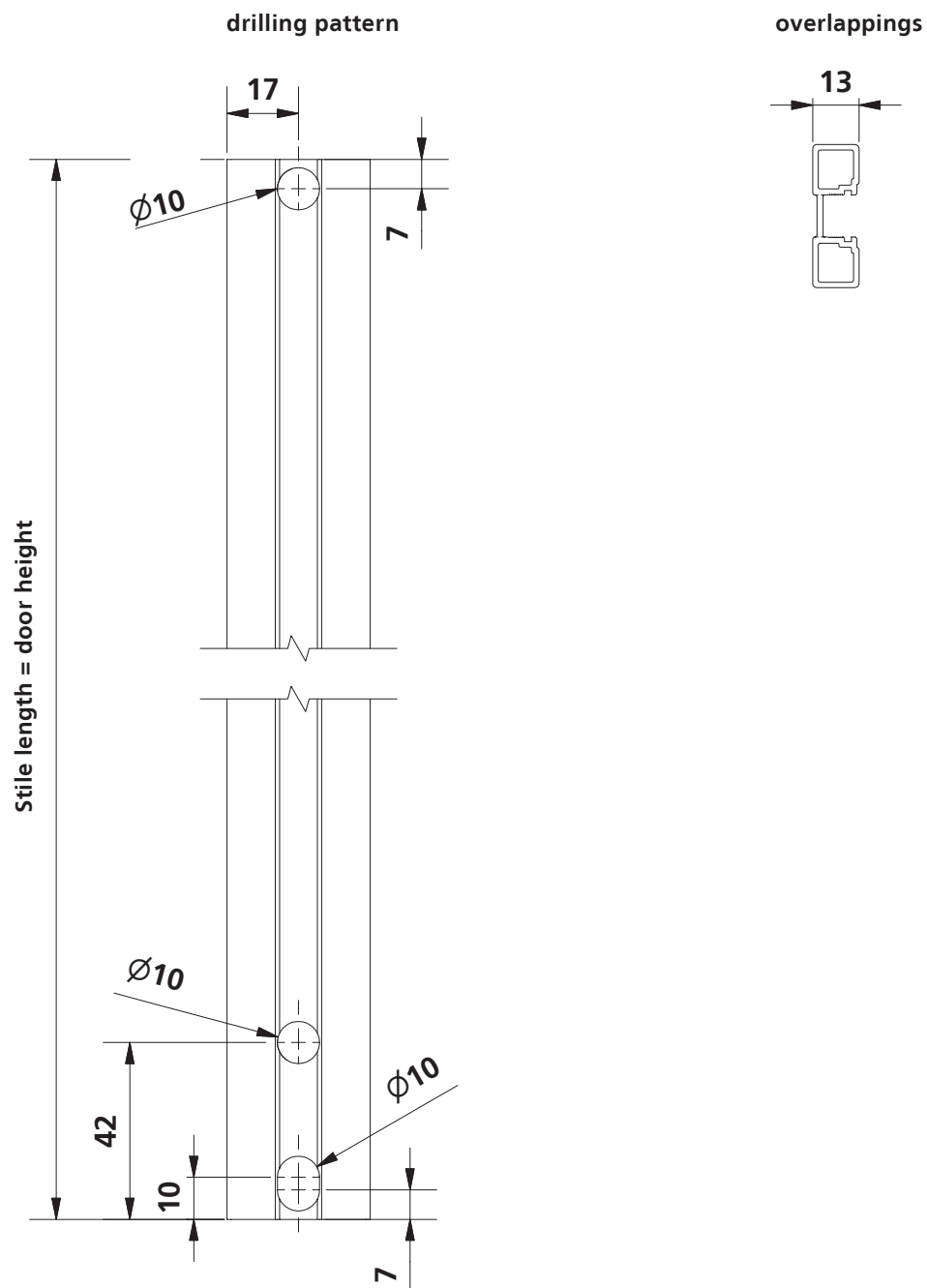

Cutting dimensions:
 stile length = opening height - 45mm
 min. / max. door height = 700mm / 2700mm

top rail
15.12.0xx

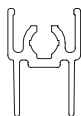

top / bottom rail length = door width - 25 mm

bottom rail
15.04.0xx

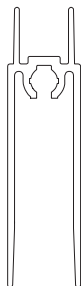

top / bottom rail length = door width - 25 mm



For double track systems
please consider the
overlapping.

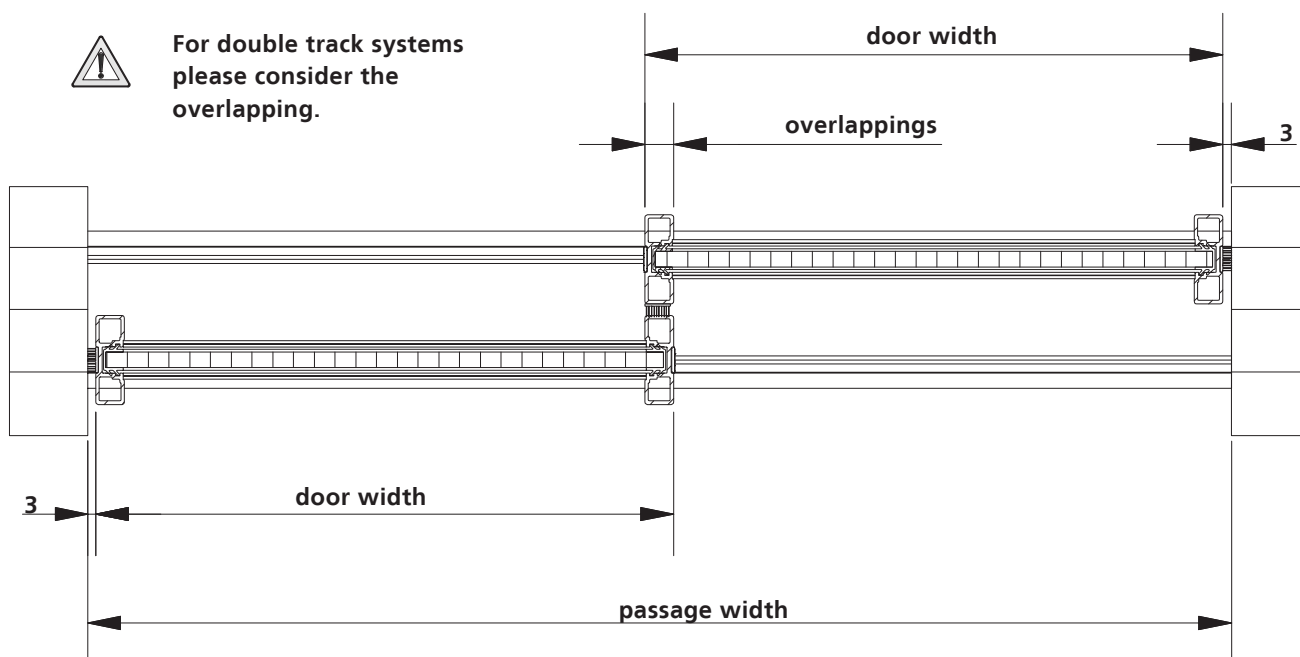

Cutting dimensions:

rail length = door width - 25 mm

min. / max. door width = 500mm / 1200mm

max. element weight = 60kg

ASSEMBLY INSTRUCTION



Gasket is only necessary for panels with less than 10mm thickness!

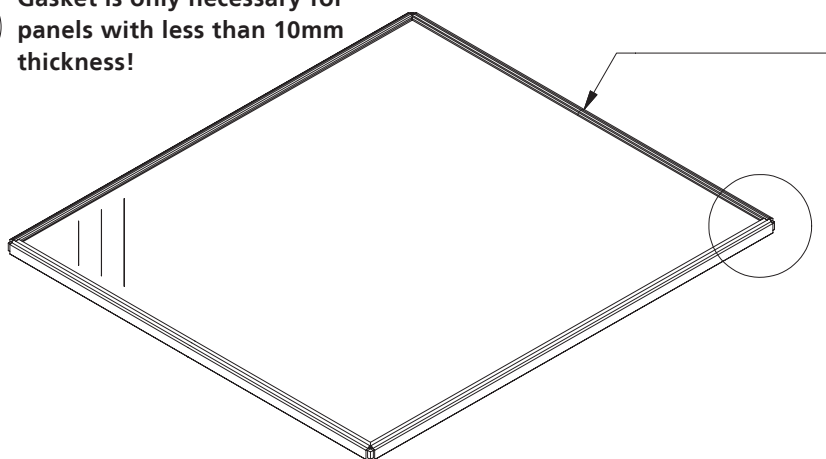

1_ Place panel on a table, affix gasket (only for panels with less than 10mm thickness)

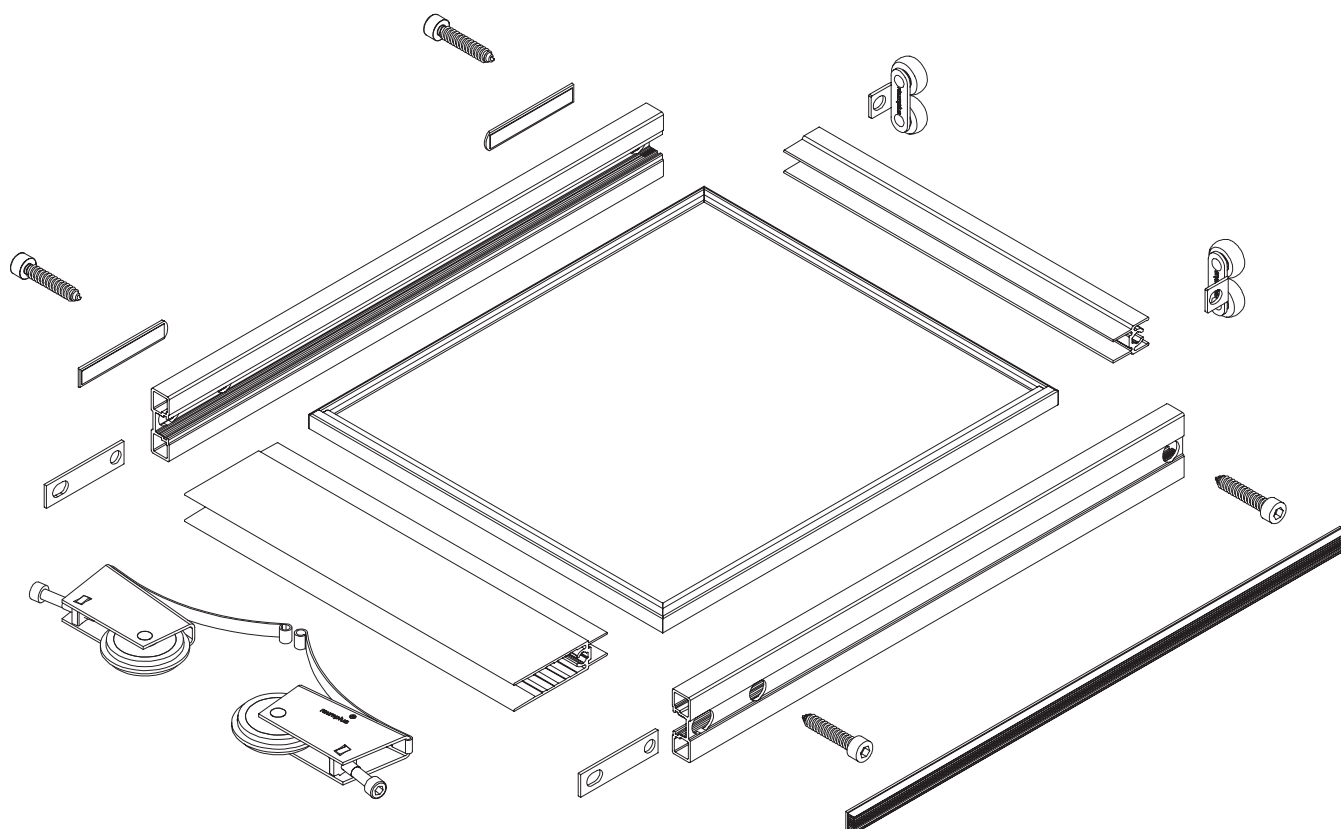

2_ Use rubber mallet to apply stiles (hit carefully) , screw together (max. 3Nm) then check by using a straight edge

ASSEMBLY INSTRUCTION

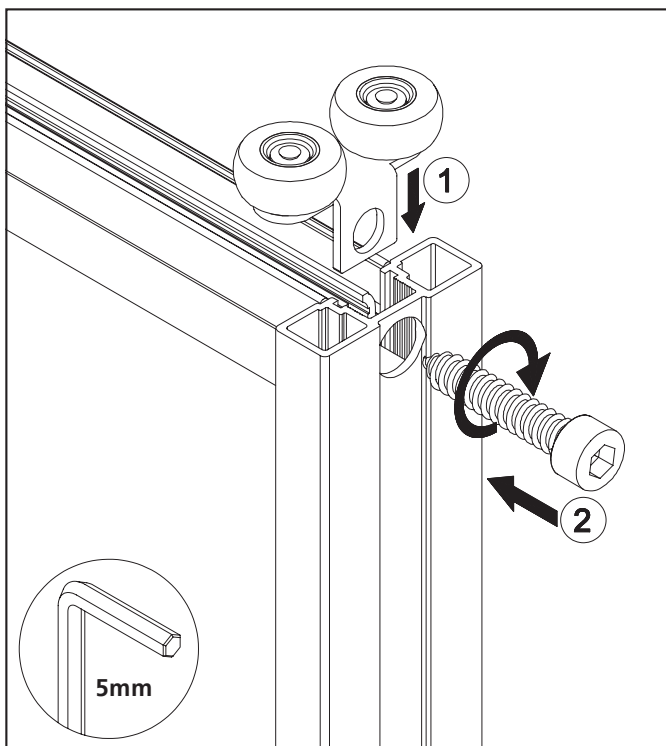

3_ Assemble the top roller (max. 3Nm)

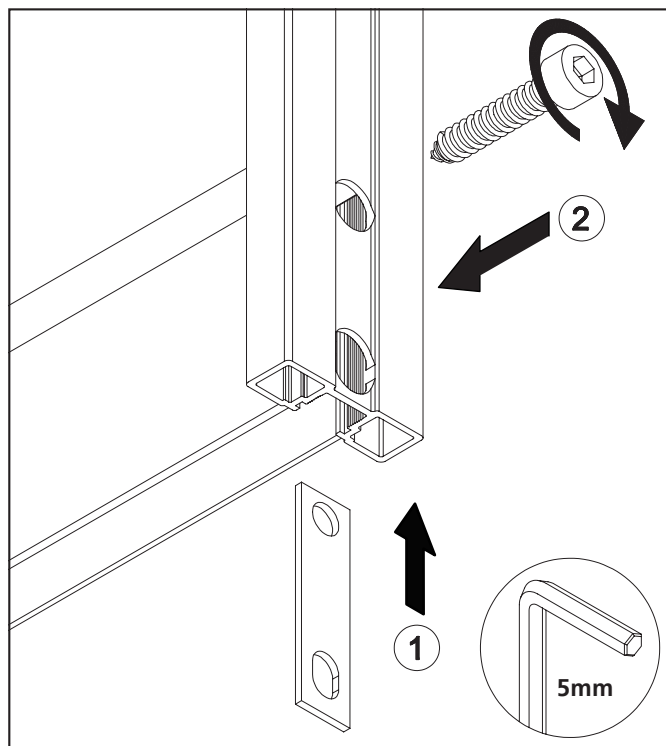

4_ Install the reinforcement for punching holes (max. 3Nm)

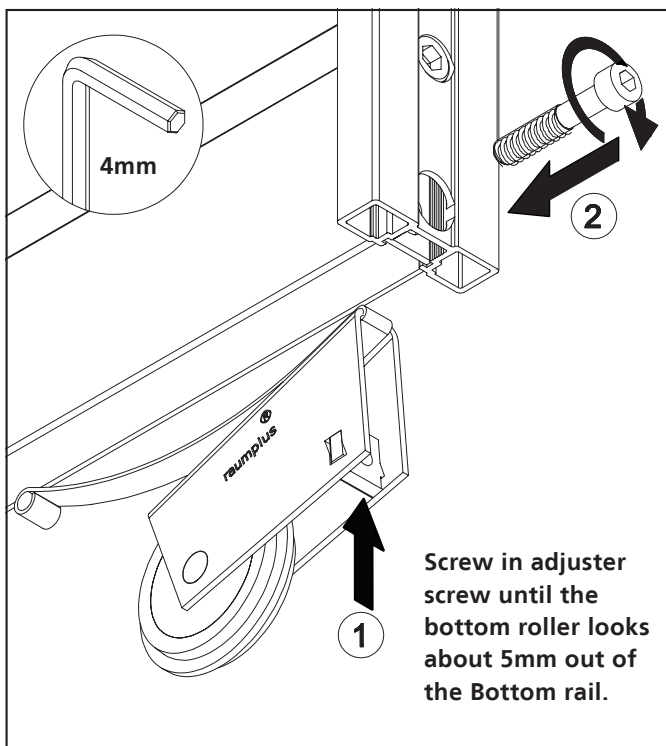

5_ Assembly the Bottom roller

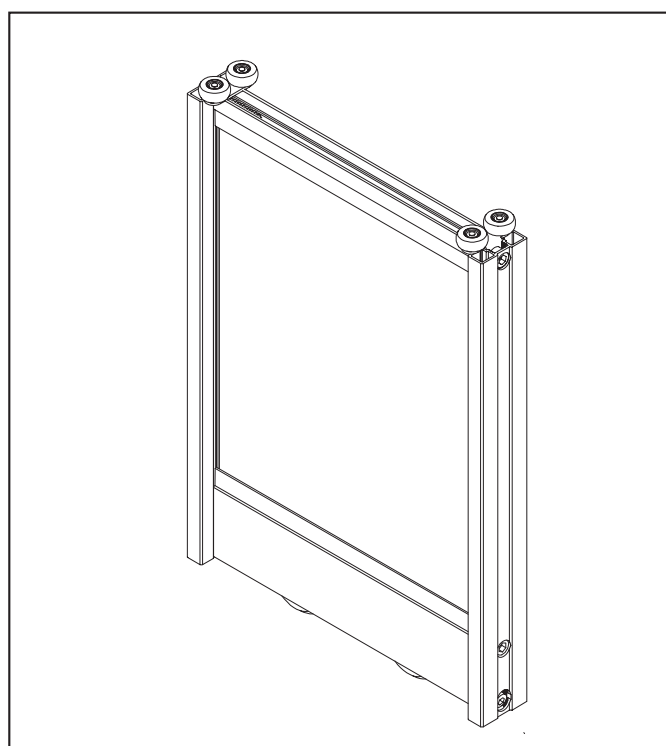

6_ Sliding door series 150

INSTALLATION INSTRUCTION

PREPARE / MOUNT TOP TRACK

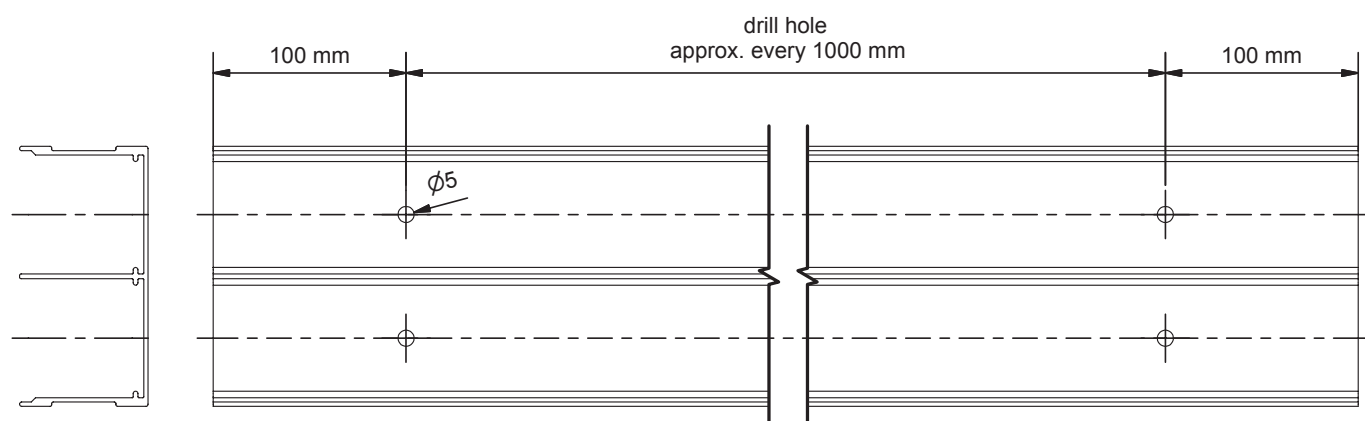

If using a wall connection double track, this has to be mounted first according to separate assembly instructions: 064c_wall connection double track S34 and S42

1_ Shorten top track to final dimension and drill holes

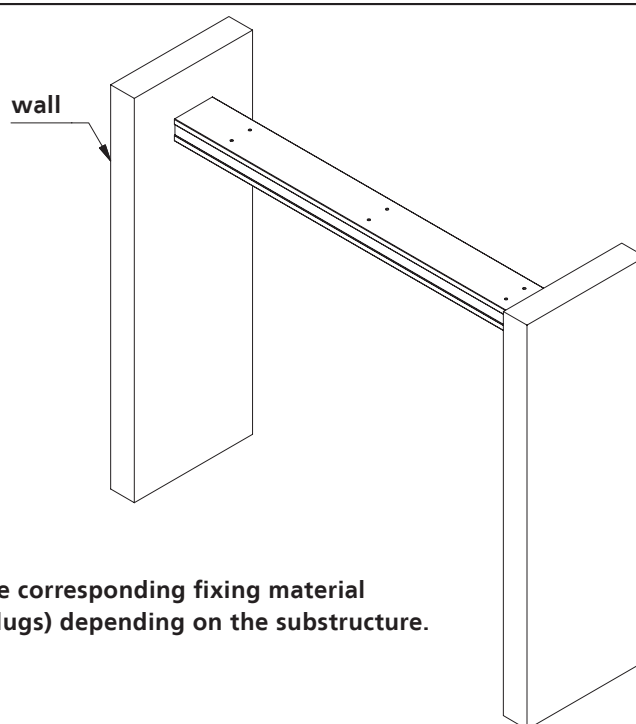

Choose the corresponding fixing material (screws, plugs) depending on the substructure.

2_ Drill holes and mount top track (fig.: without ceiling)

INSTALLATION INSTRUCTION

SHORTEN BOTTOM TRACK / MARK POSITION

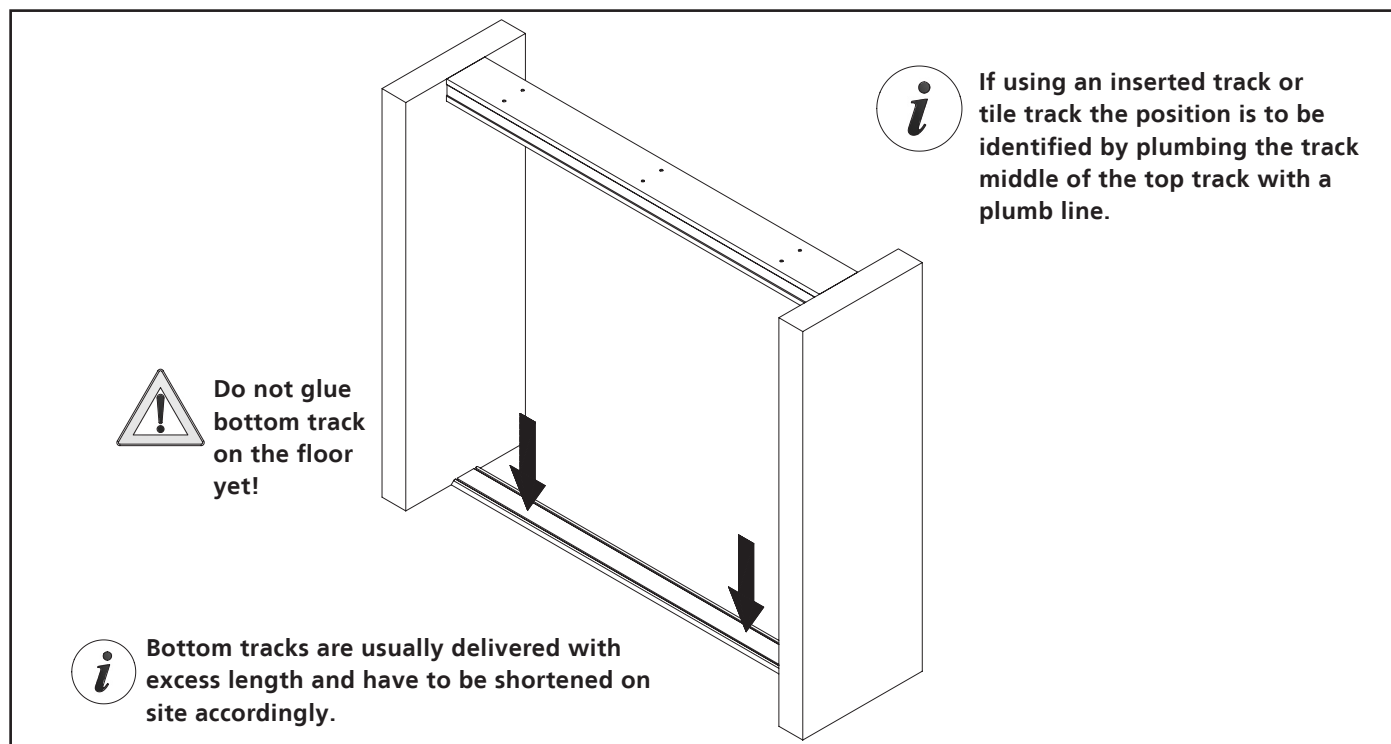

3_ Shorten bottom track to final dimension and position it approximately centrally under the top track

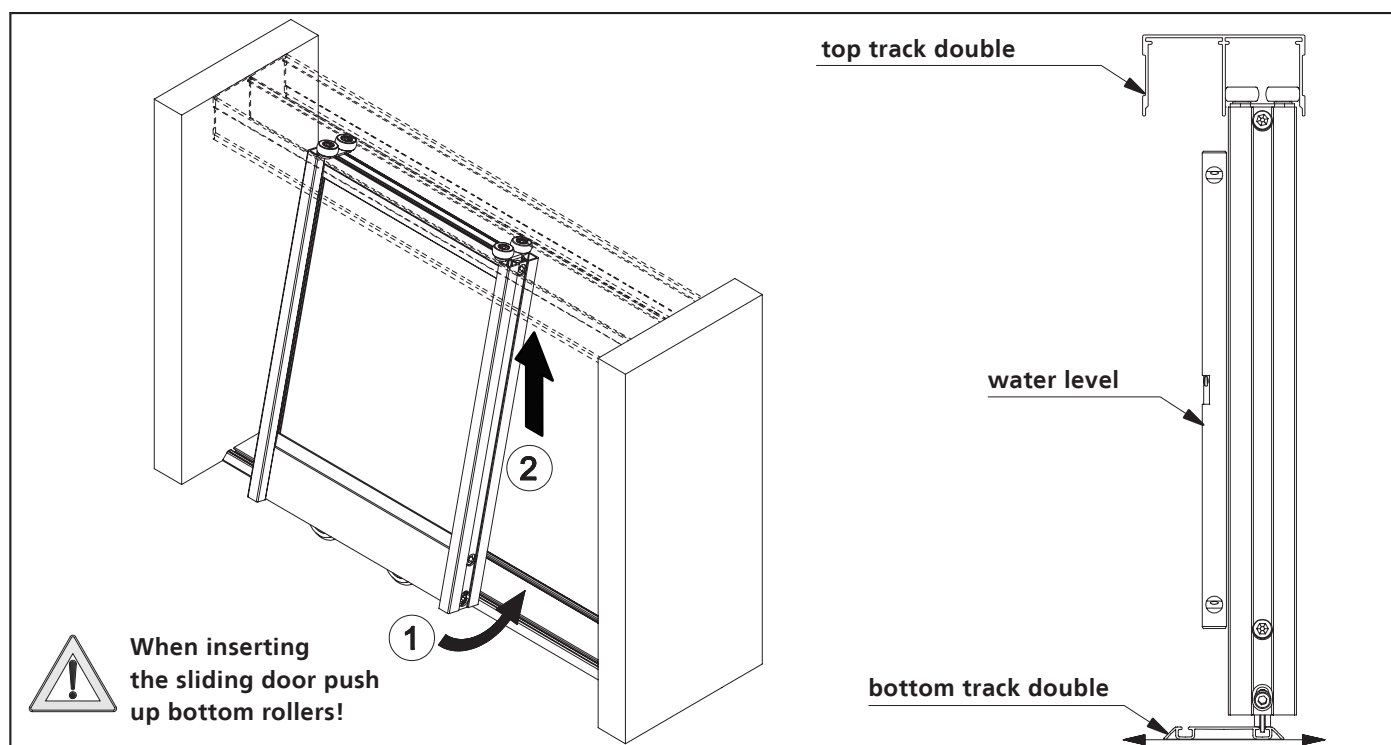

4_ Insert sliding door, align perpendicularly by moving bottom track, mark position with masking tape

INSTALLATION INSTRUCTION

STICK ON BOTTOM TRACK / INSERT DOOR



If using an inserted track or tile track cut in the carpet, the laminate or the tiles so that the bottom track can be adjusted. Before installing the bottom track, push the bottom stopper into the track and make sure it is facing the right way.

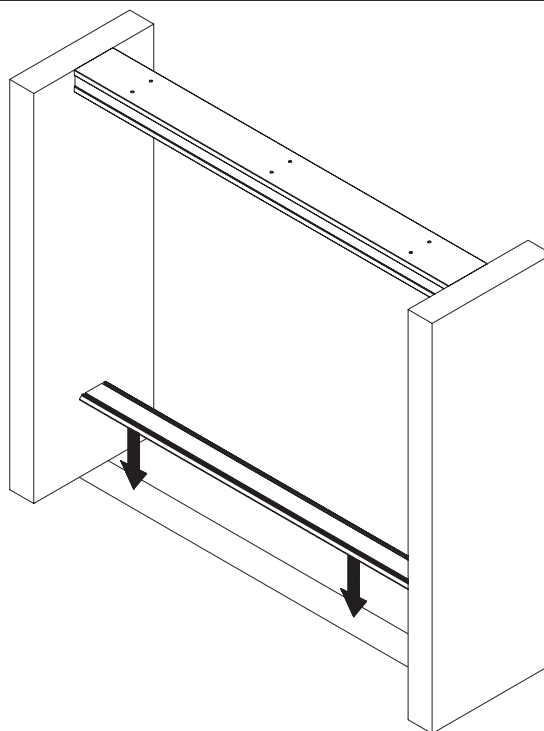

5_ Remove sliding door, clean surface (free of grease, impurities) and stick on bottom track at marked position



When inserting the sliding door push up bottom rollers!

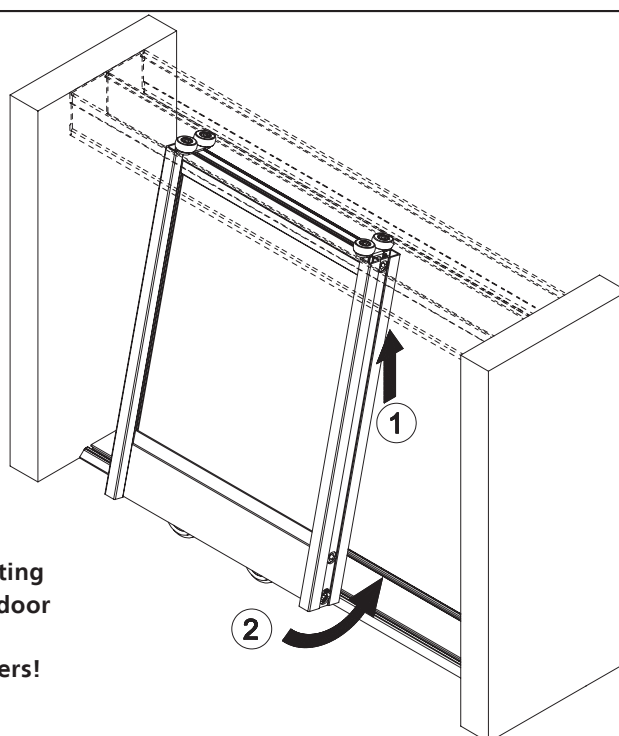

6_ Insert sliding door

INSTALLATION INSTRUCTION

ADJUST DOOR / STICK ON DUST EXCLUD. BRUSH

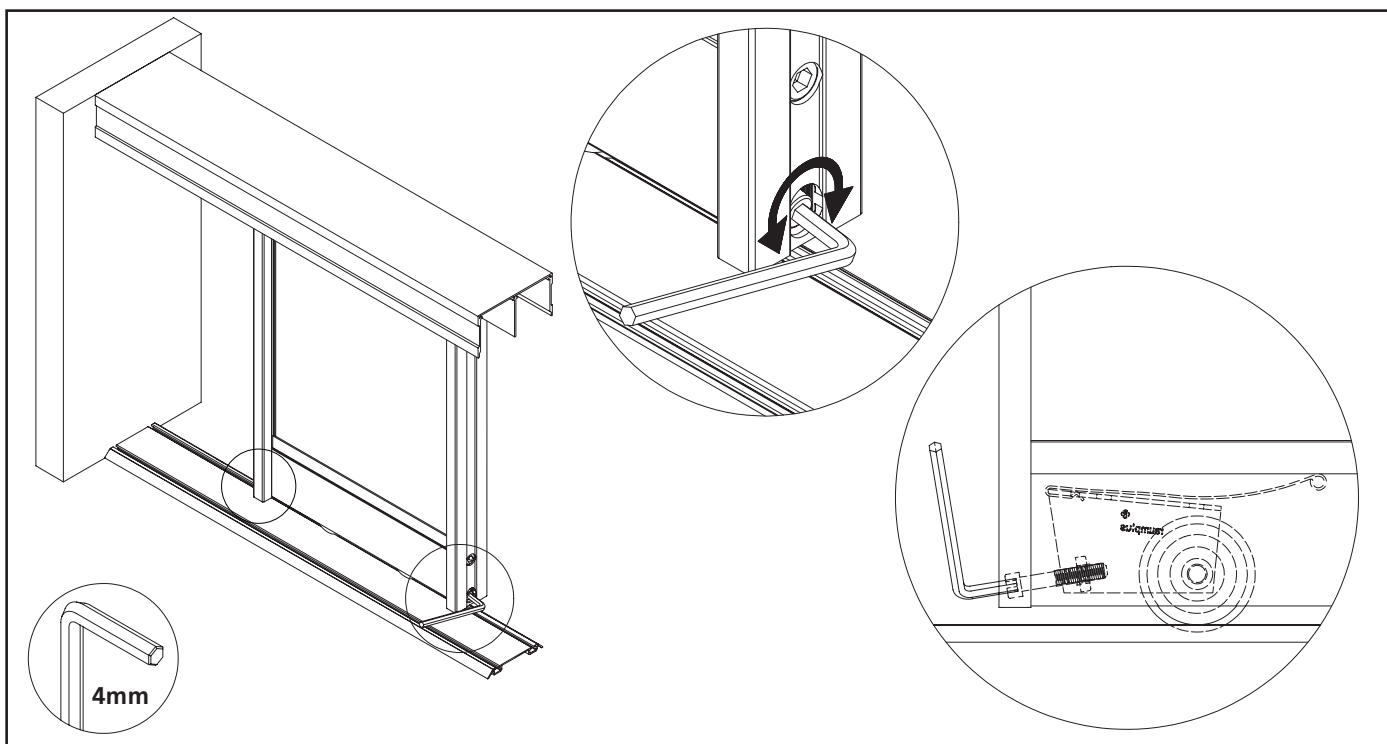

7_ Adjust sliding door

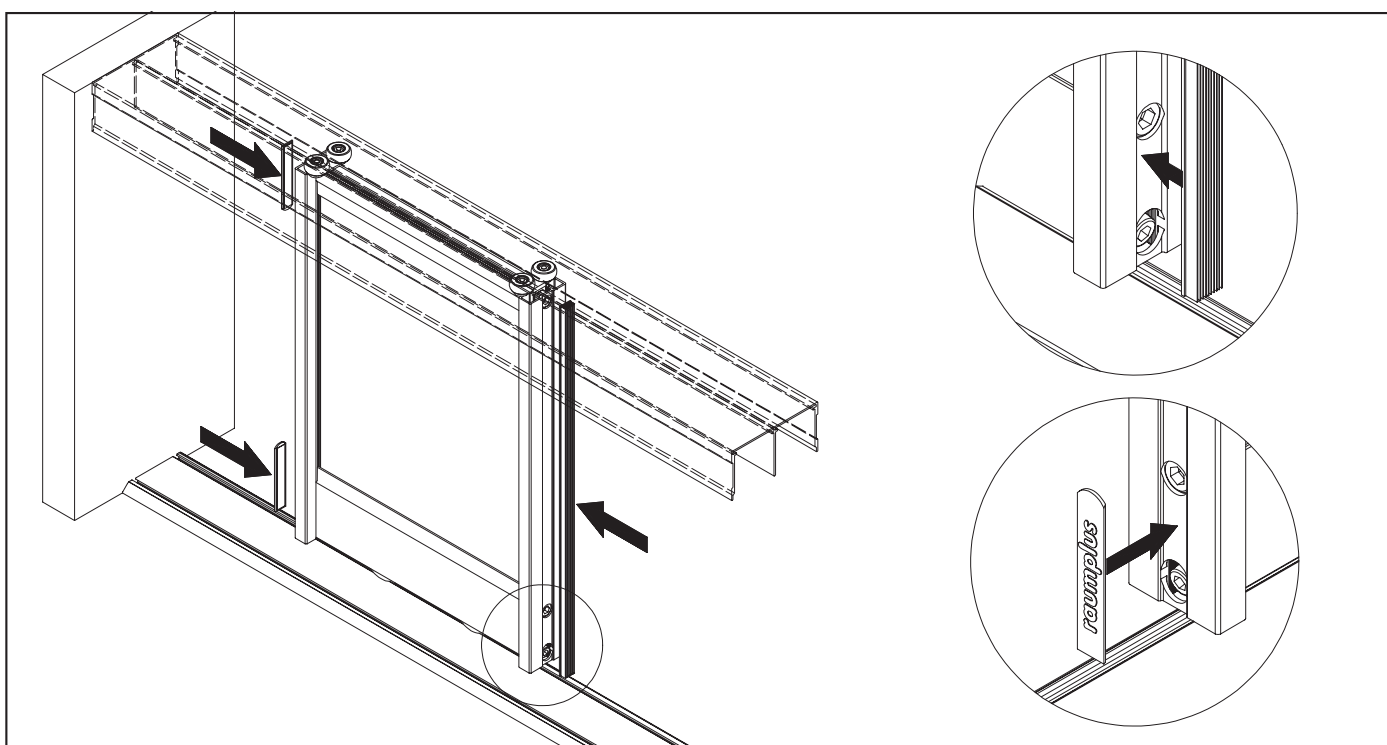

8_ Stick on plugs for punching holes and dust excluding brush

ASSEMBLY INSTRUCTION

POSITIONS FOR DUST EXCLUDING BRUSH

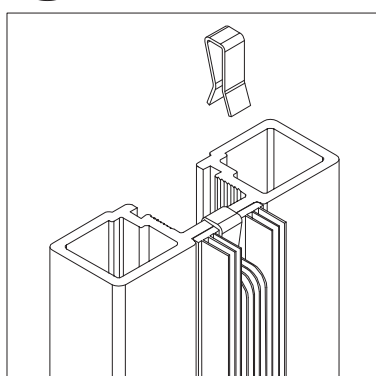
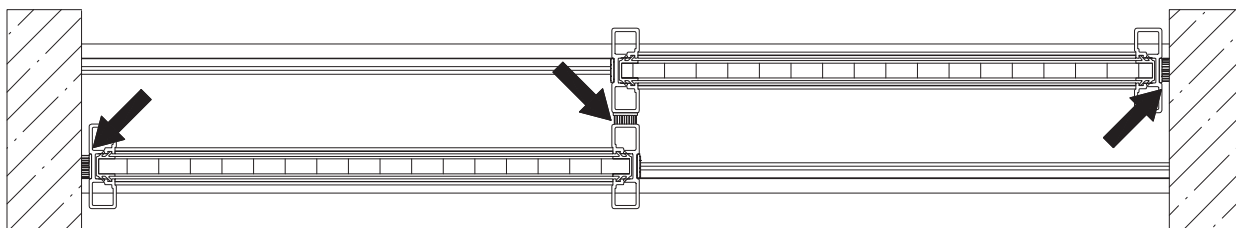

Stick on dust excluding brush and fix it with clip on top and bottom.

For the remaining sides, plugs for punching holes have to be stuck on at the top and bottom.

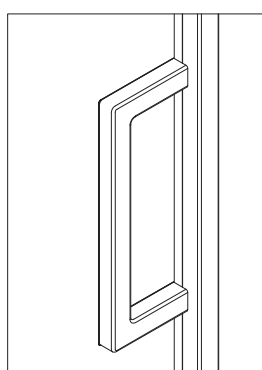

10.01.093
handle square

10.01.094
handle halfround

Remove the protective foil and stick on the handle on the dry, cleaned position (free from grease, oil, separating agent and other impurities); then press it on using your hand.

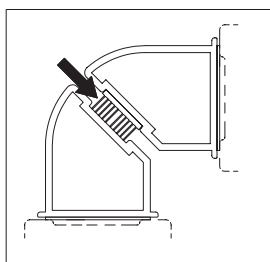
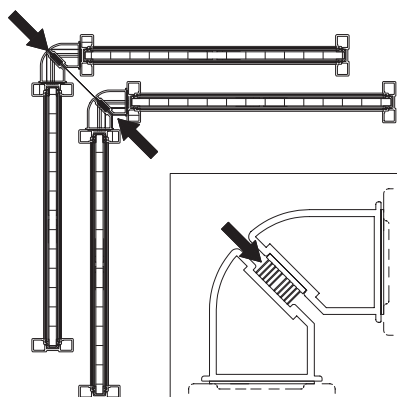

For corner solutions, please use the corner profile item-no: 14.07.0xx

ASSEMBLY INSTRUCTION

90°- CORNER SOLUTION

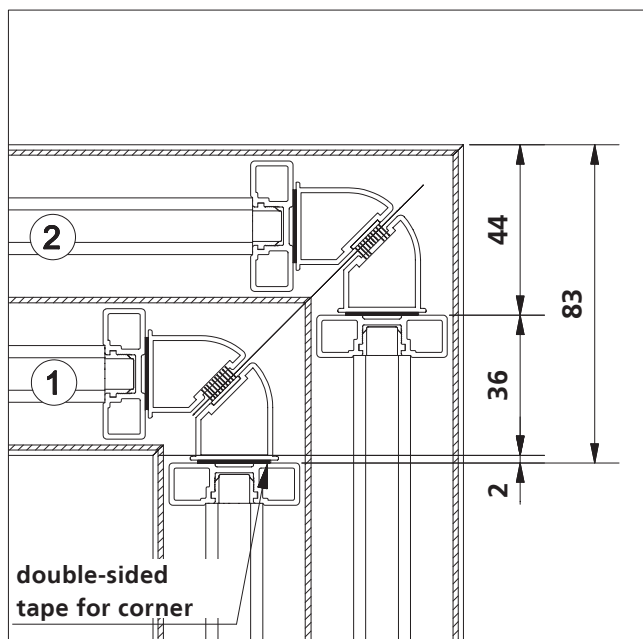

1_ 90°-corner solution (fig.: S150)



The corner profiles are to be stuck on the vertical profiles with double-sided tape for corner (item-no.: 25.12.046). (fig.: 1).

For corner solutions the use of bottom stoppers, at double- / triple corner solutions and additionally the use of top track stoppers are intended (separate assembly instruction) or the Corner stop f.double top track (item-no.: 10.08.28x).

How to find the width of the front

A1= width of wardrobe

A2= width of wardrobe

B1= depth from front edge of top track

B2= depth from front edge of top track

