

INSTALLATION INSTRUCTION - (SHORT VERSION)

SLIDING DOOR BRAKE S 34 / S 42

(2017-10-11) Short version 9.0/1

ACCESSORIES

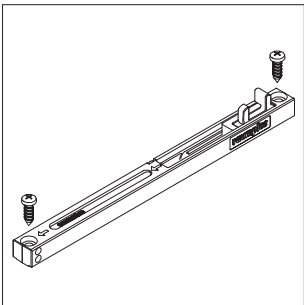

1_ 10.01.560
10.01.570

1_ Sliding door brake
for sliding door 10 - 30 kg
for sliding door 31 – 60 kg

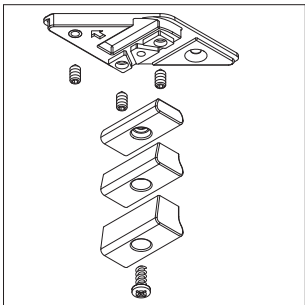

2_ 10.01.691
Positioning
for sliding door brake S34
with top cover:
small, medium, large

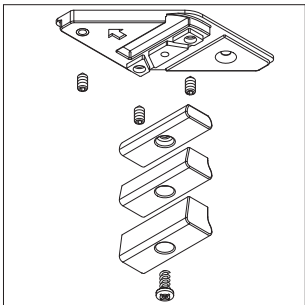

3_ 10.01.692
Positioning
for sliding door brake S42
with top cover:
small, medium, large

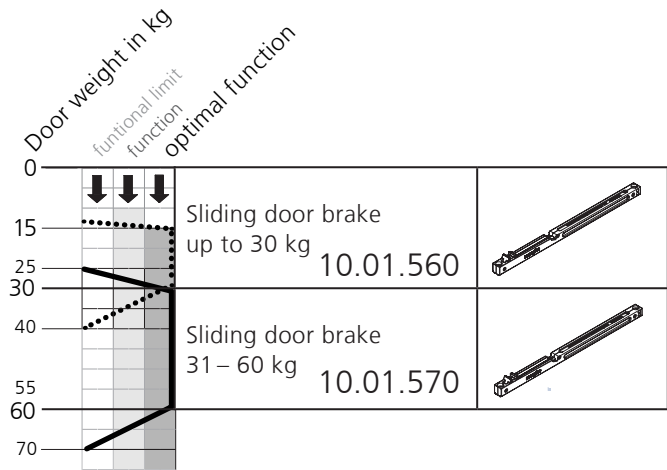

without illustration:

- Bottom track stopper
- Stopper for top track
- Stop plate
- for sliding door brake

Installation easy medium difficult

Subject to technical changes.

INSTALLATION INSTRUCTION

SLIDING DOOR BRAKE

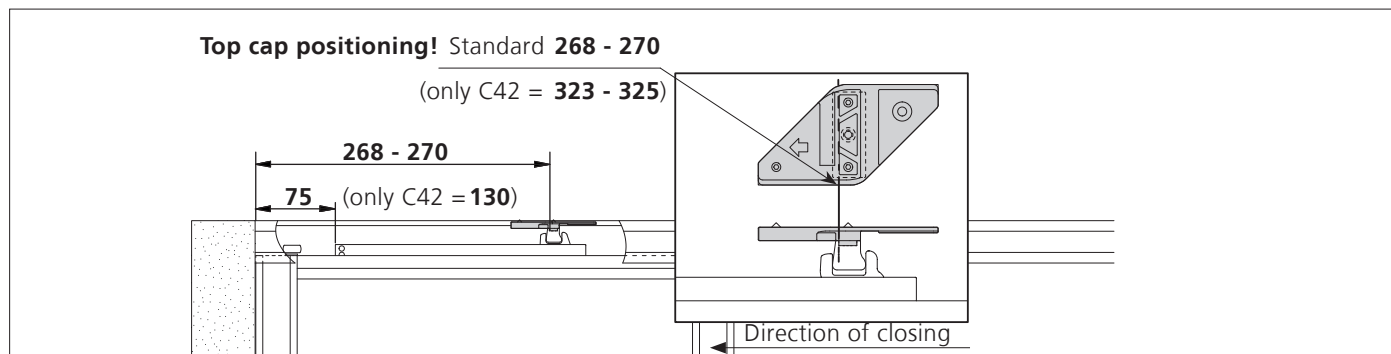

1_ Standard size for sliding door brake installation.

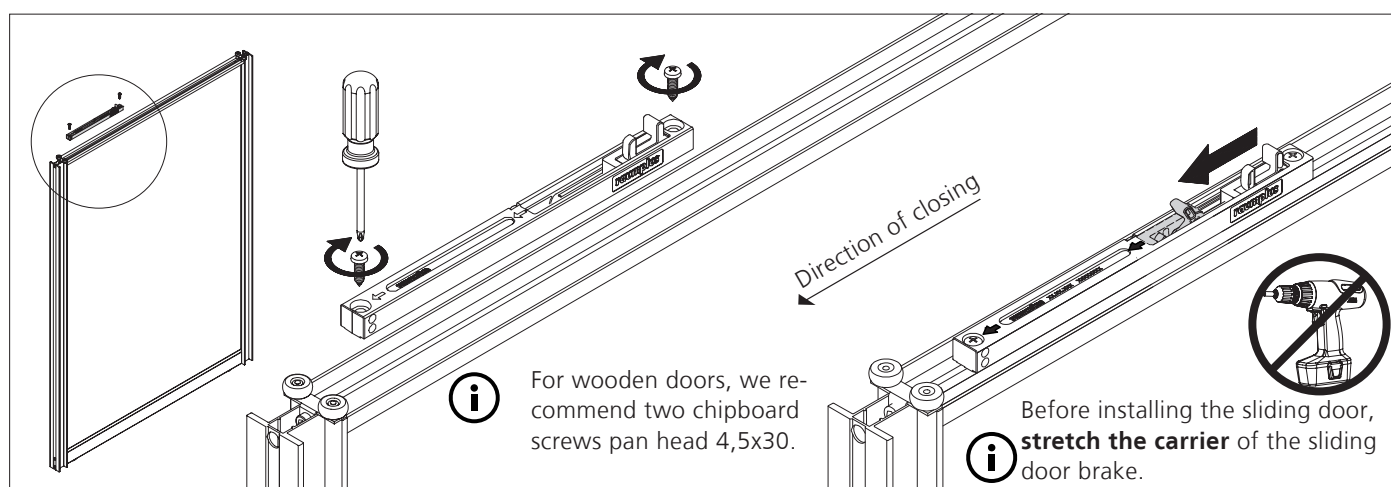

2_ Installation of the sliding door brake. Attention! Before installing the sliding door stretch the carrier.

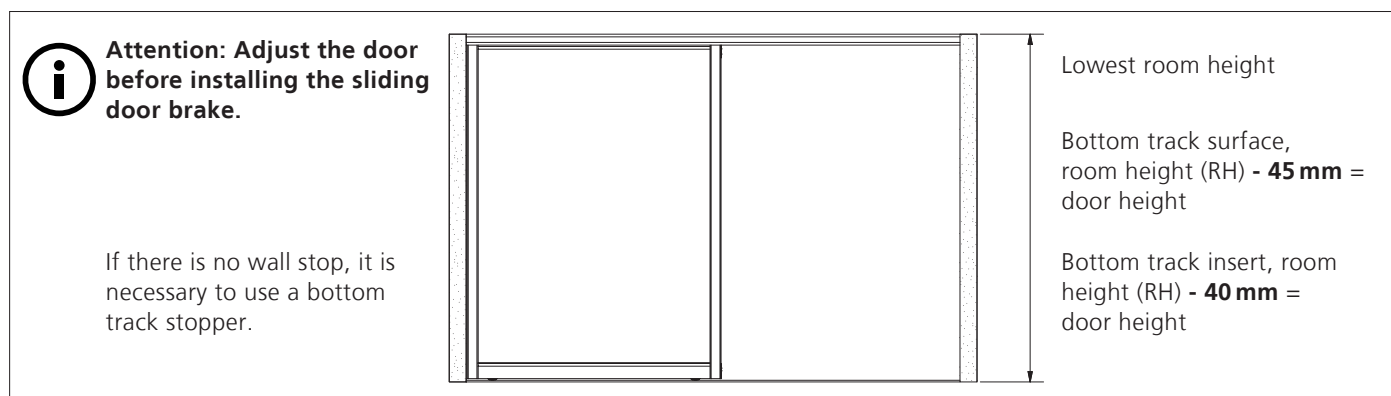

3_

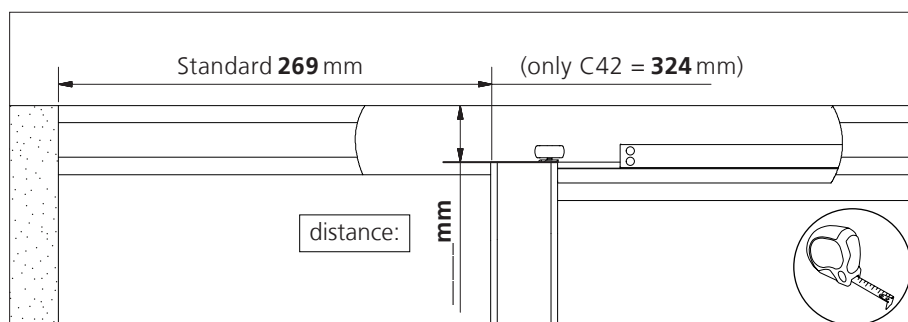

Measure the **distance** from the upper edge of the door to top track. Determine the top cap size with the table. (Small, medium or large)

4_ Slide the door into position (standard **269 mm**) to determine the correct pin length

INSTALLATION INSTRUCTION

DETERMINE PIN LENGTH

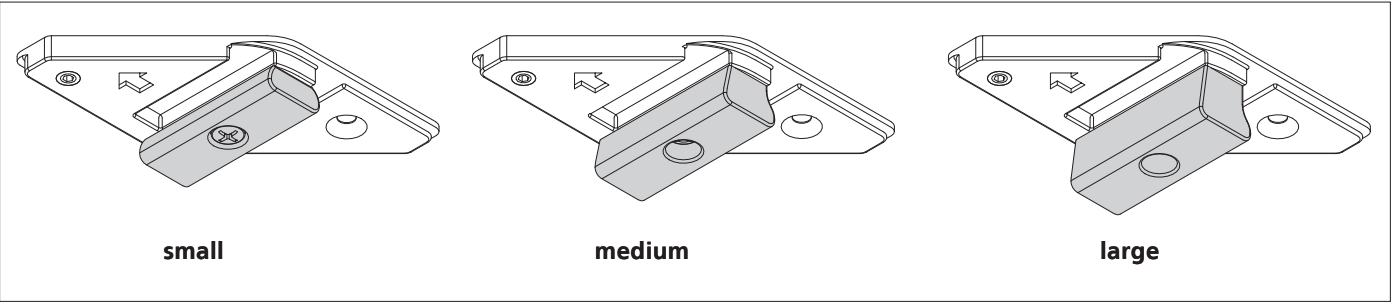

1_

System 34

symm / asym

S34	distance:
small	28-31
medium	31-35
large	35-38

System 42

S1200

S1200	distance:
small	28-31
medium	31-35
large	35-38

2_

System 42

S42	distance:
small	25-28
medium	28-32
large	32-35

System 42 / 34

wooden door

wooden door	distance:
small	28-31
medium	31-35
large	35-38

3_

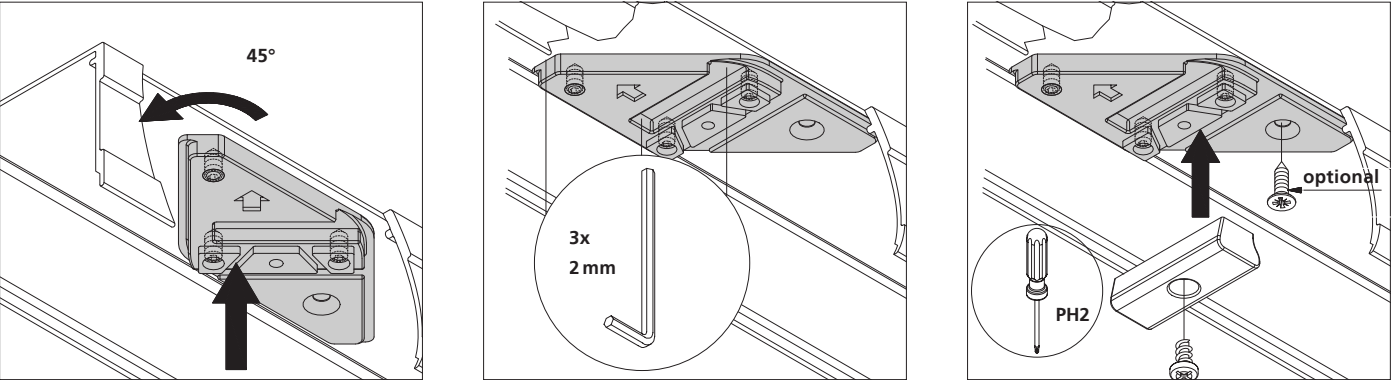

4_

5_

6_

INSTALLATION INSTRUCTION

SLIDING DOOR BRAKE

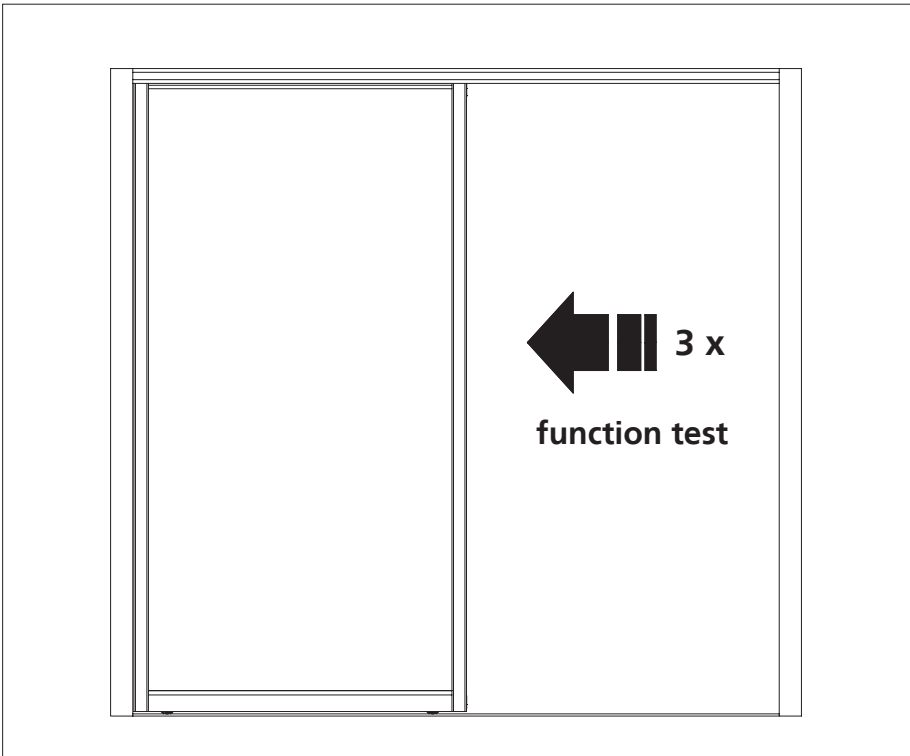

1_ Function test

Possible sources of error	
Error	Troubleshooting
The sliding door does not brake.	Stretch the carrier of sliding door brake.
The sliding door does not brake properly, it's grinds while closing.	Make sure that the top cap has the right size.
The sliding door closes too early or too late.	Correct the position of the positioning.
Imprecise overlap of the vertical profiles for systems with more than two sliding doors.	Make sure that the bottom stopper is on the correct position.
Noise when opening or closing the sliding door.	Make sure that the positioning is mounted at right angles.
	Make sure that the screws of the positioning are not too tight.
	Turn the door height adjustment max. one step down to increase the distance between driver and cut surface of the positioning.
The sliding door closes too slowly.	Make sure the floor is flush, if necessary exchange the sliding door brake. For slopes you need a sliding door brake for higher weight category.

2_ Possible sources of error



Detailed information can be found in the instructions: Sliding door brake S26 S34 S42 Installation

3_