



Livellatori Level adjusters

Serie LV100 / LV200 LV100 / LV200 Series

I LIVELLATORI DELLA SERIE LV100/LV200 SONO NORMALMENTE ASSEMBATI SUL LATO FIANCO SOTTO BASE.

FIG. 1 : LIVELLATORE SENZA DISTANZIALE.
FIG. 2 : LIVELLATORE CON UN DISTANZIALE.
FIG. 3 : LIVELLATORE CON DUE DISTANZIALI.

IL DISTANZIALE HA LA FUNZIONE DI AUMENTARE LA PORTATA DELLA BASE, DI TENERE IN PIANO IL LIVELLATORE QUANDO SI SPOSTA LATERALMENTE IL MOBILE E FARE DA GUIDA ALLA CHIAVE ES. 4.

THE LV100/LV200 SERIES LEVEL ADJUSTERS ARE NORMALLY ASSEMBLED UNDER BASE FLANK SIDE.

FIG. 1: LEVEL ADJUSTER WITHOUT SPACER.
FIG. 2: LEVEL ADJUSTER WITH SPACER.
FIG. 3: LEVEL ADJUSTER WITH TWO SPACERS.

THE SPACER IS USED: TO INCREASE THE CAPACITY OF THE BASE, TO KEEP THE LEVEL ADJUSTER LEVEL WHEN MOVING LATERALLY THE FURNITURE AND GUIDE THE ALLEN KEY 4.

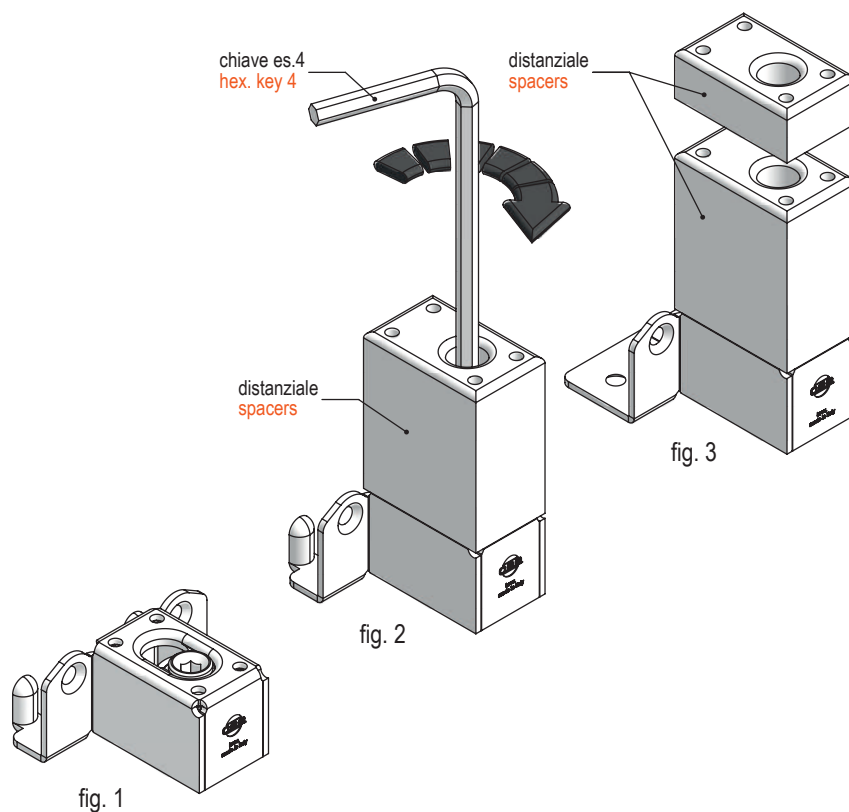



Esempi di applicazioni livellatori serie LV100 LV200

Application examples level adjusters LV100 LV200 series

I LIVELLATORI POSSONO
ESSERE
POSIZIONATI SOTTO LE
GIUNZIONI CON FORO
PASSANTE.
ATTRAVERSO LA
GIUNZIONE SI PUO'
PASSARE CON LA CHIAVE
ES.4 PER LA REGOLAZIONE
DEI LIVELLATORI.

THE LEVEL ADJUSTERS
CAN BE POSITIONED
UNDER THE CONNECTING
FITTINGS WITH THROUGH
HOLE.
THE HEX. KEY 4 CAN PASS
THROUGH THE
CONNECTING FITTING TO
ADJUST THE LEVEL
ADJUSTERS.

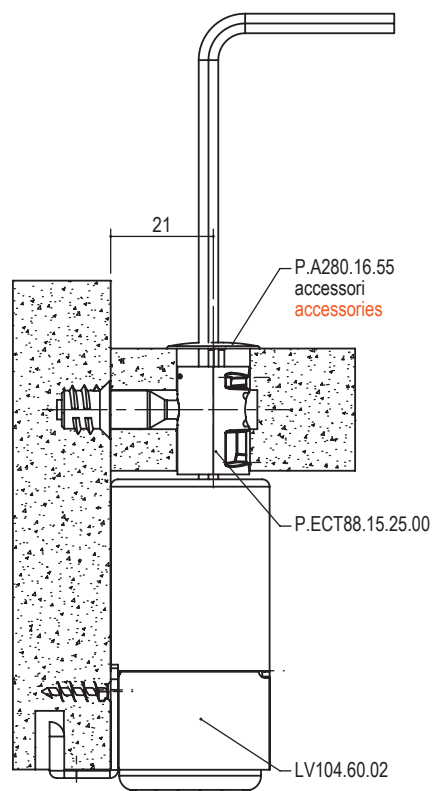
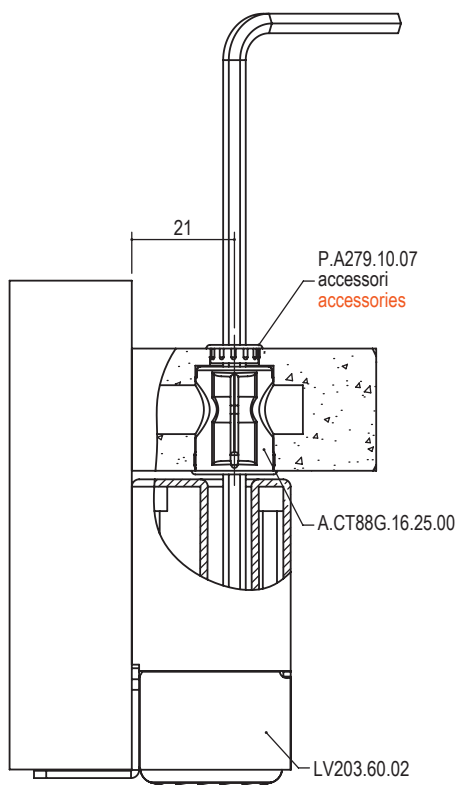



Livellatore tipo LV101 / LV102 Level adjuster LV101 / LV102 type

CATAS
Test Report 34774/1

LIVELLATORE IN ACCIAIO
SOTTO BASE LATO FIANCO.

STEEL LEVEL ADJUSTER
UNDER BASE FLANK SIDE

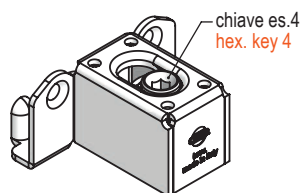

acciaio - nylon FV grigio
steel - gray nylon FG

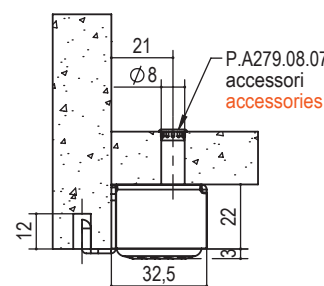
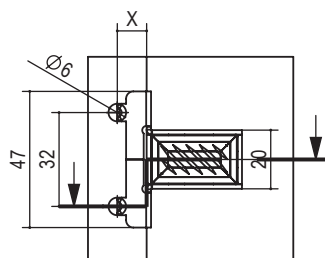

tipo type	X	misura measure	finitura finishing	box	kg / box
LV101.	10	22.	02 zincato bianco white zinc	400	22,4
LV102.	12,5				

es./e.g.: LV101.22.02

Livellatore tipo LV103 / LV104 Level adjuster LV103 / LV104 type

CATAS
Test Report 34774/1

LIVELLATORE IN ACCIAIO
SOTTO BASE LATO FIANCO
IN ACCIAIO CON
DISTANZIALE PREMONTATO
SUI LIVELLATORI LV101 E
LV102.

STEEL LEVEL ADJUSTER
UNDER BASE FLANK SIDE
WITH SPACER PRE-
ASSEMBLED.

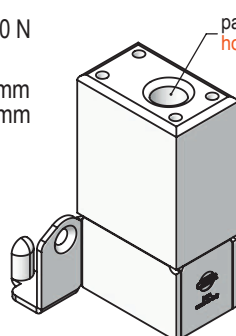
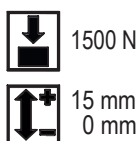

acciaio - nylon FV grigio
steel - gray nylon FG

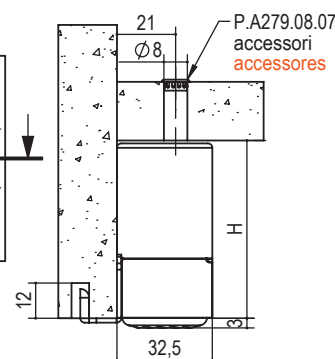
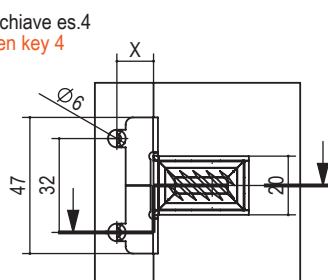

tipo type	X	misura measure	H	finitura finishing	box	kg / box
LV103.	10	32	32	02 zincato bianco white zinc	400	25,2
		35	35			25,5
		38	38			22,6
		40	40			22,8
LV104.	12,5	45	45		350	23,4
		54	54			24,3
		60	60			24,9
		65	65		300	21,9

es./e.g.: LV104.38.02



Livellatore tipo LV201

Level adjuster LV201 type

CATAS
Test Report 34774/1

LIVELLATORE IN ACCIAIO
SOTTO BASE LATO FIANCO.

STEEL LEVEL ADJUSTER
UNDER BASE FLANK SIDE.



1500 N



15 mm
0 mm

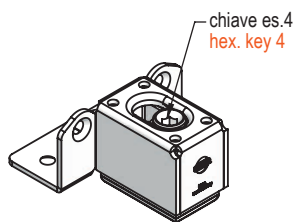

acciaio - nylon FV grigio
steel - gray nylon FG

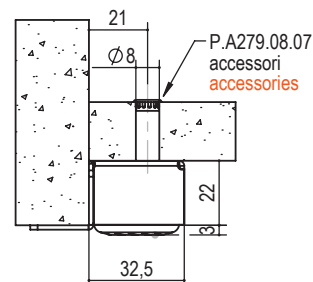
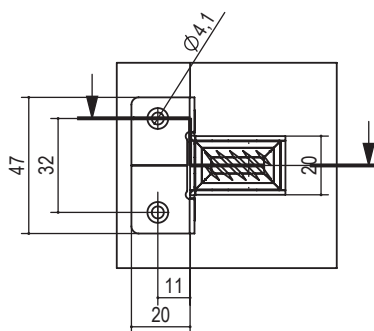

tipo type	misura measure	finitura finishing	box	kg / box	pack
LV201.	22.	02 zincato bianco white zinc	400	22,4	10

es./e.g.: LV201.22.02

Livellatore tipo LV203

Level adjuster LV203 type

CATAS
Test Report 34774/1

LIVELLATORE IN ACCIAIO
SOTTO BASE LATO
FIANCO CON DISTANZIALE
PREMONTATO.

STEEL LEVEL ADJUSTER
UNDER BASE FLANK SIDE
WITH SPACER PRE-
ASSEMBLED.



1500 N



15 mm
0 mm

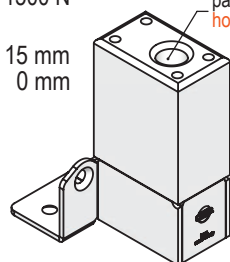

acciaio - nylon FV grigio
steel - gray nylon FG

passaggio chiave es.4
hole for allen key 4

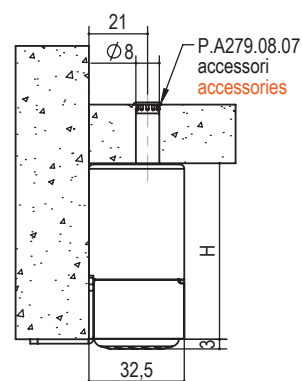
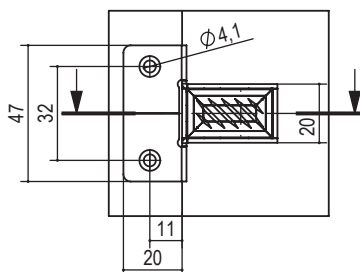

tipo type	misura measure	H	finitura finishing	box	kg / box	pack
LV203.	32.	32	02 zincato bianco white zinc	400	25,2	10
	35.	35			25,5	
	38.	38			22,6	
	40.	40			22,8	
	45.	45		350	23,4	
	54.	54			24,3	
	60.	60			24,9	
	65.	65		300	21,9	

es./e.g.: LV203.45.02



Distanziale per livellatori serie LV100 / LV200 Spacers for levelers LV100 / LV200 series

DISTANZIALE CON FORO
PASSANTE PER CHIAVE
DI REGOLAZIONE
LIVELLATORE.

SPACER WITH HOLE FOR
KEY CONTROL LEVEL
ADJUSTER.

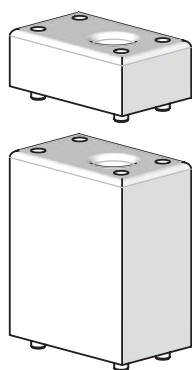

nylon FV grigio
grey nylon FG

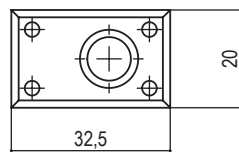
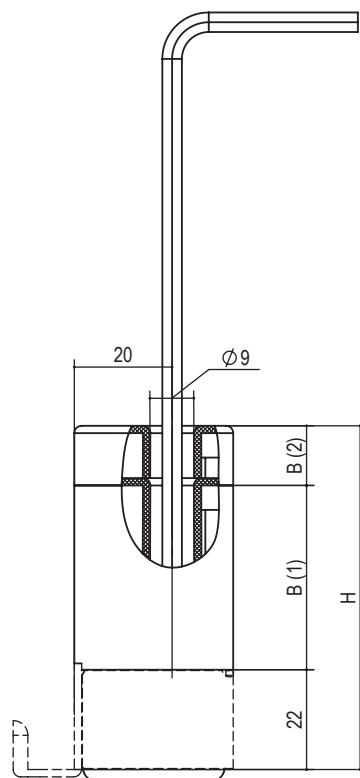

tipo type	misura measure	B	finitura finishing	box	kg / box	pack
P.A020	10.	10	55 grigio grey	3000	11,7	50
	13.	13		2500	12	
	16.	16		2000	11,4	
	18.	18		2000	12,6	
	23.	23		1500	11,7	
	32.	32		1000	10,5	
	38.	38		900	12	
	43.	43		800	11,2	

es./e.g.: P.A020.23.55



Livellatori Level adjusters

Serie LV300 LV300 Series

I LIVELLATORI DELLA SERIE LV300 SONO NORMALMENTE INCASSATI NELLE BASI A TERRA. SVOLGONO LA FUNZIONE ANCHE DI GIUNZIONE CON MINOR NUMERO DI PEZZI DA ASSEMBLARE E MINORI LAVORAZIONI. BASSA COPPIA DI REGOLAZIONE. OTTIMA PORTATA.

LV300 SERIES LEVEL ADJUSTERS ARE NORMALLY RECESSED IN THE GROUND BASES. THEY PERFORM THE JOINING FUNCTION ADJUSTMENT ALSO WITH FEWER PIECES TO ASSEMBLE. LOW ADJUSTMENT TORQUE. EXCELLENT CAPACITY.

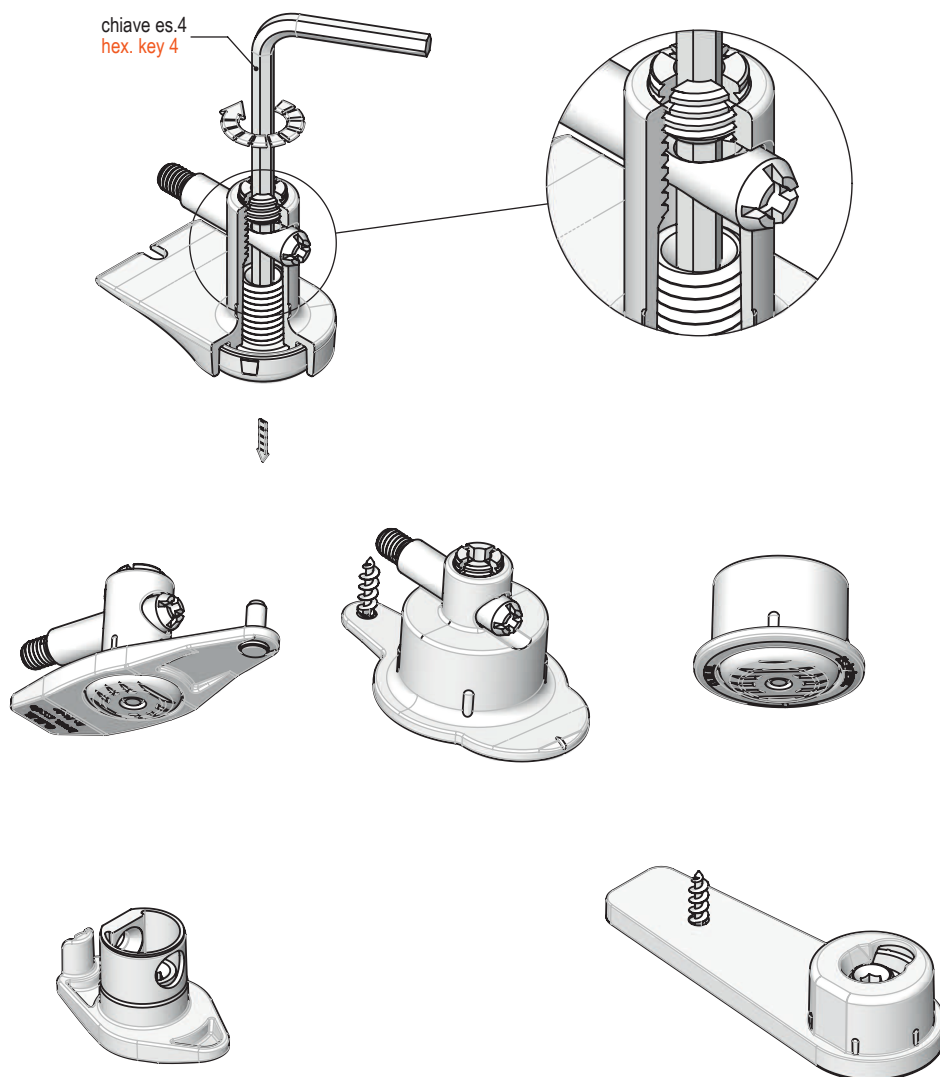



Livellatore tipo LV301 \ LV302 Level adjuster LV301 \ LV302 type

CATAS®
Test Report 34773/1

LIVELLATORE DA INCASSO
PER BASE A TERRA
REALIZZATO IN ACCIAIO.
SPESSORE MINIMIMO
BASE 18.

BUILT-IN LEVEL ADJUSTER
FOR GROUND BASE MADE
OF STEEL.
MINIMUM BASE
THICKNESS 18.

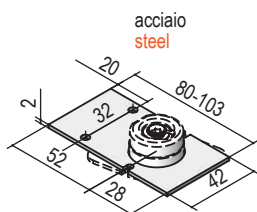

Piastrina supporto
fianchi
Side support plate
Cod. S.P.A321.02
42X80
Cod. S.P.A502.02
42X103

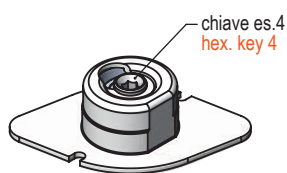
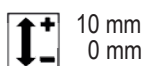

acciaio - nylon FV grigio
steel - gray nylon FG

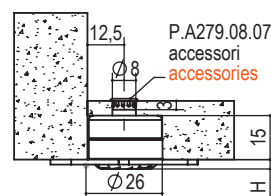
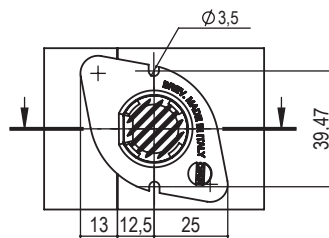

tipo type	misura measure	H	finitura finishing	box	kg / box	pack
LV301.	3,5.	3,5.	02 zincato bianco white zinc	500	20	10
LV302.	13,5.	13,5.				

es./e.g.: LV301.3,5.02

Livellatore tipo LV303 Level adjuster LV303 type

LIVELLATORE DA INCASSO
PER BASE UTILE QUANDO
SERVE AVERE IL PUNTO DI
REGOLAZIONE SPOSTATO
VERSO L'INTERNO.

LEVEL ADJUSTER BUILT
FOR BASIC EARNINGS
WHEN YOU NEED TO HAVE
POINT OF ADJUSTMENT
MOVED INWARDS.

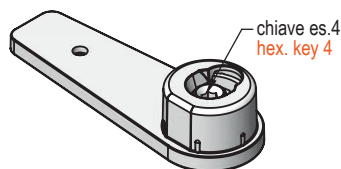
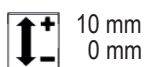

zama - nylon FV grigio
zamak - gray nylon FG

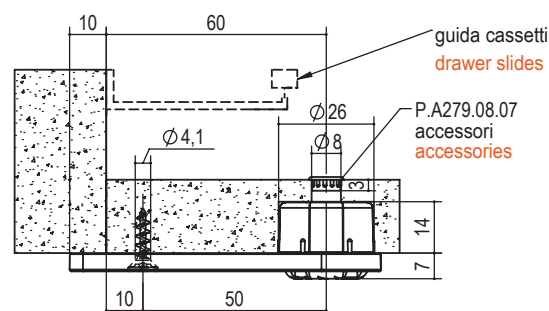
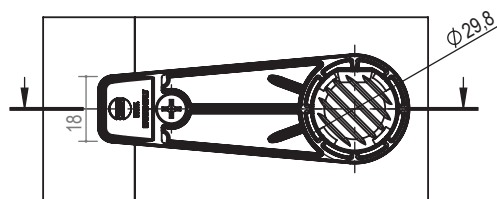

tipo type	misura measure	finitura finishing	box	kg / box	pack
LV303.	07.	00 grezzo raw	400	20	10

es./e.g.: LV303.07.00



Livellatore tipo LV304

Level adjuster LV304 type

LIVELLATORE DA INCASSO
PER BASE A TERRA
REALIZZATO IN NYLON
CARICATO FIBRA VETRO.

BUILT-IN LEVEL ADJUSTER
FOR GROUND BASE MADE
OF NYLON FV.



1500 N
gray nylon FG



10 mm
0 mm

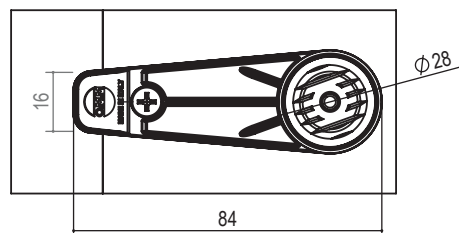

tappo zama $\phi 5$ varie finiture
zamak cover cup $\phi 5$ various
finishings P.A458.05

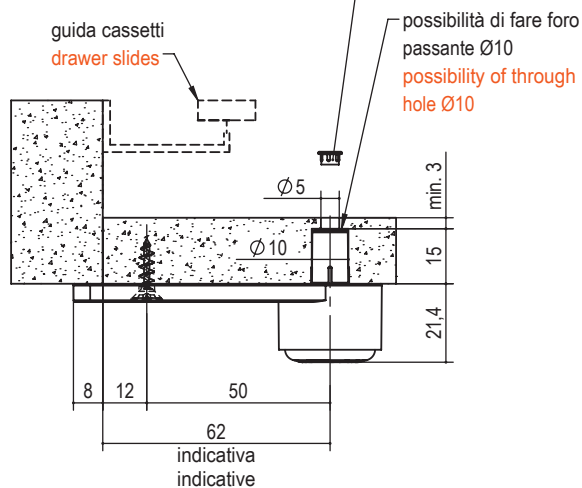

tipo	misura	finitura	box	kg / box	pack
type	measure	finishing			
LV304.	21.	53 nero black	400	12	10

es./e.g.: LV304.21.53



Livellatore tipo LV311 LV312 LV313 LV314 Level adjuster LV311 LV312 LV313 LV314 type

CATAS®

Test Report 84579

LIVELLATORE DA
INCASSO PER BASE A
TERRA REALIZZATO IN
NYLON FIBRA VETRO.
OTTIMA PORTATA.

BUILT-IN LEVEL
ADJUSTER FOR GROUND
BASE MADE OF NYLON
FIBRE GLASS.
EXCELLENT CAPACITY.



1500 N



10 mm
0 mm

acciaio - nylon FV grigio
steel - grey nylon FG

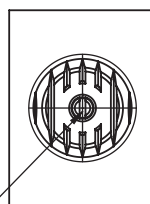

solo per LV312 taglio cacciavite
only LV312 slotted head

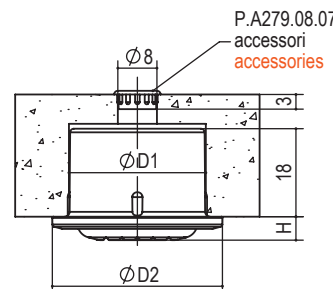

tipo type	misura measure	H	D1	D2	finitura finishing	box	kg / box	pack
LV311.	2,5.	2,5	28	35	55 grigio grey	500	20,3	10
LV312.	5,0.	5,0						
LV313.	2,5.	2,5	30	38			21	
LV314.	5,0.	5,0						

es./e.g.: LV311.2,5,55

Livellatore tipo LV311 LV312 LV313 LV314 con giunzioni Level adjuster LV311 LV312 LV313 LV314 with connecting fittings

CATAS®

Test Report 84579

LIVELLATORE DA
INCASSO PER BASE A
TERRA, PREASSEMBLATO
CON LE GIUNZIONI
INDICATE IN TABELLA.
SVOLGE OLTRE A QUELLA
DI LIVELLATORE LA
FUNZIONE DI GIUNZIONE.
OTTIMA PORTATA.

BUILT-IN LEVEL
ADJUSTER FOR GROUND
BASE, PRE-ASSEMBLED
WITH THE CONNECTING
FITTINGS INDICATED IN
THE TABLE.
IT HAS A JOINING
FUNCTION IN ADDITION
TO THE LEVEL ADJUSTER
ONE.
EXCELLENT CAPACITY.



PER GRANO
PREASSEMBLATO INSERIRE
LETTERA "G" NEL CODICE.

WITH PRE-ASSEMBLED
GRAIN, PLEASE ADD THE
LETTER "G" TO THE ARTICLE
CODE.

es./e.g.:
LV31118.CT88G1418.00

www.omm.name
omm@omm.name
tel. 0362.622377



1500 N



8 mm
0 mm

acciaio - zama - nylon FV grigio
steel - die cast - grey nylon FG

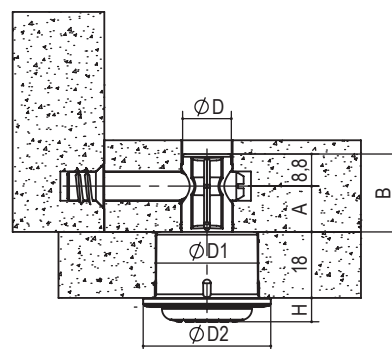
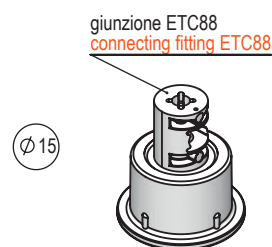
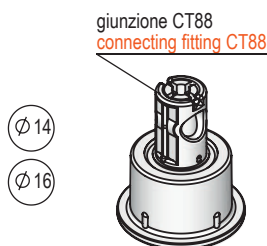

LIVELLATORE LEVEL ADJUSTERS				GIUNZIONE CONNECTING FITTINGS					ASSIEME ASSEMBLY		
tipo type	H	D1	D2	tipo type	A	B	ØD	finitura finishing	box	kg / box	pac
LV31118.	2,5	28	35	CT881418	9	17,8	13,9	00 grezzo raw	400	15,0	10
LV31218.	5			CT881420	10	18,8				15,2	
LV31318.	2,5			CT881422	11	19,8				15,4	
LV31418.	5	30	38	CT881425	12,5	21,3	15,9	05 ottonato brass		15,8	
				CT881622	11	19,8		06 bronzato bronzed		16,0	
				CT881625	12,5	21,3		07 nichelato nickel		16,2	
				CT881630	15,0	23,8				16,4	
				ECT881518.	9	18	14,8			15,0	
				ECT881525.	12,5	21,3				15,8	
				ECT881532.	16	25				16,4	

es./e.g.: LV31118.ECT881518.00

es./e.g.: LV311418.CT881418.00



Livellatore - giunzione tipo LV341 Level adjuster - connecting fitting LV341 type

CATAS
Test Report 71521/1

REALIZZATO IN UN CORPO UNICO SVOLGE OLTRE A QUELLA DI LIVELLATORE LA FUNZIONE DI GIUNZIONE.
MADE OF A SINGLE BODY WITH A JOINING FUNCTION IN ADDITION TO THE LEVEL ADJUSTER ONE.



PER GRANO PREASSEMBLATO INSERIRE LETTERA "G" NEL CODICE.
WITH PRE-ASSEMBLED GRAIN, ADD THE LETTER "G" TO THE ART. CODE.
es/e.g.: LV341.G.15.42.02

PER COMPLETARE I MONTAGGI CON "D" = Ø 15 UTILIZZARE LE BUSSOLE SOTTO INDICATE. PER Ø 16 VEDERE IL CAPITOLO GIUNZIONI.
TO COMPLETE ASSEMBLY WITH "D" = Ø 15 USE THE HOUSING SHOWN BELOW. FOR Ø 16 SEE CONNECTING FITTINGS CHAPTER.

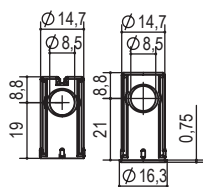

ST88.15.38 CT88.15.42



1500 N



12 mm
0 mm

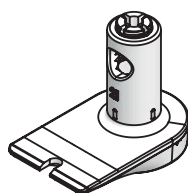

zama - acciaio
die-cast - steel

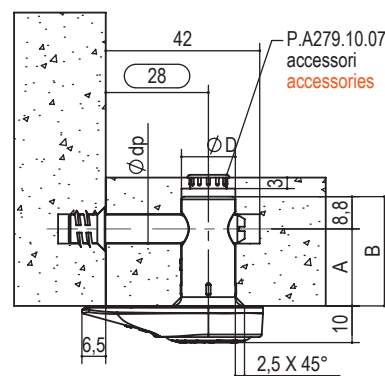
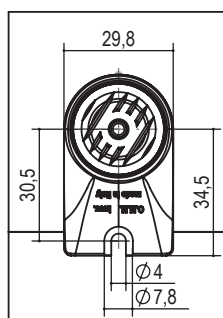

tipo type	misura measure	ØD	A	B	Ød	finitura finishing	box	kg / box
LV341.	10.15.38.	14,8	19	27,8	8	00 grezzo raw	300	19,8
	10.15.42.		21	29,8				20,1
	10.16.30.		15	23,8				20

es./e.g.: LV341.10.15.42.02

Livellatore - giunzione tipo LV342 Level adjuster - connecting fitting LV342 type

LIVELLATORE-GIUNZIONE PER BASE A TERRA REALIZZATO IN UN CORPO UNICO SVOLGE OLTRE A QUELLA DI LIVELLATORE LA FUNZIONE DI GIUNZIONE. OTTIMA PORTATA.

LEVEL ADJUSTER - CONNECTING FITTING FOR GROUND BASE MADE OF A SINGLE BODY WITH A JOINING FUNCTION IN ADDITION TO THE LEVEL ADJUSTER ONE. EXCELLENT CAPACITY.



PER GRANO PREASSEMBLATO INSERIRE LETTERA "G" NEL CODICE.
WITH PRE-ASSEMBLED GRAIN, PLEASE ADD THE LETTER "G" TO THE ARTICLE CODE.
es./e.g.: LV342.G.10.14.25.02



1500 N



12 mm
0 mm

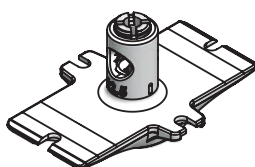

zama - acciaio
die-cast - steel

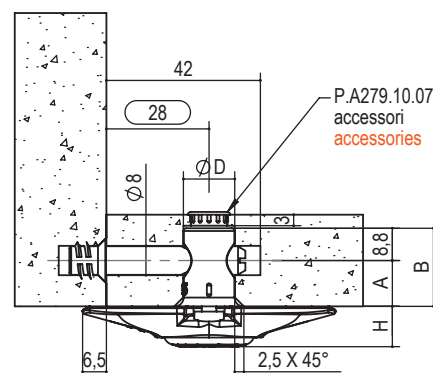
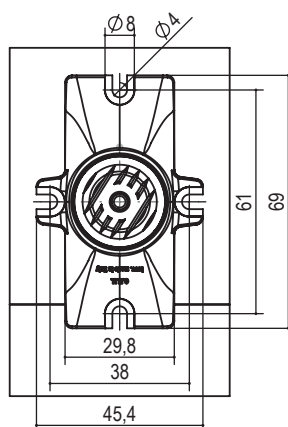

tipo type	misura measure	ØD	A	B	H	finitura finishing	box
LV342.	10.14.25.	14	12,5	21,3	10	00 grezzo raw	300
	10.14.18.		9	17,8			

es./e.g.: LV342.10.14.25.02



Livellatore - giunzione tipo LV344

Level adjuster - connecting fitting LV344 type

REALIZZATO IN UN CORPO UNICO SVOLGE OLTRE A QUELLA DI LIVELLATORE LA FUNZIONE DI GIUNZIONE.

MADE OF A SINGLE BODY WITH A JOINING FUNCTION IN ADDITION TO THE LEVEL ADJUSTER ONE.



PER GRANO PREASSEMBLATO INSERIRE LETTERA "G" NEL CODICE.

WITH PRE-ASSEMBLED GRAIN, PLEASE ADD THE LETTER "G" TO THE ARTICLE CODE.
es./e.g.: LV344.G.07.14.25.00

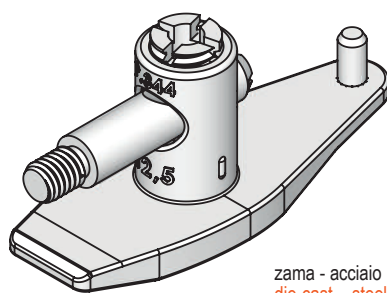
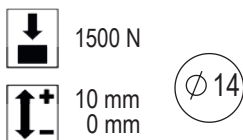

zama - acciaio
die-cast - steel

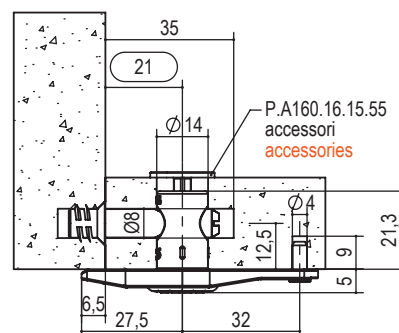
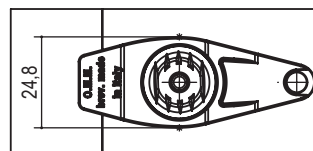

tipo type	misura measure	finitura finishing	box	kg / box	pack
LV344.	05.14.25	00 grezzo raw	300	24,9	10

es./e.g.: LV344.05.14.25.00

Livellatore - giunzione tipo LV353

Level adjuster - connecting fitting LV353 type

LIVELLATORE SOTTO BASE PREASSEMBLATO CON LE GIUNZIONE SERIE GN200 ETC88.

THE SUB-BASE LEVEL ADJUSTER PRE-ASSEMBLED WITH THE CONNECTING FITTINGS GN200 SERIES ETC88.

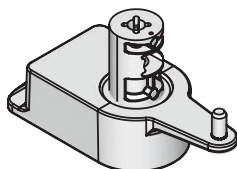
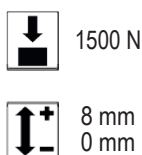

zama
die cast

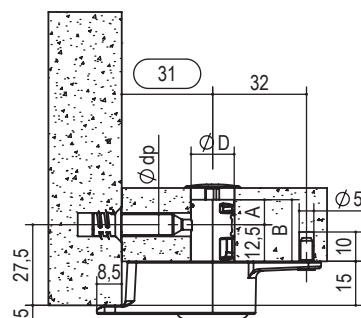
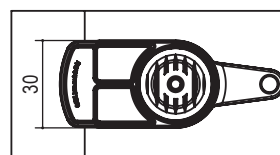

per "A" e "B" vedere giunzioni
for "A" and "B" see connecting fittings

LIVELLATORE LEVEL ADJUSTERS	GIUNZIONE CONNECTING FITTINGS			
tipo type	serie series	finitura finishing	box	kg / box
LV35320.	GN100	00 grezzo raw	200	18,4
	GN200			

es./e.g.: LV35320.ECT881525.00



Livellatore - giunzione tipo LV343

Level adjuster - connecting fitting LV343 type

REALIZZATO IN UN CORPO UNICO SVOLGE OLTRE A QUELLA DI LIVELLATORE LA FUNZIONE DI GIUNZIONE.

MADE OF A SINGLE BODY WITH A JOINING FUNCTION IN ADDITION TO THE LEVEL ADJUSTER ONE.



PER GRANO PREASSEMBLATO INSERIRE LETTERA "G" NEL CODICE.

WITH PRE-ASSEMBLED GRAIN, PLEASE ADD THE LETTER "G" TO THE ARTICLE CODE.

es./e.g.: LV343.G.05.14.25.00

PER I RELATIVI TAPPI VEDERE SEZIONE ACCESSORI

FOR THE COVER CUP SEE ACCESSORIES SECTION

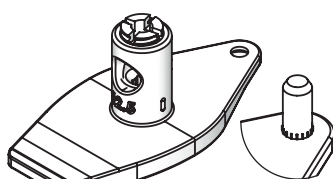
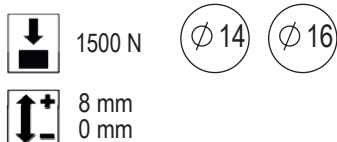

zama - acciaio
die-cast - steel

per variante con perno
opzionale aggiungere
lettera "S" nel codice.
es. LV343S.05.16.25.00

for variable with optional
dowel add the letters "S"
in the code. e.g.
LV343S.05.16.25.00

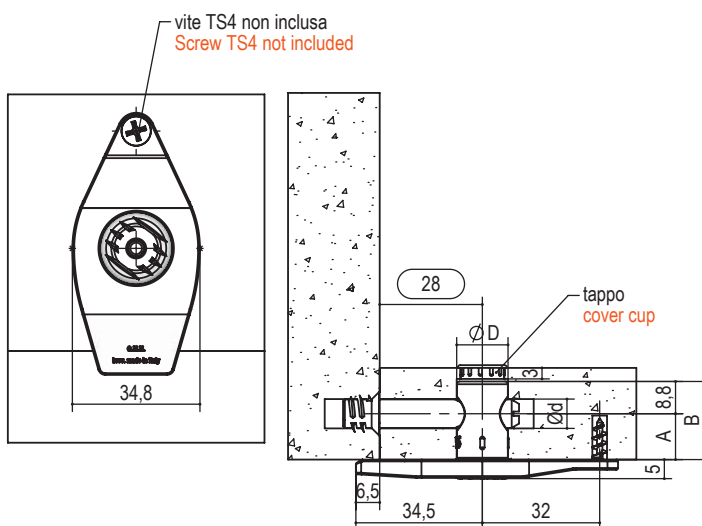

tipo type	misura measure	A	B	ØD	Ød	finitura finishing	box	kg / box
LV343.	05.14.25	12,5	21,5	14	8	00 grezzo raw	300	24,9
	05.14.30	15	24	14	8			
	05.16.30	15	24	16	10			

es./e.g.: LV343.05.14.25.00

Livellatore tipo LV331

Level adjuster LV331 type

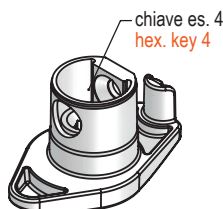
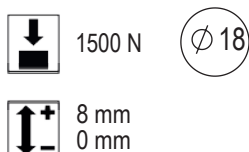

zama - nylon FV grigio
zamak - gray nylon FG

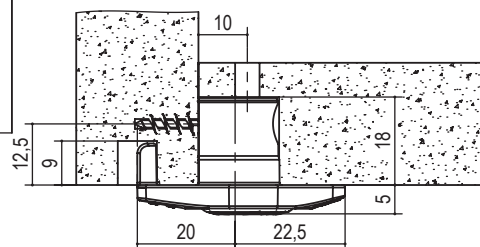
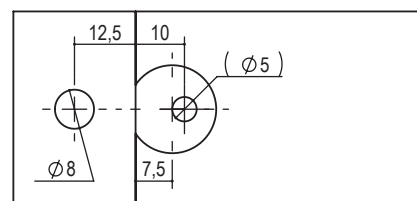
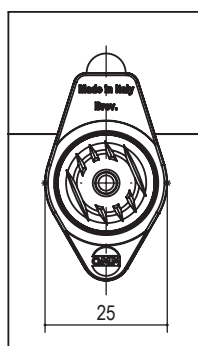

tipo type	misura measure	finitura finishing	box	kg / box
LV331.	05.	00 grezzo raw	500	20

es./e.g.: LV331.05.00



Livellatore - giunzione tipo LV351-LV352

Level adjuster - connecting fitting LV351 LV352 type

CATAS
Test Report 71525/1

LIVELLATORE-GIUNZIONE DA INCASSO PER BASE A TERRA REALIZZATO IN UN CORPO UNICO SVOLGE OLTRE A QUELLA DI LIVELLATORE LA FUNZIONE DI GIUNZIONE. OTTIMA PORTATA.

LEVEL ADJUSTER - BUILT-IN CONNECTING FITTING FOR GROUND BASE MADE OF A SINGLE BODY WITH A JOINING FUNCTION IN ADDITION TO THE LEVEL ADJUSTER ONE. EXCELLENT CAPACITY.



GN351

DA UTILIZZARE NEL CASO LE LAVORAZIONI DEL PANNELLO SUPERIORE E INFERIORI SONO UGUALI.

TO BE USED IF THE UPPER PANEL MACHINING IS EQUAL TO THAT OF THE BOTTOM PANEL.

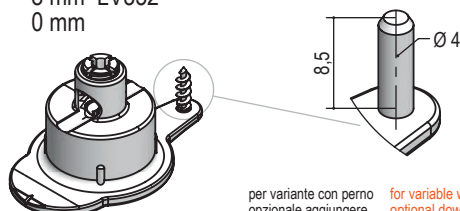

zama - acciaio
die-cast - steel

per variante con perno
opzionale aggiungere
lettera "S" nel codice.
es. LV351S.04.16.00

for variable with
optional dowel add the
letters "S" in the code.
e.g. LV351S.04.16.00

tipo type	misura measure	A	ØD	Ød	B	finitura finishing	box	kg / box
LV351.	04.14.	20	14	8	16,8	00 grezzo raw	300	24,9
	04.16.		16	10				
LV352.	04.14	17	14	8	13,8			
	04.16	17,5	16	10				

es./e.g.: LV351.04.14.00

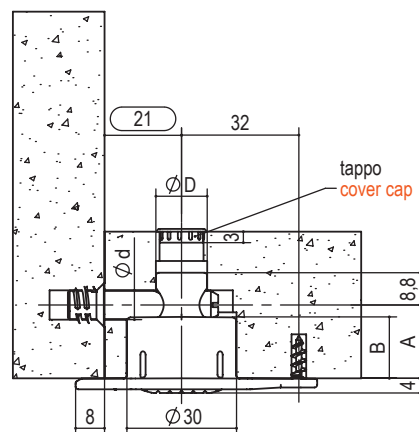
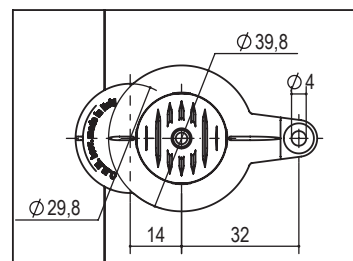

Livellatore - giunzione tipo LV355

Level adjuster - connecting fitting LV355 type



PER GRANO PREASSEMBLATO INSERIRE LETTERA "G" NEL CODICE.

WITH PRE-ASSEMBLED GRAIN, PLEASE ADD THE LETTER "G" TO THE ARTICLE CODE.

es./e.g.: LV351.G.04.14.00

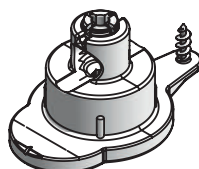
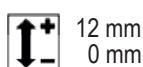

zama - acciaio
die-cast - steel

tipo type	misura measure	ØD	Ød	finitura finishing	box	kg / box
LV355.	07.16.	16	10	00 grezzo raw	300	27,6

es./e.g.: LV355.07.16.00

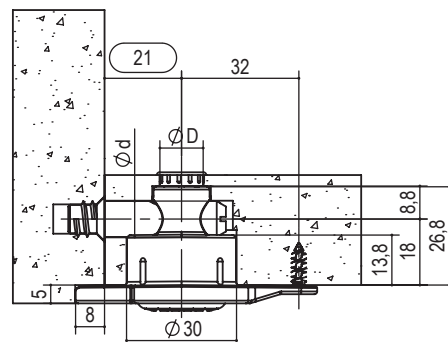
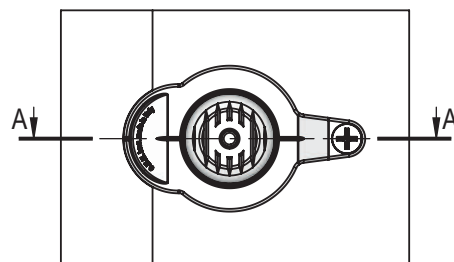



Livellatore - giunzione tipo LV354 Level adjuster - connecting fitting LV354 type

REALIZZATO IN UN CORPO UNICO SVOLGE OLTRE A QUELLA DI LIVELLATORE LA FUNZIONE DI GIUNZIONE.

MADE OF A SINGLE BODY WITH A JOINING FUNCTION IN ADDITION TO THE LEVEL ADJUSTER ONE.



PER GRANO PREASSEMBLATO INSERIRE LETTERA "G" NEL CODICE.

WITH PRE-ASSEMBLED GRAIN, PLEASE ADD THE LETTER "G" TO THE ARTICLE CODE.

es./e.g.: LV354.G.20.14.25.00



CODICE ARTICOLO.
ARTICLE CODE.
P.A456.25.55



CODICE ARTICOLO.
ARTICLE CODE.
P.A457.36.55



CODICE ARTICOLO.
ARTICLE CODE.
ST2121.L--



1500 N



8 mm
0 mm

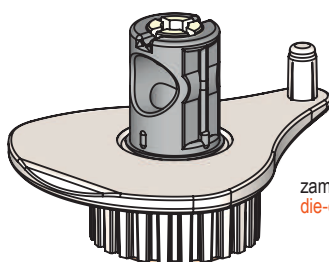

zama - acciaio
die-cast - steel

LIVELLATORE LEVEL ADJUSTERS	GIUNZIONE CONNECTING FITTINGS				
tipo type	serie series	finitura finishing	box	kg / box	pack
LV35420.	GN100	00 grizzo raw	200	23,5	10
	GN200	06 bronzato bronze			

es./e.g.: LV35420.CT881630.00

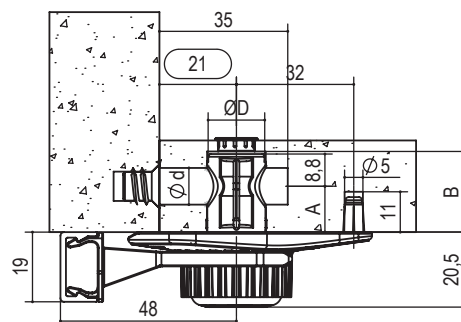
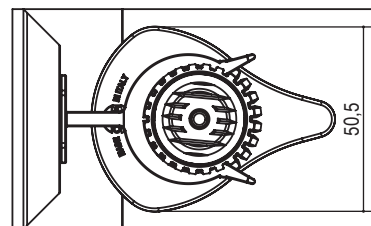

per "A" e "B" vedere giunzioni
for "A" and "B" see connecting fittings

Livellatore - giunzione tipo LV354.20.16.25 Level adjuster - connecting fitting LV354.20.16.25 type



1500 N

corsa maggiorata da 15 mm solo con GN100_16x25
longer stroke of 15 mm only with GN100_16x25



15 mm
0 mm

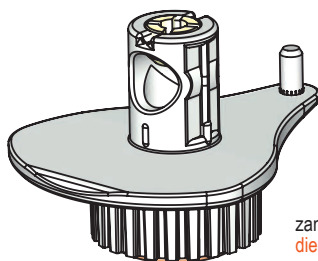

zama - acciaio
die-cast - steel

tipo type	finitura finishing	box	kg / box	pack
LV354.20.CT881625	00 grizzo raw 06 bronzato bronze	200	23,5	10

es./e.g.: LV354.20.CT881.25.00

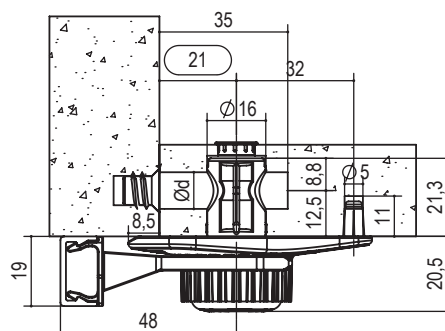
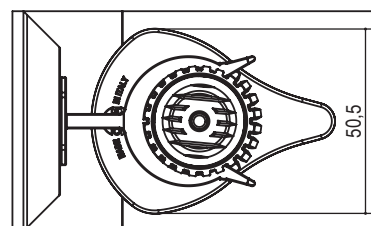



Livellatori Level adjusters

Serie LV500 LV500 Series

I LIVELLATORI DELLA SERIE LV500 SONO NORMALMENTE ASSEMBLATI SOTTO LA BASE.

CARATTERISTICHE FONDAMENTALI:
POSSIBILITA' DI ESSERE ASSEMBLATI CON LE GIUNZIONI DELLE SERIE GN100 E GN200.
IL PANNELLO INFERIORE PUO' ESSERE FORATO COME IL PANNELLO SUPERIORE.
ASPETTO ESTETICO IDENTICO SIA DELLA PARTE INFERIORE SIA SUPERIORE.
MINOR NUMERO DI LAVORAZIONI E DI PARTICOLARI DA ASSEMBLARE.
LA BASE DEL MOBILE PUO' SOPPORTARE CARICHI MAGGIORI.
POSSIBILITA' DI AGGANCIARE ACCESSORI AL LIVELLATORE TIPO PORTA ZOCCOLINI.
BASSA COPPIA DI REGOLAZIONE.

THE LV500 SERIES LEVEL ADJUSTERS ARE NORMALLY ASSEMBLED UNDER THE BASE.

KEY FEATURES: THEY CAN BE ASSEMBLED WITH GN100 AND GN200 SERIES CONNECTING FITTINGS.
THE BOTTOM PANEL CAN BE DRILLED AS THE TOP PANEL.
BOTH THE BOTTOM AND TOP HAVE IDENTICAL AESTHETIC APPEARANCE.
FEWER PROCESSING AND PARTS TO BE ASSEMBLED.
THE FURNITURE BASE CAN WITHSTAND GREATER LOADS.
ACCESSORIES LIKE SKIRTING BOARD HOLDERS CAN BE ATTACHED TO THE LEVEL ADJUSTER.
LOW ADJUSTMENT TORQUE.

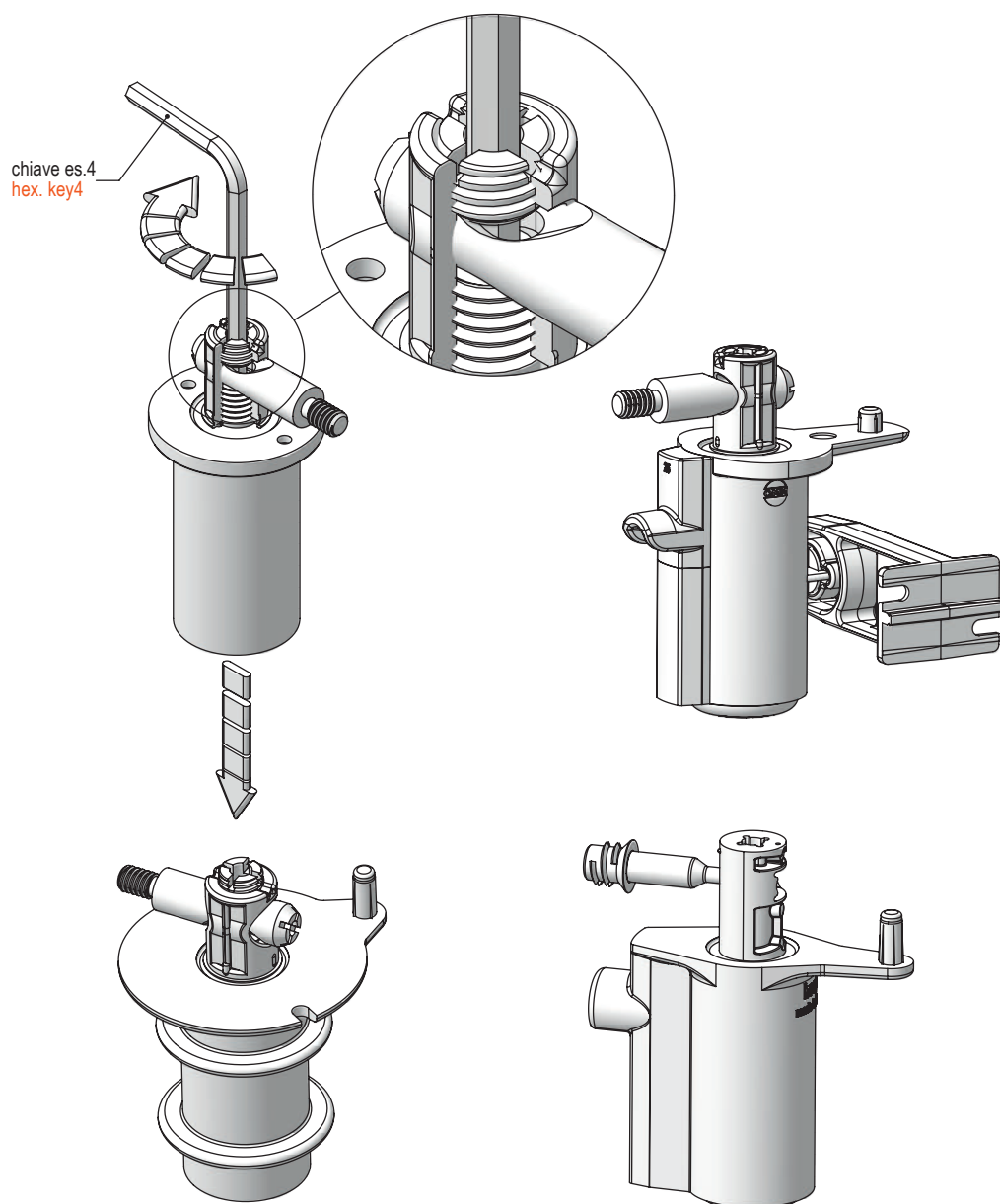



Esempi di applicazioni livellatori serie LV500

Application examples for levelers LV500 series

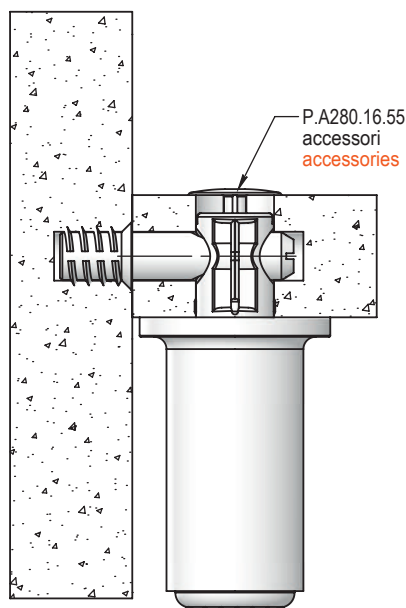

Livellatore tipo LV511
Leveler LV511 type

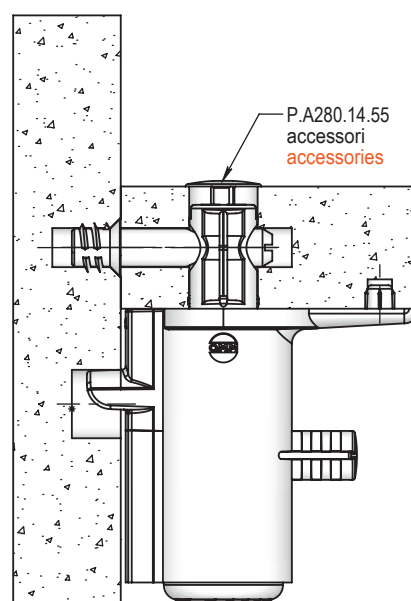

Livellatore tipo LV531
Leveler LV531 type

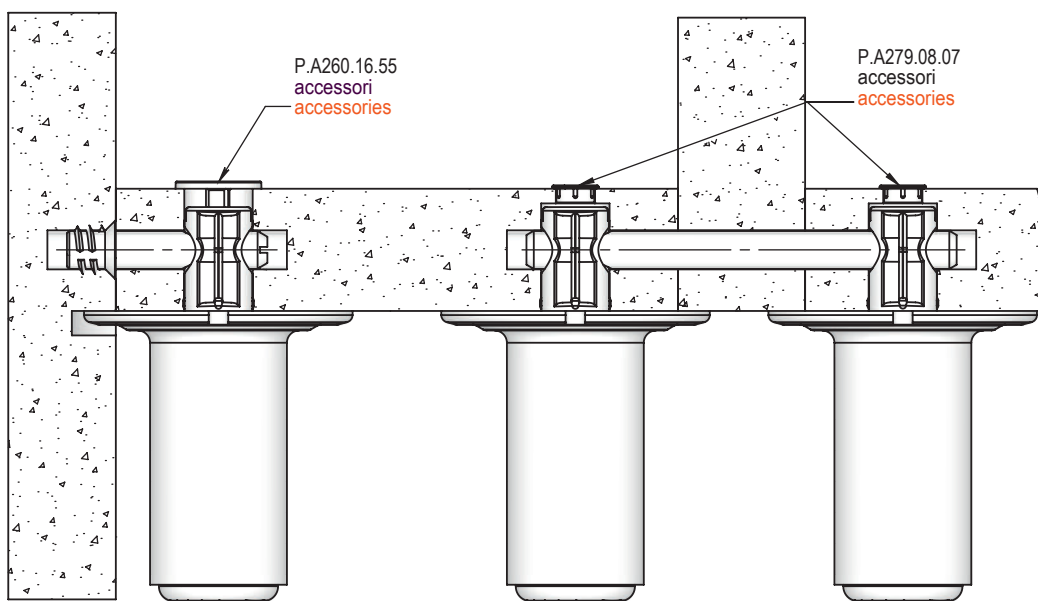

Livellatore tipo LV521
Leveler LV521 type



Schema assemblaggio livellatore tipo LV511

Assembly scheme LV511 type

LIVELLATORE
CARATTERIZZATO
DALL'ESSERE ASSEMBLATO
DIRETTAMENTE ALLA
GIUNZIONE SENZA
RICHIEDERE ULTERIORI
LAVORAZIONI SUI FIANCHI.

PER AVERE LA STESSA
LAVORAZIONE ED ESTETICA
INTERNA SIA SUL PIANO
INFERIORE SIA SUPERIORE
ASSEMBLARE LA BOCCOLA
SUL PIANO SUPERIORE CON
LA TESTA RIVOLTA VERSO
L'ALTO COME INDICATO NEL
DETTAGLIO "A".

THE LEVEL ADJUSTER CAN
BE ASSEMBLED DIRECTLY
TO THE CONNECTING
FITTING WITHOUT
ADDITIONAL MACHINING ON
THE SIDES.

IN ORDER TO HAVE THE
SAME MACHINING AND
INTERNAL AESTHETICS
BOTH ON THE UPPER AND
LOWER SURFACE,
ASSEMBLE THE BUSHING ON
THE UPPER SURFACE WITH
THE COLLAR POINTING
UPWARDS AS SHOWN IN
DETAIL "A".

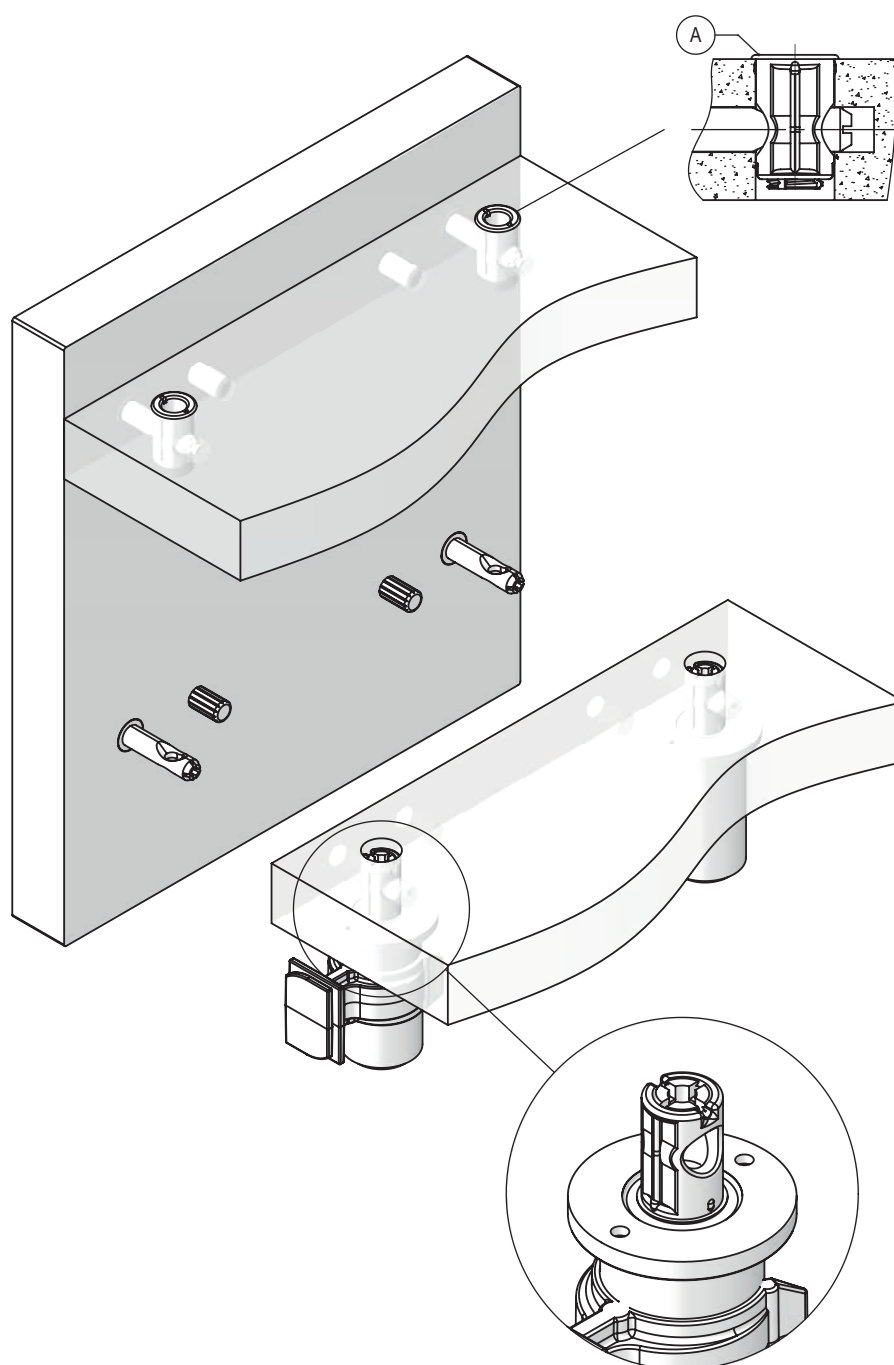



Esempi di applicazioni livellatore tipo LV511

Application example for leveler LV511 type

NON NECESSITANO DI
LAVORAZIONI DEI
FIANCHI.
E' UTILIZZATO ANCHE
COME SUPPORTO
CENTRALE PER
BASAMENTI DI
LARGHEZZA SUPERIORE
AL METRO.

SIDE MACHINING IS NOT
REQUIRED.
IT IS ALSO USED AS
CENTRAL SUPPORT FOR
BASES WITH WIDTH
EXCEEDING ONE METRE.

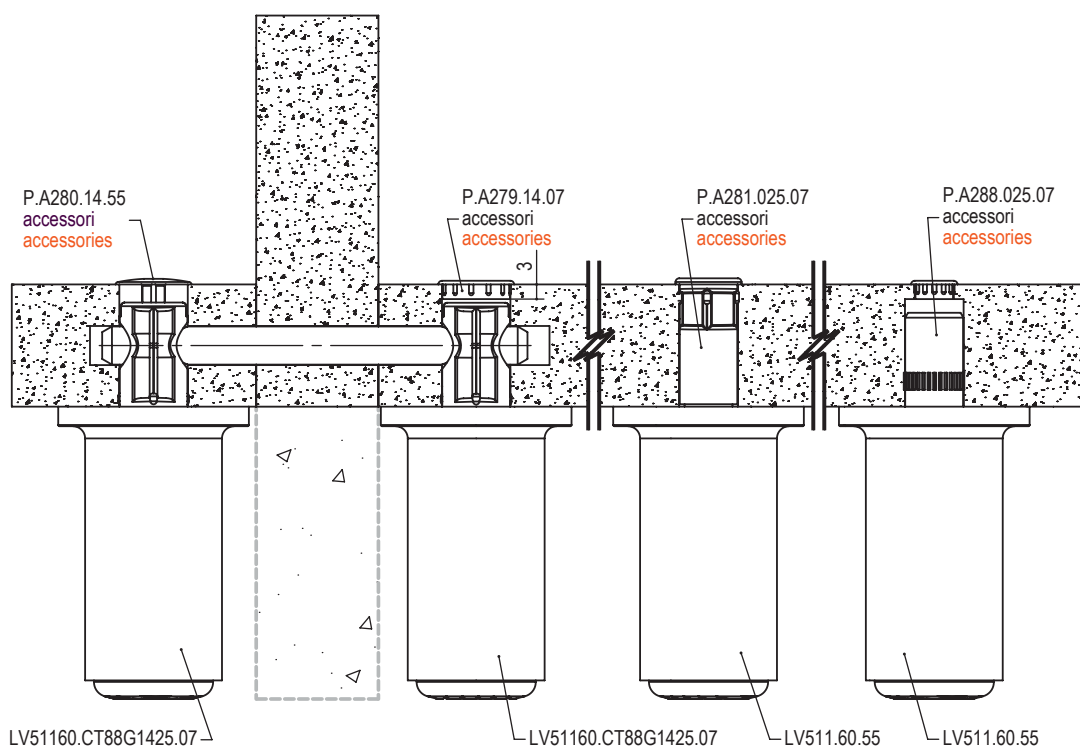
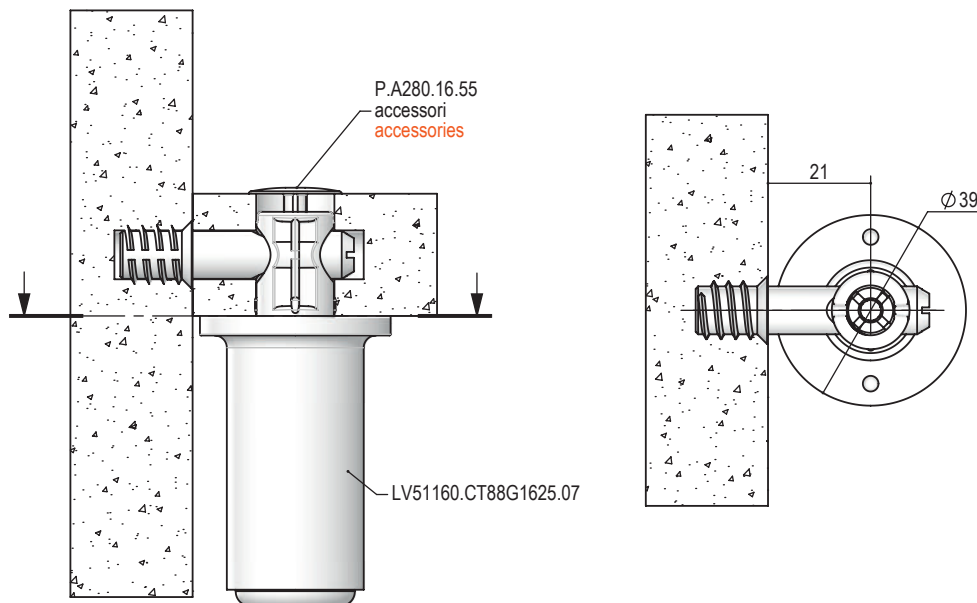



Livellatore tipo LV511 Level adjuster LV511 type



Test Report 31404/1 - 37178/1

LIVELLATORE SOTTO BASE.

LEVELER FOR BOTTOM
LOCATION



1500 N



15 mm
0 mm

nylon FV - acciaio
nylon FG - steel

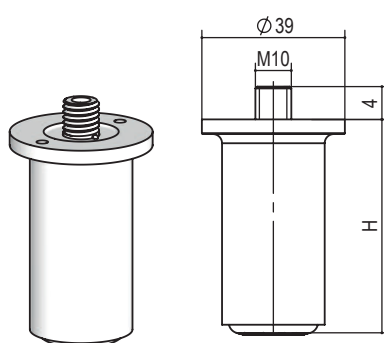

tipo type	misura measure	H	finitura finishing	box	kg / box	pack
LV511.	32.	32	55 grigio grey	500	20,5	10
	38.	38			22,0	
	50.	50			23,0	
	60.	60		400	21,5	
	70.	70			17,5	
	80.	80		300	17,0	
	90.	90			18,5	
	95.	95			13,6	
	100.	100			12,8	
	105.	105		200	14,5	
	115.	115			15,0	

es./e.g.: LV511.60.55

Livellatore tipo LV511 con giunzioni Level adjuster LV511 type with connecting fittings

LIVELLATORE SOTTO
BASE
PREASSEMBLATO CON
LE GIUNZIONI INDICATE
IN TABELLA SVOLGE SIA
LA FUNZIONE DI
LIVELLATORE SIA DI
GIUNZIONE.

THE SUB-BASE LEVEL
ADJUSTER PRE-
ASSEMBLED WITH THE
CONNECTING FITTINGS
INDICATED IN THE
TABLE ACTS BOTH AS
LEVEL ADJUSTER AND
AS CONNECTING
FITTING.



PER GRANO
PREASSEMBLATO
INSERIRE LETTERA "G"
NEL CODICE.

WITH PRE-ASSEMBLED
GRAIN, PLEASE ADD THE
LETTER "G" TO THE
ARTICLE CODE.

es./e.g.:
LV51160.CT88G1418.07



1500 N



15 mm
0 mm

nylon Fv - acciaio - zama
nylon FG - steel - die-cast

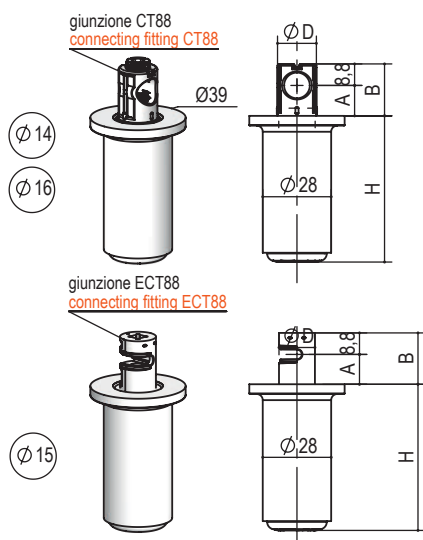

LIVELLATORE LEVEL ADJUSTER		GIUNZIONE CONNECTING FITTING					ASSIEME ASSEMBLY		
tipo type	H	tipo type	ØD	A	B	finitura finishing	box	kg / box	pack
LV51132.	32	CT881418.	13,9	9	17,8	00 grezzo raw 05 ottinato brass 06 bronzato bronzed 07 nichelata nickel	400	21,2	10
LV51138.	38	CT881420.		10	18,8			22,4	
LV51150.	50	CT881422.		11	19,8			23,2	
LV51160.	60	CT881425.	15,9	12,5	21,3		300	19,8	
LV51170.	70	CT881622.		11	19,8			21,0	
LV51180.	80	CT881625.	15	12,5	21,3		200	20,7	
LV51190.	90	CT881630.		15	23,3			21,9	
LV51195.	95	ECT881518.	14,7	9	17,8			16,0	
LV511100.	100	ECT881525.	14,7	12,5	21,3			15,2	
LV511105.	105	ECT881532.	14,7	16	24,8			16,8	
LV511115.	115							17,4	

es./e.g.: LV51160.CT881418.07
es./e.g.: LV51160.ECT881518.00



Schema assemblaggio livellatore tipo LV521

Assembly scheme LV521 type

LIVELLATORE
CARATTERIZZATO
DALL'ESSERE
ASSEMBLATO ALLA
GIUNZIONE.
SUPPORTA IL FIANCO
ESTERNO.
PARTICOLARMENTE
VANTAGGIOSO NEL CASO
IN CUI I FIANCHI INTERNI
NON VANNO A TERRA. IN
QUANTO NON SONO
NECESSARIE
LAVORAZIONI.

PER AVERE LA STESSA
LAVORAZIONE ED
ESTETICA INTERNA SIA
SUL PIANO INFERIORE SIA
SUPERIORE ASSEMBLARE
LA BOCCOLA SUL PIANO
SUPERIORE CON LA
TESTA RIVOLTA VERSO
L'ALTO COME INDICATO
NEL DETTAGLIO "A".

LEVEL ADJUSTER
CHARACTERISED BY
BEING ASSEMBLED TO
THE CONNECTING
FITTING.
IT SUPPORTS THE OUTER
SIDE.
IT IS PARTICULARLY
USEFUL IN CASES WHERE
THE INTERNAL SIDES DO
NOT GO ON THE GROUND
AS MACHINING IS NOT
REQUIRED.

IN ORDER TO HAVE THE
SAME MACHINING AND
INTERNAL AESTHETICS
BOTH ON THE UPPER AND
LOWER SURFACE,
ASSEMBLE THE BUSHING
ON THE UPPER SURFACE
WITH THE COLLAR
POINTING UPWARDS AS
SHOWN IN DETAIL "A".

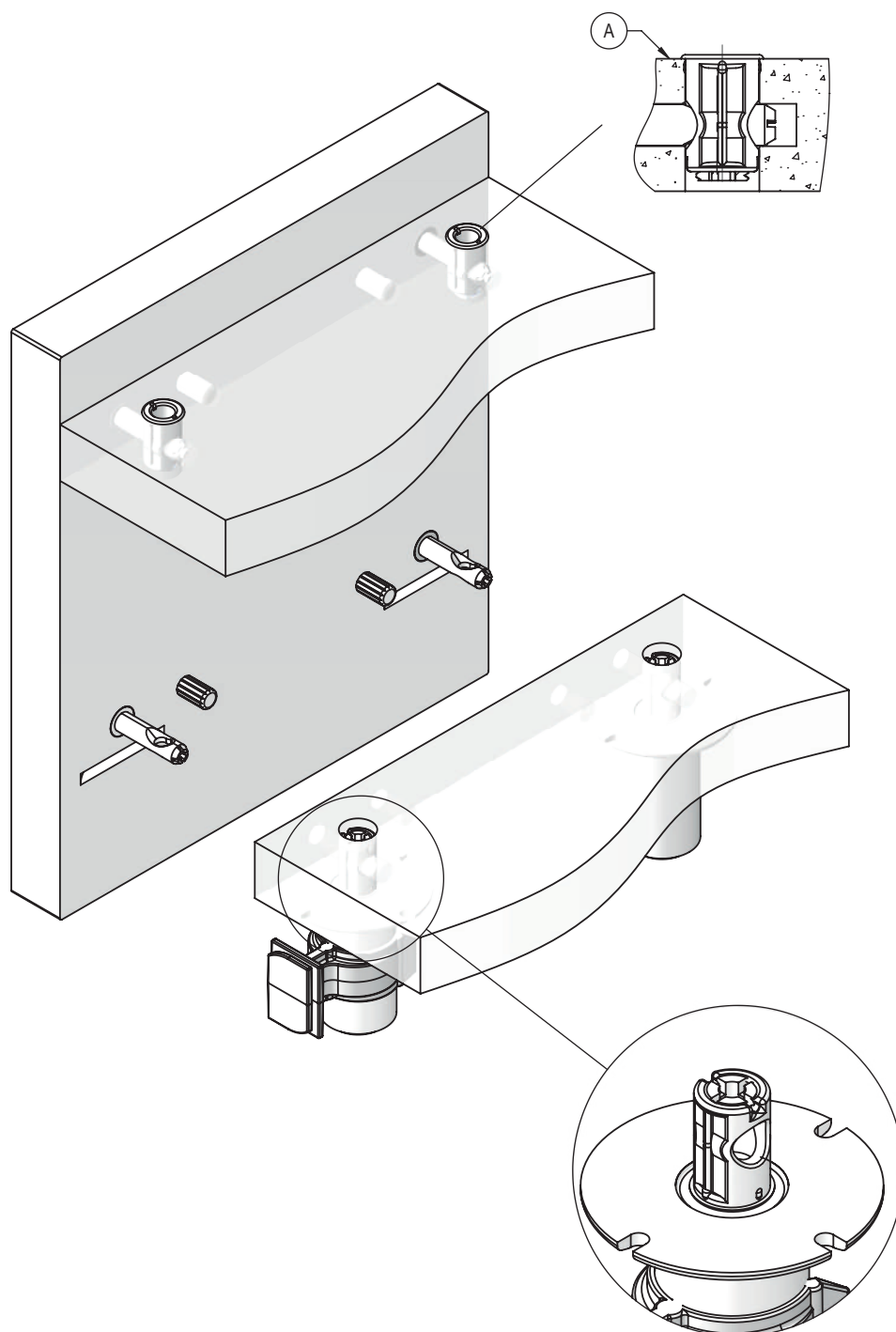



Esempi di applicazioni livellatore tipo LV521

Application example for leveler LV521 type

SUPPORTA IL FIANCO
ESTERNO,
PARTICOLARMENTE
VANTAGGIOSO NEL CASO
IN CUI I FIANCHI INTERNI
NON VANNO A TERRA, IN
QUANTO NON SONO
NECESSARIE
LAVORAZIONI.

IT SUPPORTS THE OUTER
SIDE.
IT IS PARTICULARLY
USEFUL IN CASES WHERE
THE INTERNAL SIDES DO
NOT GO ON THE GROUND
AS MACHINING IS NOT
REQUIRED.

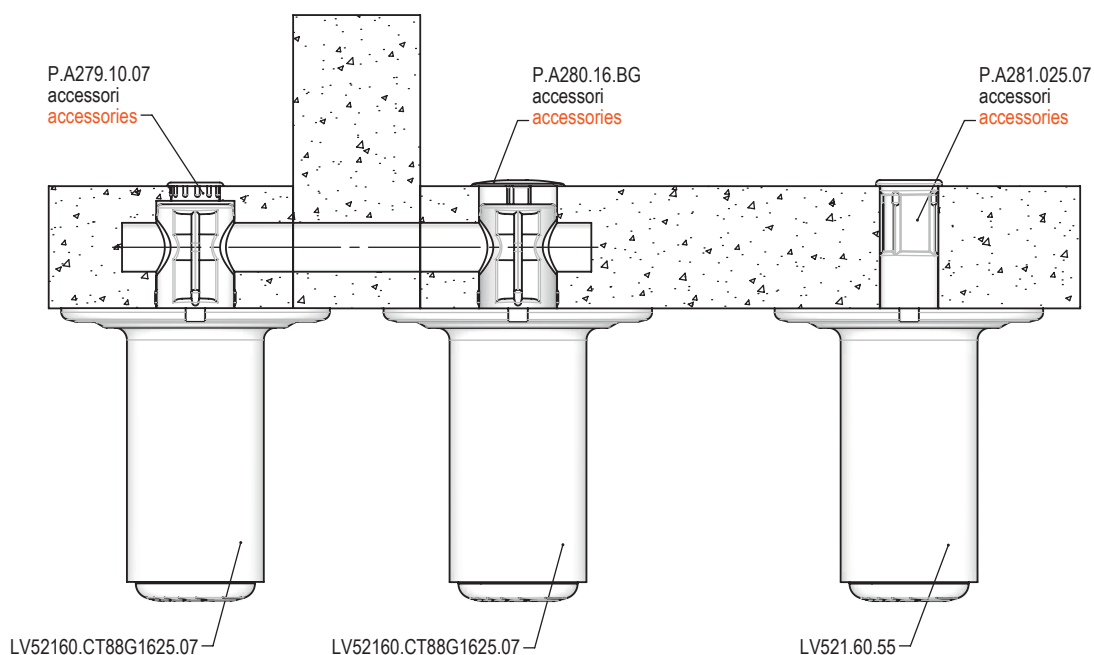
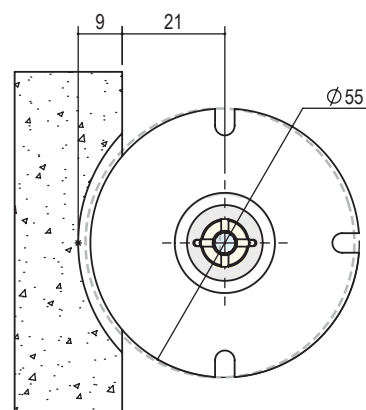
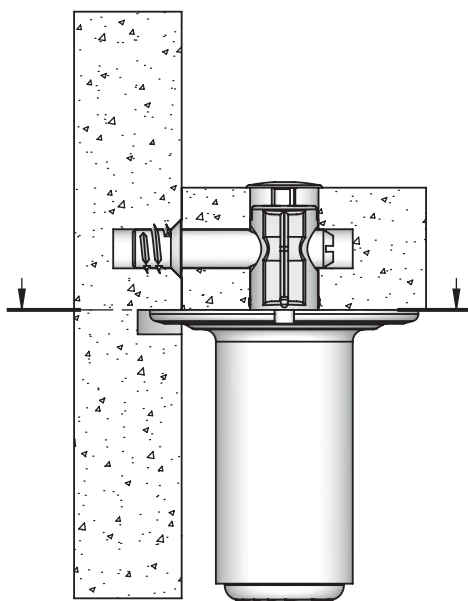



Livellatore tipo LV521 Level adjuster LV521 type



Test Report 34775/1S - 34778/1S

LIVELLATORE SOTTO
BASE LATO SPALLA .

LEVELER FOR BOTTOM
LOCATION OUTER SIDE.

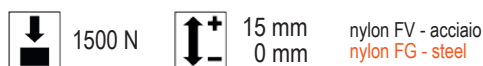

nylon FV - acciaio
nylon FG - steel

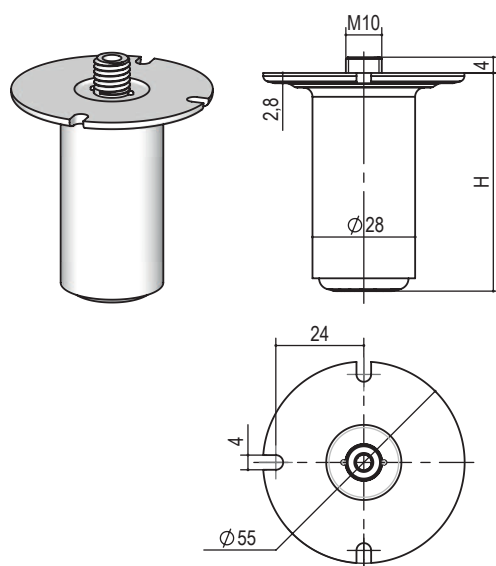

tipo type	misura measure	H	finitura finishing	box	kg / box	pack
LV521.	32.	32	55 grigio grey	500	23,0	10
	38.	38		400	19,2	
	50.	50			21,2	
	60.	60		300	17,4	
	70.	70			18,6	
	80.	80			19,8	
	90.	90		200	21,0	
	95.	95			14,2	
	100.	100			14,6	
	105.	105			15,0	
	115.	115			15,6	

es./e.g.: LV521.60.55

Livellatore tipo LV521 con giunzioni Level adjuster LV521 type with connecting fittings

LIVELLATORE SOTTO
BASE LATO SPALLA
PREASSEMBLATO CON LE
GIUNZIONI INDICATE IN
TABELLA SVOLGE SIA LA
FUNZIONE DI
LIVELLATORE SIA DI
GIUNZIONE.

THE SUB-BASE LEVEL
ADJUSTER OUTER SIDE
PRE-ASSEMBLED WITH
THE CONNECTING
FITTINGS INDICATED IN
THE TABLE ACTS BOTH AS
LEVEL ADJUSTER AND AS
CONNECTING FITTING.

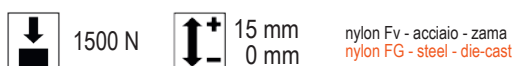

nylon Fv - acciaio - zama
nylon FG - steel - die-cast

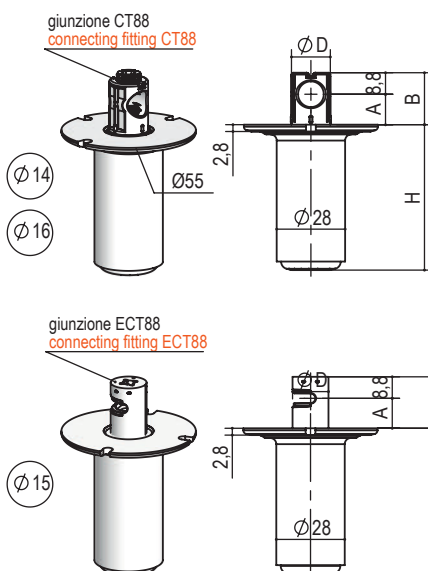

LIVELLATORE LEVEL ADJUSTER		GIUNZIONE CONNECTING FITTING					ASSIEME ASSEMBLY		
tipo type	H	tipo type	ØD	A	B	finitura finishing	box	kg / box	pack
LV52132.	32	CT881418.	9	17,8		00 grezzo raw 05 ottoneato brass 06 bronzato bronzed 07 nichelata nickel		23,2	
LV52138.	38	CT881420.	10	18,8			400	22,8	
LV52150.	50	CT881422.	13,9	11	19,8			24,8	
LV52160.	60	CT881425.	12,5	21,3			300	20,1	
LV52170.	70	CT881622.	11	19,8				22,2	
LV52180.	80	CT881625.	15,9	12,5	21,3			23,4	10
LV52190.	90	CT881630.	15	23,8				24,6	
LV52195.	95	ECT881518.	14,7	9	17,8		200	16,6	
LV521100.	100	ECT881525.	14,7	12,5	21,3			17,0	
LV521105.	105	ECT881532.	14,7	16	24,8			17,4	
LV521115.	115							18,0	

es./e.g.: LV52160.CT881425.00
es./e.g.: LV52160.ECT881518.07



PER GRANO
PREASSEMBLATO
INSERIRE LETTERA "G"
NEL CODICE.
WITH PRE-ASSEMBLED
GRAIN, PLEASE ADD THE
LETTER "G" TO THE
ARTICLE CODE.
es./e.g.:
LV52160.CT88G1418.07

www.omm.name
omm@omm.name
tel. 0362.622377



Schema assemblaggio livellatore tipo LV523

Assembly scheme LV523 type

LIVELLATORE
CARATTERIZZATO
DALL'ESSERE ASSEMBLATO
ALLA GIUNZIONE.
SUPPORTA IL FIANCO
ESTERNO.
PARTICOLARMENTE
VANTAGGIOSO NEL CASO
IN CUI I FIANCHI INTERNI
NON VANNO A TERRA. IN
QUANTO NON SONO
NECESSARIE LAVORAZIONI.

PER AVERE LA STESSA
LAVORAZIONE ED
ESTETICA INTERNA SIA SUL
PIANO INFERIORE SIA
SUPERIORE ASSEMBLARE
LA BOCCOLA SUL PIANO
SUPERIORE CON LA TESTA
RIVOLTA VERSO L'ALTO
COME INDICATO NEL
DETTAGLIO "A".

LEVEL ADJUSTER
CHARACTERISED BY BEING
ASSEMBLED TO THE
CONNECTING FITTING.
IT SUPPORTS THE OUTER
SIDE.
IT IS PARTICULARLY
USEFUL IN CASES WHERE
THE INTERNAL SIDES DO
NOT GO ON THE GROUND
AS MACHINING IS NOT
REQUIRED.

IN ORDER TO HAVE THE
SAME MACHINING AND
INTERNAL AESTHETICS
BOTH ON THE UPPER AND
LOWER SURFACE,
ASSEMBLE THE BUSHING
ON THE UPPER SURFACE
WITH THE COLLAR
POINTING UPWARDS AS
SHOWN IN DETAIL "A".

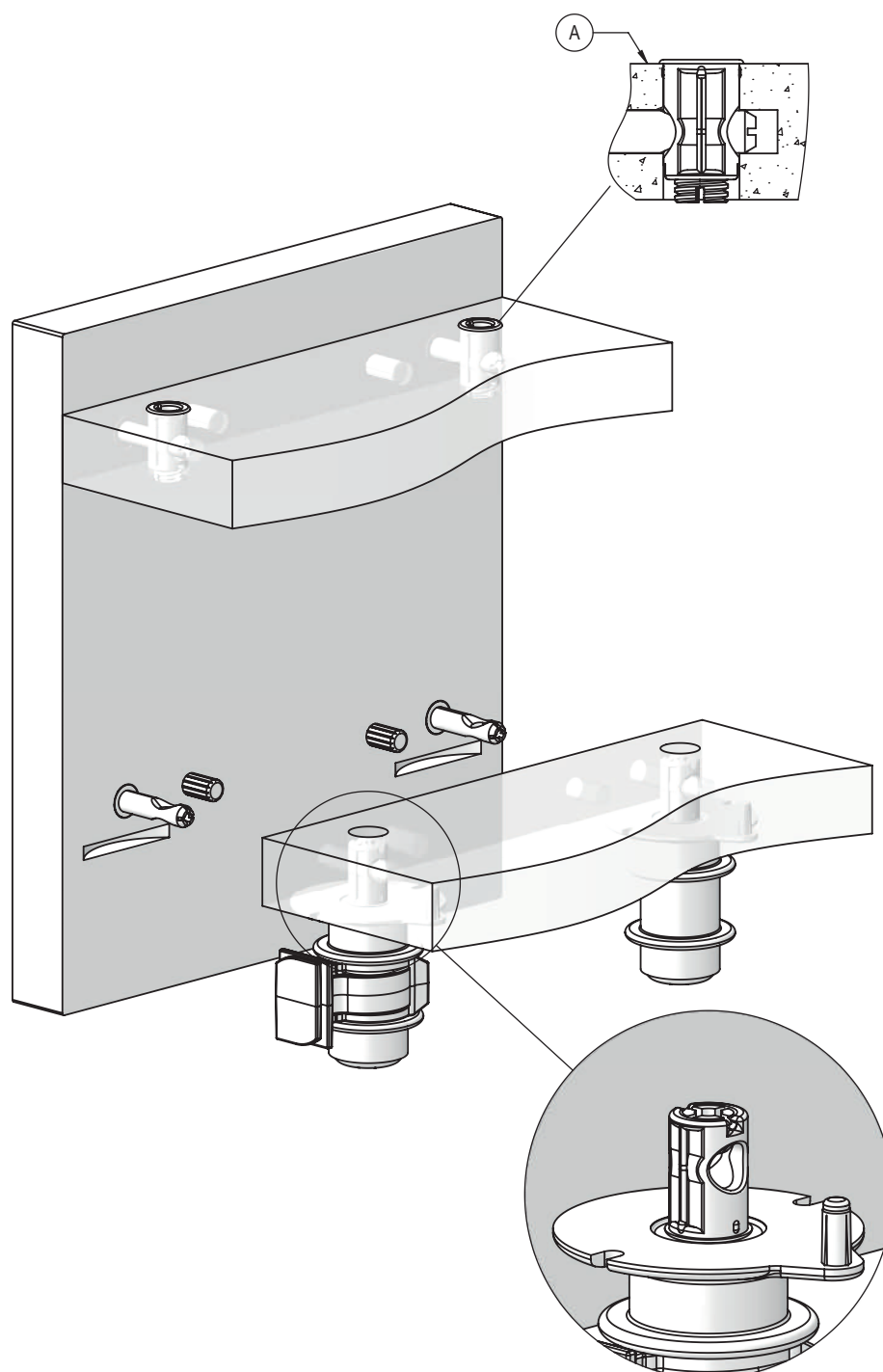



Esempi di applicazioni livellatore tipo LV523

Application example for leveler LV523 type

SUPPORTA IL FIANCO
ESTERNO.
PARTICOLARMENTE
VANTAGGIOSO NEL CASO
IN CUI I FIANCHI INTERNI
NON VANNO A TERRA, IN
QUANTO NON SONO
NECESSARIE LAVORAZIONI.

IT SUPPORTS THE OUTER
SIDE.
IT IS PARTICULARLY
USEFUL IN CASES WHERE
THE INTERNAL SIDES DO
NOT GO ON THE GROUND
AS MACHINING IS NOT
REQUIRED.

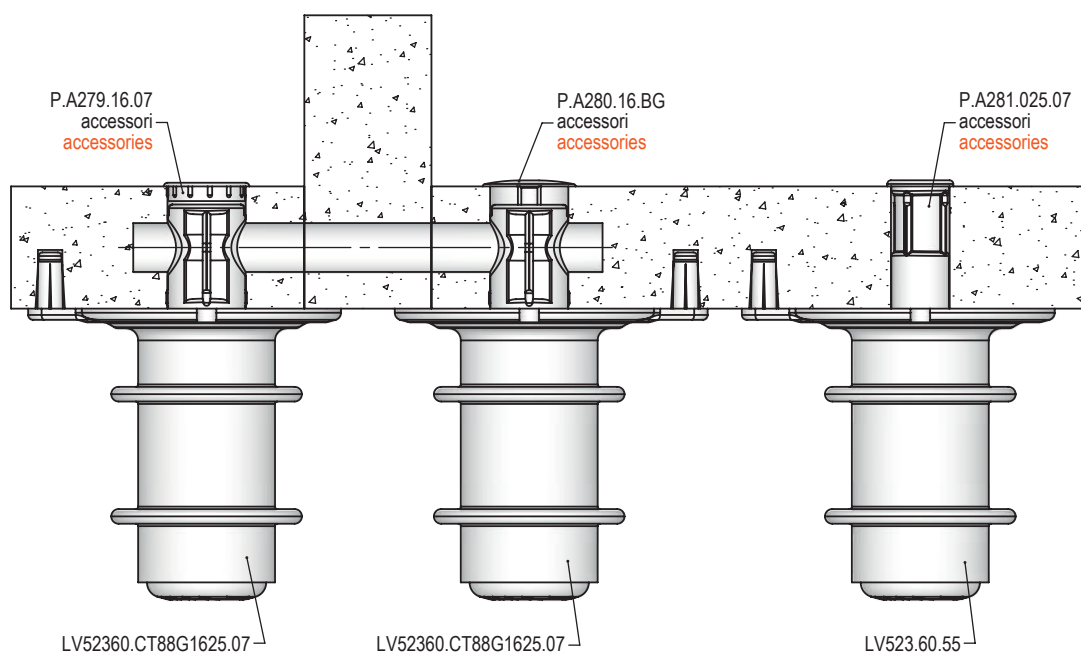
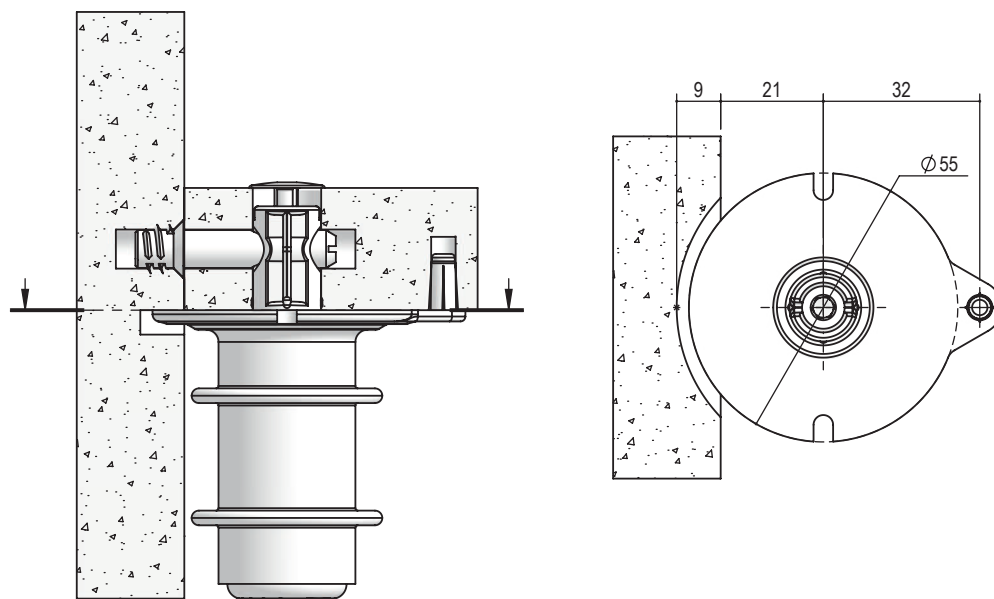



Schema assemblaggio livellatore tipo LV531 LV532 LV534 Assembly scheme LV531 LV532 LV534 type

LIVELLATORE
CARATTERIZZATO
DALL'ESSERE
ASSEMBLATO ALLA
GIUNZIONE.
PROGETTATO PER
SUPPORTARE IL FIANCO.
TIPICAMENTE USATO PER
MOBILI componibili.

PER AVERE LA STESSA
LAVORAZIONE ED
ESTETICA INTERNA SIA SUL
PIANO INFERIORE SIA
SUPERIORE ASSEMBLARE
LA BOCCOLA SUL PIANO
SUPERIORE CON LA TESTA
RIVOLTA VERSO L'ALTO
COME INDICATO NEL
DETTAGLIO "A".

LEVEL ADJUSTER
CHARACTERISED BY BEING
ASSEMBLED TO THE
CONNECTING FITTING.
DESIGNED TO SUPPORT
THE SIDE.
TYPICALLY USED FOR
MODULAR FURNITURE.

IN ORDER TO HAVE THE
SAME MACHINING AND
INTERNAL AESTHETICS
BOTH ON THE UPPER AND
LOWER SURFACE,
ASSEMBLE THE BUSHING
ON THE UPPER SURFACE
WITH THE COLLAR
POINTING UPWARDS AS
SHOWN IN DETAIL "A".

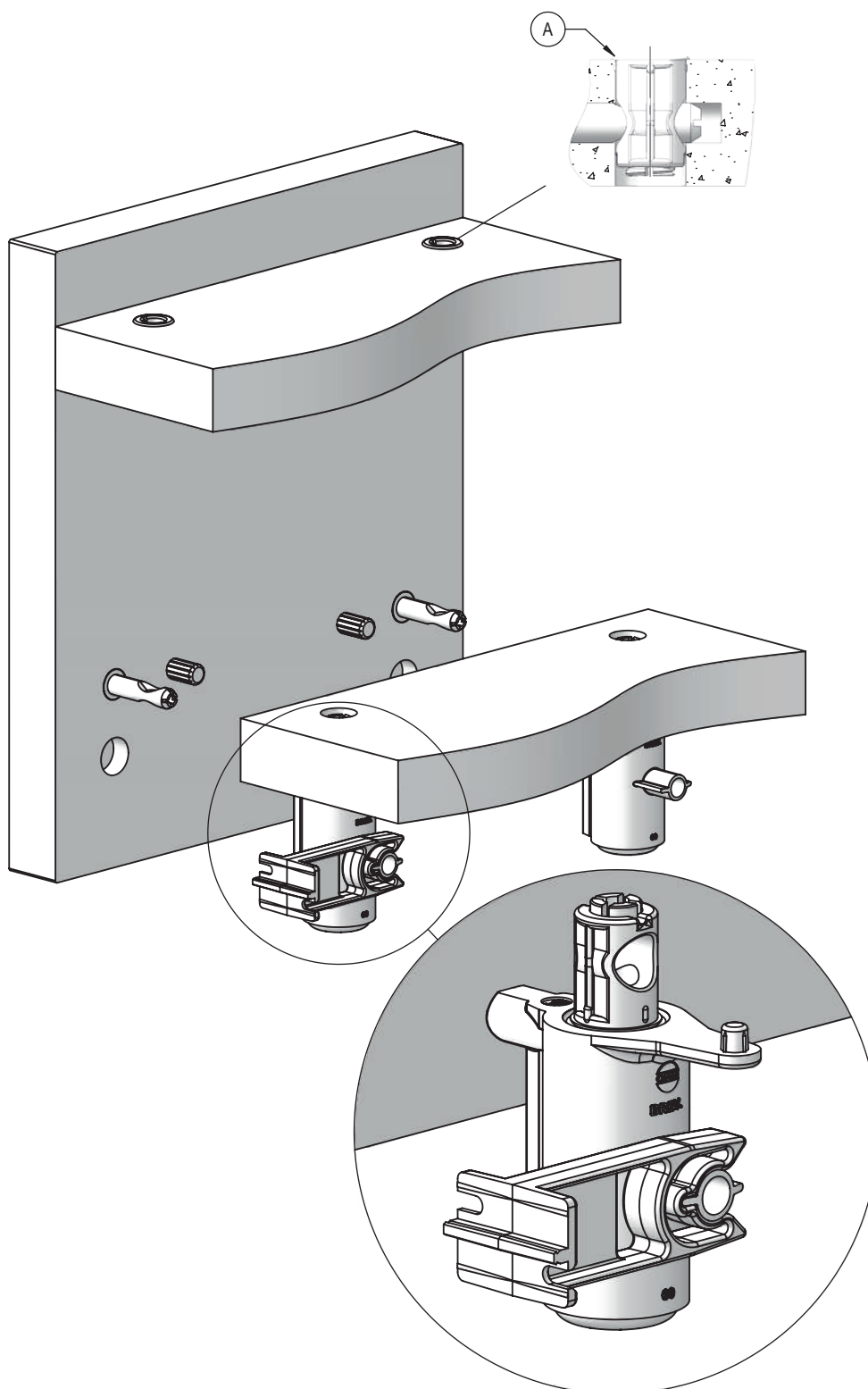



Esempi di applicazioni livellatore tipo LV531 LV532 LV534 Application example for leveler LV531 LV532 LV534 type

LV532 E' TIPICAMENTE
USATO PER MOBILI
COMPONIBILI CON TUTTI
I FIANCHI A TERRA.
LV534 E' L'IDEALE
QUANDO SI HANNO
COMBINAZIONI DI
FIANCHI A TERRA E
SOSPESI.

LV532 TYPICALLY USED
FOR KIT FURNITURE
WITH SIDES TO THE
GROUND.

LV534 CAN BE USED IN
CASE OF COMBINATION
OF SUSPENDED AND TO
THE GROUND SIDES.

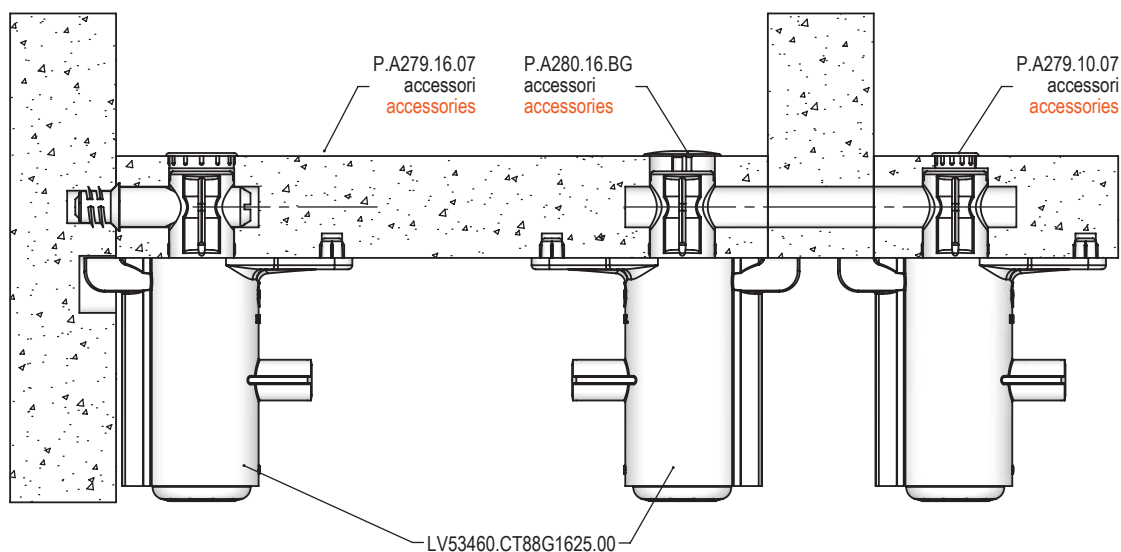
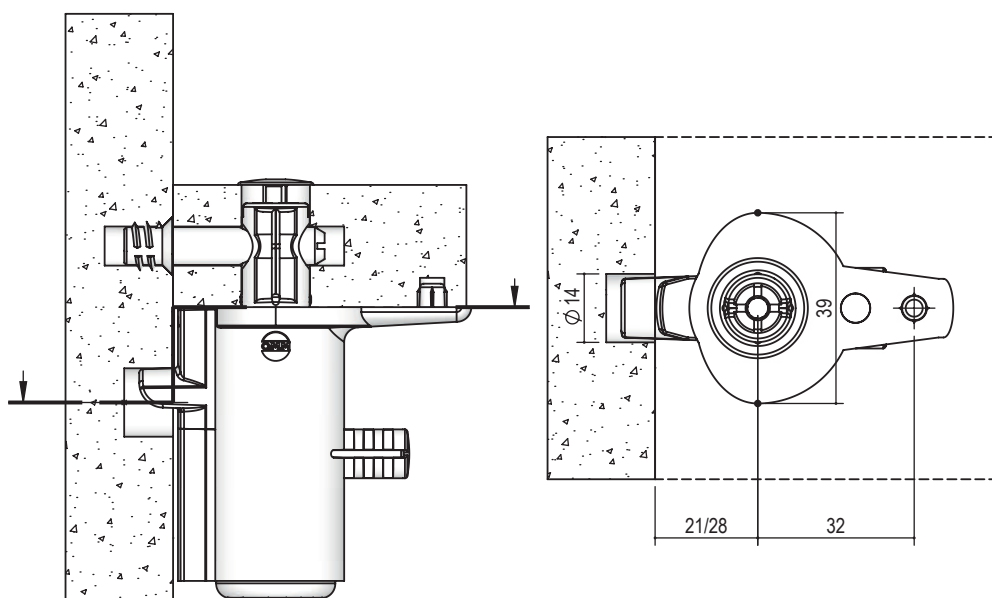



Livellatore tipo LV532 con giunzioni Level adjuster LV532 type with connecting fittings

CATAS
Test report 84204/1



1500 N



15 mm 8 mm solo per LV53218
0 mm 0 mm only for LV53218

nylon Fv - acciaio - zama
nylon FG - steel - die-cast

LIVELLATORE SOTTO
BASE LATO SPALLA
PREASSEMBLATO CON
LE GIUNZIONI INDICATE
IN TABELLA. SVOLGE SIA
LA FUNZIONE DI
LIVELLATORE SIA DI
GIUNZIONE.
FORATURA DELLA BASE
Distanza 28.

THE SUB-BASE LEVEL
ADJUSTER OUTER SIDE
PRE-ASSEMBLED WITH
THE CONNECTING
FITTINGS INDICATED IN
THE TABLE ACTS BOTH
AS LEVEL ADJUSTER
AND AS CONNECTING
FITTING.
DRILLING BASE
DISTANCE 28.



PER GRANO
PREASSEMBLATO
INSERIRE LETTERA "G"
NEL CODICE.
WITH PRE-ASSEMBLED
GRAIN, PLEASE ADD THE
LETTER "G" TO THE
ARTICLE CODE.

es./e.g.:
LV53160.CT88G1418.07

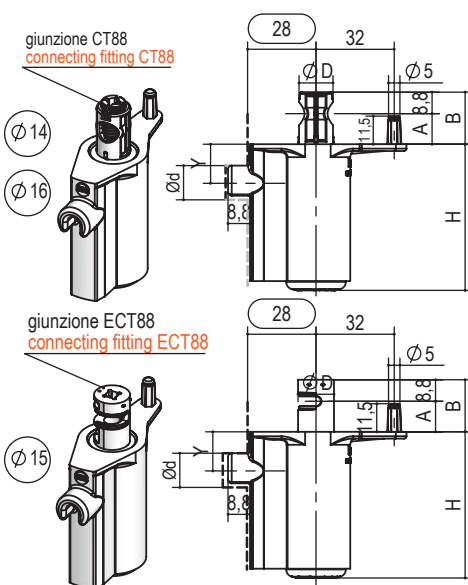

LIVELLATORE LEVEL ADJUSTER				GIUNZIONE CONNECTING FITTING						ASSIEME ASSEMBLY		
tipo type	H	Y	Ød	tipo type	ØD	A	B	finitura finishing	box	kg / box	pac	
LV53218.	18	7	10	CT881418.		9	17,8		500	23,0	10	
LV53232.	32			CT881420.		10	18,8			28,0		
LV53242.	42			CT881422.	13,9	11	19,8		18,0			
LV53252.	52			CT881425.		12,5	21,3		300	18,9		
LV53260.	60			CT881428.		14	22,8	00 grezzo raw		21,6		
LV53270.	70	16	15	CT881622.		11	19,8	05 ottinato brass		15,2		
LV53280.	80			CT881625.	15,9	12,5	21,3	06 bronzato bronzed	200			
				CT881630.		15	23,8	07 nichelata nickel		15,8		
				ECT881518.	14,7	9	17,8					
				ECT881525.	14,7	12,5	21,3					
				ECT881532.	14,7	16	24,8					

es./e.g.: LV53260.CT88 1425.00
es./e.g.: LV53260.ECT881518.07

Livellatore tipo LV534 con giunzioni Level adjuster LV534 type with connecting fittings

CATAS
Test report 84204/1



1500 N

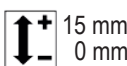

15 mm 0 mm nylon Fv - acciaio - zama
nylon FG - steel - die-cast

CARATTERIZZATO DALLA FORATURA DELLA
BASE DISTANZA 21.

CHARACTERIZED BY DRILLING BASE
DISTANCE 21.

ACCESSORI
ACCESSORIES

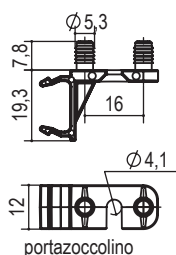

portazoccolino
hook for aluminum plinth
cod: P.A549.16.55

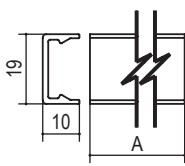

zoccolino
aluminum plinth
cod: STZ121.A.00

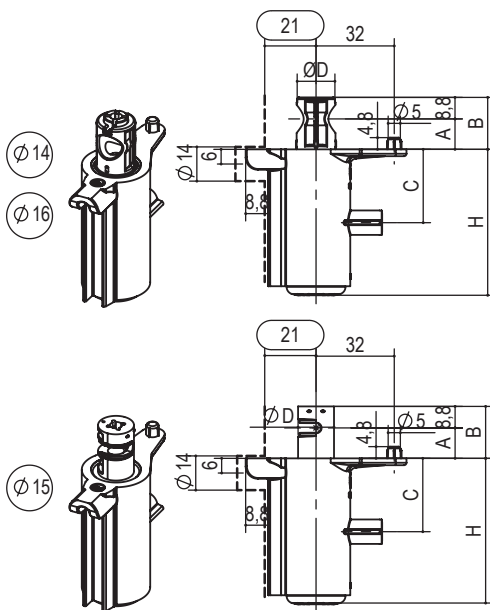

LIVELLATORE LEVEL ADJUSTER			GIUNZIONE CONNECTING FITTING						ASSIEME ASSEMBLY		
tipo type	H	tipo type	ØD	A	B	C	finitura finishing	box	kg / box	pack	
LV53418.	20	CT881418.	13,9	9	17,8	16	00 grezzo raw 05 ottinato brass 06 bronzato bronzed 07 nichelata nickel	500	20	10	
LV53432.	32	CT881418.		9	17,8	16		400	22,4		
LV53442.	42	CT881420.		10	18,8	21			18,0		
LV53452.	52	CT881422.		11	19,8			300	18,9		
LV53460.	60	CT881425.		12,5	21,3			19,8			
LV53470.	70	CT881428.		14	22,8	30		14,0			
LV53480.	80	CT881622.		11	19,8		200				
		CT881625.	15,9	12,5	21,3			14,6			
		CT881630.		15	23,8						
		ECT881518.	14,7	9	17,8						
		ECT881525.	14,7	12,5	21,3						
		ECT881532.	14,7	16	24,8						

es./e.g.: LV53460.CT881425.00
es./e.g.: LV53460.ECT881518.07



Livellatori Level adjusters

I LIVELLATORI DELLA SERIE LV600 SONO NORMALMENTE ASSEMBLATI SUI FIANCHI.

CARATTERISTICHE FONDAMENTALI:
POSSONO ESSERE POSTI SOTTO LE GIUNZIONI DELLA SERIE GN300.
POSSIBILITA' DI REGOLAZIONE ATTRAVERSO LE GIUNZIONI DELLA SERIE GN300.
POSSIBILITA' DI AGGANCIARE ACCESSORI TIPO PORTA ZOCCOLINI.
BASSA COPPIA DI REGOLAZIONE.

LV600 SERIES LEVEL ADJUSTERS ARE NORMALLY ASSEMBLED ON SIDES.

KEY FEATURES: CAN BE PLACED UNDER THE GN300 SERIES CONNECTING FITTINGS.
CAN BE ADJUSTED THROUGH THE CONNECTING FITTINGS OF THE GN300 SERIES.

ACCESSORIES LIKE SKIRTING BOARD HOLDERS CAN BE ATTACHED.
LOW ADJUSTMENT TORQUE.

Serie LV600 LV 600 series

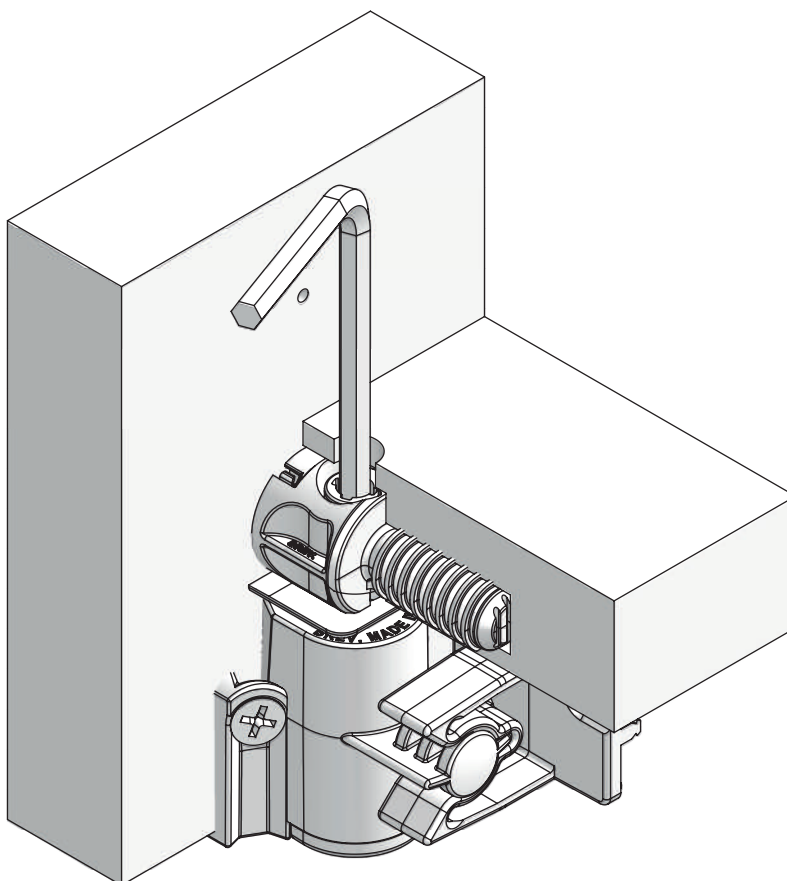



Livellatore tipo LV601

Level adjuster LV601 type

LIVELLATORE SOTTO
BASE LATO SPALLA.
SUPPORTA IL FIANCO
ESTERNO CON
FORATURA VITI TS4.

LEVEL ADJUSTER
UNDER BASE ON THE
SIDE.
SUPPORTS THE OUTER
SIDE WITH TS4 SCREWS
DRILLING.



1500 N



15 mm
0 mm

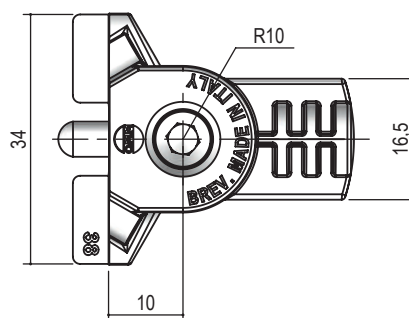
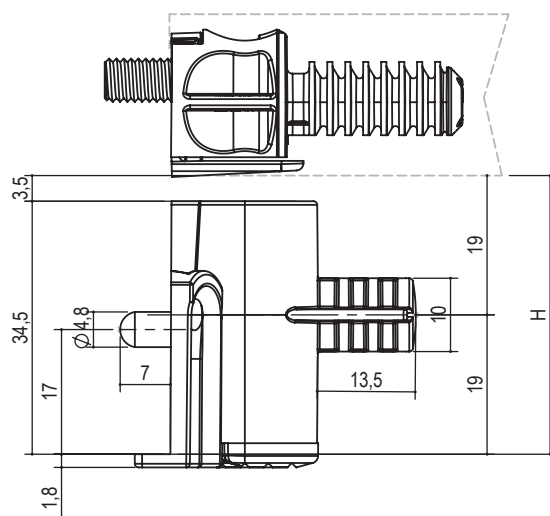
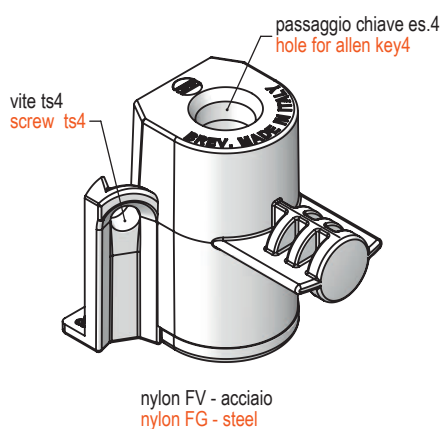

tipo	misura		finitura			
<u>type</u>	<u>measure</u>	H	<u>finishing</u>	box	kg / box	pack
LV601.	38.	38	55 grigio grey	500	25	10

es./e.g.: LV601.38.55



Livellatori Level adjusters

I LIVELLATORI DELLA SERIE LV900 SONO NORMALMENTE ASSEMBLATI SOTTO LA BASE.

CARATTERISTICHE FONDAMENTALI:
LA BASE A TERRA RIMANE FERMA DURANTE LA REGOLAZIONE.
DUE POSSIBILI REGOLAZIONI, CON CHIAVE ES.4 SOPRA E SOTTO.

THE LV900 SERIES LEVEL ADJUSTERS ARE NORMALLY ASSEMBLED UNDER THE BASE.

KEY FEATURES: THE BASE ON THE GROUND REMAINS STILL DURING ADJUSTMENT.
TWO POSSIBLE ADJUSTMENTS, WITH ALLEN KEY 4 UP AND DOWN.

Serie LV900 LV900 series

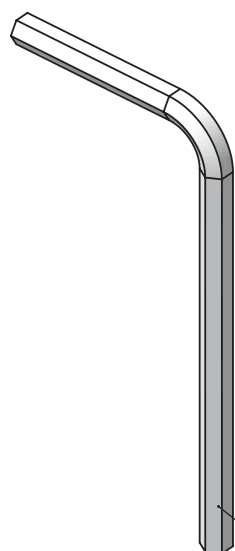

chiave es.4
hex. key4

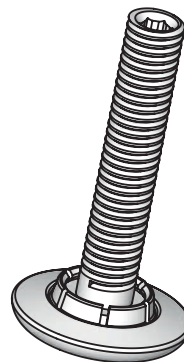
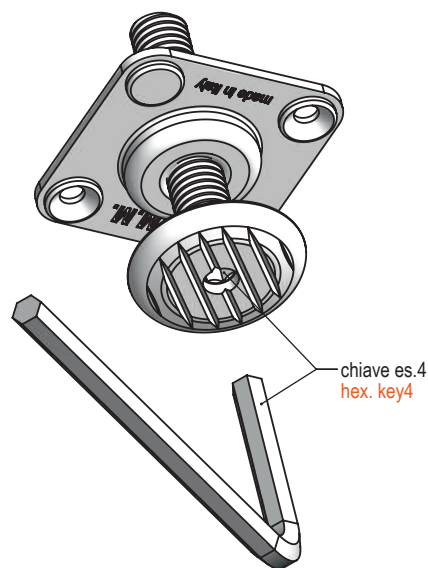
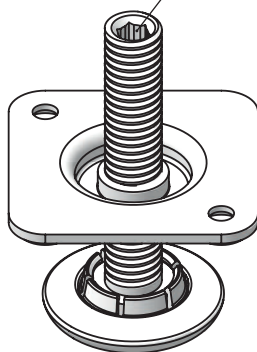



Livellatore tipo LV901 LV902 Level adjuster LV901 LV902 type

CATAS
Test Report 84580/1

LIVELLATORE SOTTO
BASE.

LEVEL ADJUSTER
ASSEMBLED UNDER THE
BASE



1500 N



25/35 mm
0 mm

acciaio - nylon FV grigio
steel - nylon FG grey

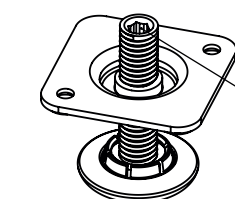

LV901

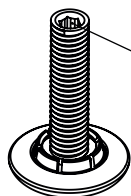

LV902

chiave es. 4
allen key 4

chiave es. 4
allen key 4

chiave es. 4
allen key 4

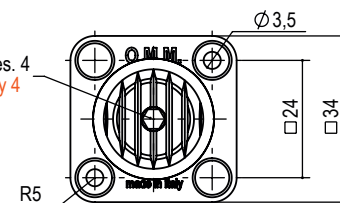
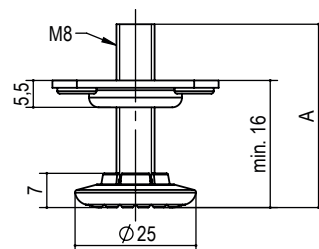

tipo type	misura measure	A	finitura finishing	box	kg / box	pack
LV901.	37,5	37,5	02 zincato bianco white zinc	500	12,8	10
LV902.	47,5	47,5			14,5	

es./e.g.: LV901.37,5.02

Livellatore tipo LV911 Level adjuster LV911



1500 N



15 mm
0 mm

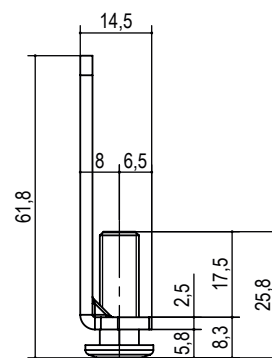
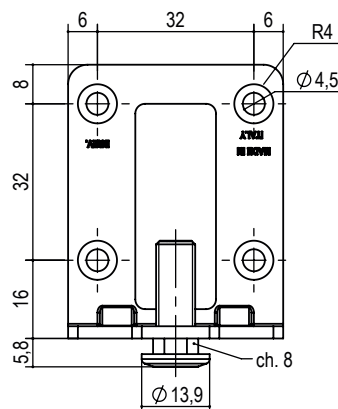
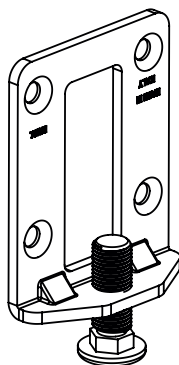

tipo type	misura measure	finitura finishing	box	kg / box	pack
LV911.	26.	02 zincato bianco white zinc	500	12,8	10

es./e.g.: LV911.26.02



Livellatori regolabili frontalmente serie LV1020 Frontal adjustment leveler LV1020 series

Serie LV1020 LV1020 Series

I LIVELLATORI DELLA SERIE LV1020 SONO NORMALMENTE ASSEMBLATI SOTTO LA BASE E SUPPORTANO IL FIANCO.

CARATTERISTICHE FONDAMENTALI:
I LIVELLATORI ANTERIORE E POSTERIORE POSSONO ESSERE REGOLATI FRONTALMENTE IN MODO INDIPENDENTE. IL PIANO RISULTA ESSERE ESENTE DA FORI VERTICALI IN VISTA PER LA REGOLAZIONE OFFRENDO VANTAGGIO ESTETICO. POSSIBILITA' DI REGOLAZIONE LIVELLATORI DISLOCATI IN AREE DI DIFFICILE ACCESSO. OTTIMA PORTATA SUL PIANO. POSSIBILITA' DI AGGANCIARE ACCESSORI AL LIVELLATORE TIPO PORTA ZOCCOLINI.

THE LV1020 SERIES LEVEL ADJUSTERS ARE NORMALLY ASSEMBLED UNDER THE BASE, IT SUPPORTS THE OUTER SIDE.

KEY FEATURES: FRONT AND REAR LEVEL ADJUSTERS CAN BE ADJUSTED INDEPENDENTLY FROM THE FRONT. THE SURFACE APPEARS TO BE FREE OF VERTICAL HOLES FOR ADJUSTMENT WITHIN SIGHT, OFFERING AN AESTHETIC ADVANTAGE. POSSIBILITY TO ADJUST LEVEL ADJUSTERS LOCATED IN AREAS DIFFICULT TO ACCESS. EXCELLENT CAPACITY ON THE SHELF. ACCESSORIES LIKE SKIRTING BOARD HOLDERS CAN BE ATTACHED TO THE LEVEL ADJUSTER.

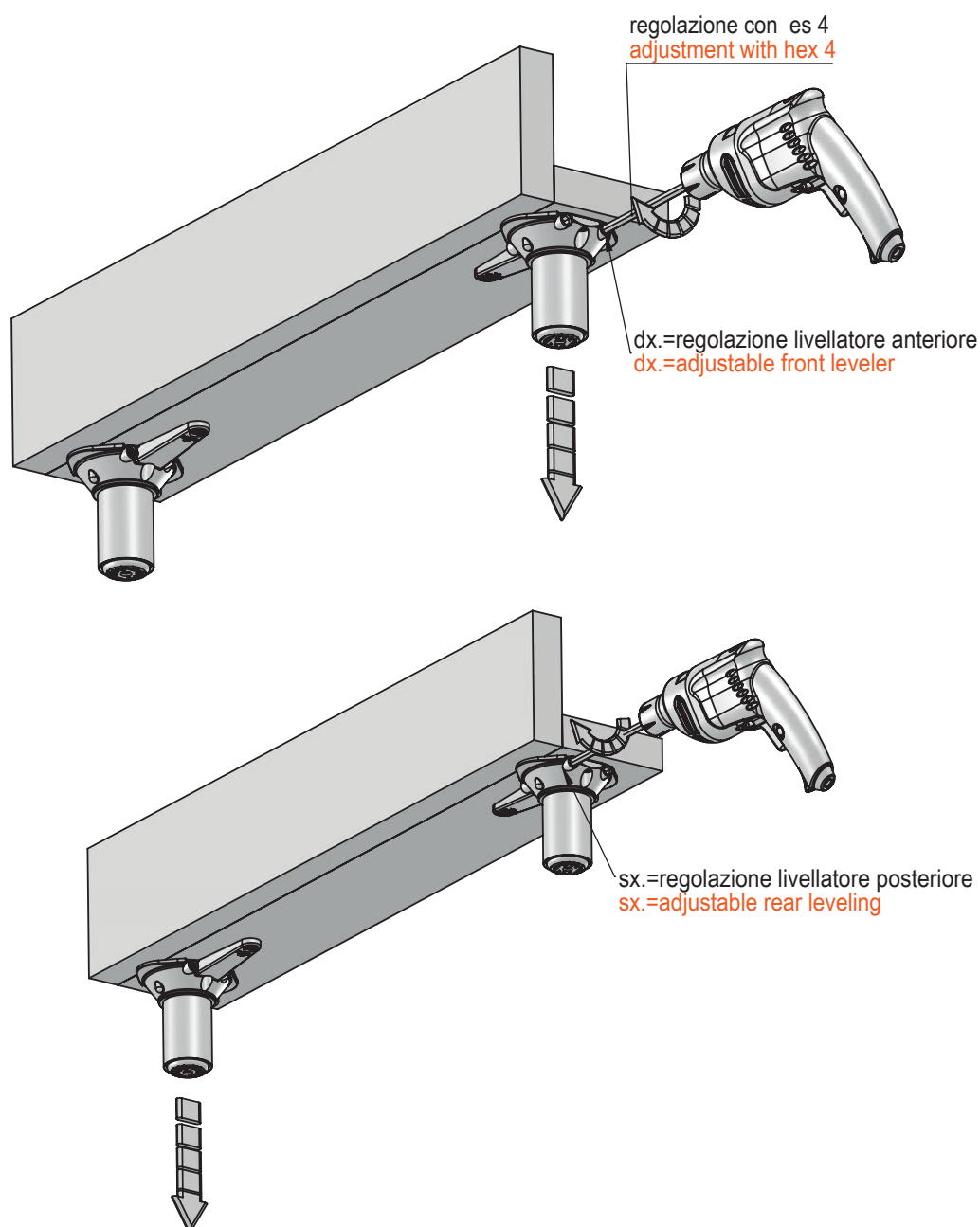



Livellatore tipo LV1021

Level adjuster LV1021 type

LIVELLATORE SOTTO
BASE SUPPORTA IL
FIANCO REGOLABILE
FRONTALMENTE.
DISPONIBILI NELLE
LUNGHEZZA "B" INDICATA
IN TABELLA.
LA LUNGHEZZA "I" PUO'
ESSERE REALIZZATA SU
MISURA.

FRONT ADJUSTABLE
UNDER BASE LEVEL
ADJUSTER SUPPORT THE
SIDE.
AVAILABLE IN LENGTH "I"
INDICATED IN THE TABLE.
LENGTH "B" CAN BE MADE
TO MEASURE.



1500 N per ogni livellatore for each leveler



20 mm
0 mm

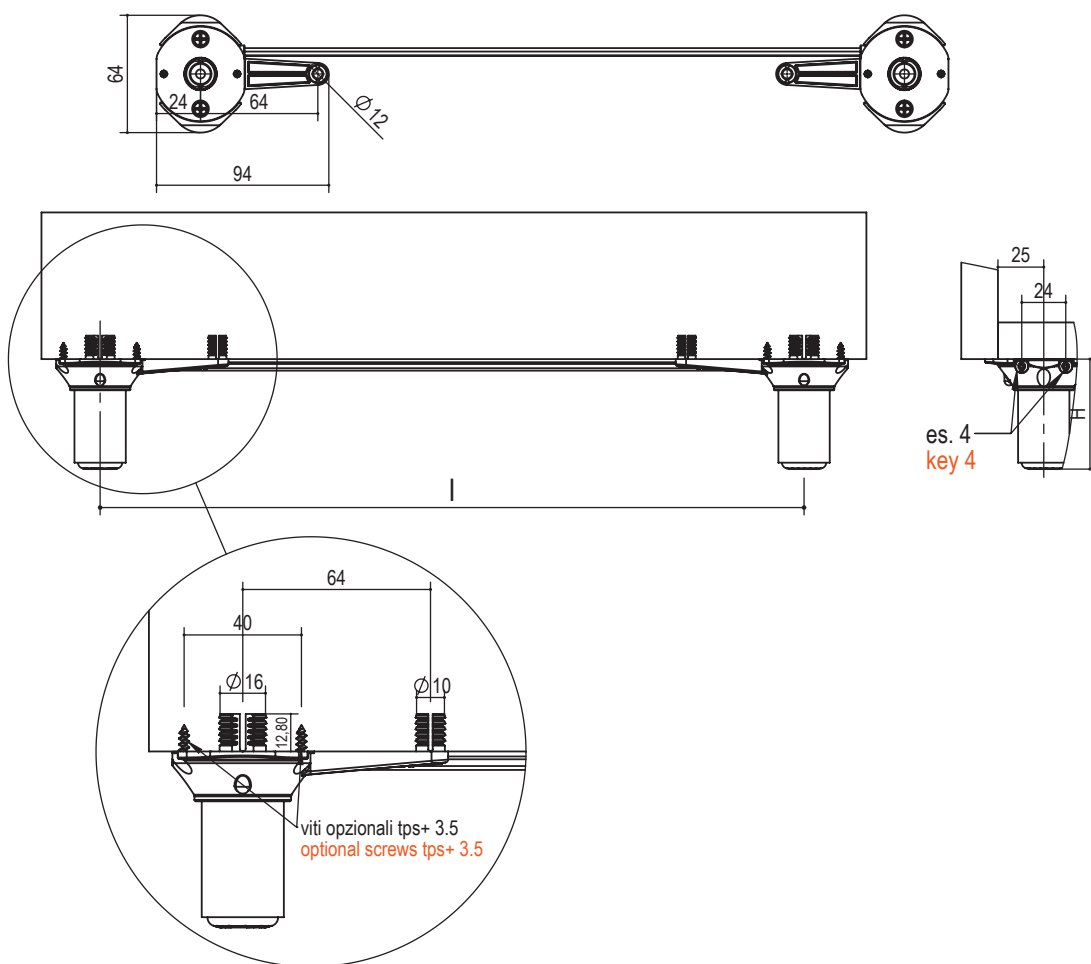

tipo type	H	I	misura measure	finitura finishing	box	kg / box
LV1021.	32		32.	53 nero back	100	0,2
	42	188	42.			0,21
	52	266	52.			0,22
	60	284	60.			0,24
	70	384	70.			0,25
	80	424	80.			0,26
...

es./e.g.: LV1021.60.I53