



Zig Zag

Mechanisms for folding panels
Meccanismi per ante a libro

www.ternoscorrevoli.com/zig-zag

Zig Zag

Zig Zag is a sliding system designed for cabinets with two folding hinged doors, weighing maximum 10 kg each panel.

Zig Zag allows doors lateral opening.

Zig Zag system installation does not require any on-sight accessory or profile on the bottom side, allowing a minimal design and an easy access to compartment.

Zig Zag è un sistema scorrevole per mobili con due ante a libro incernierate, con portate fino ad un massimo di 10 kg per pannello.

Zig Zag consente l'apertura delle ante lateralmente.

L'installazione del sistema **Zig Zag** garantisce un design minimal e lineare, ed un accesso al vano senza ostacoli.



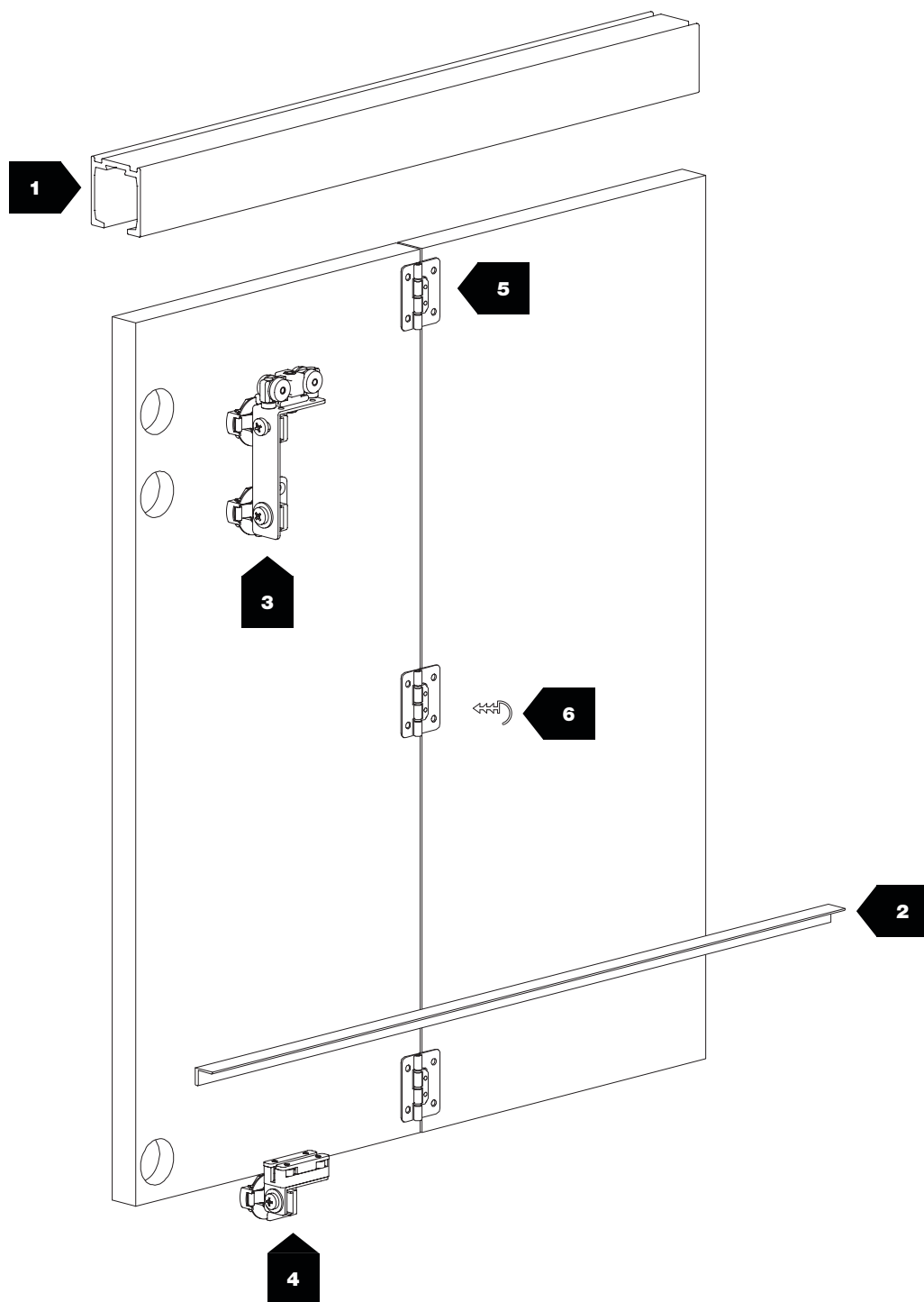

10 kg

N°			kg		N°			kg	
1	2660 8 00 0.02660 8 01 0.02660		10		4	886 S.1311.3		10	
2	20 8 00 0.00020 8 01 0.00020		10	Only ART.886		885 S.1311.5		10	
	15 8 00 0.00015 8 01 0.00015		10	Only ART.886		888 S.1311.1		10	
	730 8 01 0.00730		10	Only ART.885 — Plastic track Binario in plastica	5	879 S.1322.4		10	
3	881 S.1311.4		10			892 8 23 0.00892		10	
	882 S.1311.2		10		6				

Tracks / Binari		ALUMINUM FINISHES CODES / CODICI FINITURE ALLUMINIO			<div><div></div><div></div><div></div><div></div><div></div></div>
CODE / CODICE		FINISH COLOR / COLORE FINITURA			
8 00 0.0	<div></div> 00 G	Raw / Mill Finish / Neutro / Grezzo		STANDARD	
8 01 0.0	<div></div> 01 A	Anodized Silver / Argento			
8 14 0.0	<div></div> 14 N	Anodized Black / Nero			

Tracks / Binari		PLASTIC FINISHES CODES / CODICI FINITURE PLASTICA			<div><div></div><div></div><div></div><div></div><div></div></div>
CODE / CODICE		FINISH COLOR / COLORE FINITURA			
8 01 0.0	<div></div> 01 A	Anodized Silver / Argento		STANDARD	
8 23 0.0	<div></div> 23 GR	Gray / Grigio			

SYSTEM FOR HINGED FOLDING DOORS / SISTEMA PER ANTA A LIBRO INCERNIERATA

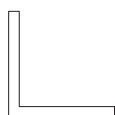

Aluminium track
Binario in alluminio

ART. 20

8 00 0.00020

8 01 0.00020



Aluminium track
Binario in alluminio

ART. 15

8 00 0.00015

8 01 0.00015

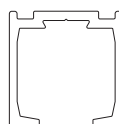

Aluminium track
Binario in alluminio

ART. 2660

8 00 0.02660

8 01 0.02660



Biextended anti-dust profile
Profilo biestruo parapolvere

ART. 892

8 23 0.00892

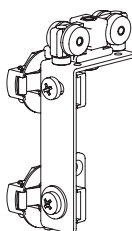

Double-hinge slider
Scorrevole con due cerniere

ART. 882

S.1311.2

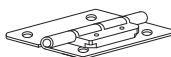

Hinge
Cerniera

ART. 888

S.1311.1

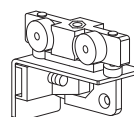

One-hinge slider
Scorrevole con una cerniera

ART. 881

S.1311.4

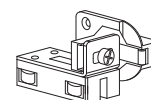

One-hinge slider
Scorrevole con una cerniera

ART. 886

S.1311.3

MEASUREMENTS DESCRIPTION / DESCRIZIONE MISURE

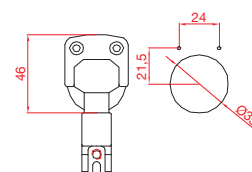
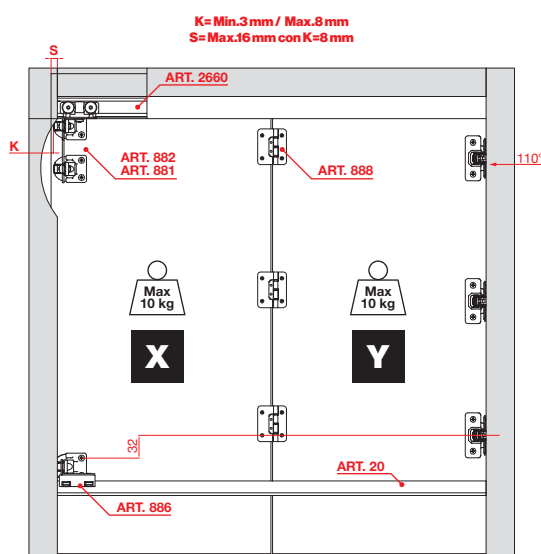

STANDARD HINGE / CERNIERA STANDARD

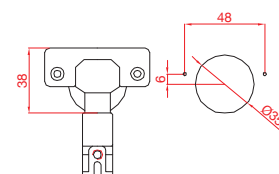

HINGE ON REQUEST / CERNIERA A RICHIESTA

The weight of the "X" and "Y" doors must be supported mostly by the 110° hinges.
Il peso delle ante "X" e "Y" deve essere sostenuto maggiormente dalle cerniere 110°.

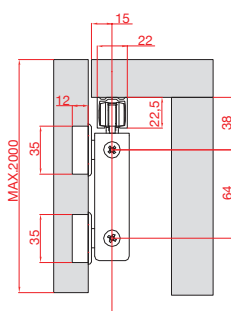

Door height / Altezza anta
Max 2000 mm

ART. 882 (S.1311.2)

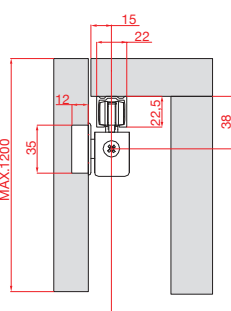

Door height / Altezza anta
Max 1200 mm

ART. 881 (S.1311.4)

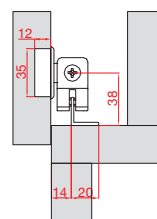

ART. 886 (S.1311.3) / ART. 20

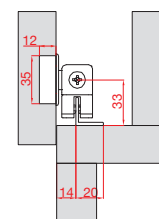

ART. 886 (S.1311.3) / ART. 15

SYSTEM FOR HINGED FOLDING DOORS / SISTEMA PER ANTA A LIBRO INCERNIERATA

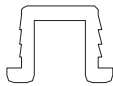

Plastic track
Binario in plastica

ART. 730
8 01 0.00730

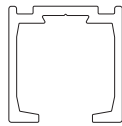

Aluminium track
Binario in alluminio

ART. 2660
8 00 0.02660
8 01 0.02660



Biextended anti-dust profile
Profilo biestroso parapolvere

ART. 892
8 23 0.00892

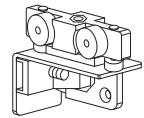

One-hinge slider
Scorrevole con una cerniera

ART. 881
S.1311.4

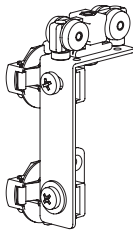

Double-hinge slider
Scorrevole con due cerniere

ART. 882
S.1311.2

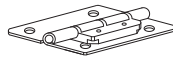

Hinge
Cerniera

ART. 888
S.1311.1

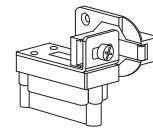

One-hinge slider
Scorrevole con una cerniera

ART. 885
S.1311.5

MEASUREMENTS DESCRIPTION / DESCRIZIONE MISURE

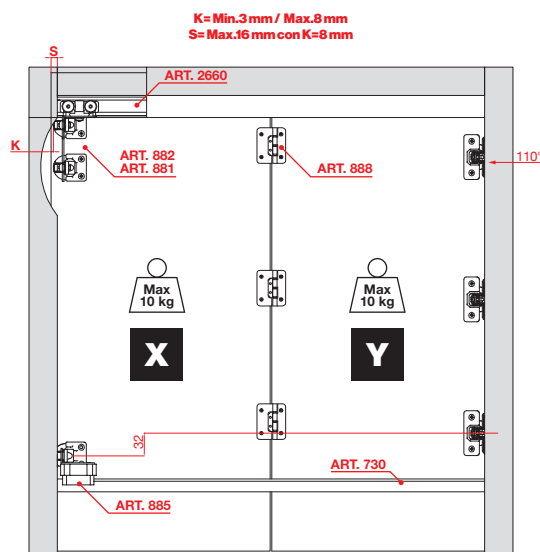

The weight of the "X" and "Y" doors must be supported mostly by the 110° hinges.
Il peso delle ante "X" e "Y" deve essere sostenuto maggiormente dalle cerniere 110°.

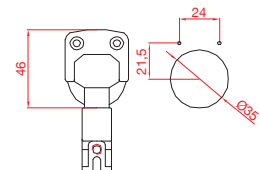

STANDARD HINGE / CERNIERA STANDARD

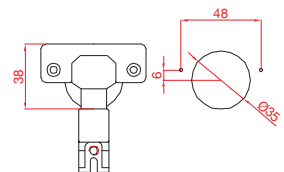

HINGE ON REQUEST / CERNIERA A RICHIESTA

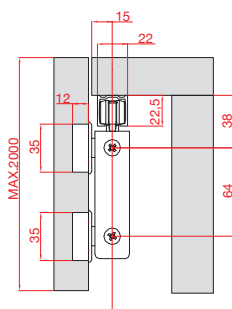

Door height / Altezza anta
Max 2000 mm

ART. 882 (S.1311.2)

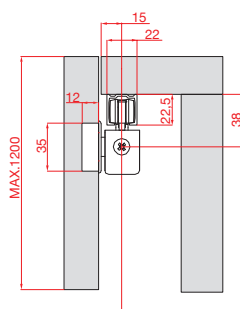

Door height / Altezza anta
Max 1200 mm

ART. 881 (S.1311.4)

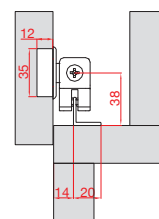

ART. 886 (S.1311.3) / ART. 20

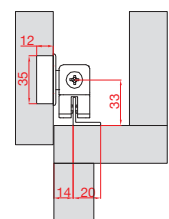

ART. 886 (S.1311.3) / ART. 15

POSITIONING DIAGRAM (X-Y) OF THE HINGE, EQUIPPED WITH JOGGLED AXIS ART. 888 (S.1311.1)
SCHEMA DI POSIZIONAMENTO (X-Y) DELLA CERNIERA CON ASSE SPOSTATO ART. 888 (S.1311.1)

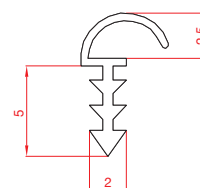
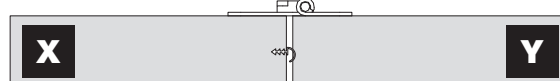
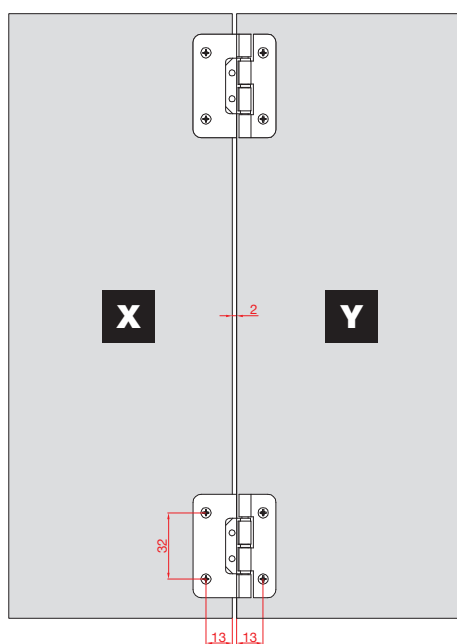
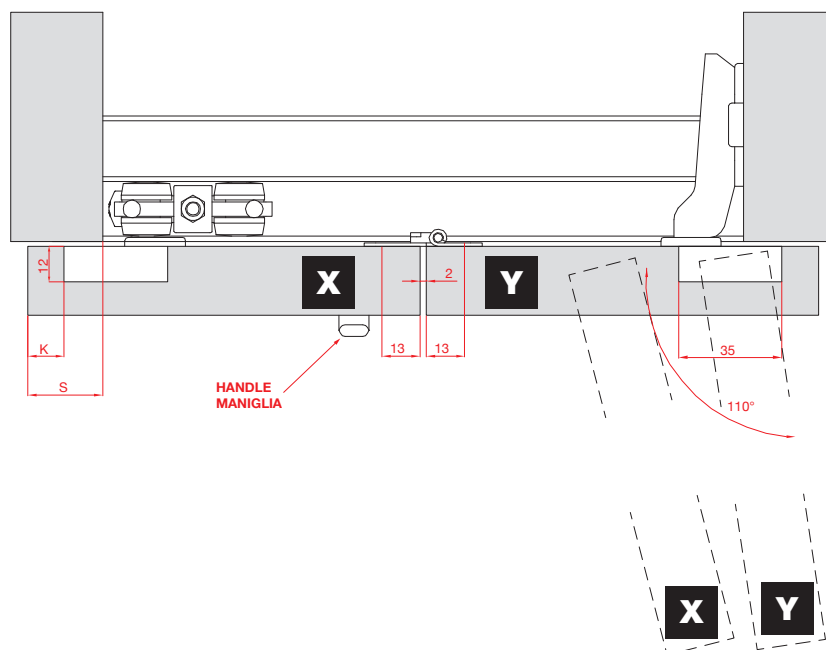

Hinge with moved axis that facilitates the closure of the door
Cerniera con asse spostato che facilita una migliore chiusura

Biextended anti-dust profile
Profilo biestruato parapolvere

ART. 888
S.1311.1

ART. 892
8 23 0.00892

**POSITIONING DIAGRAM (X-Y) OF THE HINGE, EQUIPPED WITH JOGGLED AXIS ART. 879 (S.1322.4)
SCHEMA DI POSIZIONAMENTO (X-Y) DELLA CERNIERA CON ASSE SPOSTATO ART. 879 (S.1322.4)**

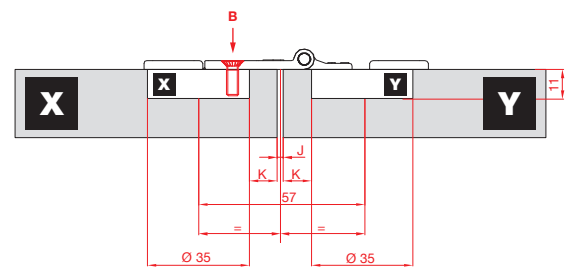
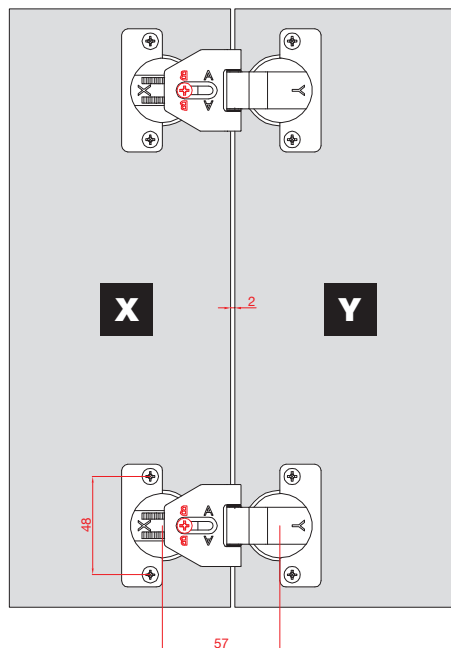
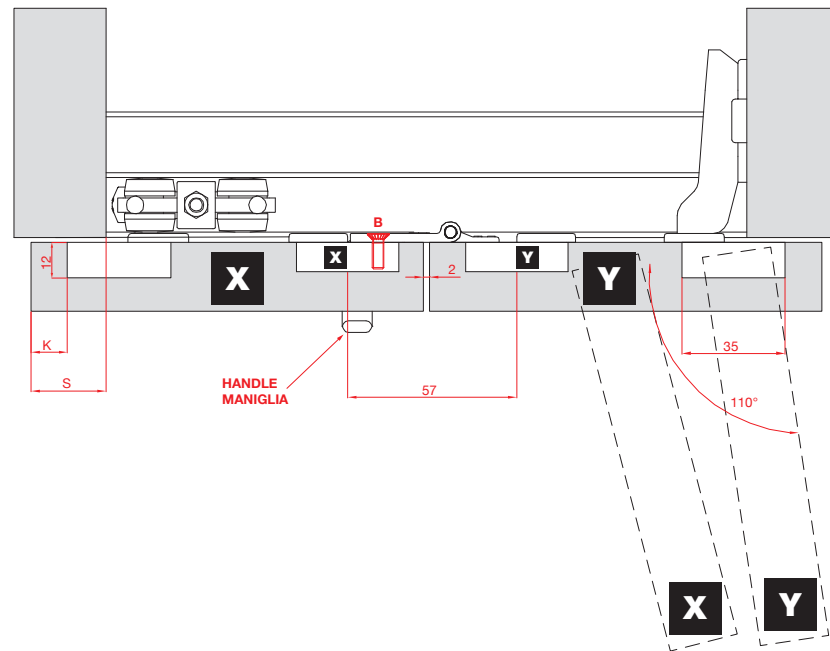

K= 10 J= 2 mm
K= 11 J= 0 mm

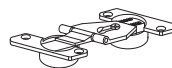

Hinge with axis moved to position "B"
Cerniera con asse spostato in posizione "B"

**ART. 879
S.1322.4**

ILLUSTRATION OF POSITIONING WITH CENTRAL AXIS OF HINGE ART. 879 (S.1322.4)
SCHEMA DI POSIZIONAMENTO CON ASSE CENTRALE DELLA CERNIERA ART. 879 (S.1322.4)

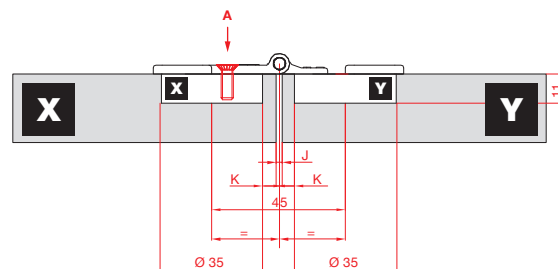
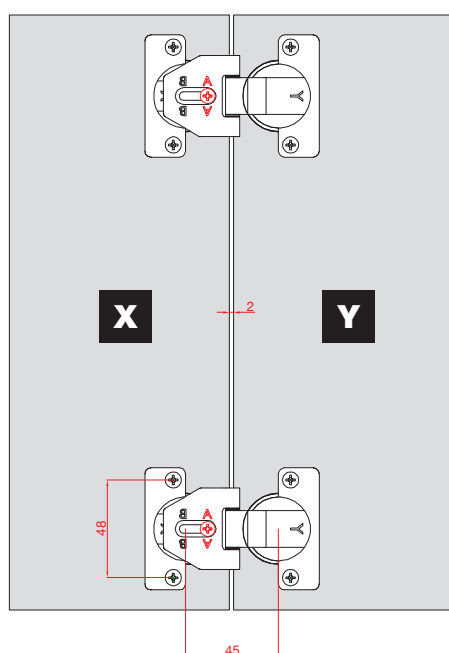
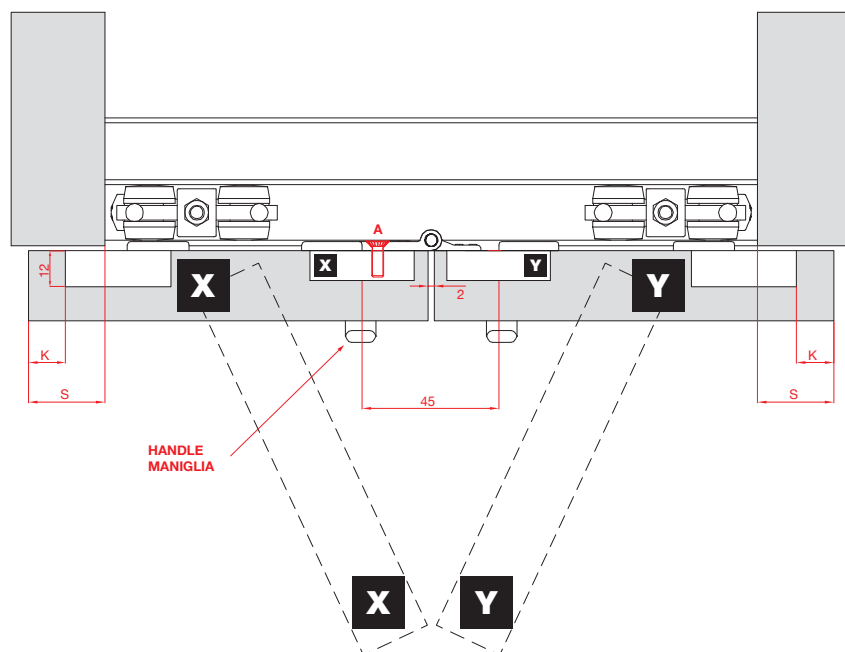

K= 4 J= 2 mm
K= 5 J= 0 mm

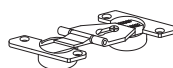

Hinge with axis moved to position "A"
Cerniera con asse spostato in posizione "A"

ART. 879
S.1322.4



Terno Scorrevoli S.p.A.

Via Ravenna, 4 - 20814 Varedo (MB) ITALY
Phone +39 0362 543001 - Fax +39 0362 582290

terno@ternoscorrevoli.com
www.ternoscorrevoli.com