

# SLIDING DOOR: ASSEMBLY & INSTALLATION

## SYSTEM AIR-A / S1200

Version 1.5 (2019-09-13)

1.03.3.c

**Installation**  easy medium difficult

Subject to technical changes.

**raumplus**

# CONTENT AND TOOLS

**CONTENT:**

Content and tools	page	02
Product information	page	03
Accessories	page	06
Exploded drawing	page	07
Cutting measures	page	08
Assembly instruction	page	10
Installation instruction	page	13
Detail drawings	page	19
Stopper for top track	page	20

**TOOLS:**

(without claim of completeness)

- |                           |                   |
|---------------------------|-------------------|
| ■ Hack saw                | ■ Screwdriver set |
| ■ Allen key set           | ■ Rubber mallet   |
| ■ Cordless drill          | ■ Pencil          |
| ■ Drilling machine        | ■ Water level     |
| ■ Drill set metal / stone |                   |



**VERSION INFORMATION:**

- Version 1.1: Cutting measure corrected
- 1.2: Cutting measure corrected (door height)
- 1.3: Item number corrected
- 1.4: Instructions for stoppoint added
- 1.5: Washer for frame screw 0,5 mm added

# PRODUCT INFORMATION

## GENERAL INFORMATION: Preparation

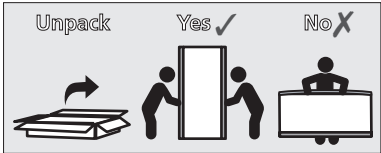

- This manual is part of the product and describes the safe and proper installation of the system. Please read the instructions carefully before installation
- Please note that the assembly should only be done by qualified and trained staff in strict compliance with all details indicated in this document. Improper installation in variation from manufacturer's specification may cause defects and danger, thus endangering the safe fixing of the product as well as the safety of the prospective user. The liability of the manufacturer shall be excluded in case of defects and consequential damages resulting from incorrect assembly of this product.
- Please check the completeness of the delivered parts and check carefully if any transport damages are visible.
- If any parts are damaged or lost, please immediately contact the responsible supplier.
- It is assumed that you have exactly identified all cutting dimensions according to the measurement instruction for raumplus products.

## SYMBOLS:

Symbol	Importance	Symbol	Importance
	Risk or danger		Perform this workstep with several people.
	Advice and information		
	Additional information / other documents		
	Directional data / direction of movement		
	„yes“ and „right“		
	„no“ and „wrong“		
	Follow the order		

## SYSTEM:

### System Information: S 1200 AIR-A S42

- max. weight of element = 60 kg
- min./max. door height = 700 mm / 2750 mm
- min./max. door width = 500 mm / 1400 mm

# PRODUCT INFORMATION

## GENERAL INFORMATION: **Product safety**

- The door system complies with the prior art and the authorized safety rules at the time of delivery.

## USE:

### **Intended use**

- The prerequisite for the intended use of our products is the professional installation according to our installation instruction. The fittings must be sufficiently and durable attached to all relevant places.  
The function of the fitting must not be hindered or altered during installation.
- Special solutions are only possible in consultation with raumplus.

### **Use not as intended**

- Risk or danger may occur in the following cases:
  - the door system has improperly been installed or maintained
  - the safety and installation instructions have not been followed.
  - after improper installation or inadequate fixing ( e.g. to parts of buildings)
  - the maximum weight of the doors has been exceeded.
  - improper shock and case loads or other additional loads on the fittings have occurred
  - the fittings have been used outside.
  - body parts or objects get in to the clothing edges or door runnings during use of the door wing.
  - the door system is not used as intended.

### **Structural modifications**

- structural modifications that are not offered as an accessory from **raumplus** may only be attached or installed with permission of **raumplus** GmbH!

# MANUAL

This manual is part of the delivered product and describes the safe and proper use.

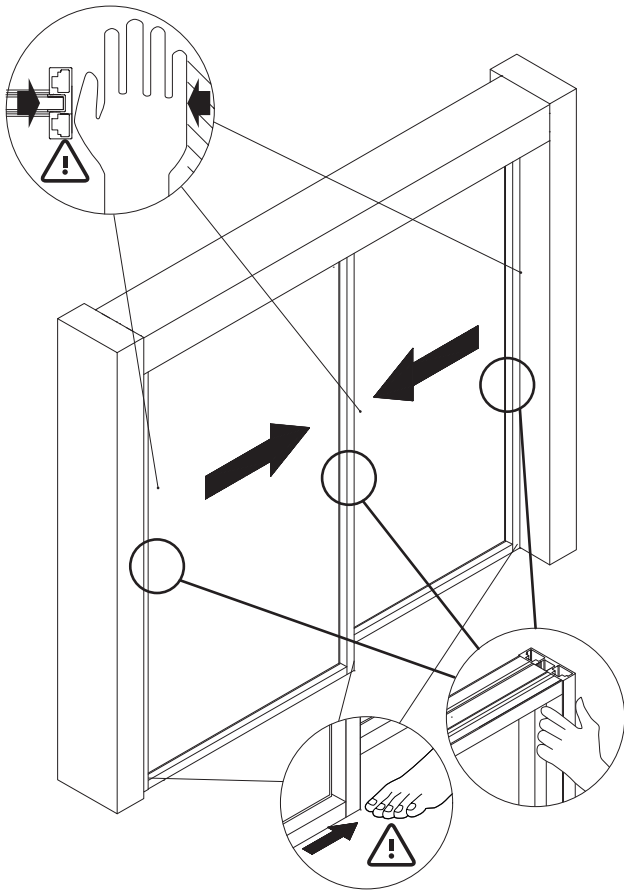

## Designated use:

The product is designed and manufactured for indoor use.

The product was designed as a hand-held sliding door that is usually not moved faster than at walking pace and that is braked manually when reaching of the end position. The doors are guided at the top and at the bottom.

Any other use or use beyond that is considered to be improper.

## Manual:

Open the door by the handle profile or the handle (optional).

Run the door slowly to the ...  
... opening / closing point, or  
... activating point of the sliding door brake (optional).

## Note:

Protect your hands from jamming during the movement of the door. When closing or opening the door never grasp the profile, only use the handle profile or the handle.

Use the door as instructed.

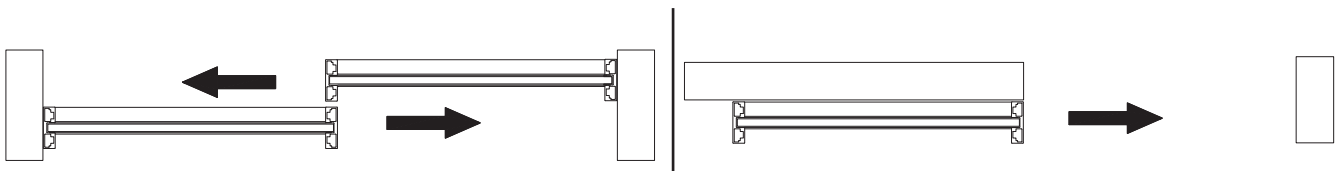

## Safety Information:

The product complies with the prior art and the recognized safety rules at the time of delivery.

- Pay attention to child safety.
- No additional load to the doors.
- Structural changes, additions or modifications can only be carried out by a dealer.
- In case of malfunctions or irregularities: shut down the system and contact your dealer.
- ⚠ Installation of the product without wall connection, only in combination with top / bottom stopper 📄!

As defined in the „Law of Liability for Products“ (§4 Prod-HaftG), for the liability of the manufacturer, for his products, the above information has to be regarded. The disregard of this manual, releases the manufacturer from his liability.

# ACCESSORIES

More colors available, please ask your supplier.

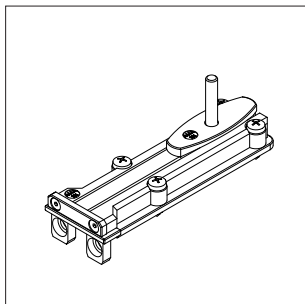

1\_ 10.06.027

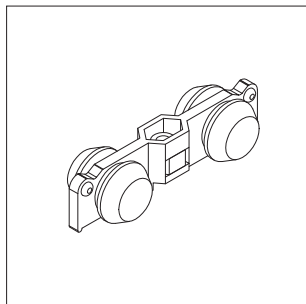

2\_ 10.06.200

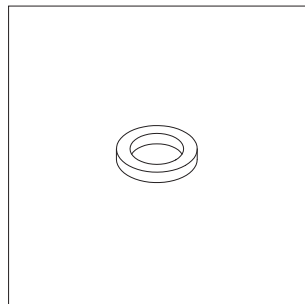

3\_ 10.07.215

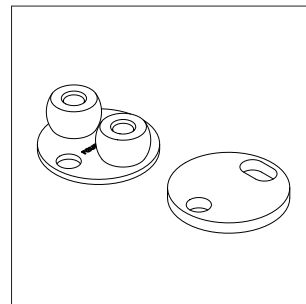

4\_ 10.06.033 / 10.06.035

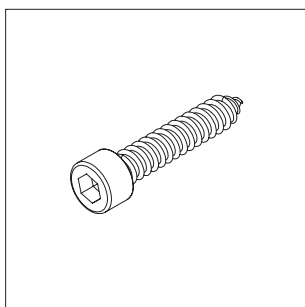

5\_ 10.07.212

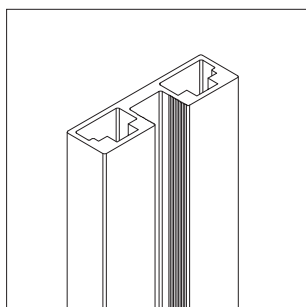

6\_ 12.01.0xx

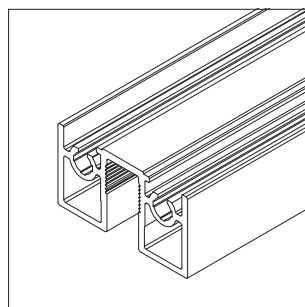

7\_ 12.42.0xx

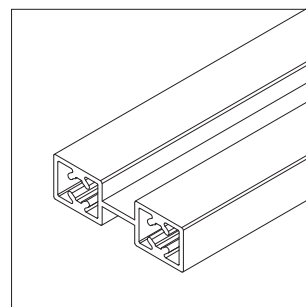

8\_ 12.20.0xx

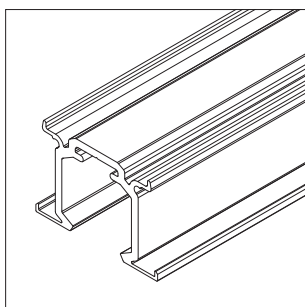

9\_ 14.55.0xx

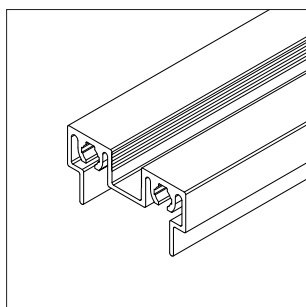

10\_ 12.26.0xx

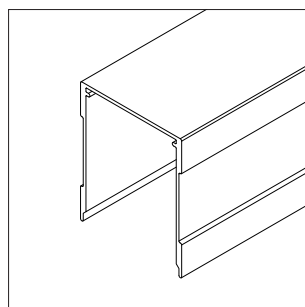

11\_ 14.65.0xx

1\_ Pick up element S 1200

2\_ Top roller Air

3\_ Washer for frame screw 1,5 mm

4\_ Ground plate with bearing air S34 / air S1200  
stance plate air S34 / air S1200

5\_ Frame screws 6,3 x 32mm

6\_ Stile S 1200

7\_ Top rail S 1200 Air

8\_ Dividing rail 12 mm

9\_ Top track insert Air

10\_ Bottom rail S1200 air

11\_ Top track S42, 60 mm

\_ Without fig.:

12\_ Drilling template S 1200 (30.14.018)

13\_ Countersink set w. guiding pin (30.14.020)

14\_ Brake for top roller (10.05.030)

15\_ Stopper for top roller (10.05.017)

16\_ topper for top roller w/o brake (10.05.060)

17\_ Crossbar Air system (14.53.0xx)

18\_ Washer for frame screw 0,5 mm (10.07.218)

# EXPLODED DRAWING

SYSTEM AIR-A / S1200

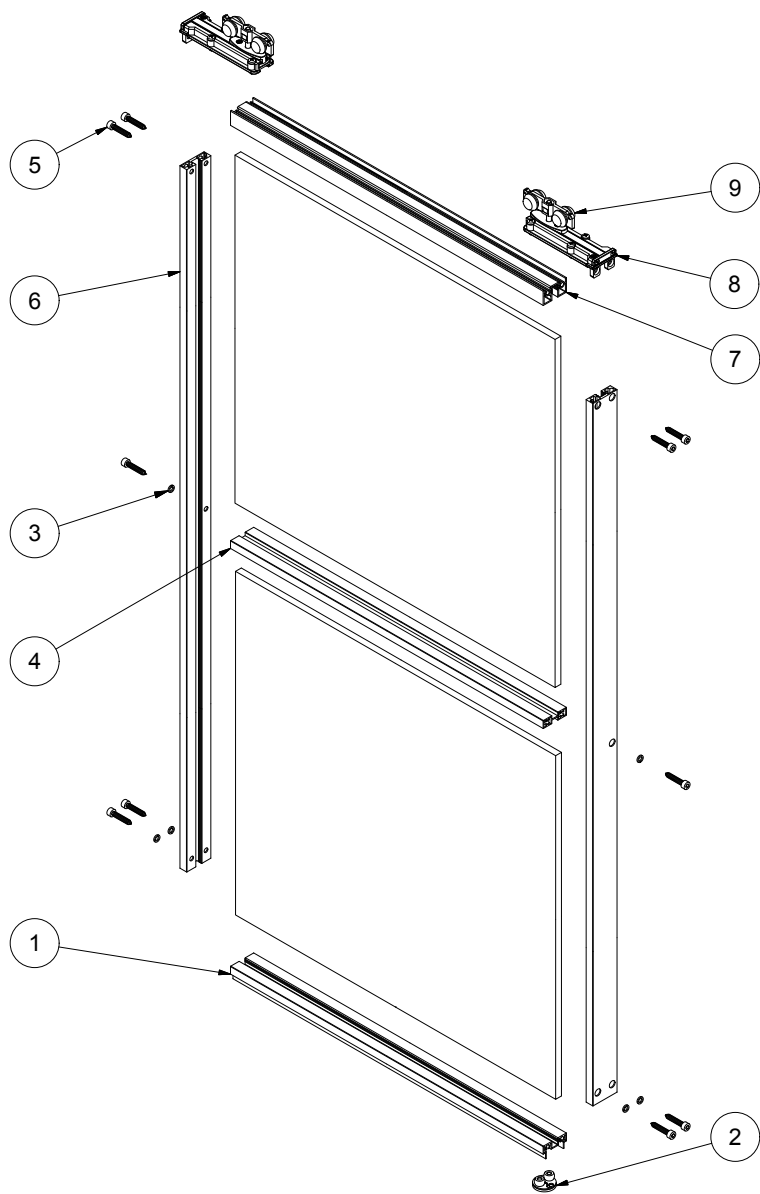

Item List

Object	Quantity	Description	Article-no.
1	1	Bottom rail S1200 air	12.26.0xx
2	1	Ground plate with bearing air S34 / air S1200	10.06.033
3	6	Washer for frame screw	10.07.215
4	1	Dividing rail 12 mm	12.20.0xx
5	10	Frame screws 6.3 x 32 mm	10.07.21x
6	2	Stile S 1200	12.01.0xx
7	1	Top rail S1 200 Air	12.01.0xx
8	2	Pick up element S 1200	10.06.027
9	2	Frame profile LED glass shelf closed	10.06.200

# DETAIL DRAWING

## HOLE PATTERN VERTICAL PROFILES / CUTTING MEASURES W/O SDB

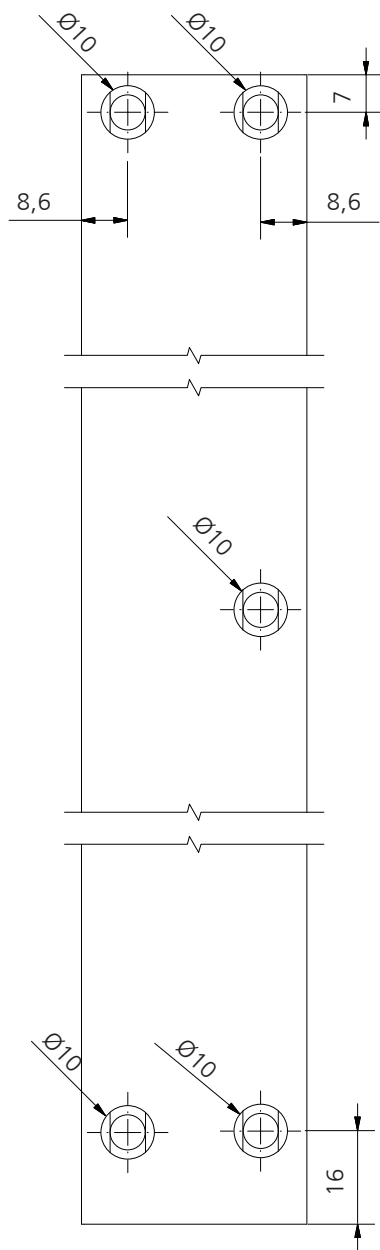

profile outside

stile S1200  
item no.: 12.01.0xx

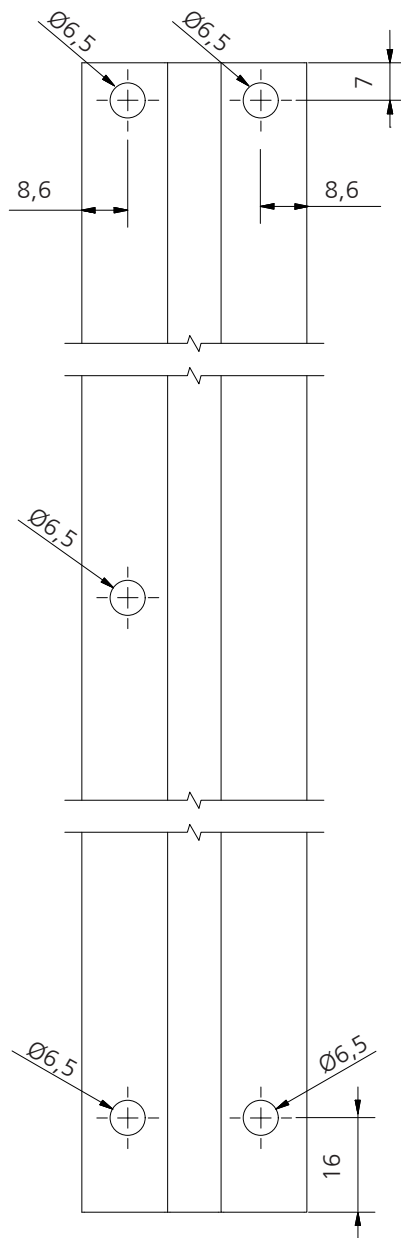
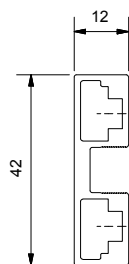

profile inside

### CUTTING MEASURES **PROFILES** S1200 AIR:

Door height	= clear height -60 mm
Cross rail length	= door width -24 mm
min. / max. door width	= 500 mm / 1400 mm
min./ max. door height	= 700 mm / 2750 mm
max. door weight	= 60 kg
Overlap	= 12 mm

### CUTTING MEASURES **PANEL** S1200 AIR (w/o dividing rail):

height	= door height -16 mm (w/o gasket)
	= door height -17 mm (with gasket)
width	= door width -11 mm



# DETAIL DRAWING / CUTTING MEASURES

CUTTING MEASURES HEIGHT FOR PANELS S1200 AIR

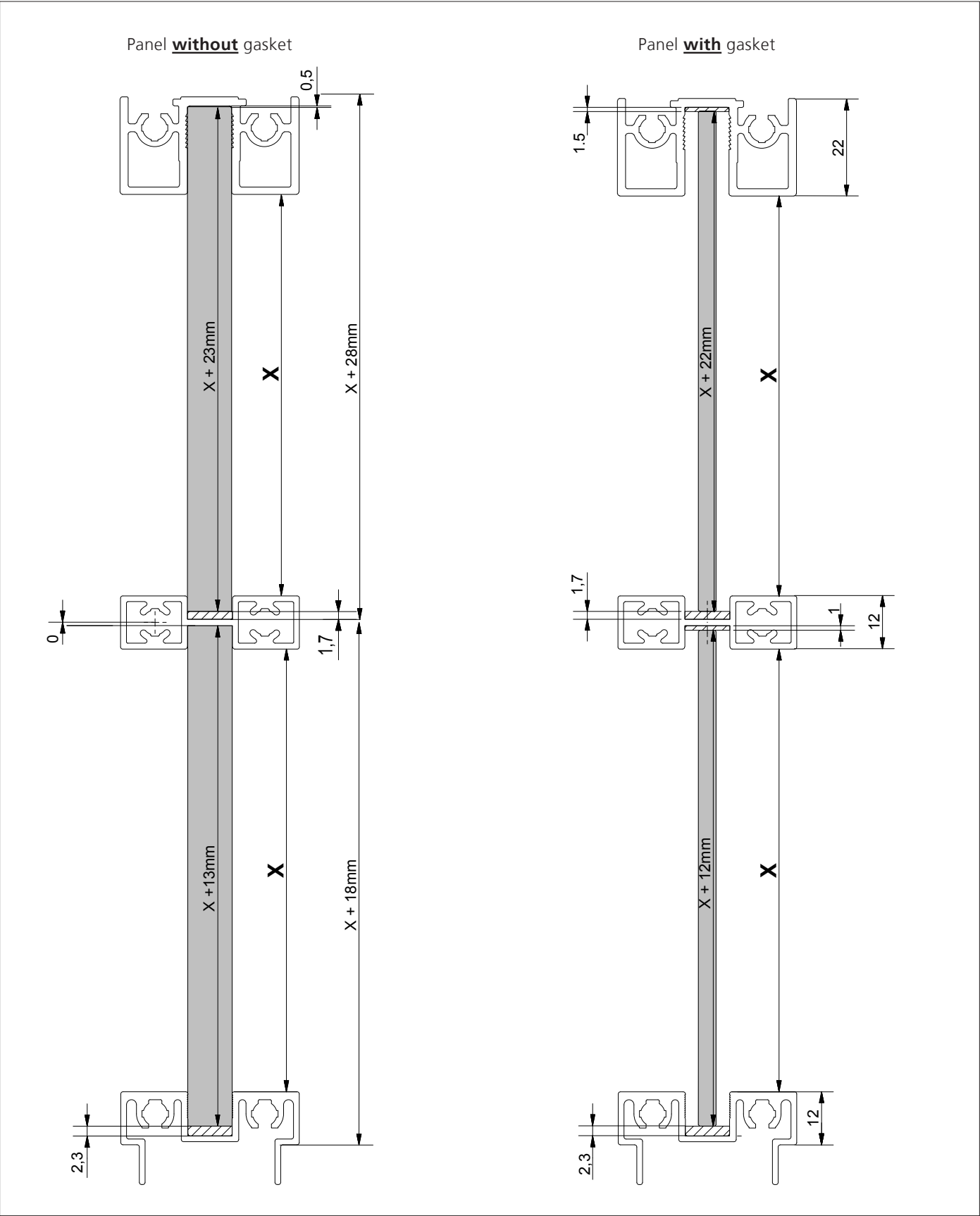

# ASSEMBLY INSTRUCTIONS

## DOOR PANEL / GASKET



The gasket is necessary for glass panels under 10 mm.

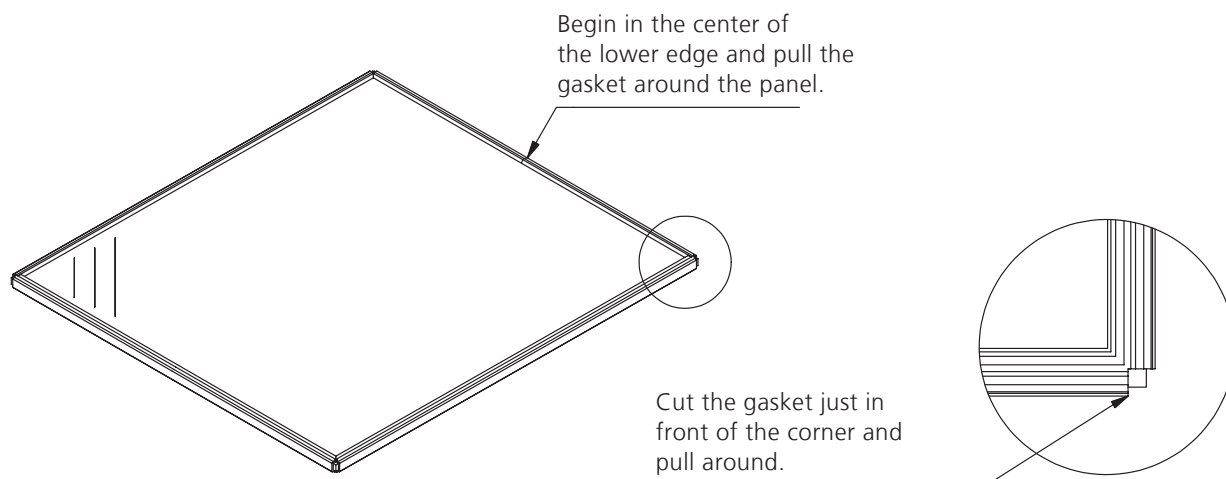

1\_ Panel



After the profiles mounted on the glass filling, cut the stick out from the gasket at the rail.

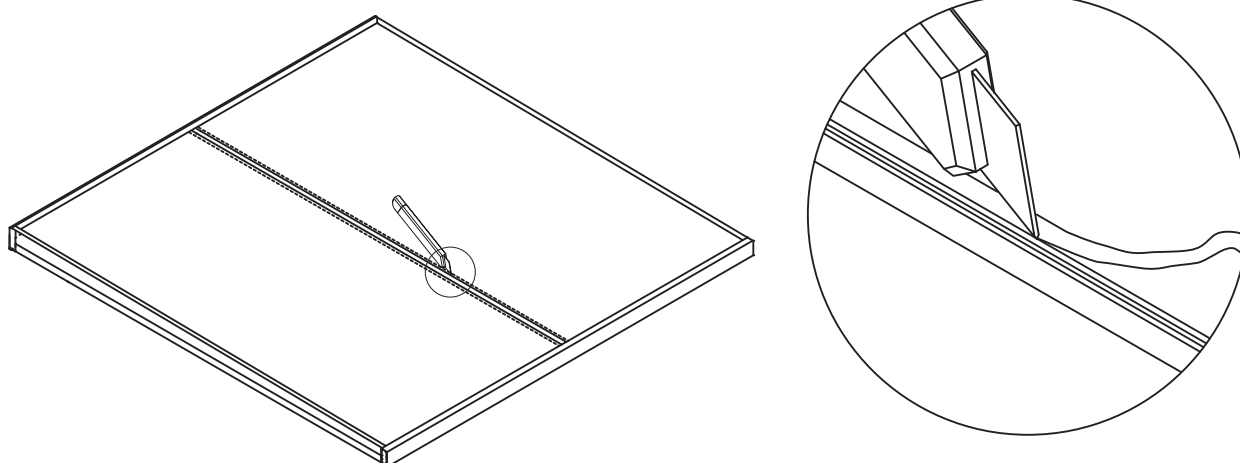

2\_ Panel with gasket

# ASSEMBLY INSTRUCTIONS

## DOOR ASSEMBLY

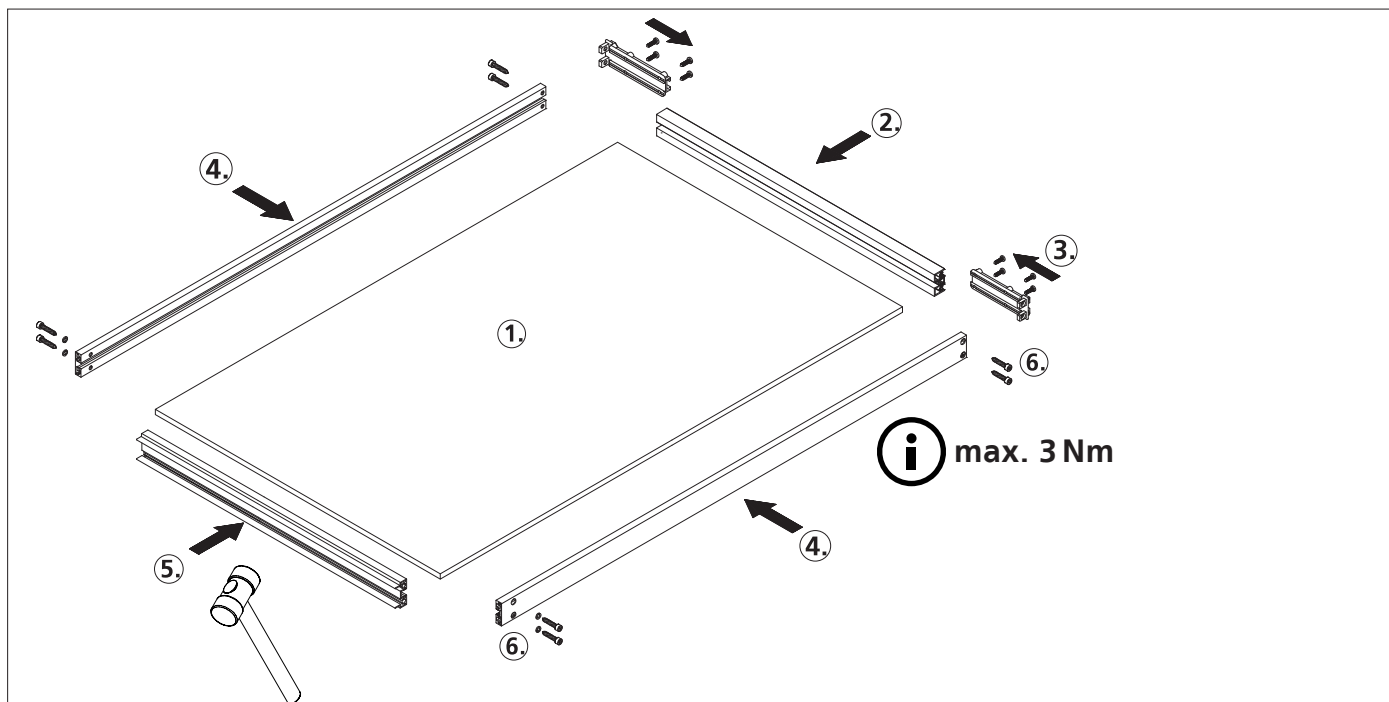

- ① Put the panel on a flat work surface, optionally provided with a suitable gasket.
- ② Hit the top rail with a rubber hammer.
- ③ Insert the pick-up-element laterally into the top rail.
- ④ Put the vertical profile in the pick-up-element and hit the vertical profiles with a rubber hammer.
- ⑤ Hit the bottom rail with a rubber hammer.
- ⑥ Align profiles flush and screw the profiles with the frame screws, use the washers only at the bottom screws.

## DOOR ASSEMBLY DETAIL

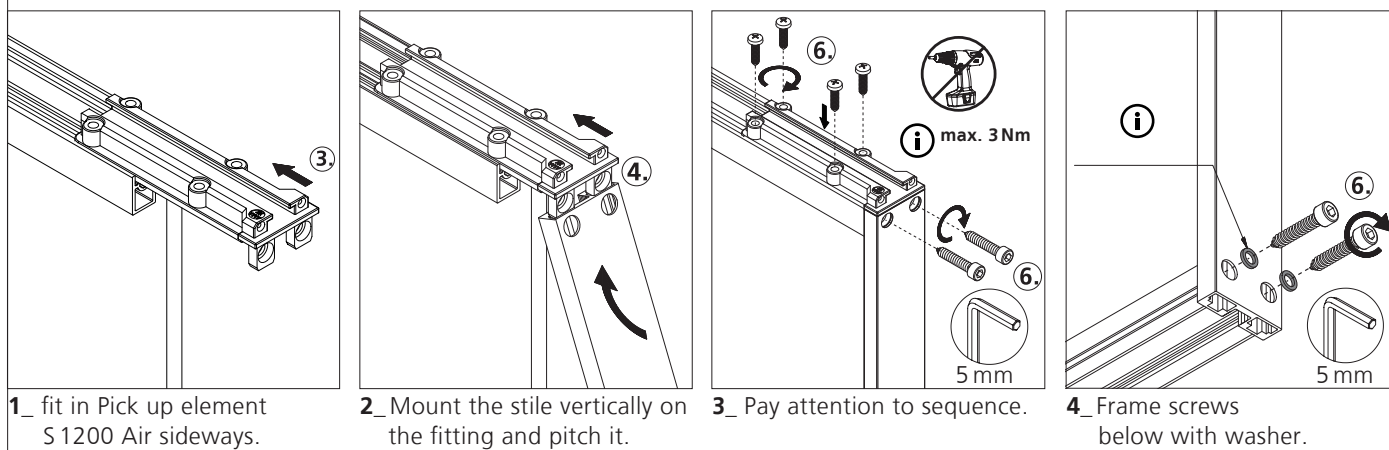

# ASSEMBLY INSTRUCTION

## ALIGN SLIDING DOOR

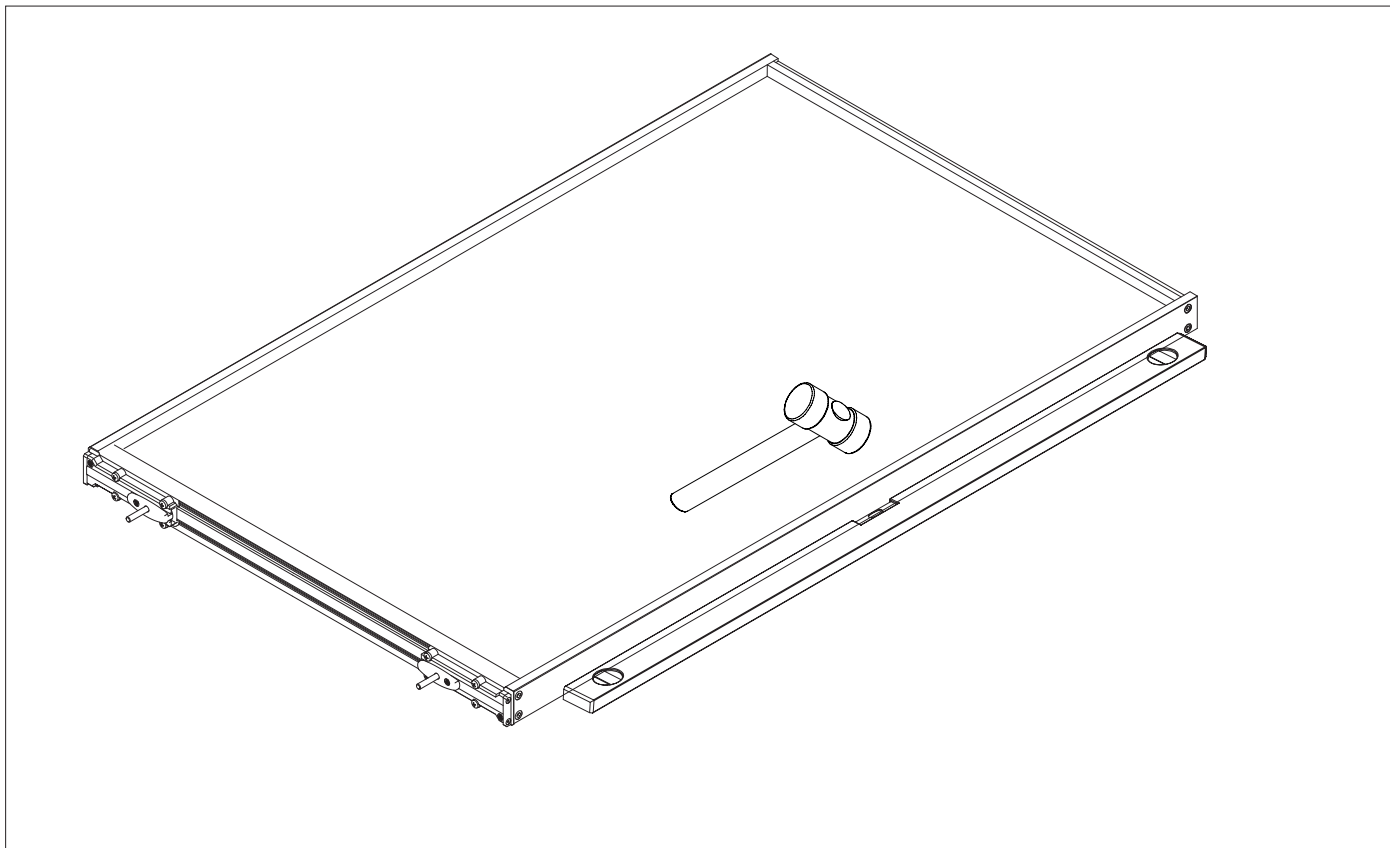

**1\_** Align the profiles with a rubber hammer and straight-edge.

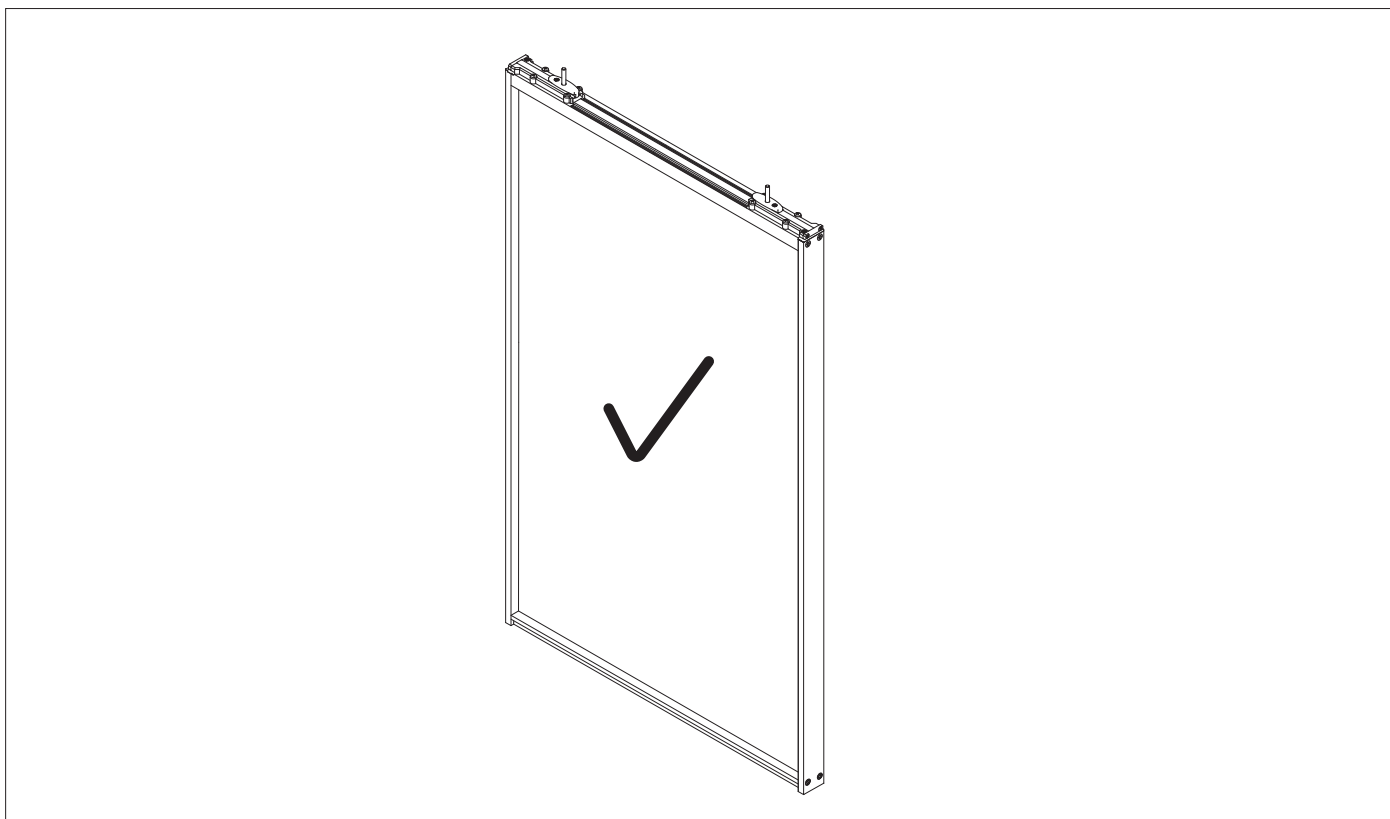

**2\_** Sliding door S1200 AIR-A is completed.

# INSTALLATION INSTRUCTION

## TOP TRACK

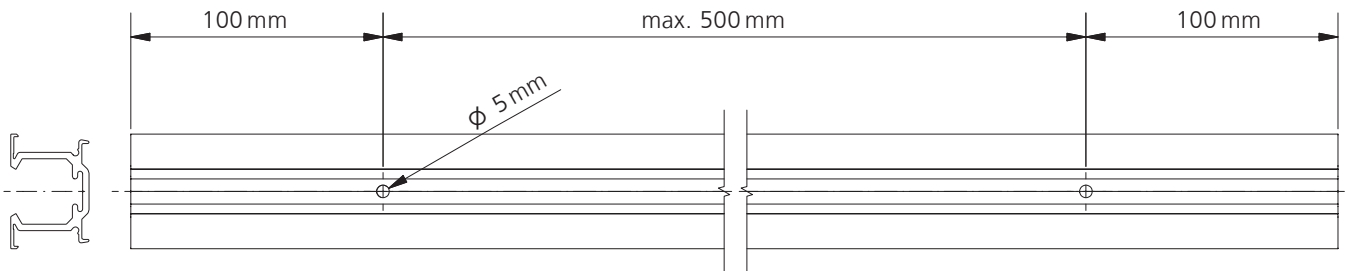

Screws and dowels for mounting the top track must be adapted to the respective ground.  
The loading capacity must be at least **60 kg per door**.

**1\_** Cut cover for top track, middle insert profile and top track to size and drill holes in top track.

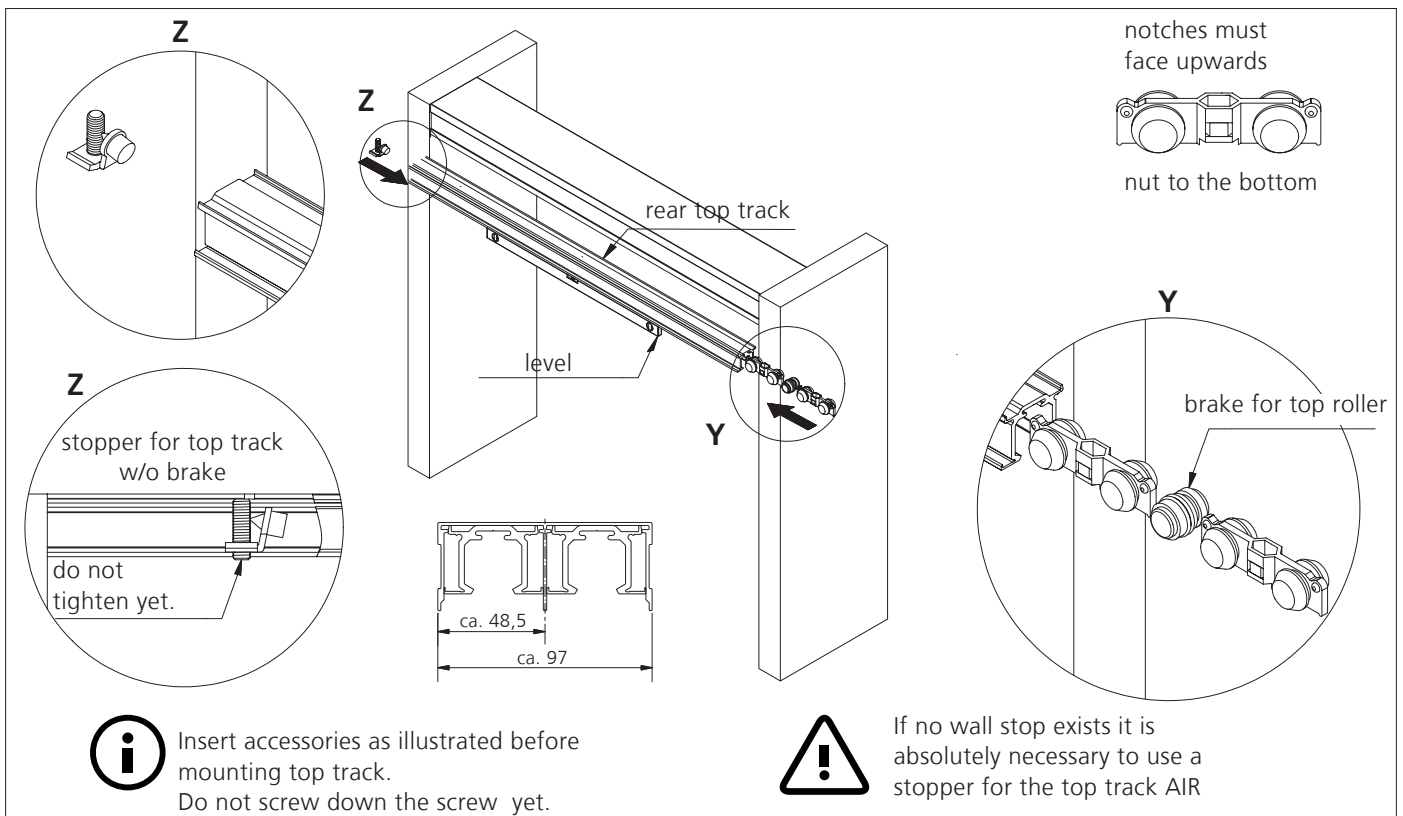

**2\_** Drill holes in ceiling/top of corpus and mount the rear top track horizontally (fig. w/o ceiling/corpus).

# INSTALLATION INSTRUCTION

## ASSEMBLE PICK UP ELEMENT

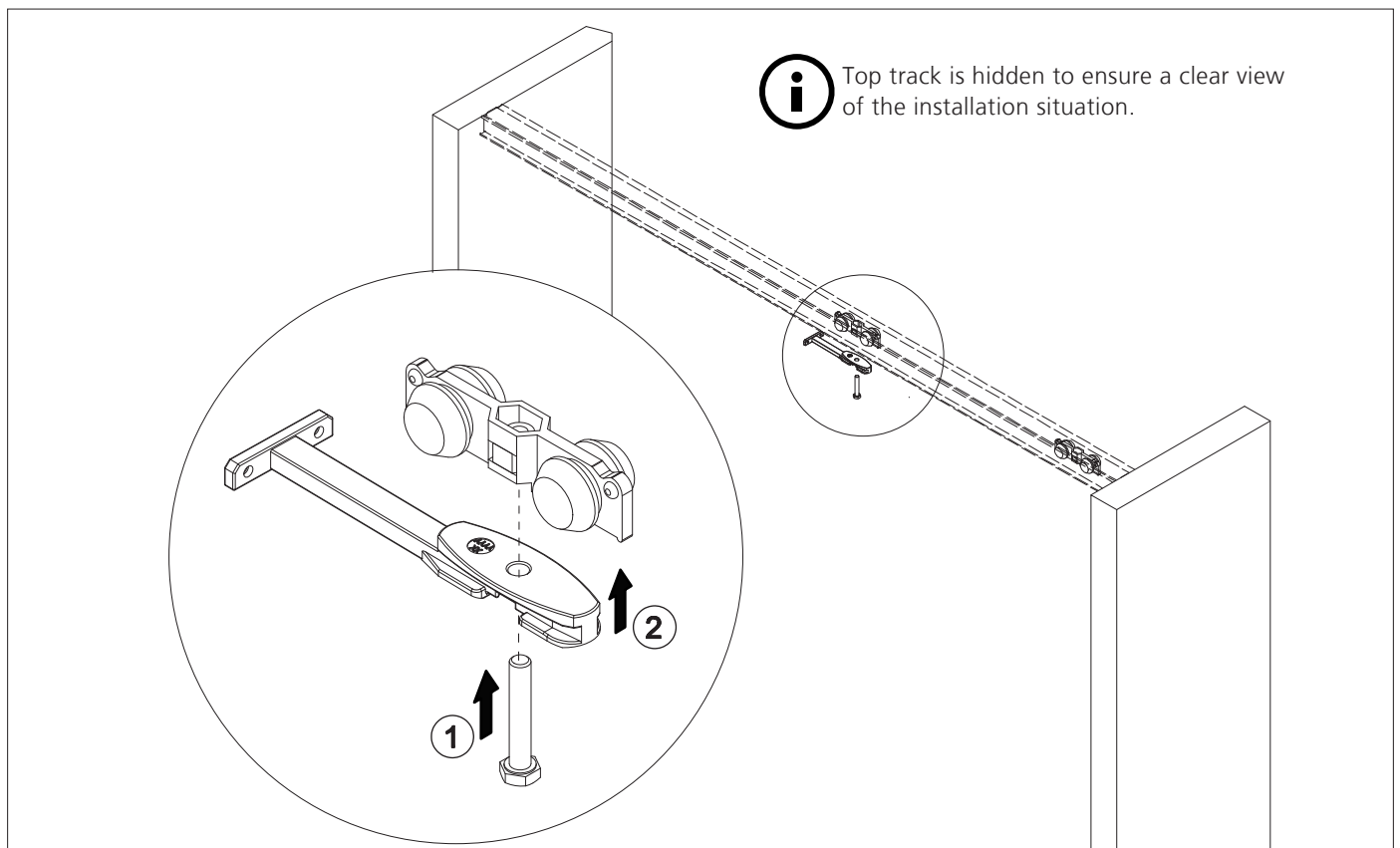

1\_ Connect pick up element with top roller.

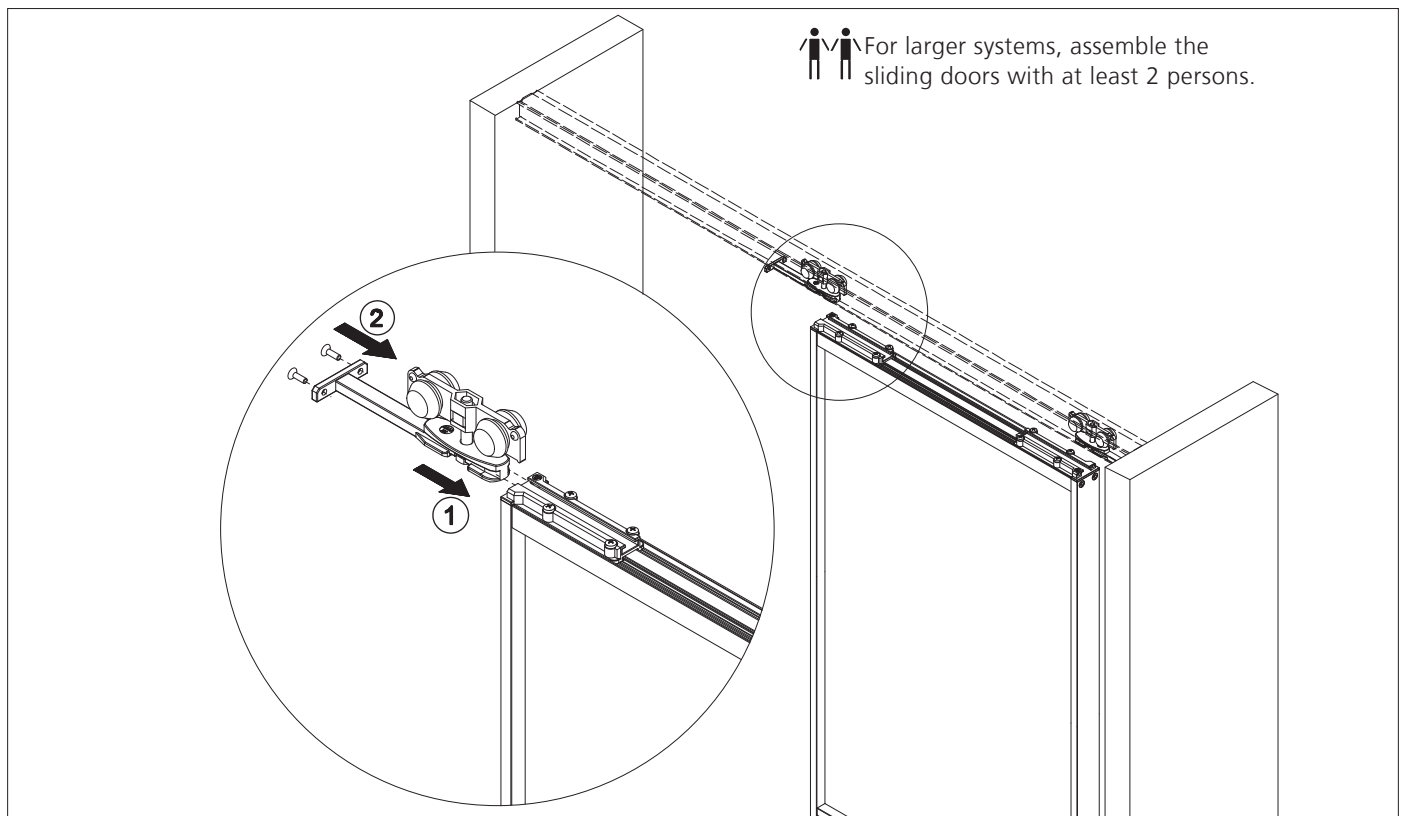

2\_ Put in the rear door, slide the top roller with the pick up element into the mounting rail and mount it.

# INSTALLATION INSTRUCTION

## ADJUST SLIDING DOOR

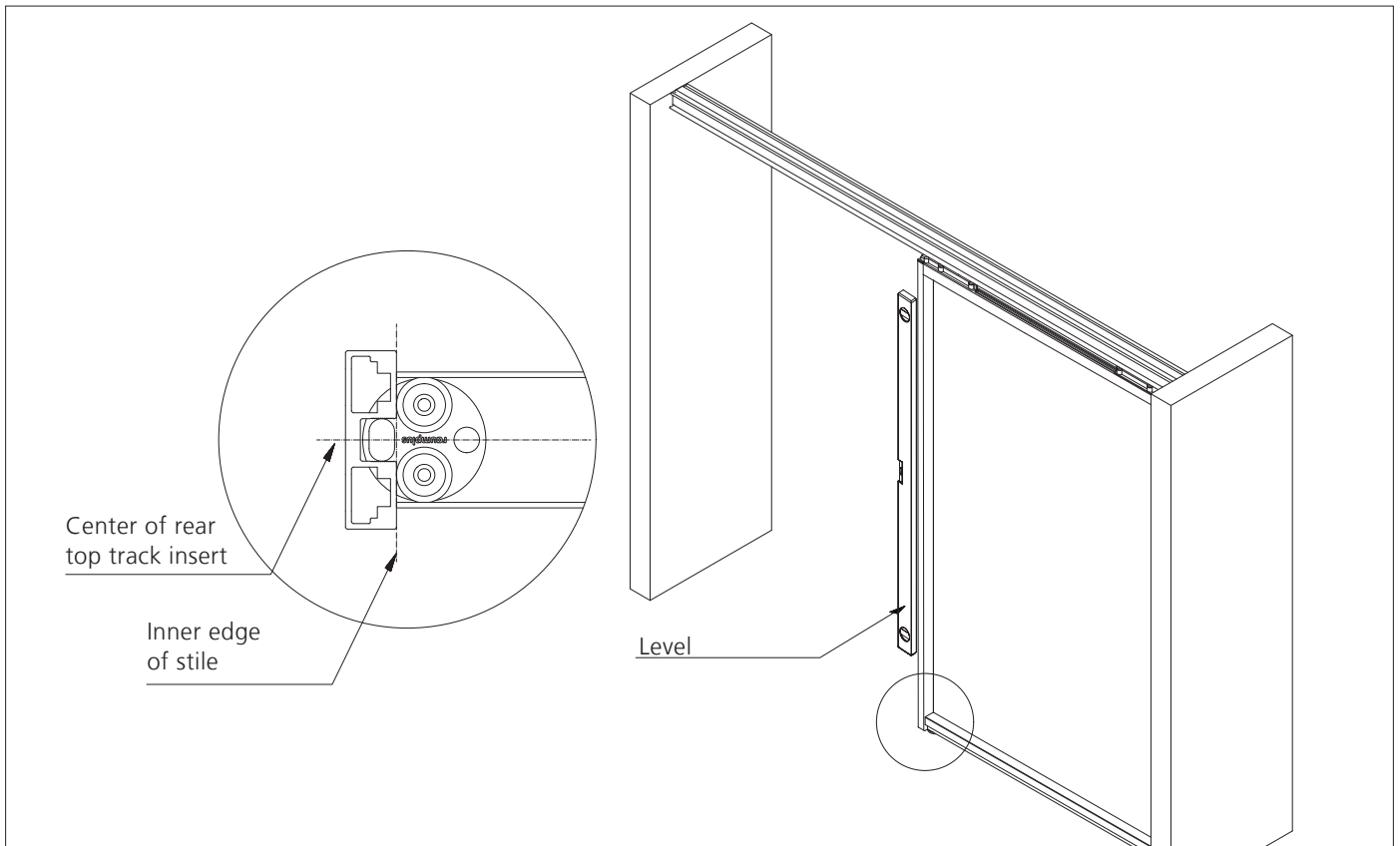

1\_ Mark position of ground plate (masking tape / pencil), unhinge rear sliding door and mount ground plate.

 For larger systems, assemble the sliding doors with at least 2 persons.

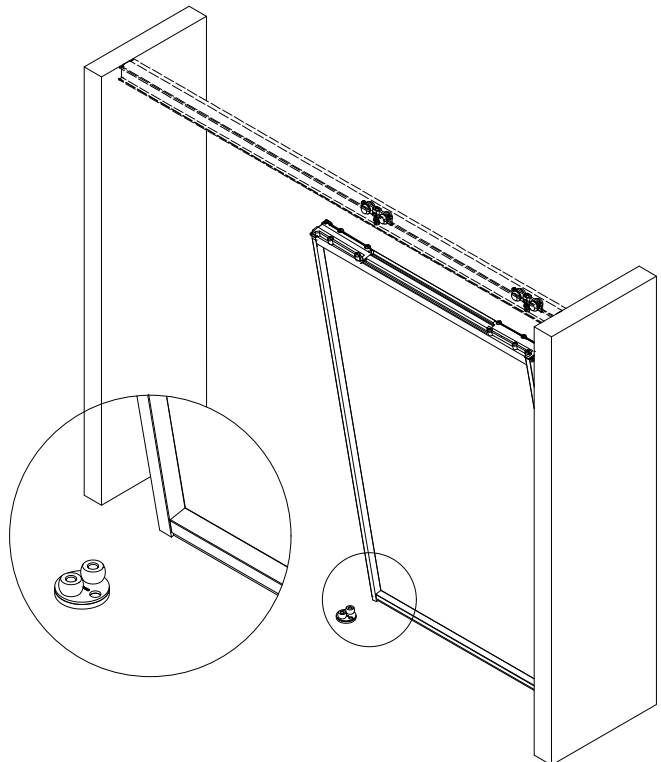

2\_ Install the **rear** sliding door and assemble the mounting rail.

# INSTALLATION INSTRUCTION

## SECOND TOP TRACK

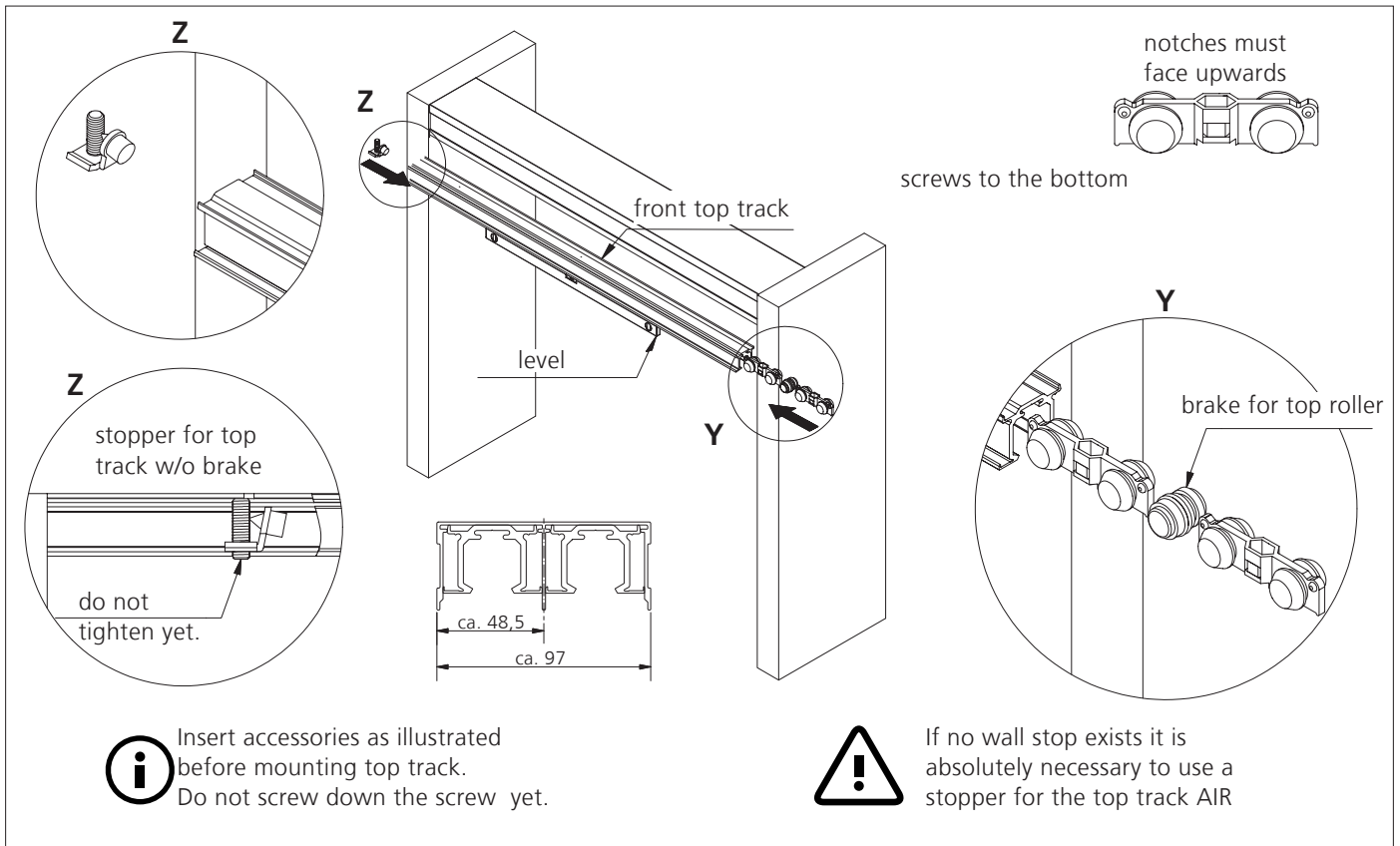

1\_ Drill holes in ceiling/top of corpus and mount the front top track horizontally (fig. w/o ceiling/corpus).

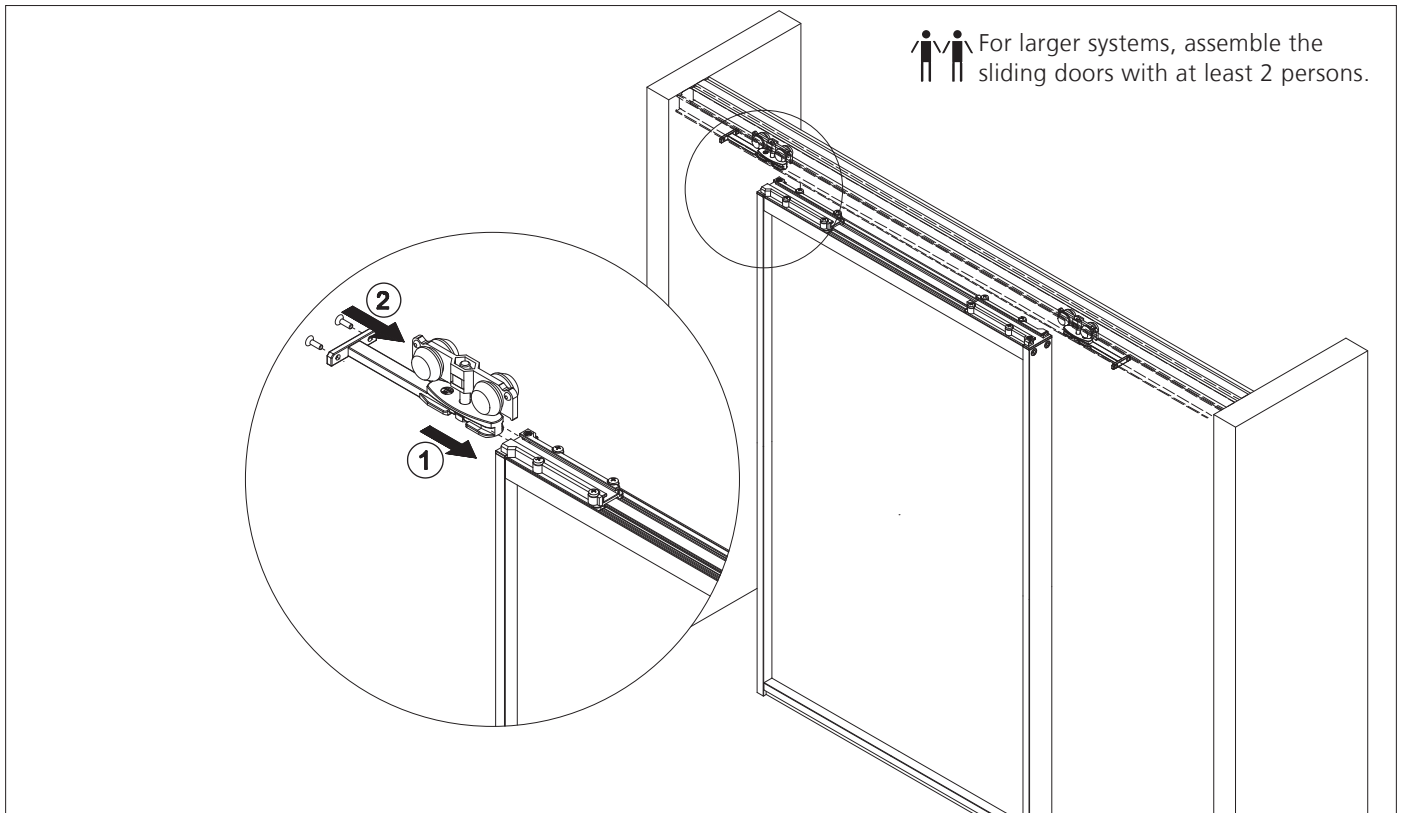

2\_ Put in the front door, slide the top roller with the pick up element into the mounting rail and mount it.



# INSTALLATION INSTRUCTION

## ADJUST SECOND SLIDING DOOR

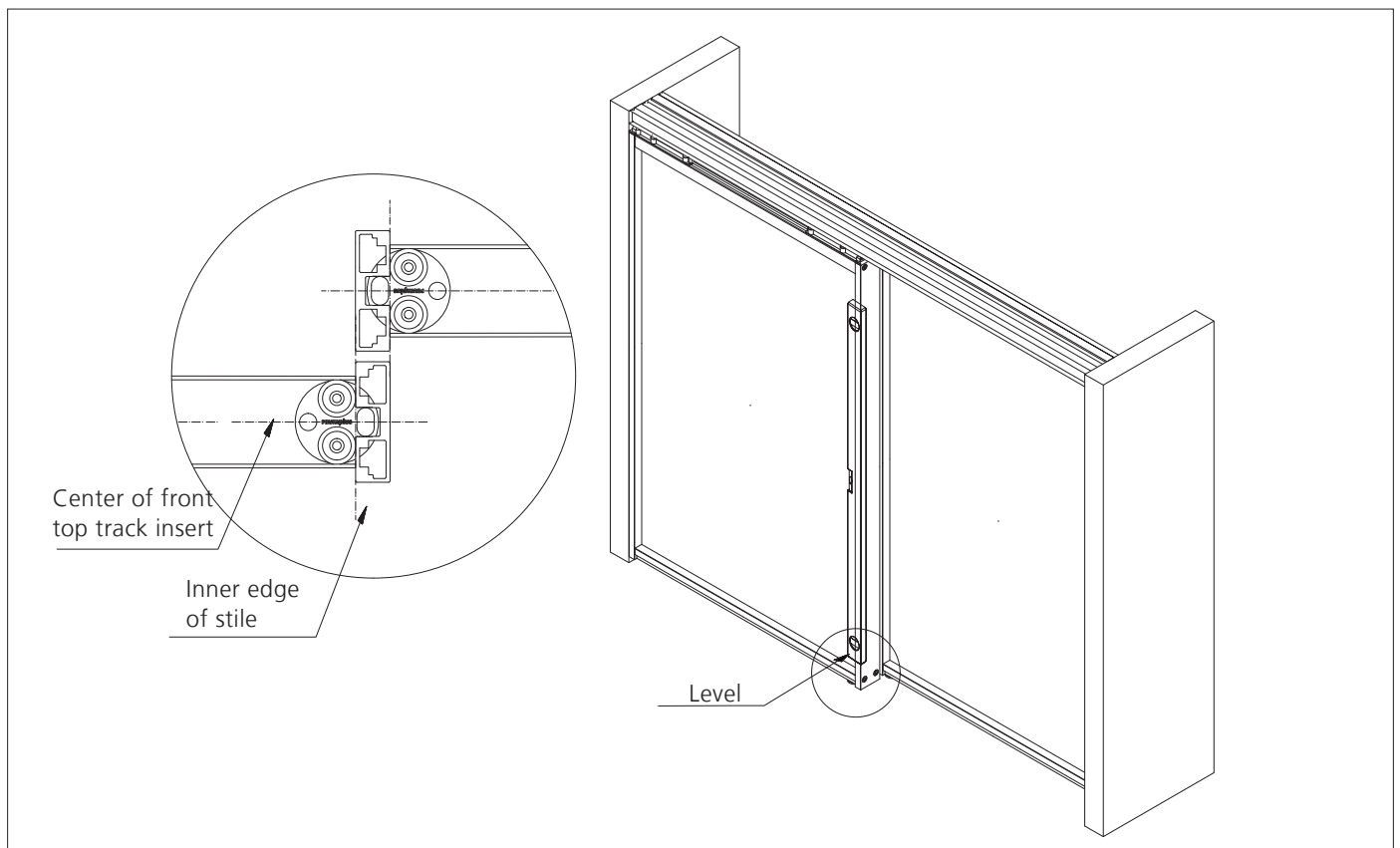

1\_ Mark position of ground plate (masking tape / pencil), unhinge rear sliding door and mount ground plate.

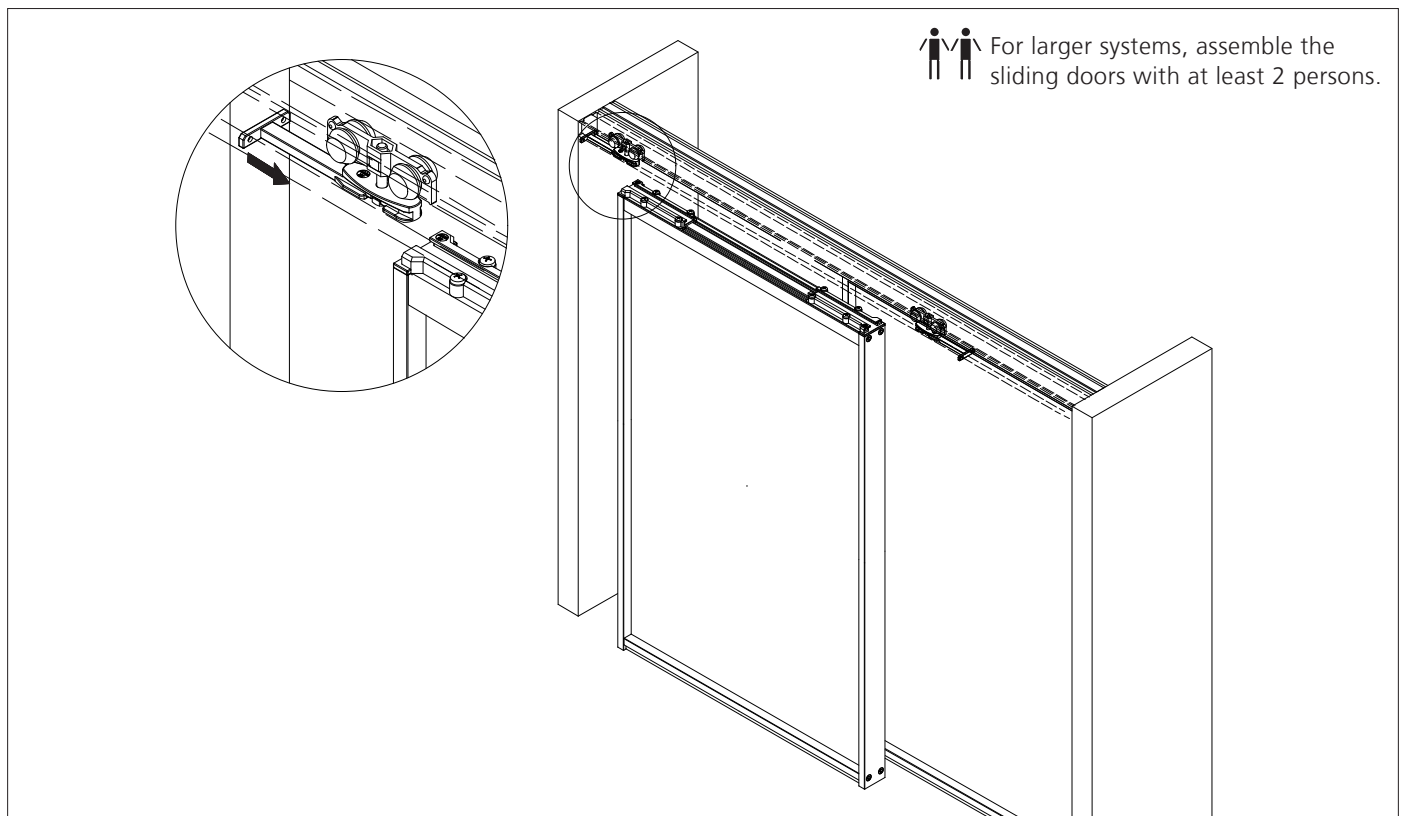

2\_ Put in the front door, slide the top roller with the pick up element into the mounting rail and mount it.

# INSTALLATION INSTRUCTION

## POSITION STOPPER

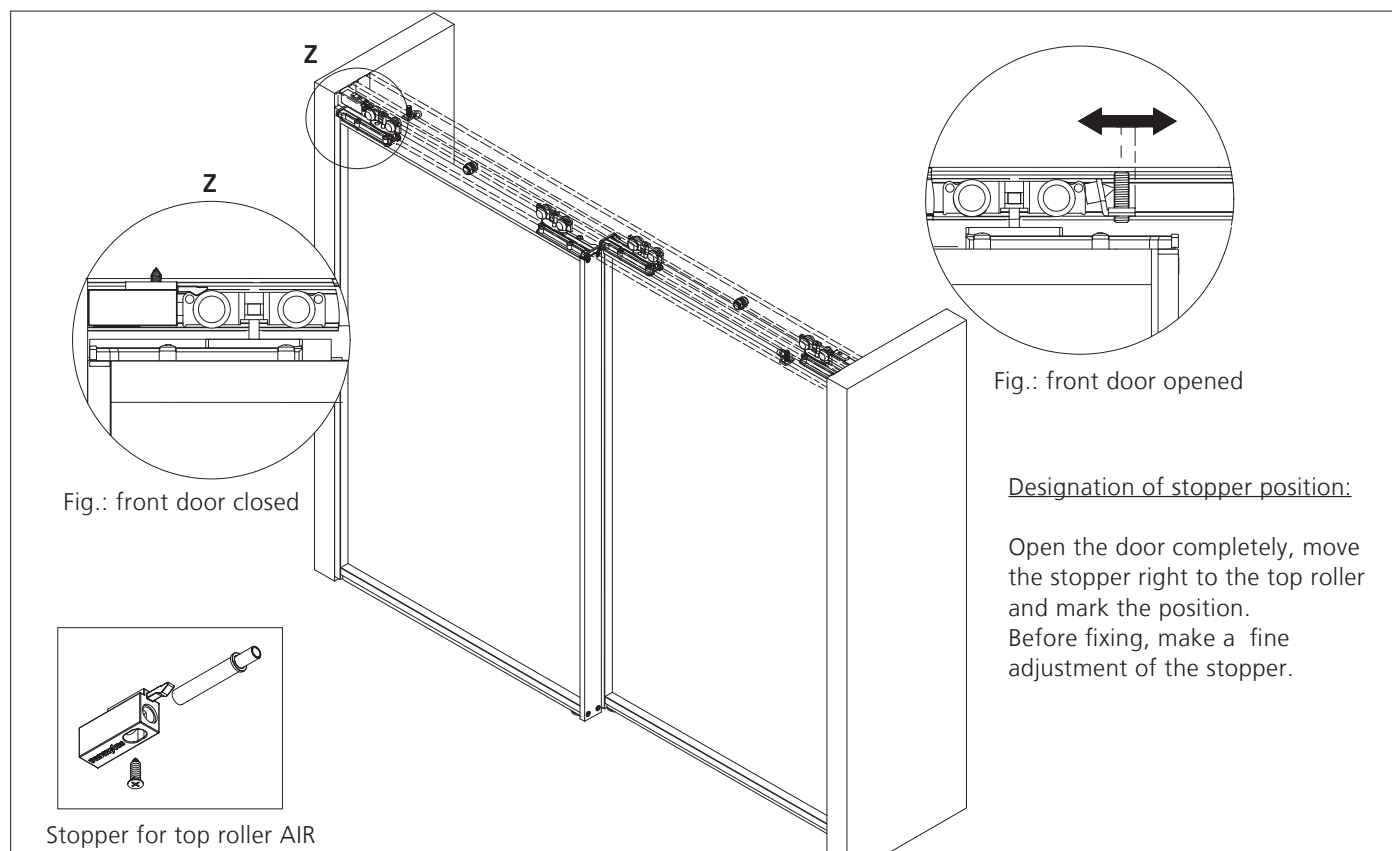

1\_ Mount stopper for top roller AIR in both top track inserts at closing positions.

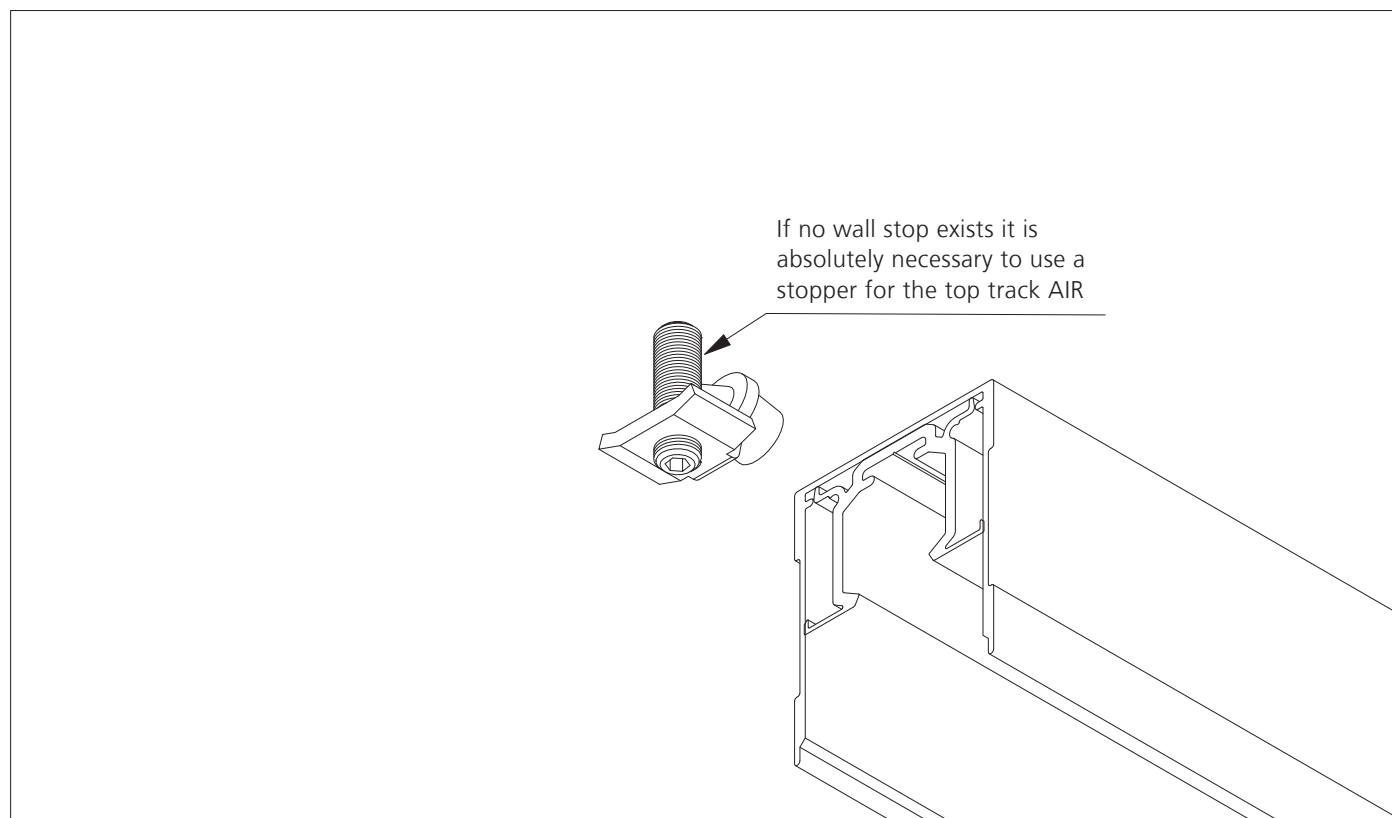

2\_ Stopper for top roller inside top track insert Air.

# DETAIL DRAWING

## SECTION DRAWING S1200 AIR-A / S1200 AIR-A SLIDING DOOR BRAKE

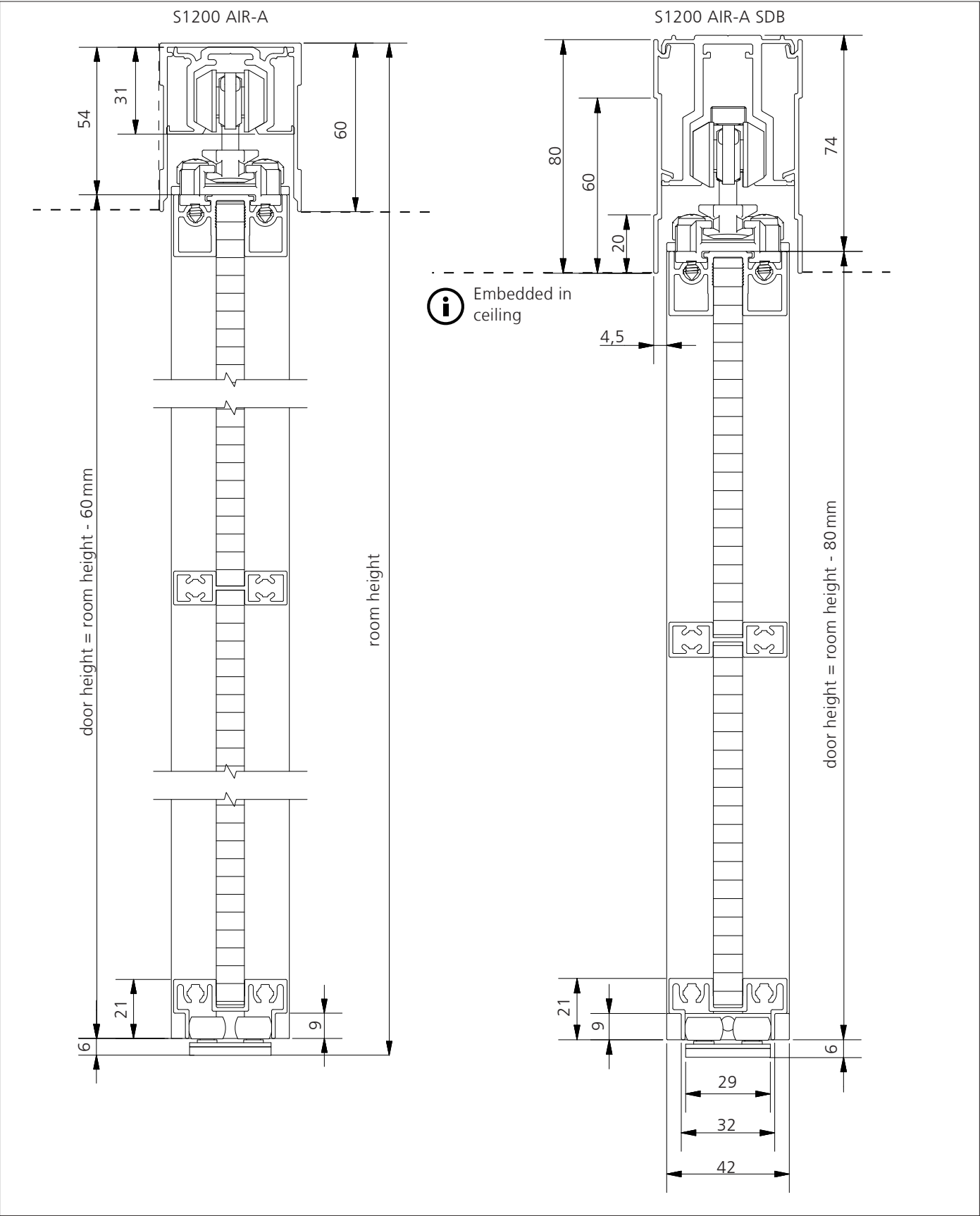

# DETAIL DRAWING

## TRAVERSING DISTANCE / PASSAGE WIDTH

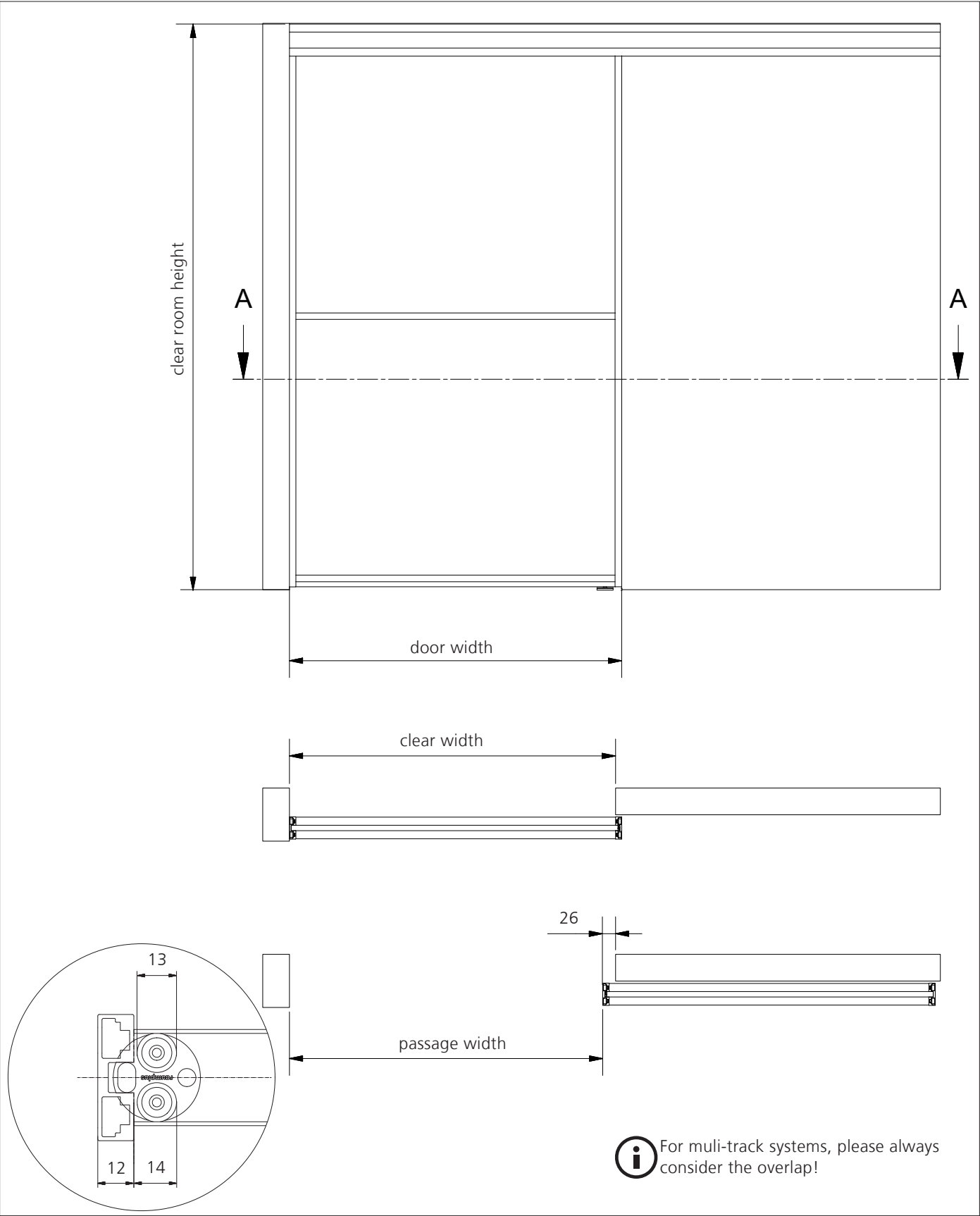

# DETAIL DRAWING

## HANDLE OPTIONS

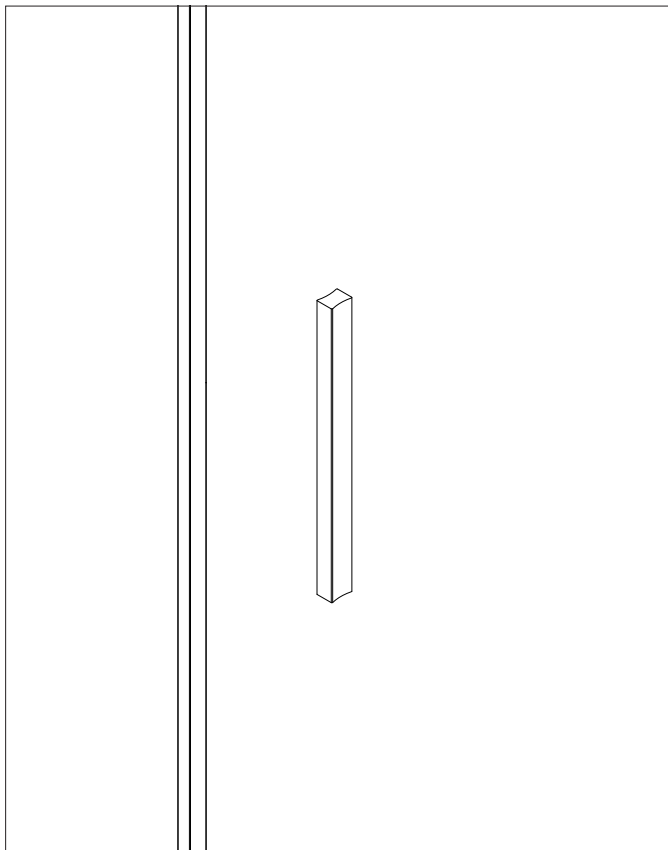

1\_ concave handle.

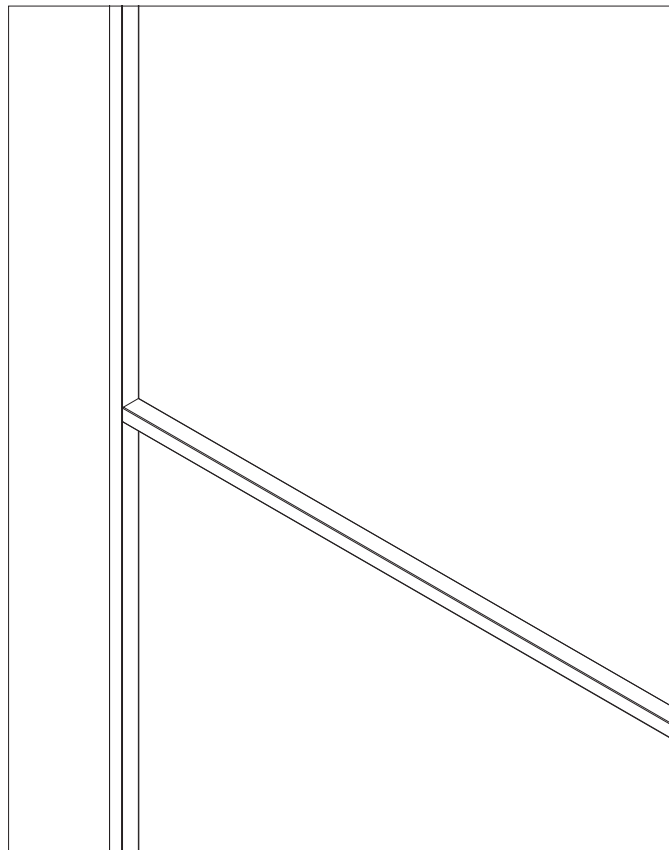

2\_ Dividing rail

# DETAIL DRAWING

## STOPPER FOR TOP ROLLER

0 mm

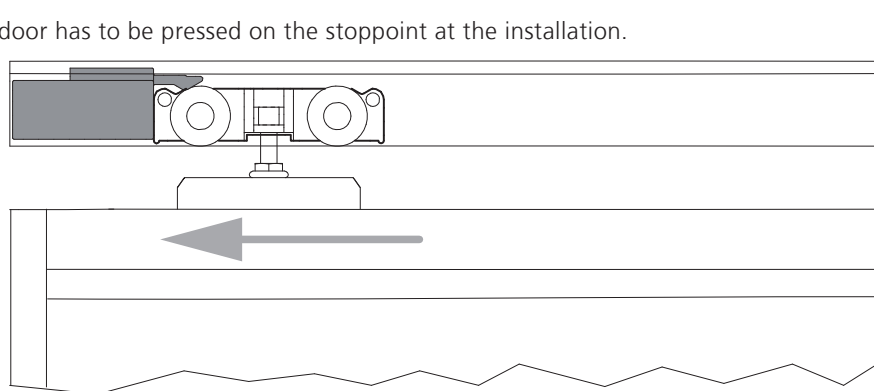
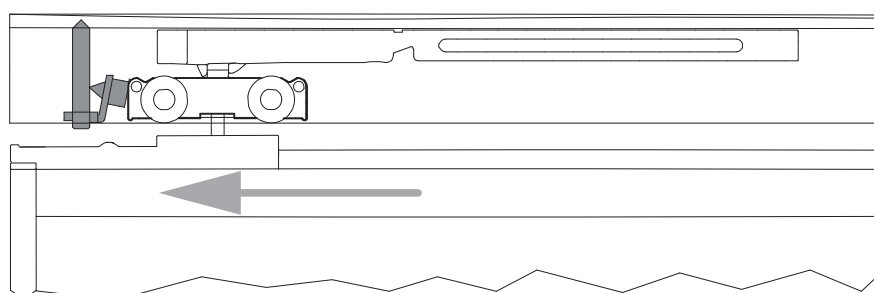
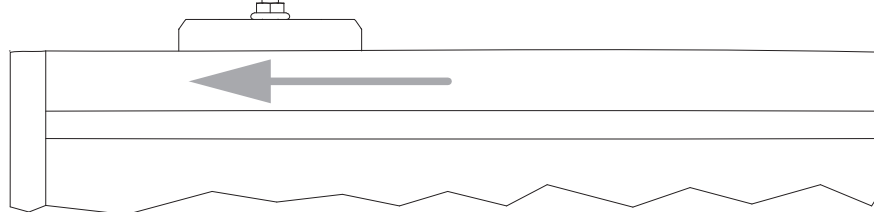
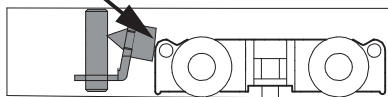

**i** The door has to be pressed on the stoppoint at the installation.

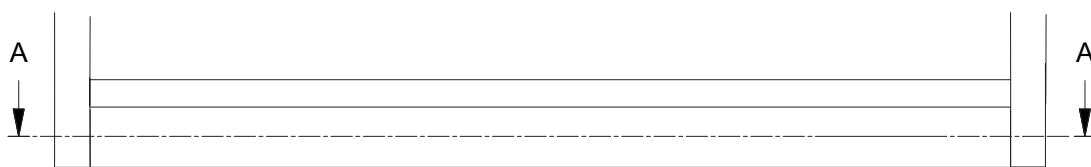
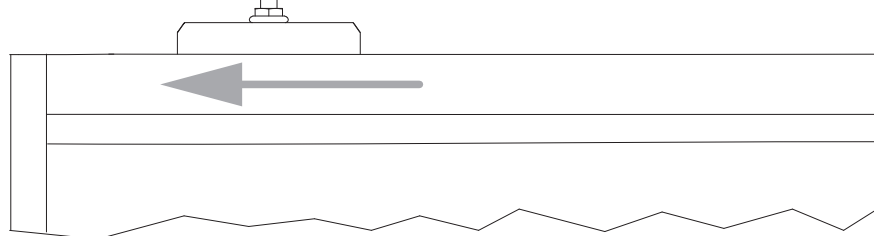
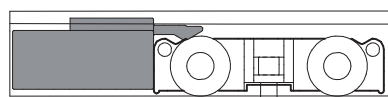

A-A

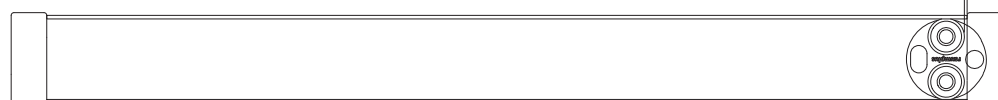

Attention!

The stopper for top roller inside the top rail are meant to be stoppoint to stop the door. The ground plate with roller air are **not** meant to be the stoppoint for the door and always requires space between the bottom roller and the stile to prevent a collision with the door and the roller.