

SLIDING DOORS: INSTALL & MANUAL INSTRUCTIONS

SYSTEM 42 AIR-B

Version 2.1 (2018-09-13)

easy

medium

difficult

Installation

subject to technical changes



CONTENT AND TOOLS

CONTENT:

Content and tools	page	02
Manual	page	03
Product information	page	05
Accessories	page	06
Installation instruction	page	07
Detail drawings	page	16
Installation instruction (C42/S1200)	page	18
Overlapping (S1500/S3000)	page	20
Stopper for top track	page	21

TOOLS:

(without claim of completeness)

- Aluminium saw
- Allen keys 1,5/3/(4)/5 mm
- 2x open-ended spanner (10 mm)
- Drilling machine
- Drills Ø6,5/(8,5)/10mm (stone / wood)
- Masking tape
- Pencil
- Water level
- Cross tip screwdriver



VERSION INFORMATION:







- Version 1.1: Redesign of manual and product information added
- 1.2: Installation instuction C42 / S1200
- 2.0: Ground plate with bearing added (p. 19)
- 2.1: Instruction for stoppoint added

PRODUCT INFORMATION

GENERAL INFORMATION: Preparation

- This manual is part of the product and describes the safe and proper installation of the system. Please read the instructions carefully before installation
- Please note that the assembly should only be done by qualified and trained staff in strict compliance with all details indicated in this document.
Improper installation in variation from manufacturer's specification may cause defects and danger, thus endangering the safe fixing of the product as well as the safety of the prospective user. The liability of the manufacturer shall be excluded in case of defects and consequential damages resulting from incorrect assembly of this product.
- Please check the completeness of the delivered parts and check carefully if any transport damages are visible.
- If any parts are damaged or lost, please immediately contact the responsible supplier.
- It is assumed that you have exactly identified all cutting dimensions according to the measurement instruction for **raumplus** products.

SYMBOLS:

Symbol	Importance
	Risk or danger!
	Advice and information
	Additional information / other documents
	Directional data / direction of movement
	„yes“ and „right“
	„no“ and „wrong“
	Follow the order

SYSTEM:

System Information: AIR-B S42

- max. weight of element = **60 kg**
- min./max. door height = **700 mm / 2750 mm**
- min./max. door width = **500 mm / 1200 mm ▲(S 1200 ≤ 1400 mm)**

PRODUCT INFORMATION

GENERAL INFORMATION: **Product safety**

- The door system complies with the prior of the art and the authorized safety rules at the time of delivery.

USE:

Intended use

- The prerequisite for the intended use of our products is the professional installation according to our installation instruction. Sufficient fittings must be available and durably installed to all relevant places.
The function of the fittings must not be hindered or altered during installation.
- Special solutions are only possible in consultation with **raumplus**.

Incorrect use

- Risk or danger may occur in the following cases:
 - the door system has improperly been installed or maintained
 - the safety and installation instructions have not been followed.
 - after improper installation or inadequate fixing (e.g. to parts of buildings)
 - the maximum weight of the doors has been exceeded.
 - improper shock and case loads or other additional loads on the fittings have occurred
 - the fittings have been used outside.
 - body parts or objects got into the closing edges or door runnings during use of the door wing.
 - the door system is not used as intended.

Structural modifications

- Structural modifications that are not offered as an accessory from **raumplus** may only be attached or installed with permission of **raumplus** GmbH!

MANUAL

This manual is part of the delivered product and describes the safe and proper use.

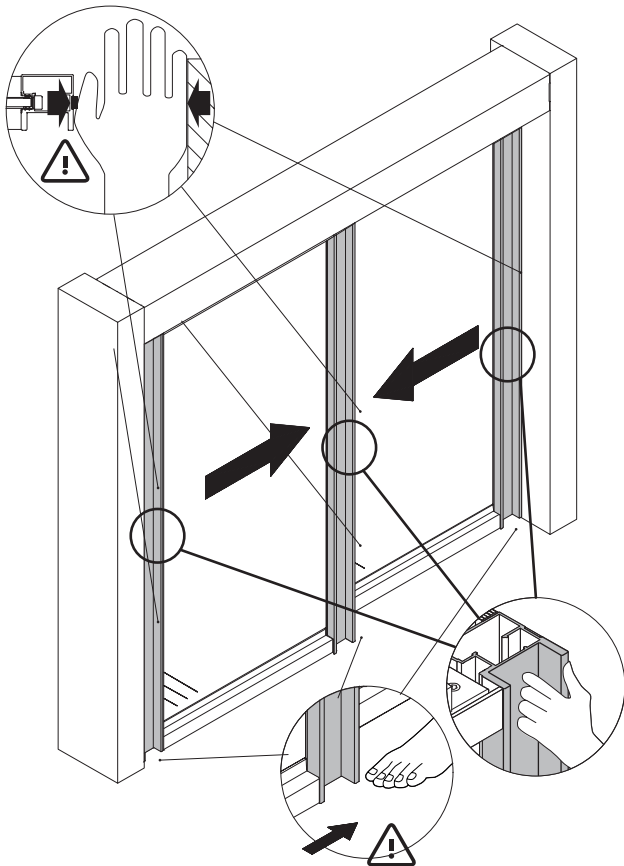

Designated use:

The product is designed and manufactured for indoor use.

The product was designed as a hand-guided sliding door that is usually not being moved faster than walking speed and should be stopped manually when reaching the end position. The doors are guided on top and bottom track.

Any other use that deviates from the specific proper use is not according to the **raumplus** regulations.

Manual:

Open the door by using the handle profile or the handle (optional).

Guide the door slowly to the ...
... opening / closing point, or
... activating point of the sliding door brake (optional).

Attention:

Preserve your hands from getting trapped during the movement of the door. When closing or opening the door never take hold of the profile, only use the handle profile or the handle.

Use the door as instructed.

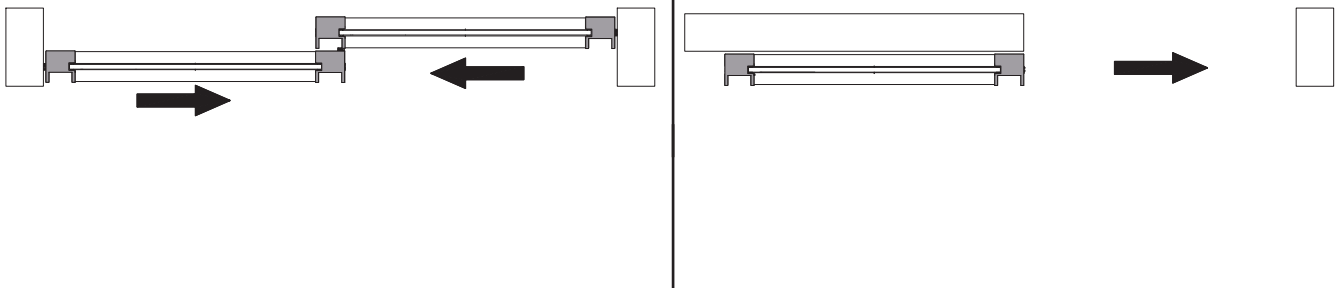

Safety Information:

The product complies with the prior of the art and the approved safety rules at the time of delivery.

- Pay attention to child safety.
- No additional load to the doors.
- Structural changes, additions or modifications can only be carried out by a distributor.
- In case of malfunctions or irregularities: shut down the system and contact your dealer.
- ⚠ For Installation without wall connection: use of top / bottom stopper is obligatory 📄!

As defined in the „Law of Liability for Products“ (§4 Prod-HaftG), for the liability of the manufacturer, for his products, the above information has to be regarded. The disregard of this manual, releases the manufacturer from his liability.

ACCESSORIES

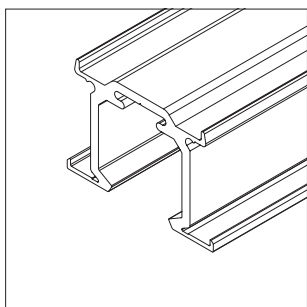

1_ 14.55.0xx

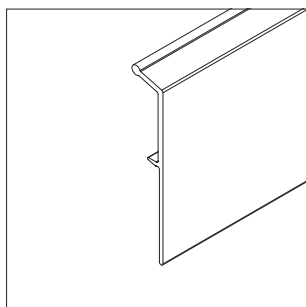

2_ 14.53.0xx

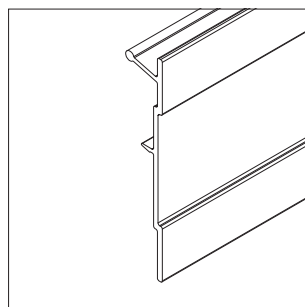

3_ 14.50.0xx

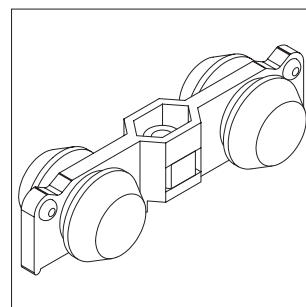

4_ 10.06.200

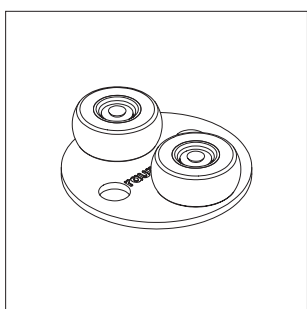

5_ 10.06.030

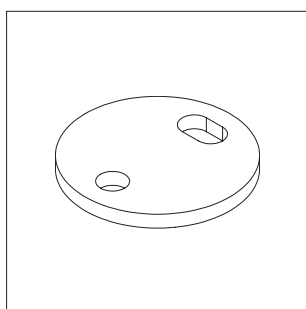

6_ 10.05.025

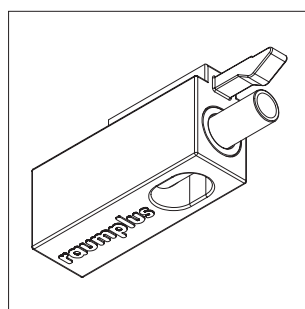

7_ 10.05.017

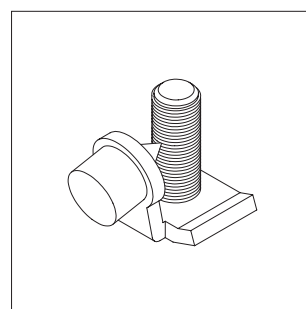

8_ 10.05.060

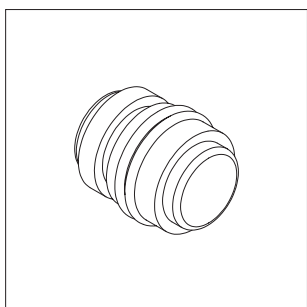

9_ 10.05.030

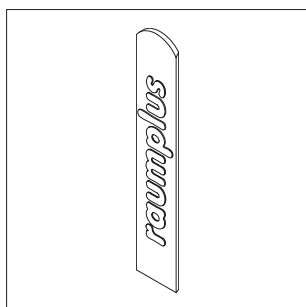

10_ 10.07.05x

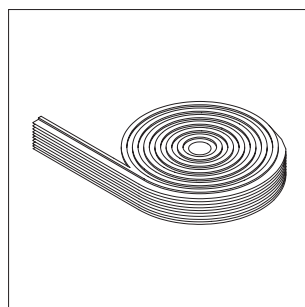

11_ 10.07.02x

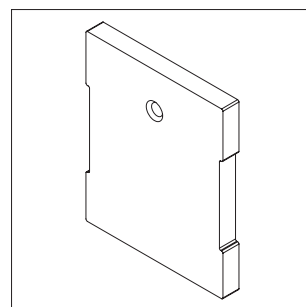

12_ 10.05.291

1_ Top track insert AIR

2_ Middle insert profile AIR

3_ Cover for top track insert AIR

4_ Top roller AIR

5_ Ground plate with roller air S42 / except S1200
distance plate air S42 / except air S1200

6_ Ground plate w/o rollers AIR

7_ Stopper for top roller with door brake AIR

8_ Stopper for top track AIR

9_ Brake for top roller AIR

10_ Plug for punching holes

11_ Dust excluding brush, grey

optionally:

12_ End cap for insert profile

w / o illustration:

13_ End cap for wall connection profile

Art.: 10.05.2xx

14_ Connector for end cap

Art.: 10.05.290

15_ Screw for wall connection profile

Art.: 10.07.081

16_ Nut for wall connection profile

Art.: 10.07.082

17_ Wall connection profile Air S42

Art.: 14.54.020

18_ Bracket for dust excluding

Art.: 10.01.039

DETAIL DRAWING

HORIZONTAL SECTION



Screws and dowels for mounting the top track must be adapted to the respective ground.

The carrying capacity must be at **60kg** per door.

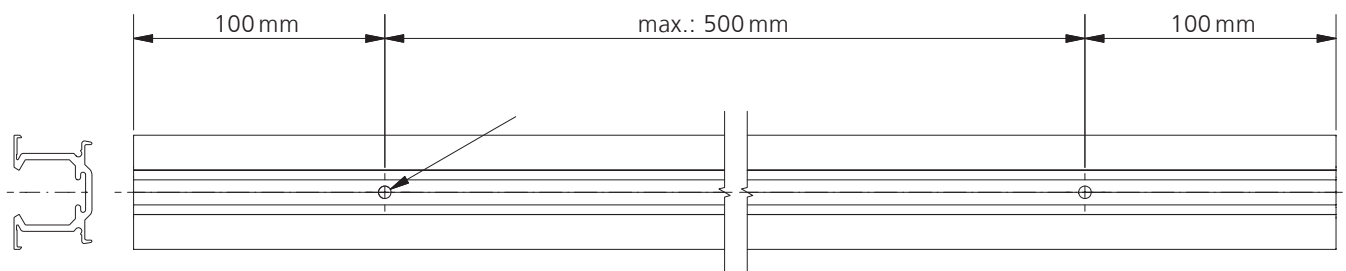

1_ Cover for top track AIR, middle insert profile and top track AIR size cutting. Make fixing holes in top track AIR



Set screws and counter-nuts are supplied with the door

Notches facing to top

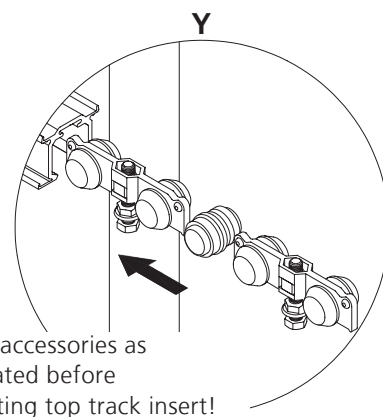
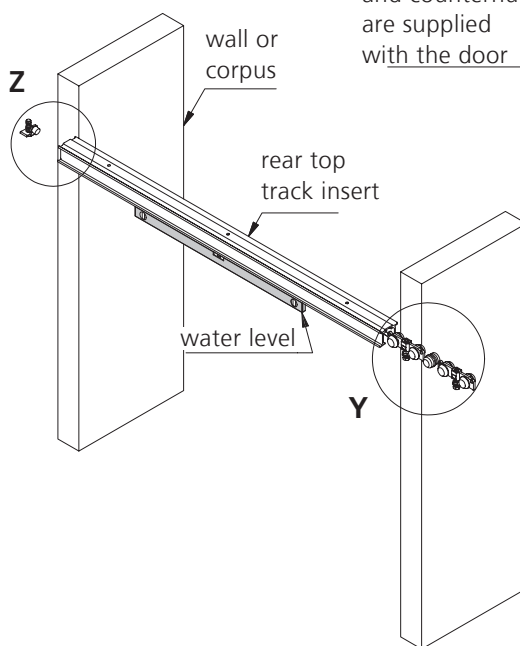
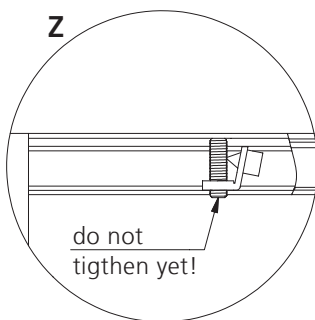
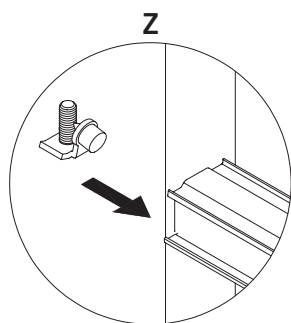
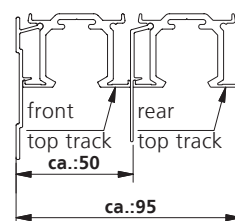
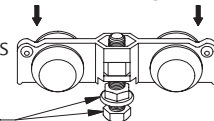

2_ Drill holes in ceiling/top of corpus and mount the rear top track insert horizontally (fig. w/o ceiling/corpus)

INSTALLATION INSTRUCTION

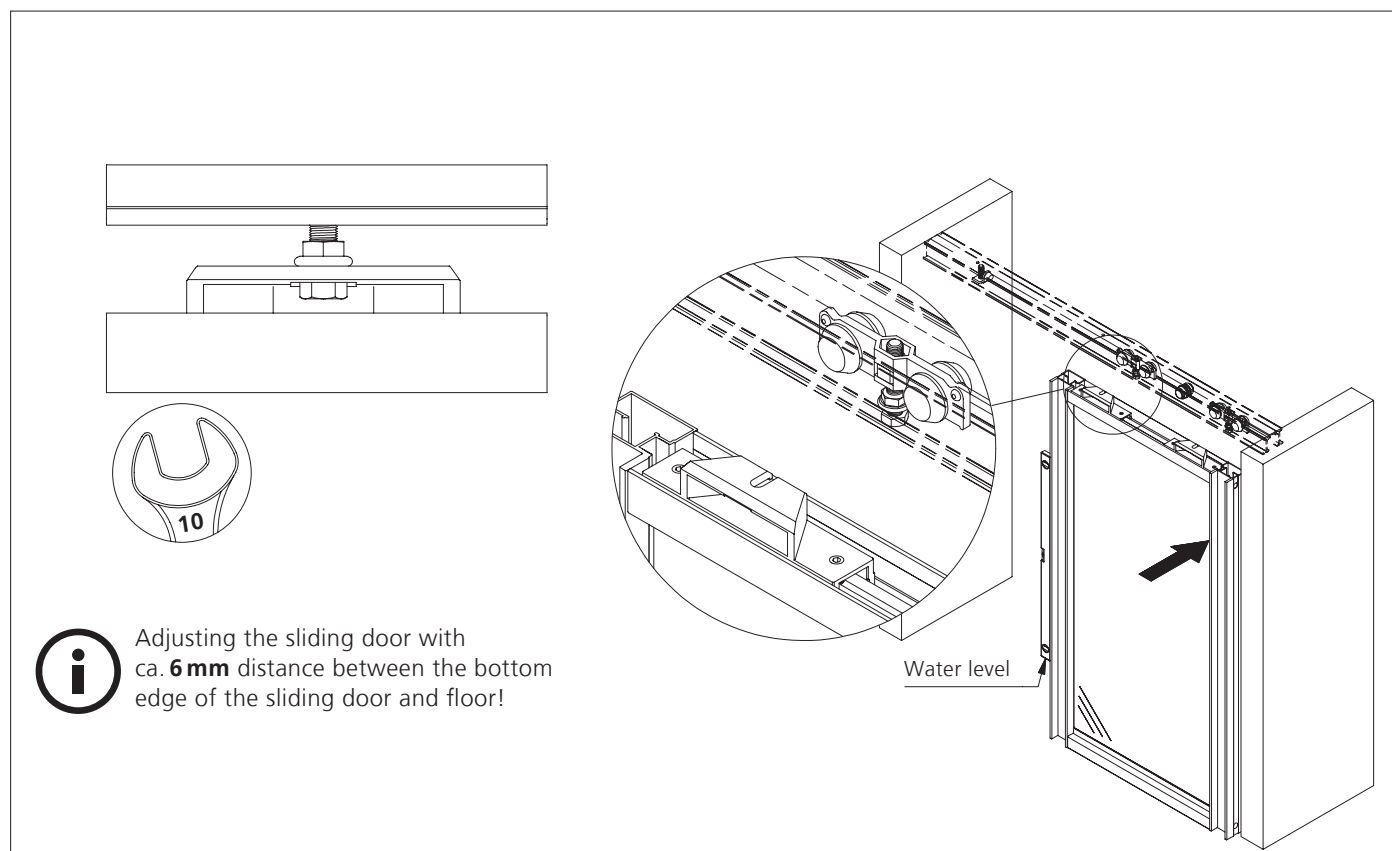

3_ Hinge the rear sliding door and adjust perpendicular with the set screws - do not tighten yet

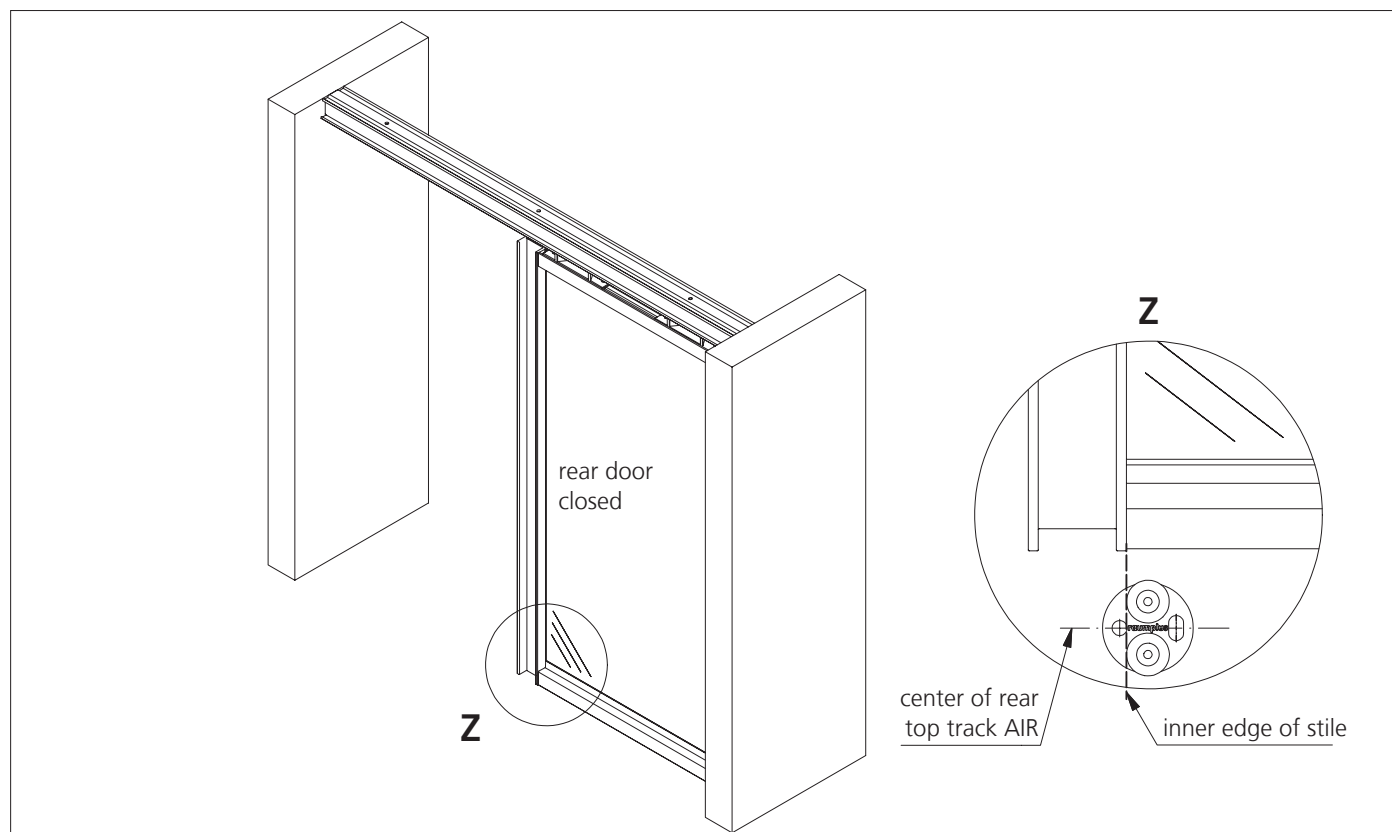

4_ Mark position of the ground plate (masking tape / pencil), unhinge rear sliding door and mount the ground plate

INSTALLATION INSTRUCTION

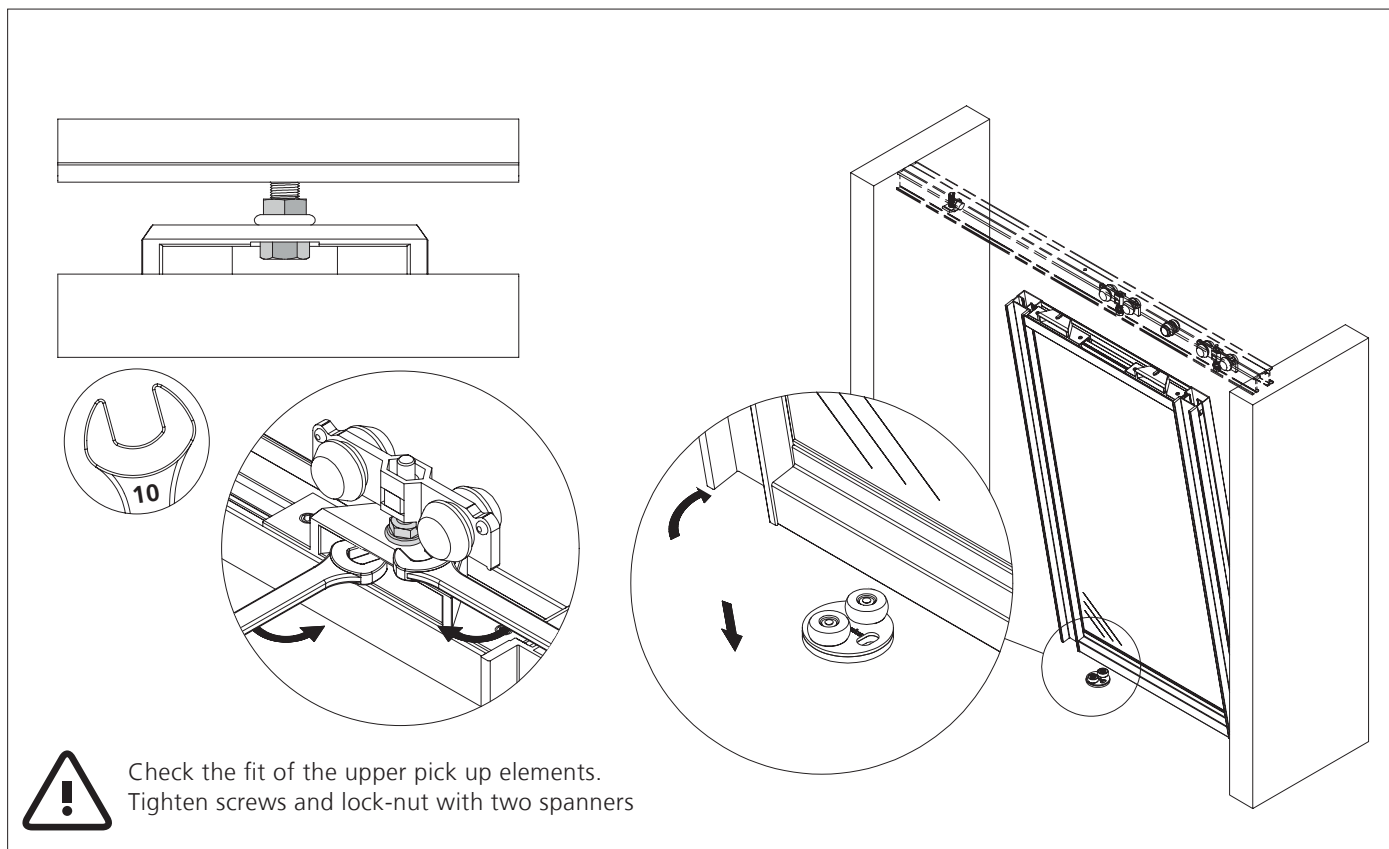

5_ Hang the rear sliding door, then tighten the counternuts at the pick up elements

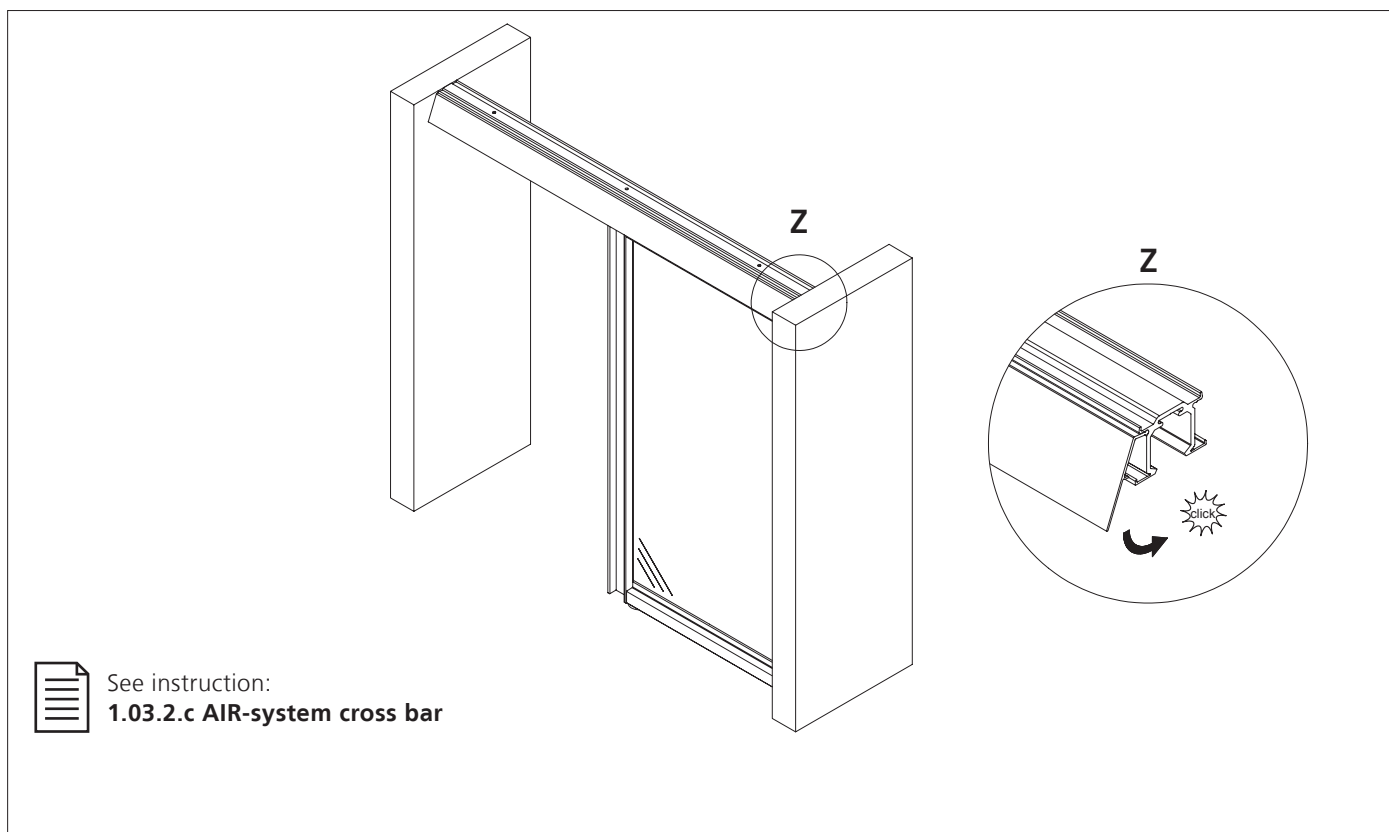

6_ Mount the middle insert profile

INSTALLATION INSTRUCTION

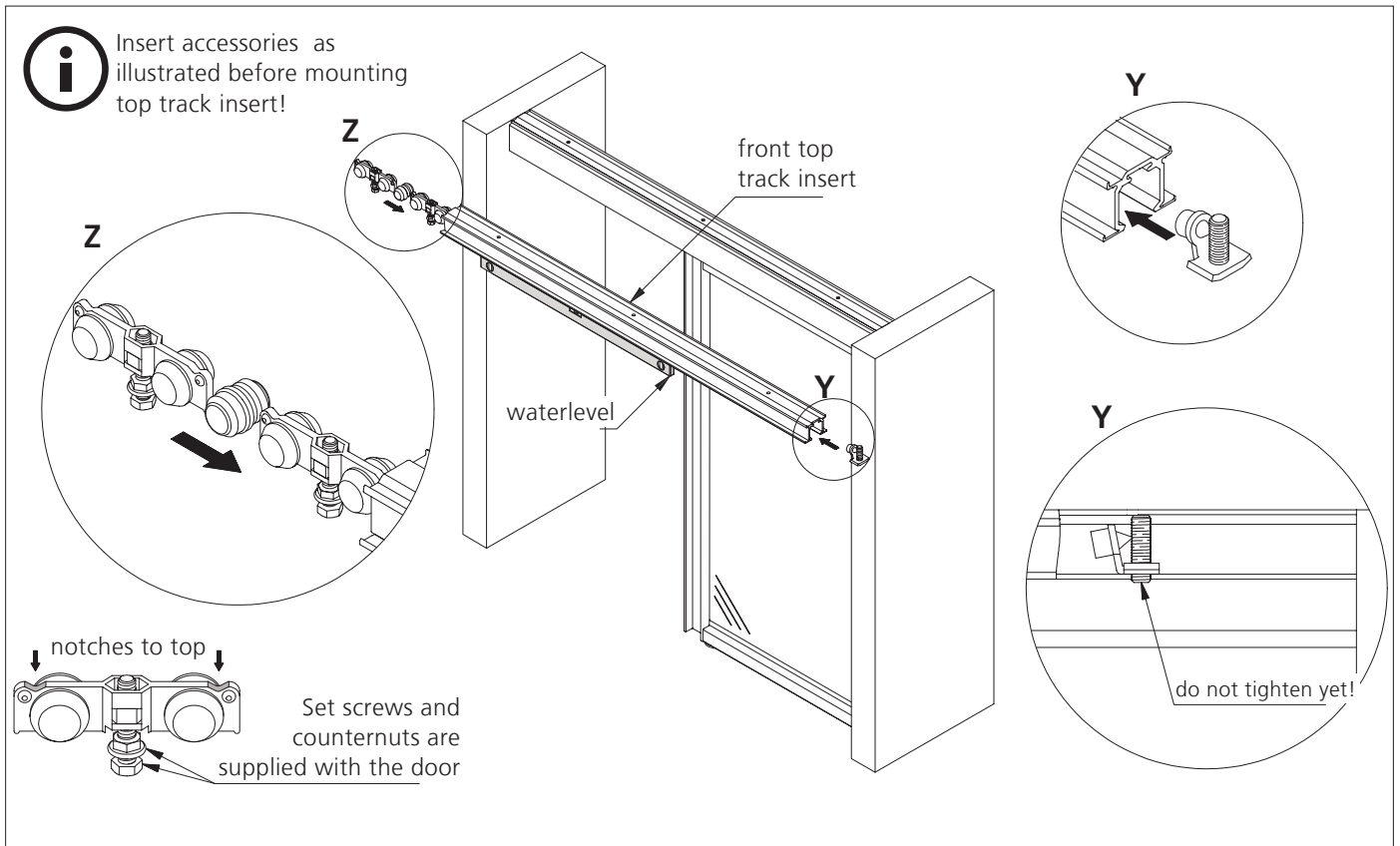

7_ Drill holes in ceiling/top of corpus and mount the front top track horizontally (fig. w/o ceiling/corpus)

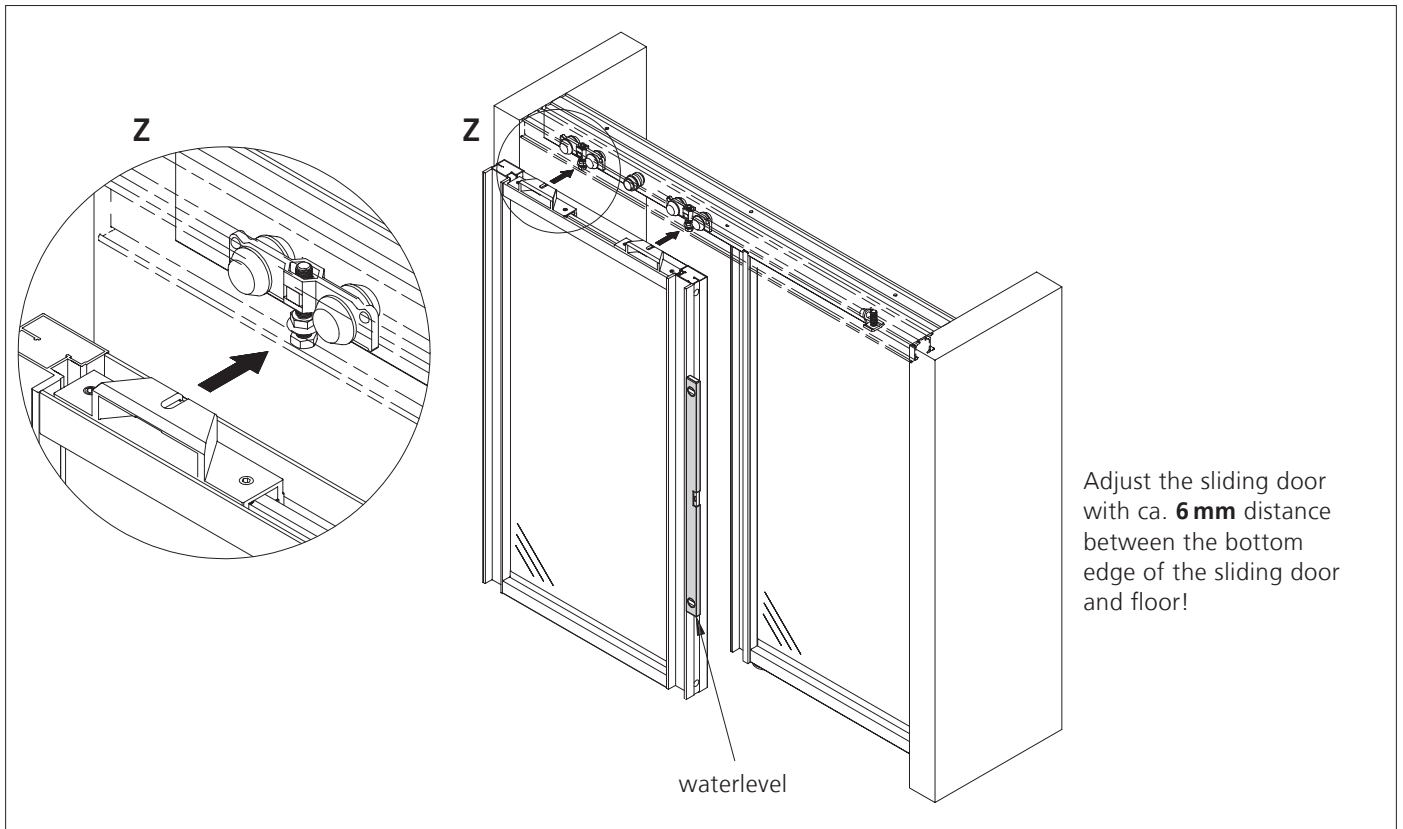

8_ Hang the front sliding door and adjust perpendicular with the set screws - do not tighten yet

INSTALLATION INSTRUCTION

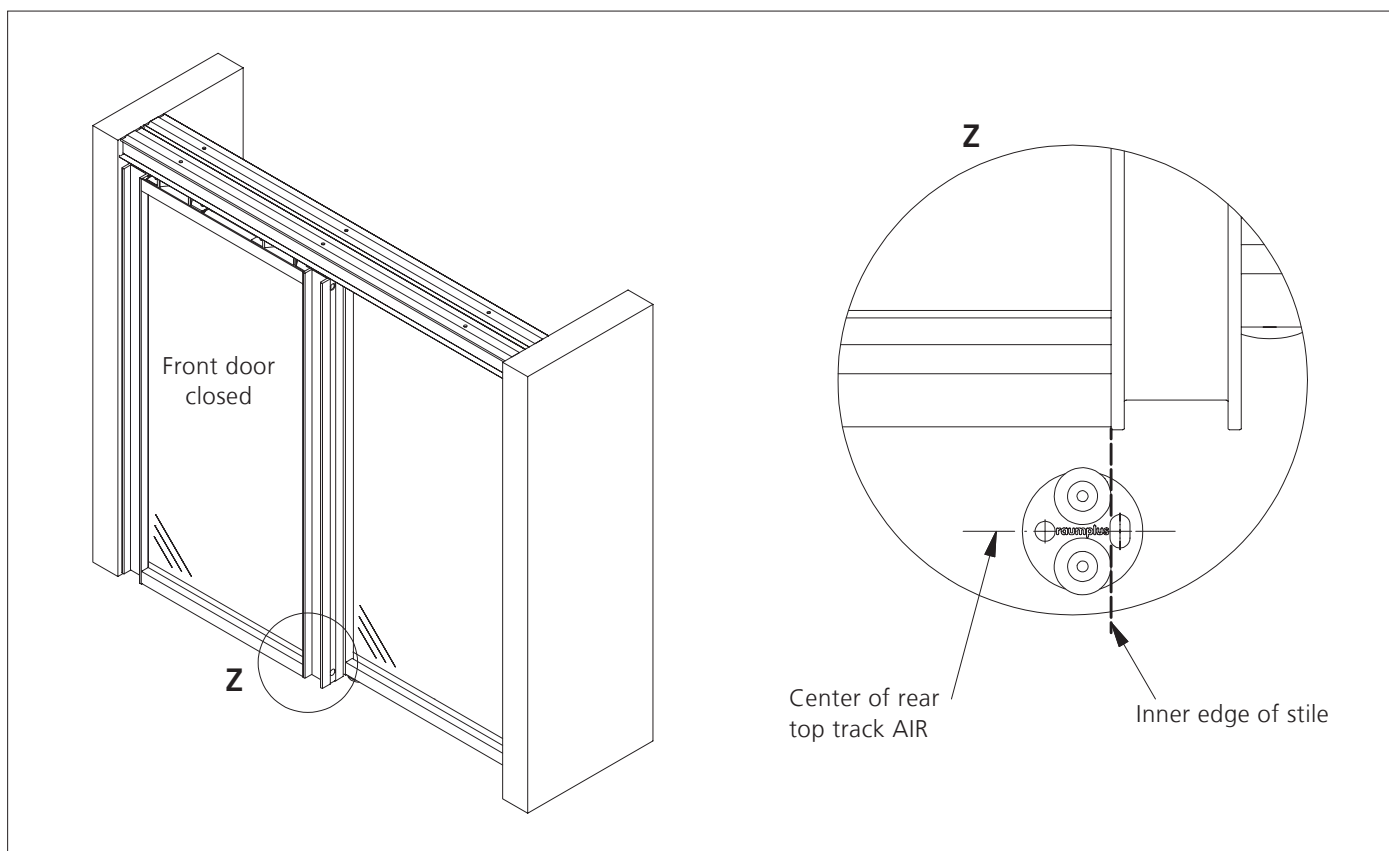

9_ Mark position of ground plate (masking tape / pencil), unhinge front sliding door and mount ground plate

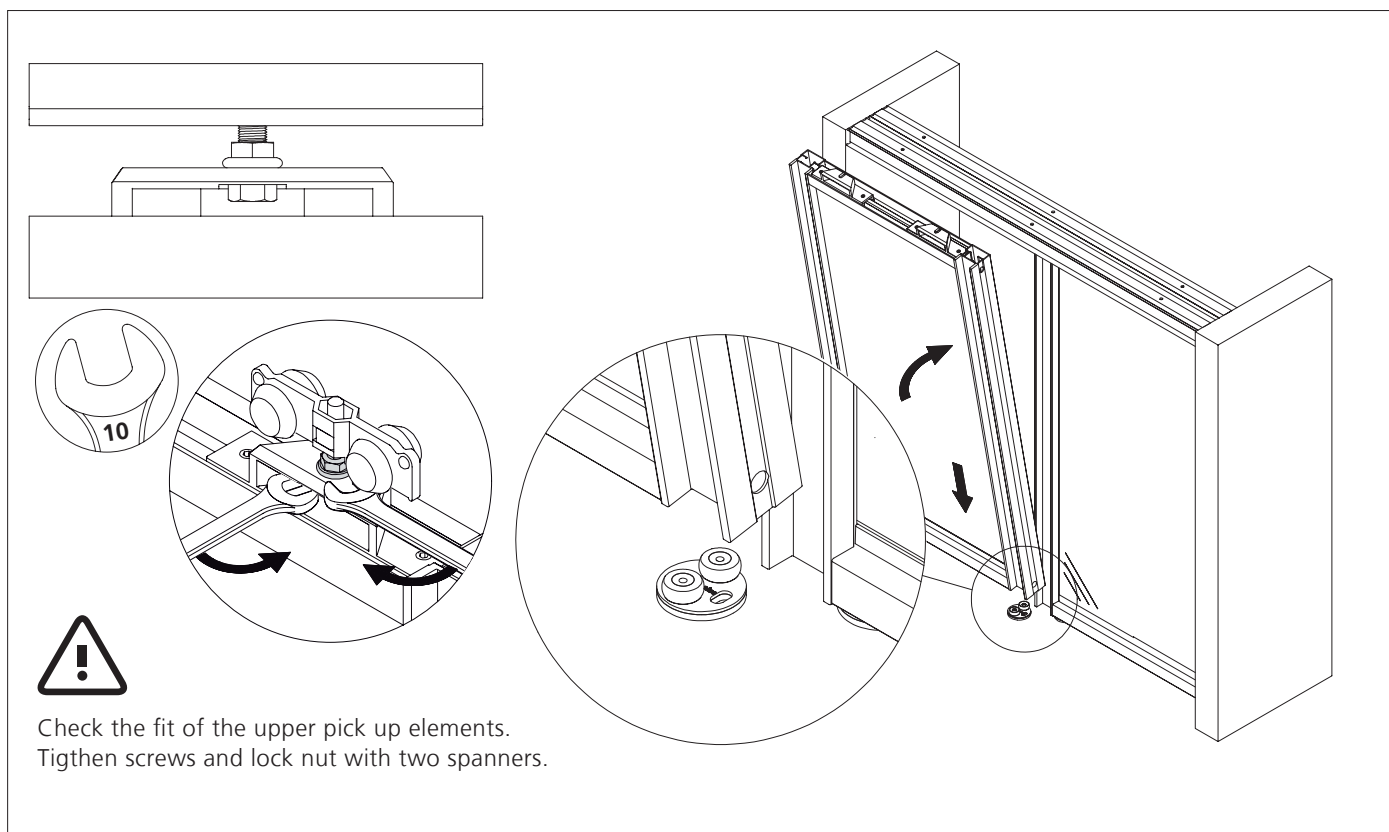

10_ Hinge front sliding door, then tighten the counter nuts at the pick up elements

INSTALLATION INSTRUCTION

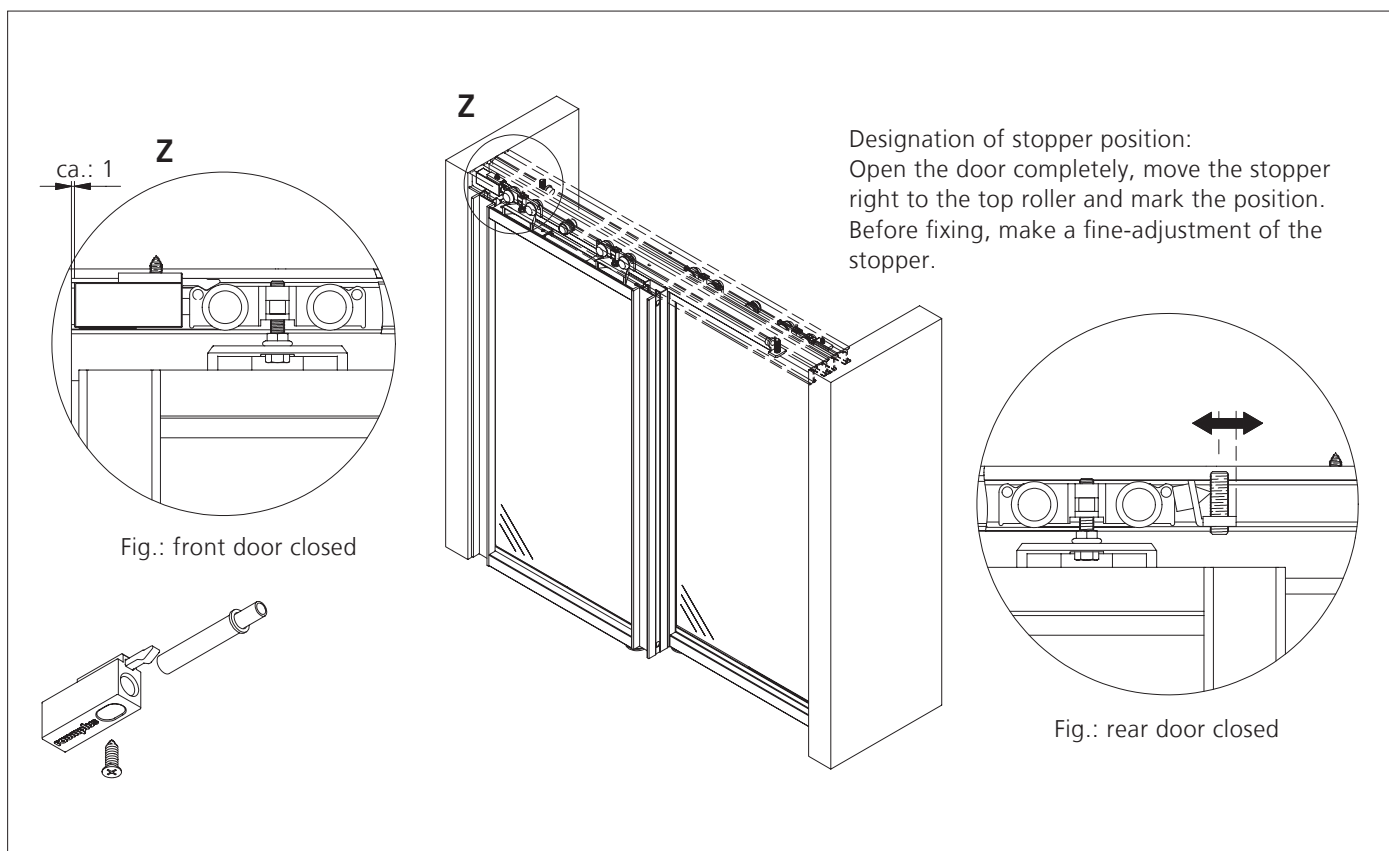

11_ Mount stopper for top roller with door brake AIR in both top track inserts at closing positions

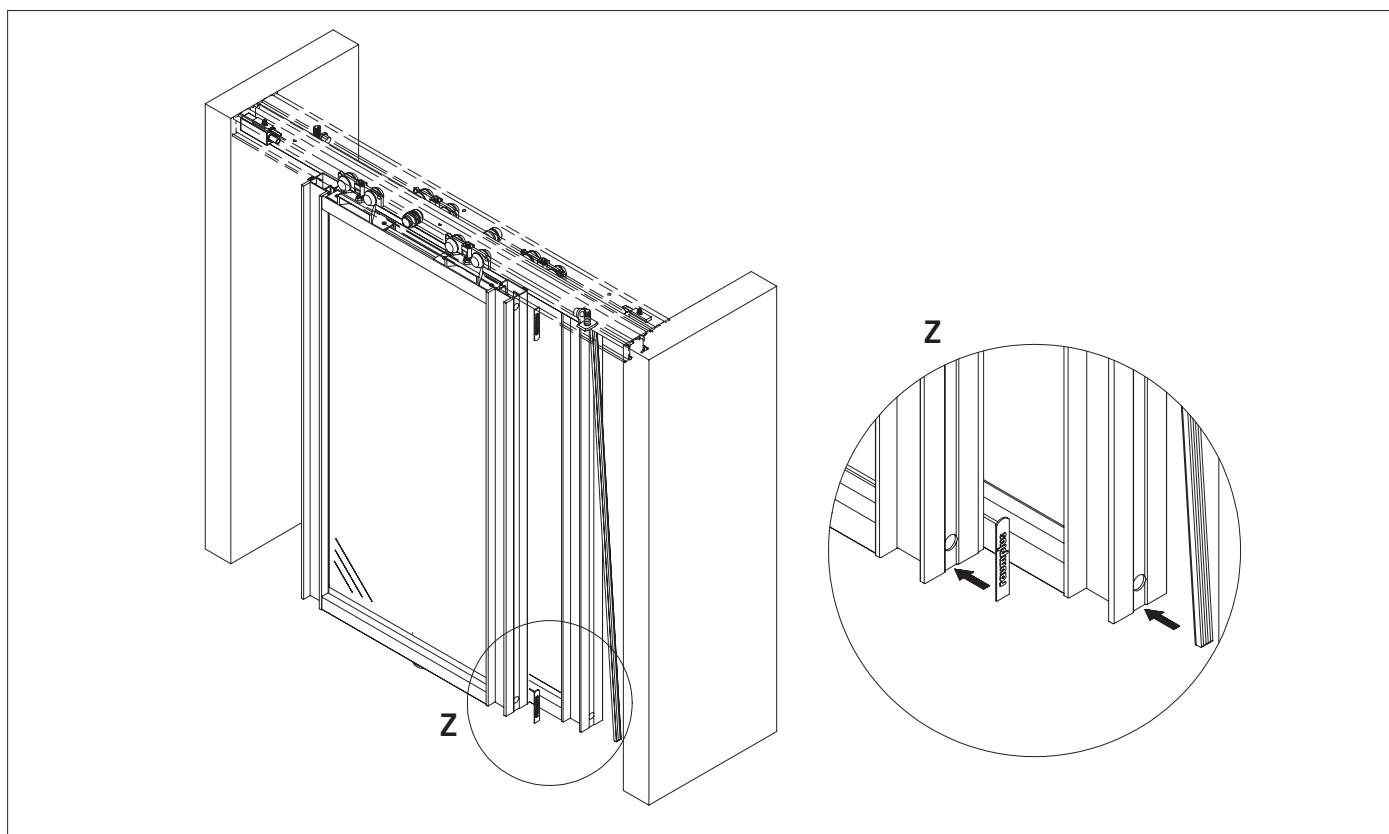

12_ Stick on dust excluding brushes and plugs for punching holes (see page 15)

INSTALLATION INSTRUCTION

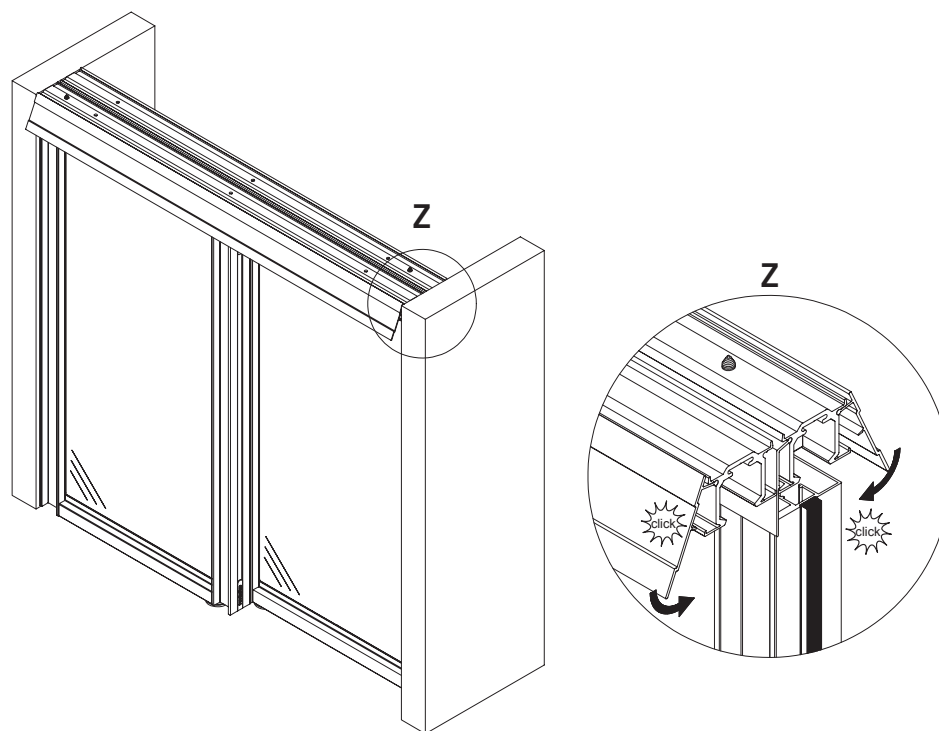

13_ Apply covers for top track insert on front and back

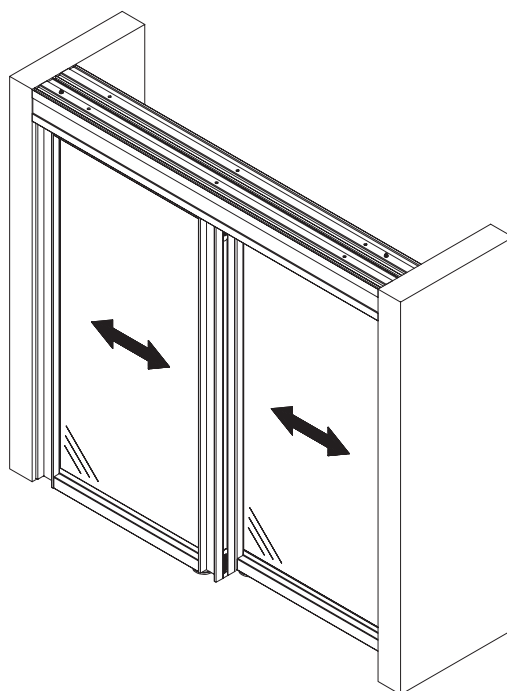

14_ Test the function

INSTALLATION INSTRUCTION

ACCESSOIRES TOP TRACK WALL MOUNTED

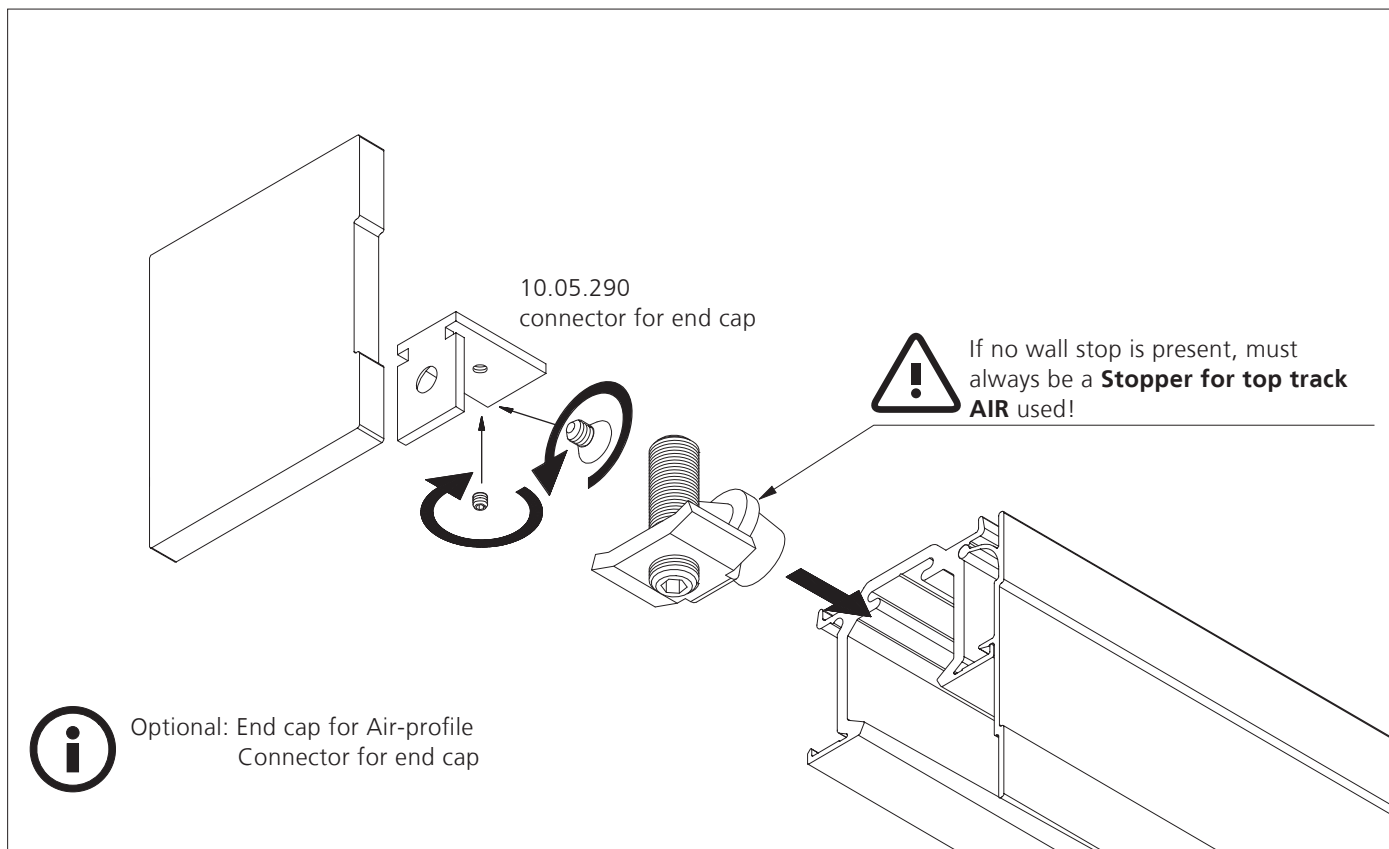

1_ End cap for wall connection profile, left / stopper for top track AIR

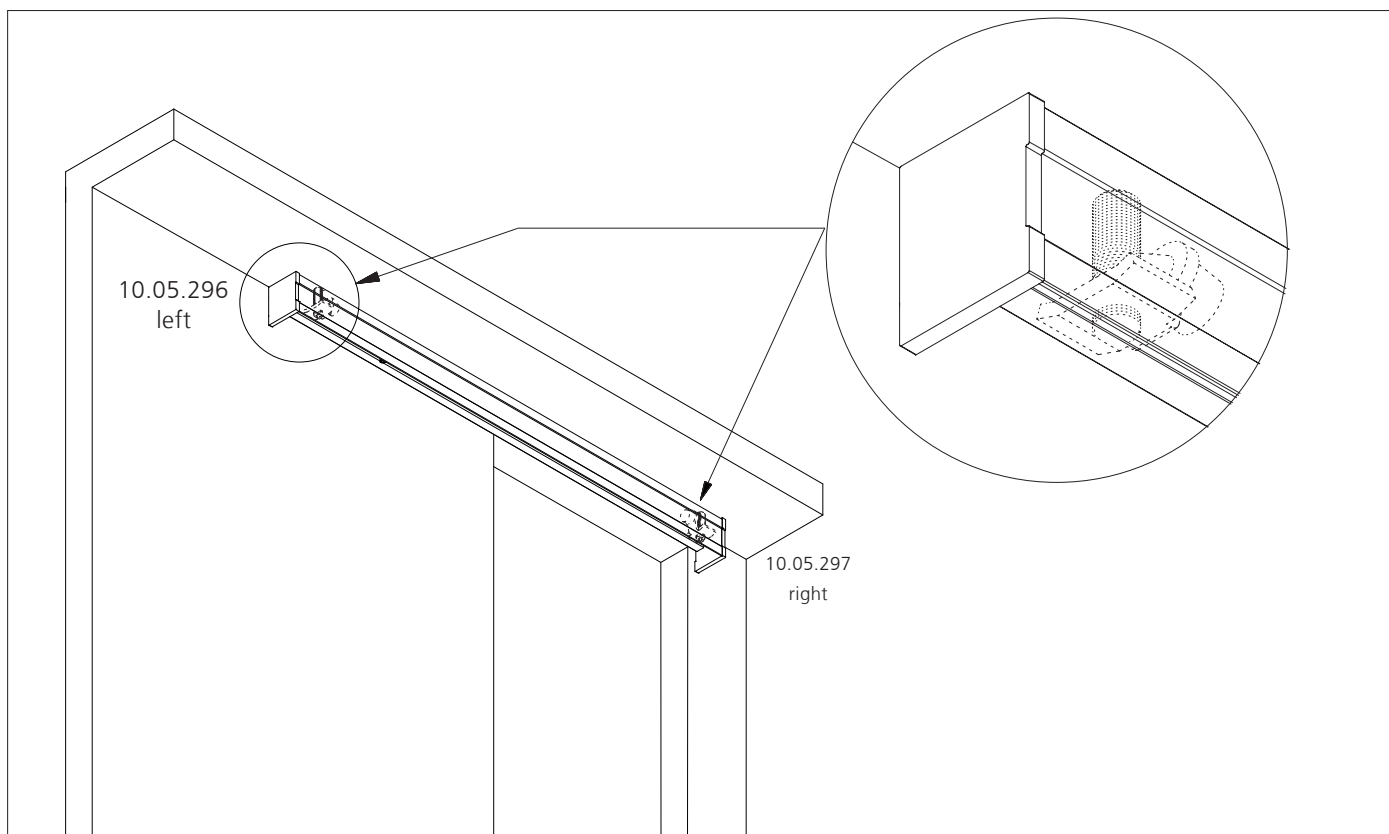

7_ End cap / stopper for top track AIR

INSTALLATION INSTRUCTION

POSITIONS OF THE DUST EXCLUDING BRUSHES

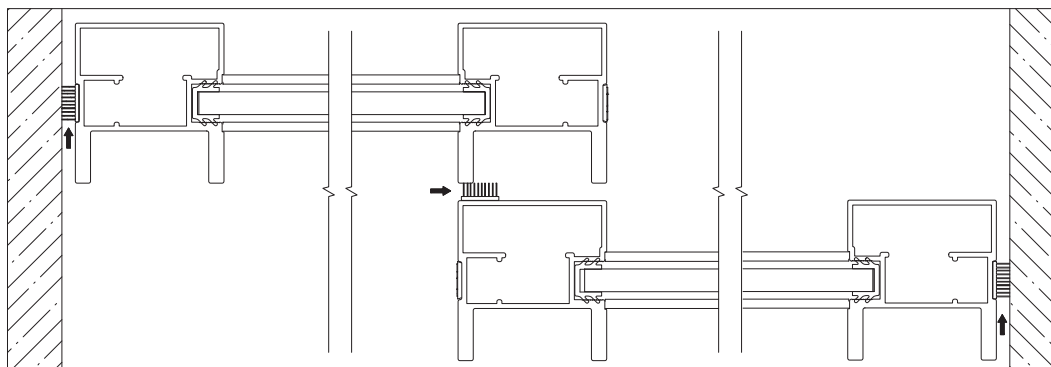

e.g.:
„normal” solution

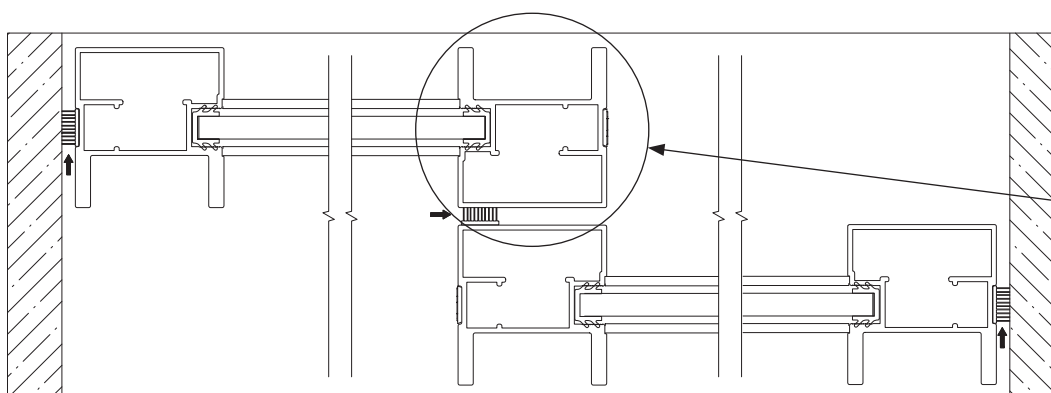

e.g.:
profile rotated

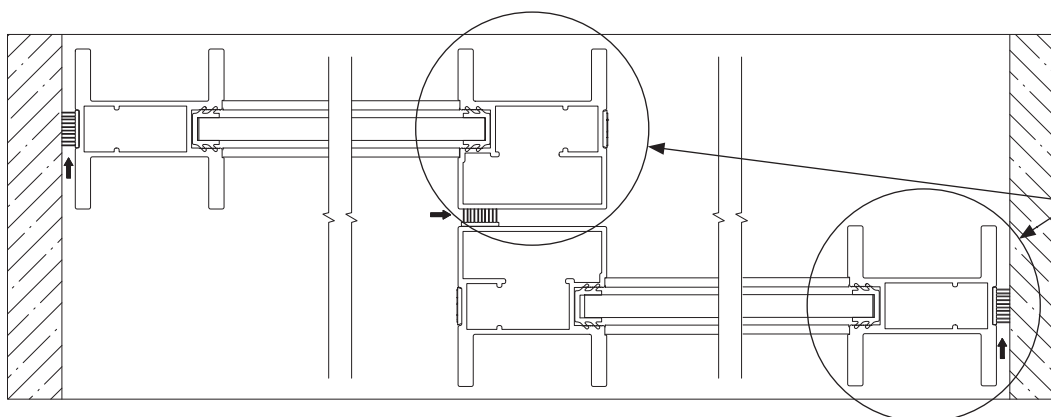

e.g.:
profile mixed

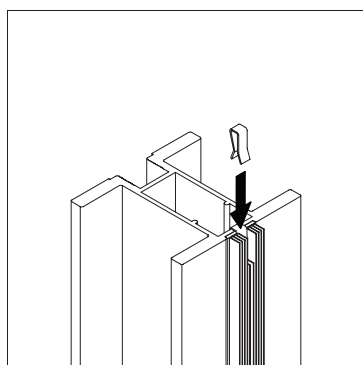

Bracket for dust excluding brush



Stick on dust excluding brush and fix it with clip on top and bottom. For the remaining sides plugs for punching holes have to be stuck on at the top and bottom.

DETAIL DRAWING

CEILING FASTENING AIR-B S1500 / S3000

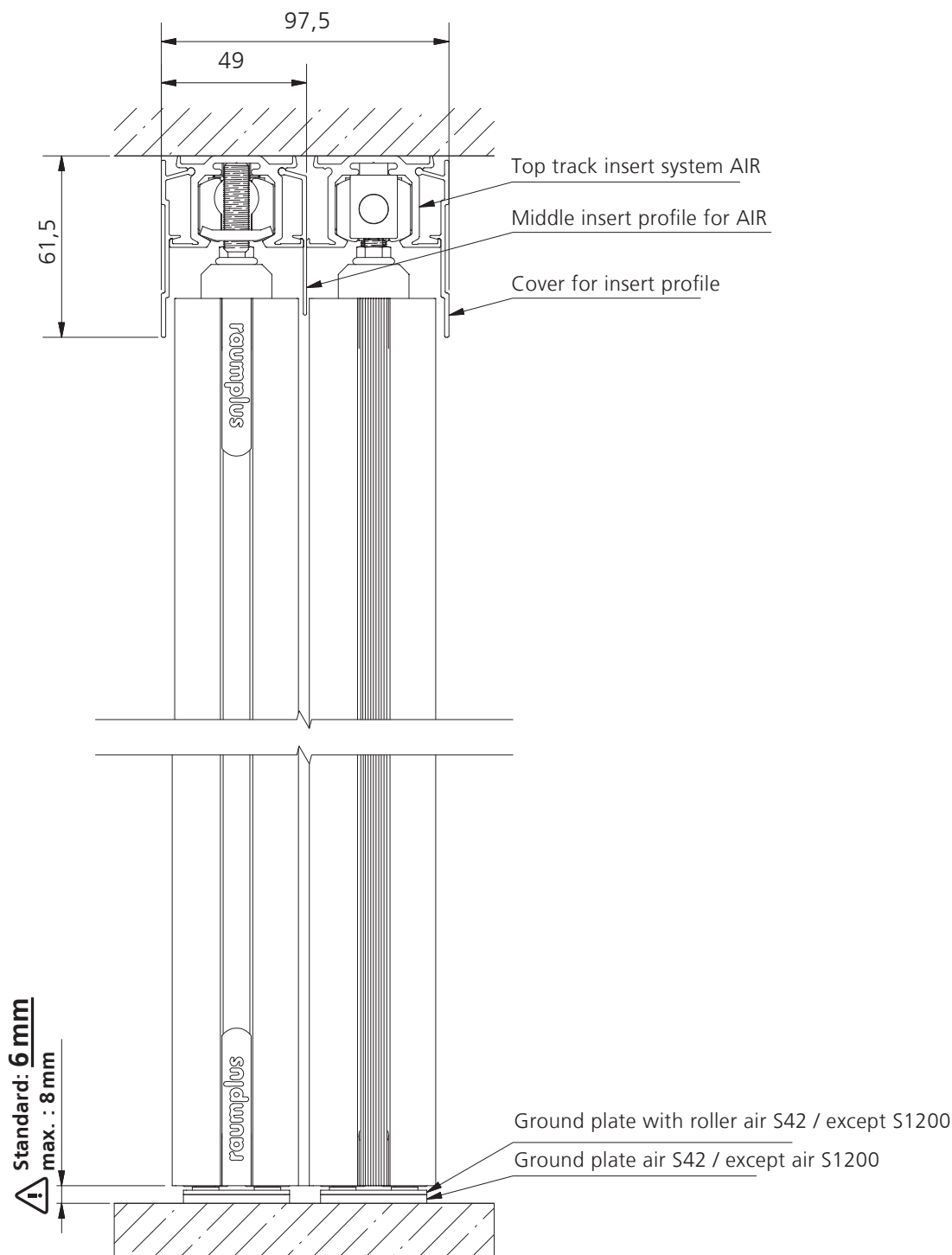

DETAIL DRAWING

WALL FASTENING AIR-B S1500 / S3000

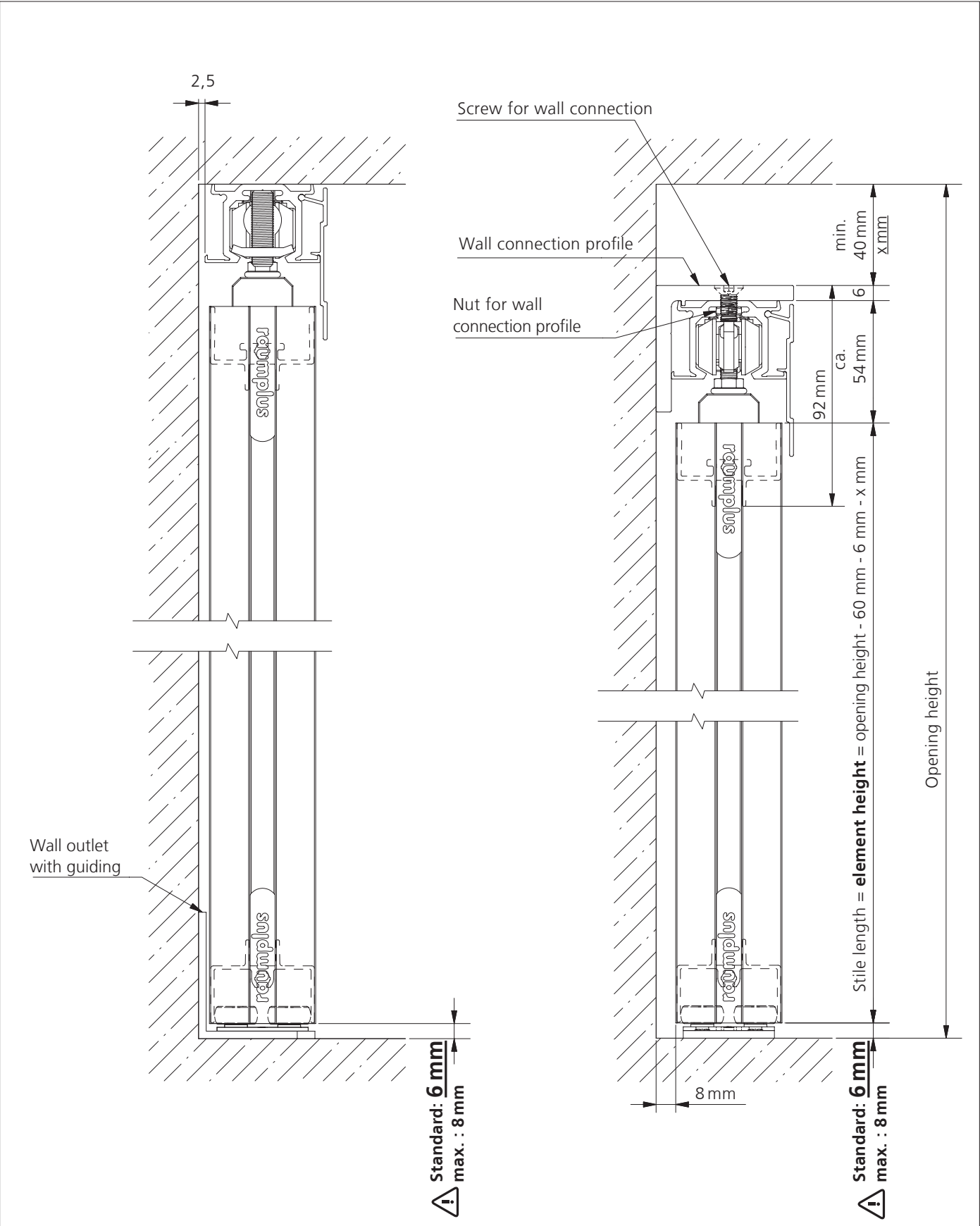

INSTALLATION INSTRUCTION

SERIES C 42

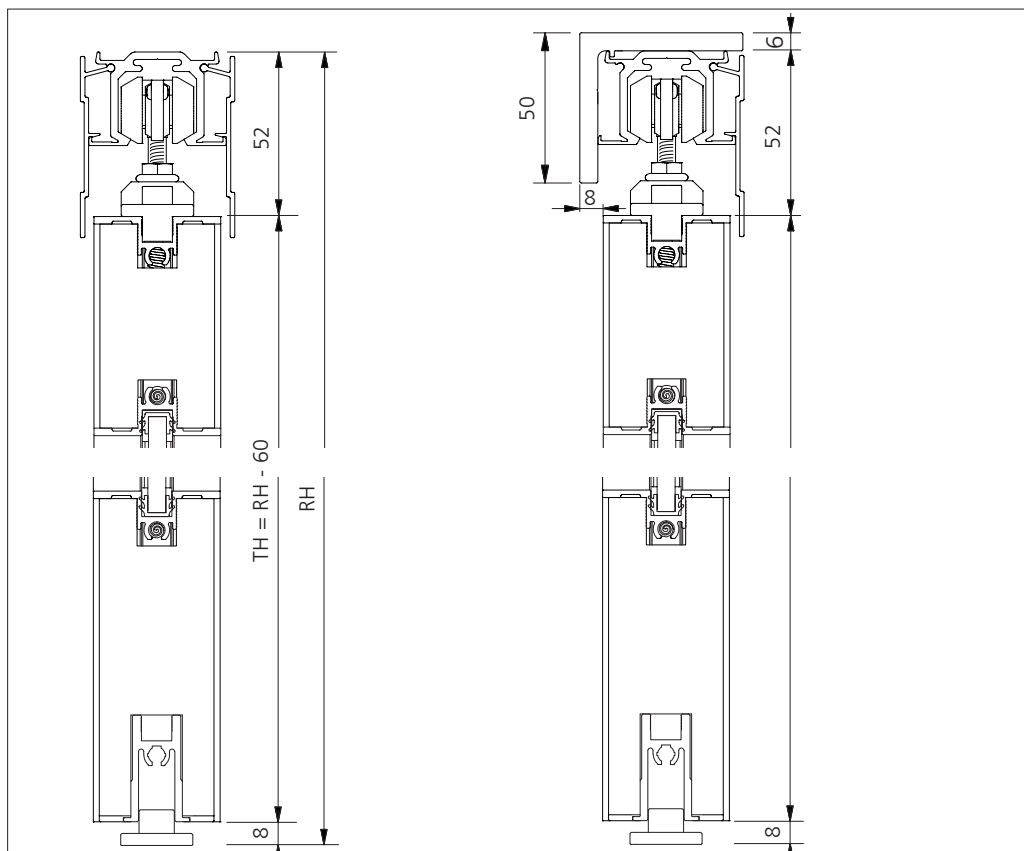

1_ C 42 mounted to the ceiling / to the wall.

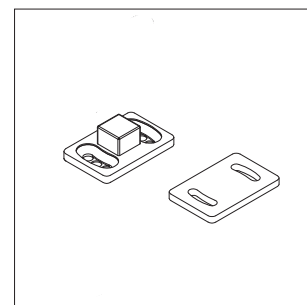

bottom guiding 12 mm AIR /
distance plate for guiding
10.05.047 / 10.05.048

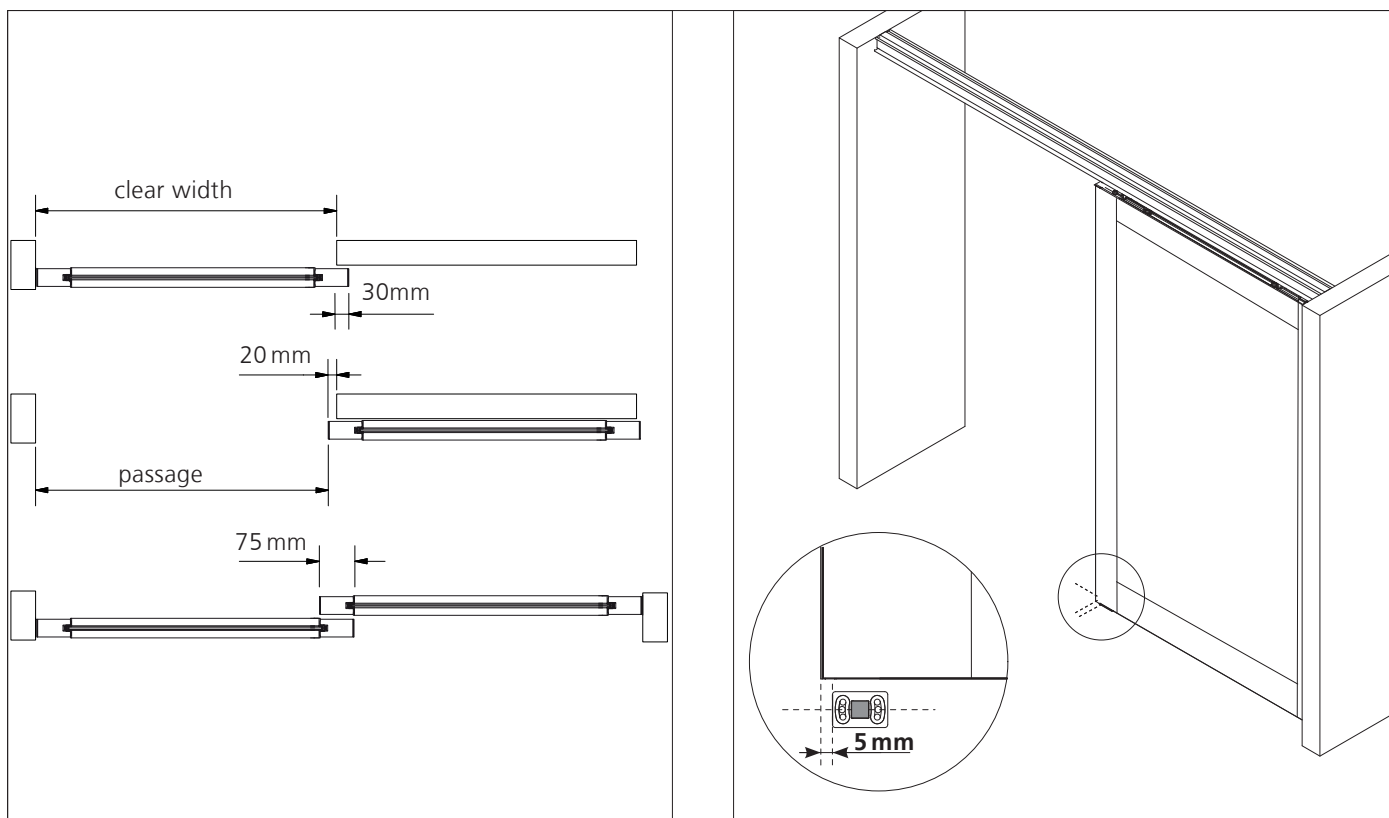

2_ Overlapping

3_ Position of the bottom guiding.

INSTALLATION INSTRUCTION

SERIES 1200

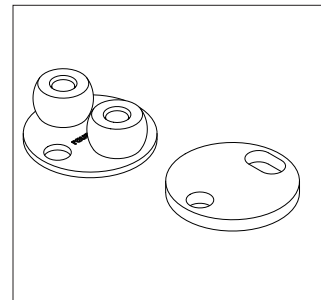
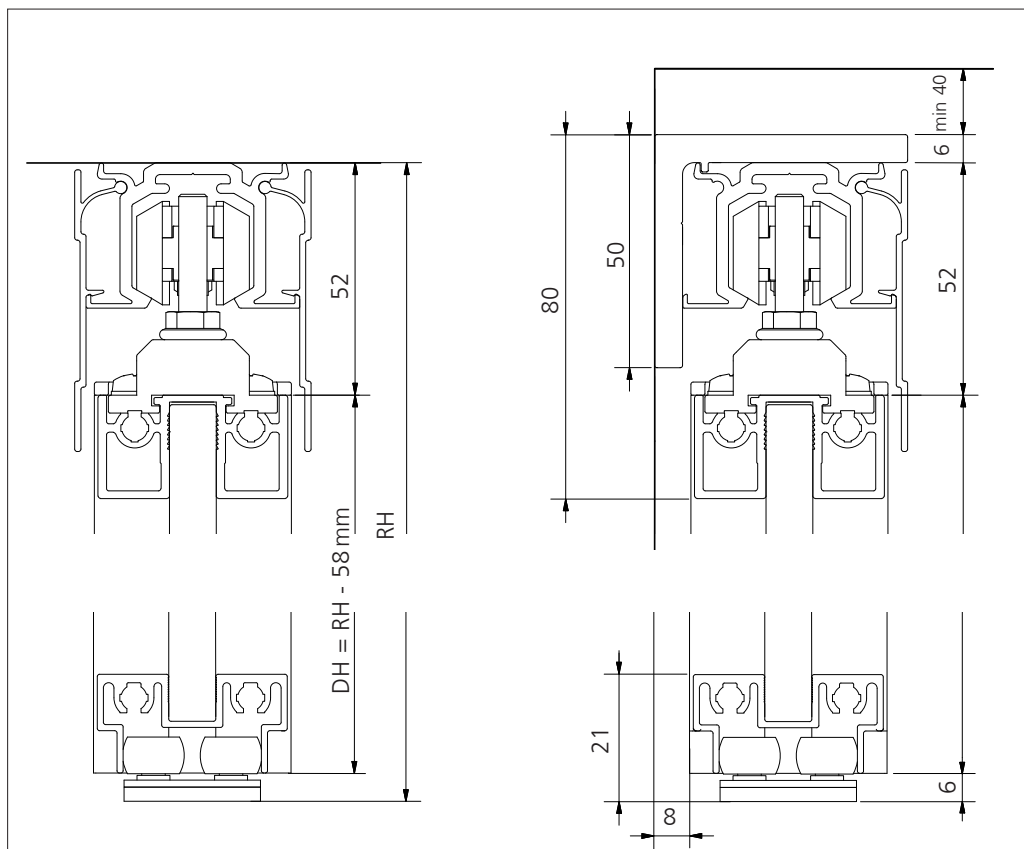

Ground plate with roller air S42 / except S1200 & distance plate air S42 / except air S1200
10.06.033 / 10.06.035

1_ S1200 mounted to the ceiling / to the wall.

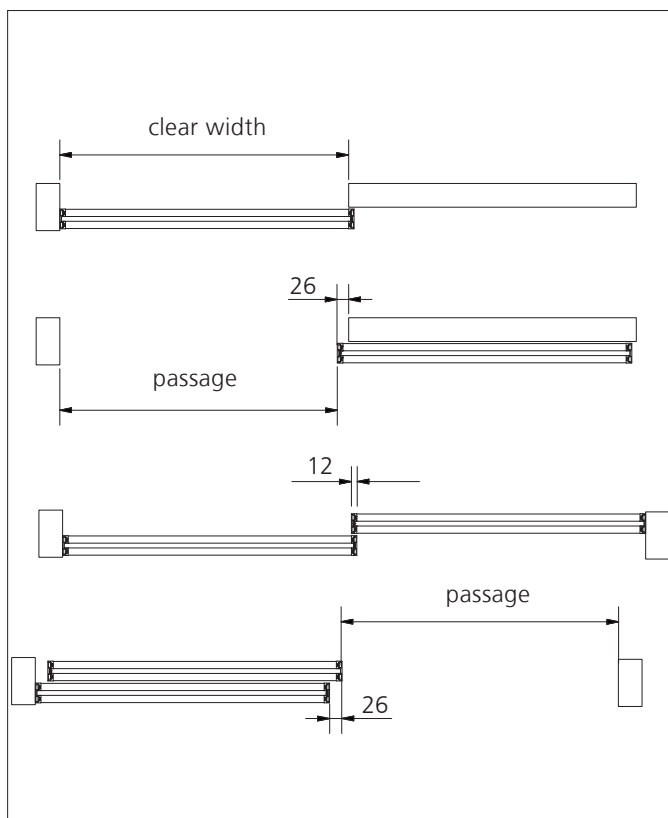

2_ Overlapping

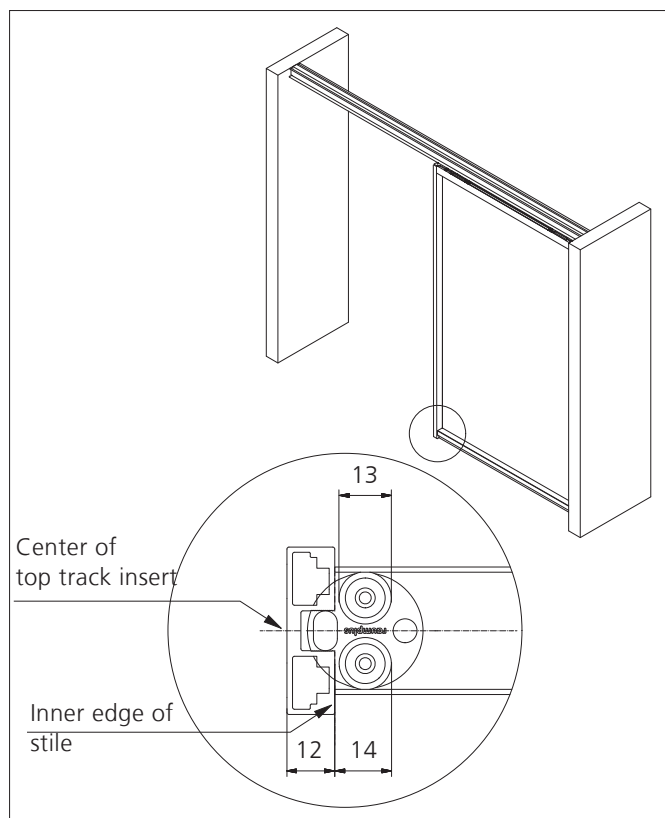

3_ Position of the bottom guiding.

INSTALLATION INSTRUCTION

OVERLAPPING S1500 / S3000

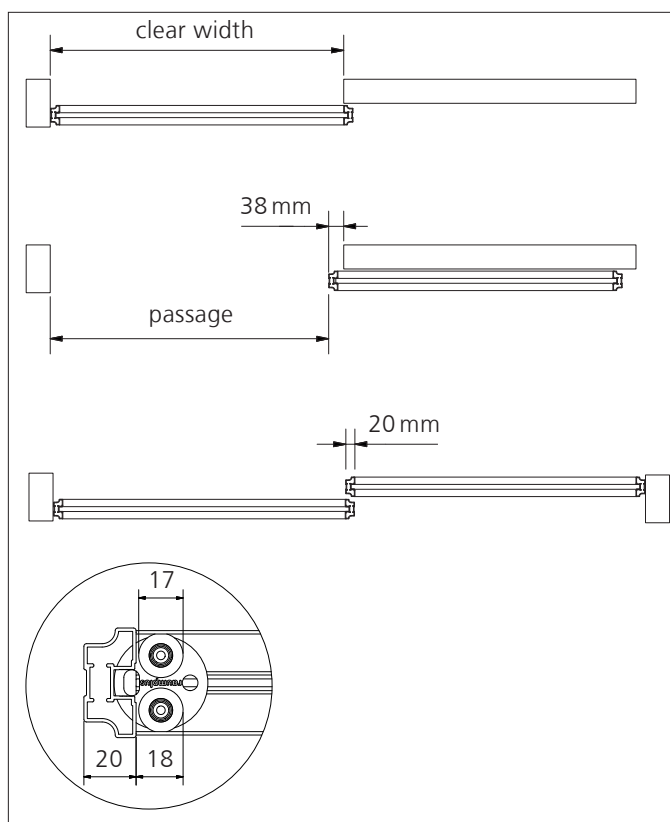

1_ Overlapping S1500

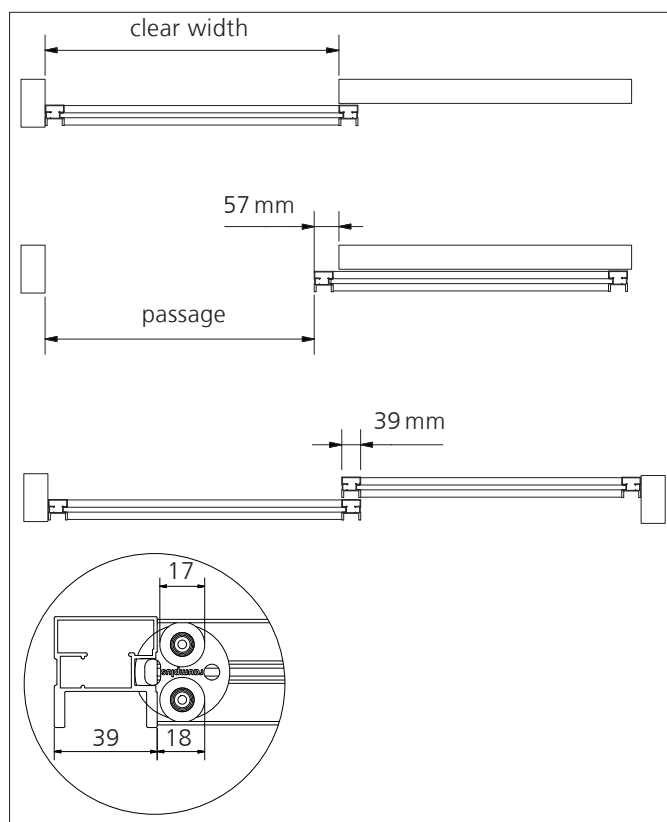

2_ Overlapping S3000

DETAIL DRAWING

STOPPER FOR TOP ROLLER

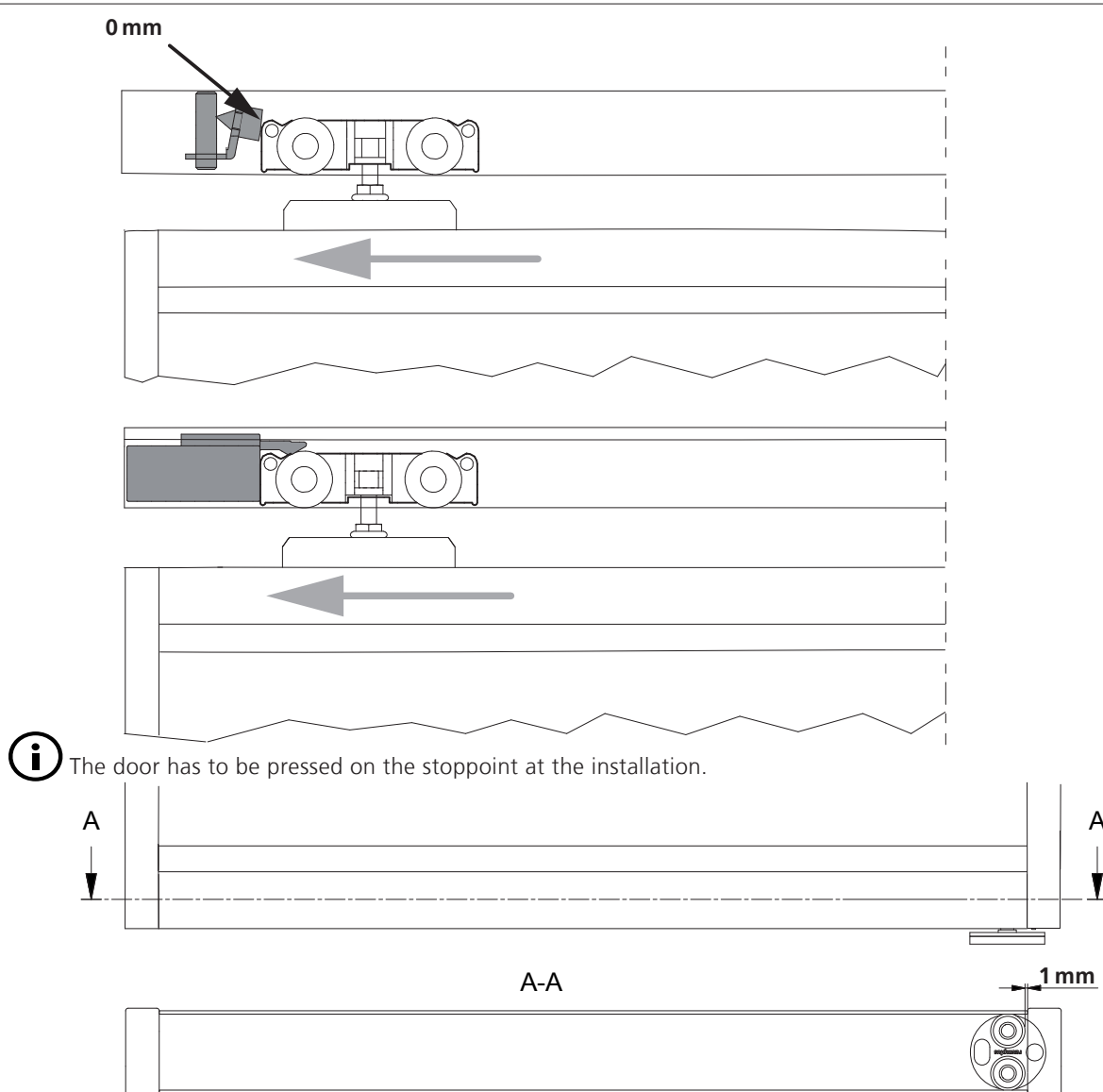

Attention!

The stopper for top roller inside the top rail are meant to be stoppoint to stop the door. The ground plate with roller air are **not** meant to be the stoppoint for the door and always requires space between the bottom roller and the stile to prevent a collision with the door and the roller.