

# INTERIOR SYSTEM: INSTALLATION INSTRUCTION

## RIMA

Version 2.0 (2017-03-06)

Installation

easy

medium

difficult

Subject to technical changes.



# CONTENT AND TOOLS

**CONTENT:**

Content and tools	page	02
Product information	page	03
Manual	page	05
Accessories	page	06
Assembly instruction	page	07
Installation instruction	page	10
Dimension sheet	page	11
Planning	page	12

**TOOLS:**

(without claim of completeness)

- |                            |                                       |
|----------------------------|---------------------------------------|
| ■ Phillips screwdriver set | ■ Hack saw                            |
| ■ Cordless screwdriver     | ■ Drilling machine                    |
| ■ Fitter's hammer          | ■ Water level / Plumb line            |
| ■ Allen key set            | ■ Wood glue                           |
| ■ Drill set metall / stone | ■ Optionally: Vacuum cup glass lifter |
| ■ Pencil                   |                                       |











**VERSION INFORMATION:**  
Version 2.0: New fittings

# PRODUCT INFORMATION

## GENERAL INFORMATION: Preparation

- This manual is part of the product and describes the safe and proper installation of the system. Please read the instructions carefully before installation
- Please note that the assembly should only be done by qualified and trained staff in strict compliance with all details indicated in this document.  
Improper installation in variation from manufacturer's specification may cause defects and danger, thus endangering the safe fixing of the product as well as the safety of the prospective user. The liability of the manufacturer shall be excluded in case of defects and consequential damages resulting from incorrect assembly of this product.
- Please check the completeness of the delivered parts and check carefully if any transport damages are visible.
- If any parts are damaged or lost, please immediately contact the responsible supplier.
- It is assumed that you have exactly identified all cutting dimensions according to the measurement instruction for **raumplus** products.

## SYMBOLS:

Symbol	Importance	Symbol	Importance
	Risk or danger		Glue the connection
	Advice and information		Perform the production step with two persons
	Additional information / other documents		
	Directional data / direction of movement		
	„yes“ and „right“		
	„no“ and „wrong“		
	Follow the order		

## SYSTEM:

### System Information: Rima (corpus dimensions)

- max. total weight = **360 kg**
- min. / max. height = **2100 mm / 2700 mm**
- min. / max. width = **850 mm / 1250 mm**
- min. / max. depth = **363 mm / 490 mm**

# PRODUCT INFORMATION

## GENERAL INFORMATION: **Product safety**

- The interior system Rima complies with the prior of the art and the authorized safety rules at the time of delivery.

## USE:

### **Intended use**

- The prerequisite for the intended use of our products is the professional installation according to our installation instruction. Sufficient fittings must be available and durably installed in all relevant places.  
The function of the fitting must not be hindered or altered during installation.
- Special solutions are only possible in consultation with **raumplus**.

### **Use not as intended**

- Risk or danger may occur in the following cases:
  - the door system has improperly been installed or maintained
  - the safety and installation instructions have not been followed.
  - after improper installation or inadequate fixing ( e.g. to parts of buildings)
  - the maximum weight of the doors has been exceeded.
  - improper shock and case loads or other additional loads on the fittings have occurred
  - the fittings have been used outside.
  - body parts or objects got in to the closing edges or door runnings during use of the door wing.
  - the door system is not used as intended.

### **Structural modifications**

- structural modifications that are not offered as an accessory from **raumplus** may only be attached or installed with permission of **raumplus GmbH**!

# MANUAL

This manual is part of the delivered product and describes the safe and proper use.

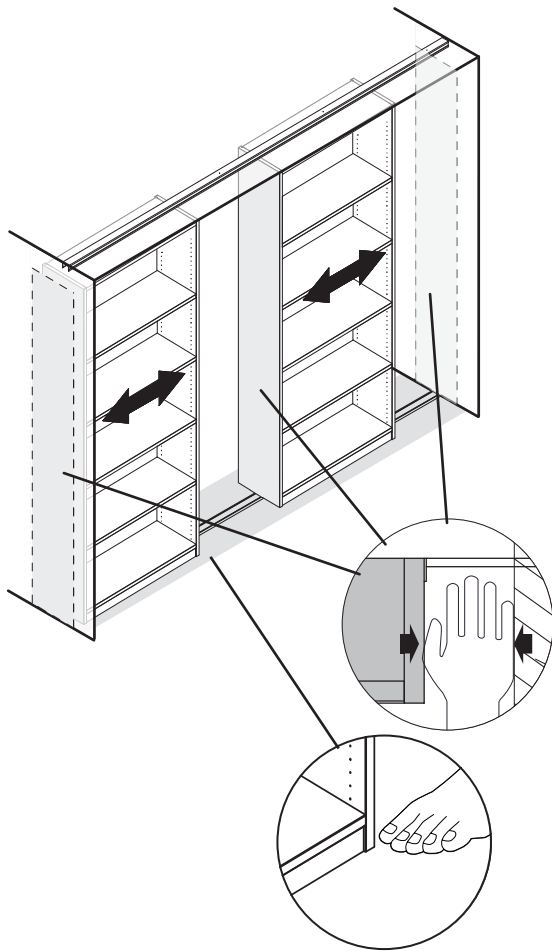

## Designated use:

The product is designed and manufactured for indoor use.

The product was designed as a hand-guided movable shelf that is usually not being moved faster than walking speed and should be stopped manually when reaching the end position. The shelves are guided on top and bottom track.

Any other use that deviates from the specific proper use is not according to the **raumplus** regulations.

## Manual:

Move the shelf slowly by hand.

Guide the shelf slowly to the end position.

## Attention:

Preserve your hands from getting trapped during the movement of the shelf.

When moving the shelf never take hold of the side panel, only use the inner shelf areas.

Use the shelf as instructed.

## Safety Information:

The product complies with the prior art and the recognized safety rules at the time of delivery.

- Pay attention to child safety.
- No additional load to the shelf.
- Structural changes, additions or modifications can only be carried out by a distributor.
- In case of malfunctions or irregularities: shut down the system and contact your dealer.
- ⚠ For Installation without wall connection: use of top / bottom stopper is obligatory 📄.

As defined in the „Law of Liability for Products“ (§4 Prod-HaftG), for the liability of the manufacturer, for his products, the above information has to be regarded. The disregard of this manual, releases the manufacturer from his liability.

# ACCESSORIES

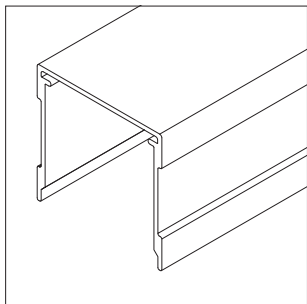

1\_ 15.45.020

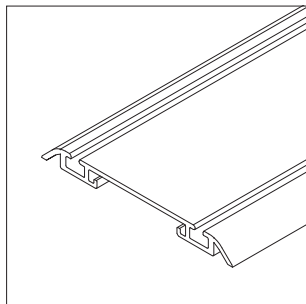

2\_ 14.08.020

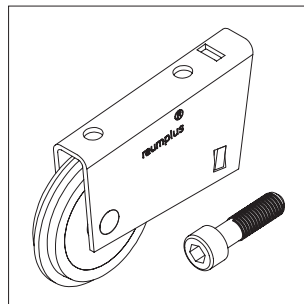

3\_ 10.01.020

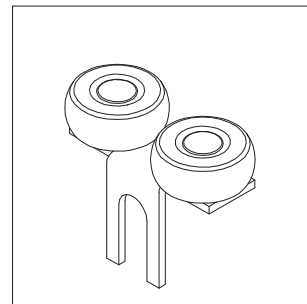

4\_ 10.01.015

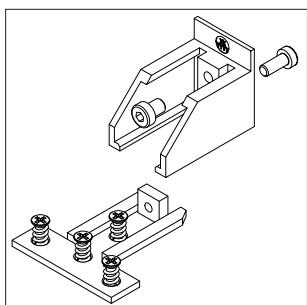

5\_ 10.09.040

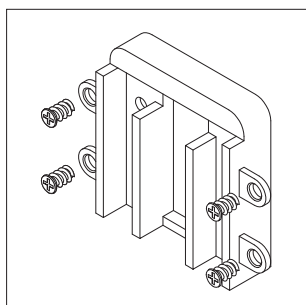

6\_ 10.09.042

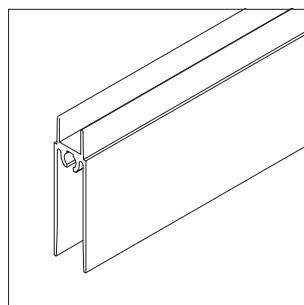

7\_ 15.04.020

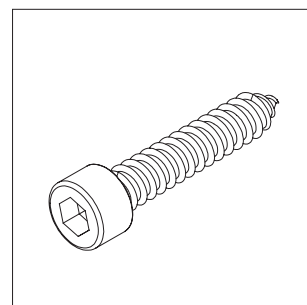

8\_ 10.07.012

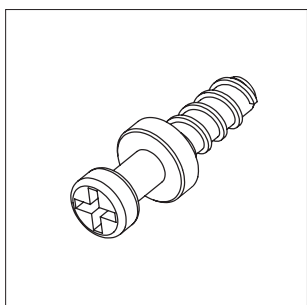

9\_ 20.08.019

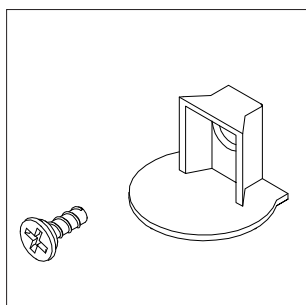

10\_ 20.08.032 / 20.08.027

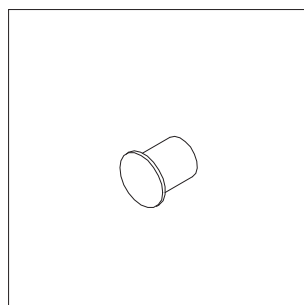

11\_ 10.01.449

1\_ Top track single S34

2\_ Bottom track double S42 surface closed

3\_ Bottom roller (w/o antijump) / screw M5x25

4\_ Top roller S34

5\_ Top fitting

6\_ Bottom fitting Rima

7\_ bottom rail

8\_ Frame screw 6,3x32

9\_ Screw-in dowel 5x12

10\_ Euro screw 4,2x13,5 mm / screw-in corpus connector

11\_ Damper

**w/o illustrations:.**

12\_ Stopper for bottom track (Art. No.: 10.01.031)

13\_ Stopper for top track S34 mm (Art. No.: 10.08.481)

14\_ Wooden dowel 8x30 (Art. No.: 20.08.037)

15\_ Chipboard screw 4,5x35 (Art. No.: 10.05.046)

# ASSEMBLY INSTRUCTIONS

## PREPARATION OF THE PARTS

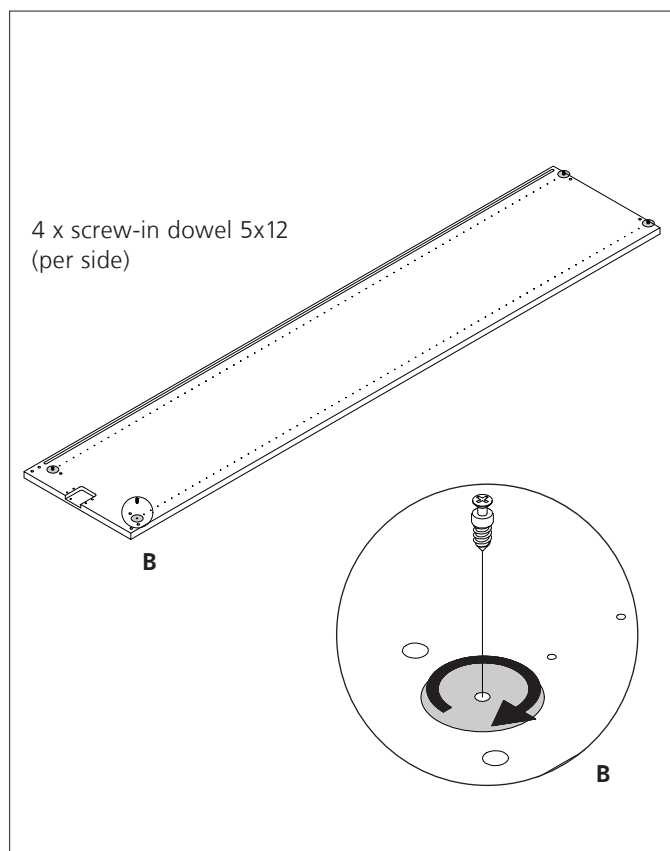

1\_ Sides: screw in all dowels

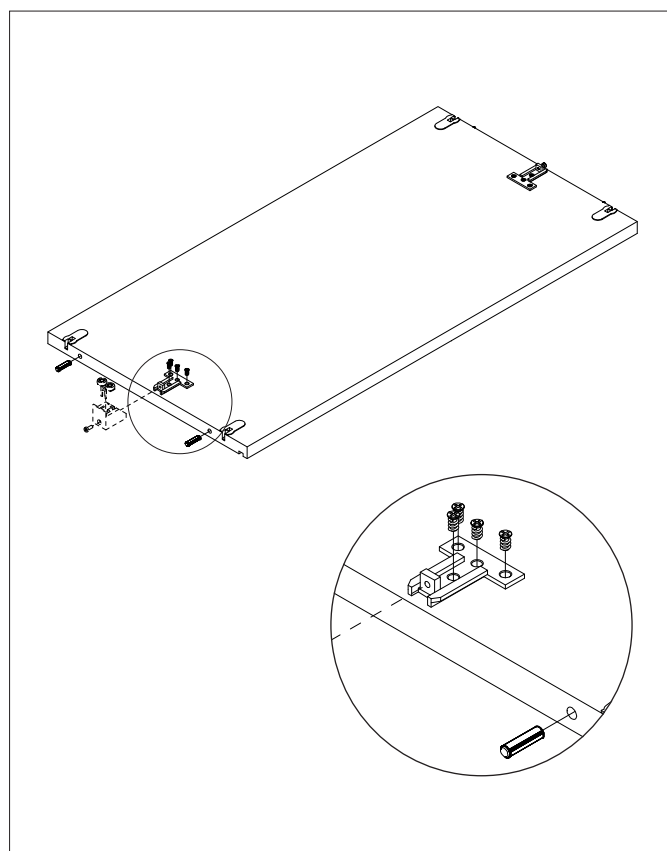

2\_ Prepare top shelf with top fittings and dowels

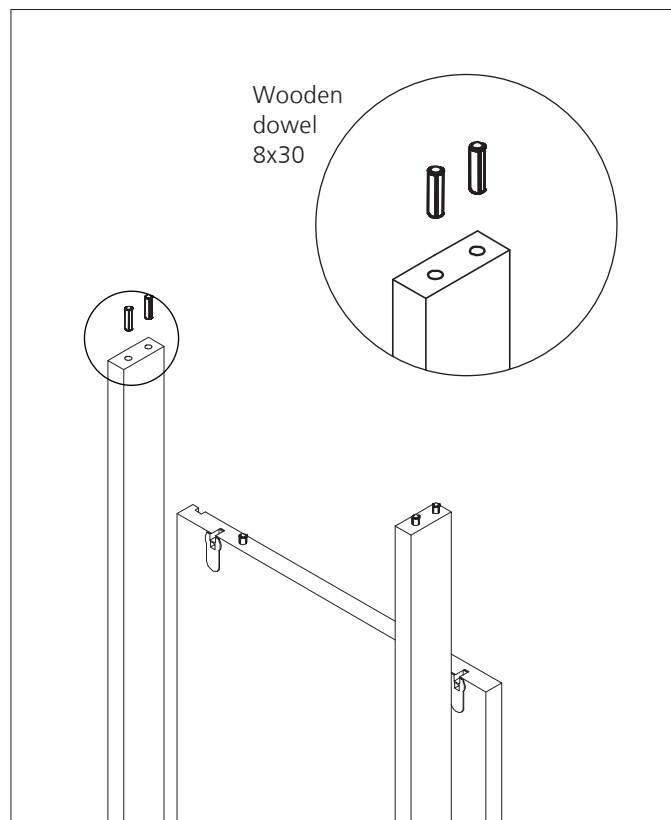

3\_ Prepare bottom shelf and plinth panel

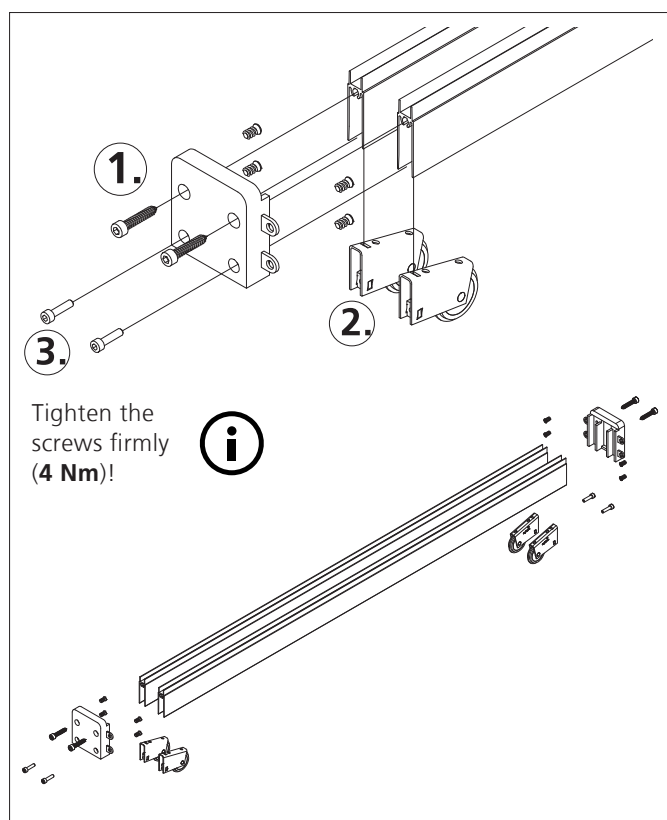

4\_ Prepare sliding technic bottom

# ASSEMBLY INSTRUCTION

## ASSEMBLY OF THE SHELF

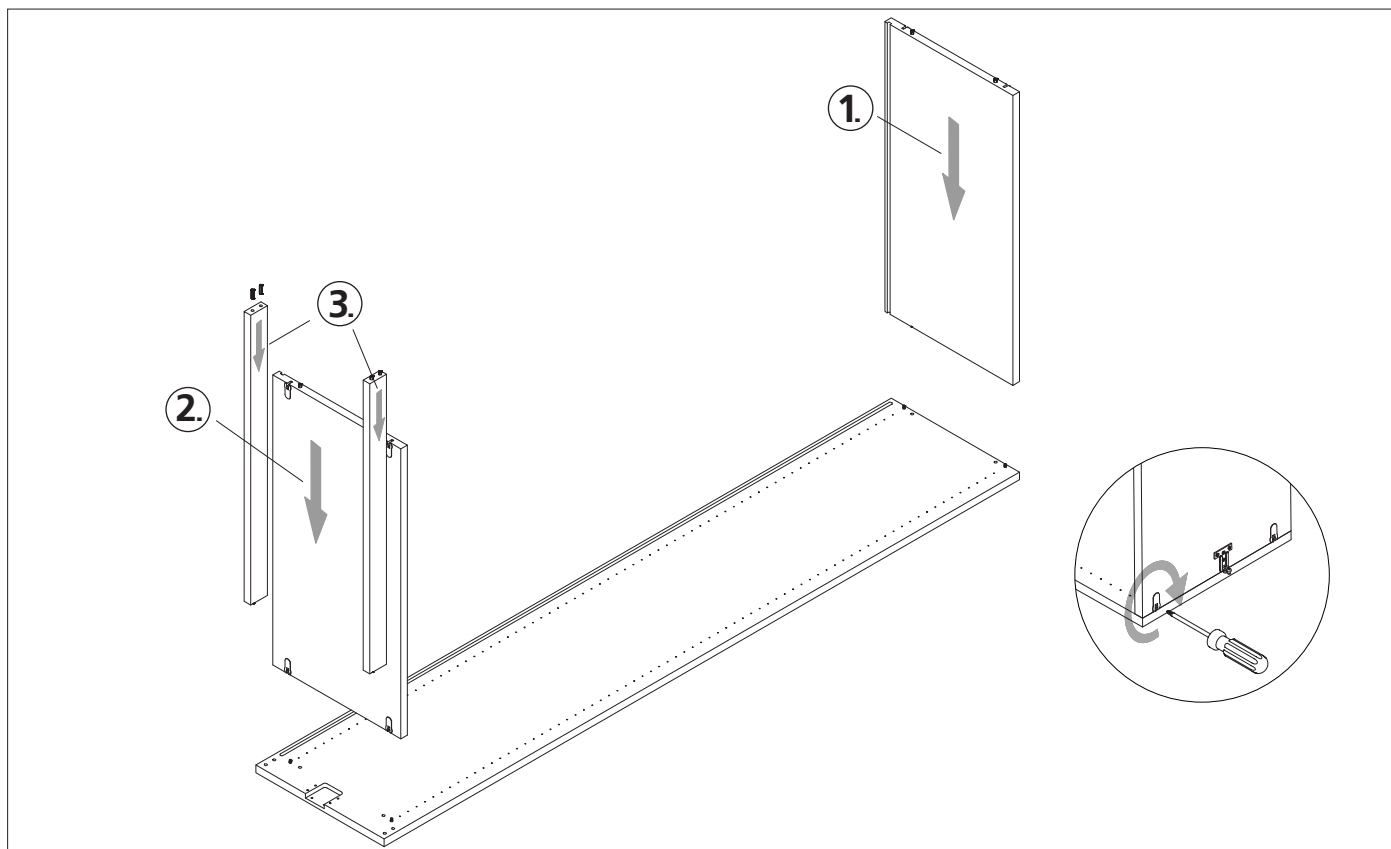

1\_ Connect top / bottom shelf and plinth panel to side panel

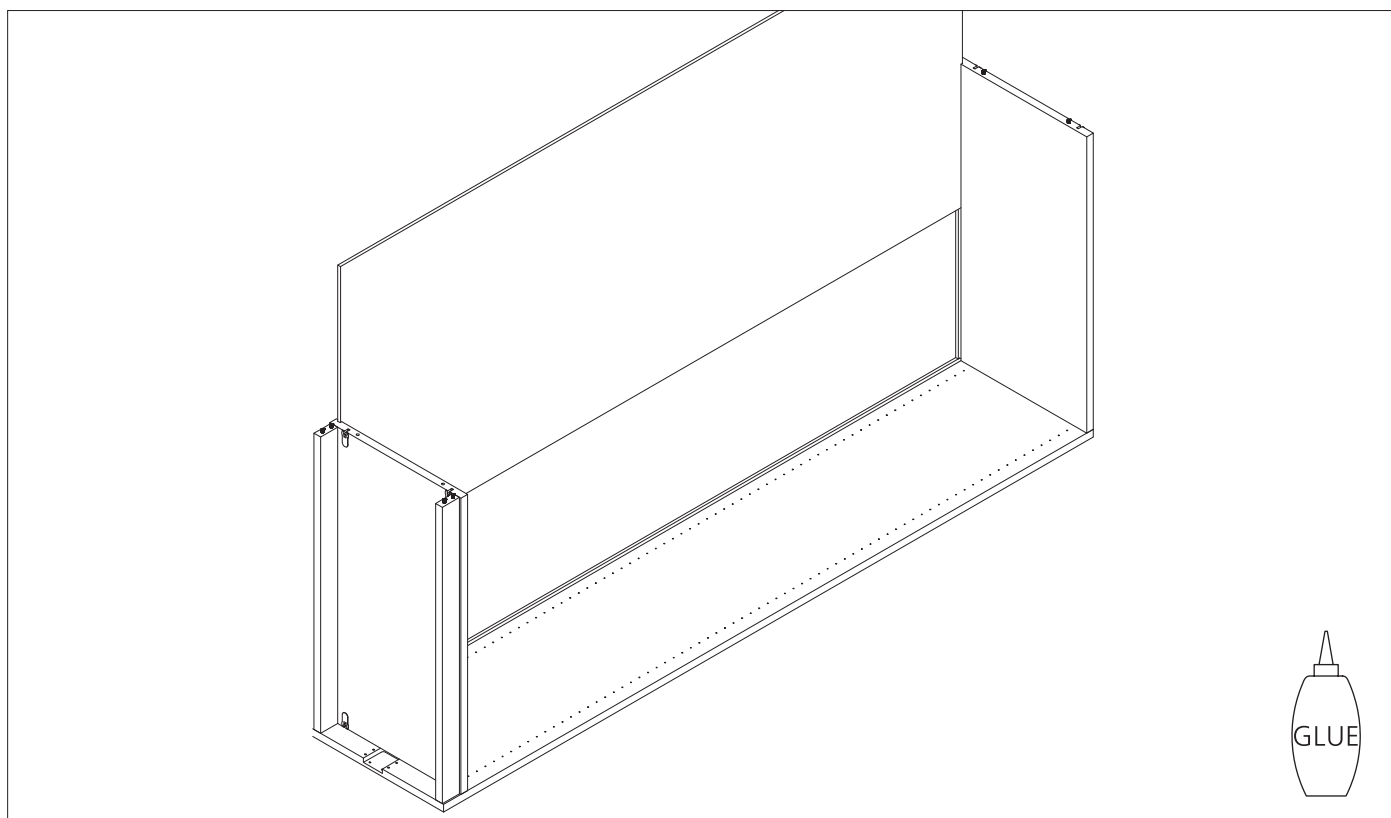

2\_ Insert rear wall



# ASSEMBLY INSTRUCTIONS

## ASSEMBLY OF THE SHELF

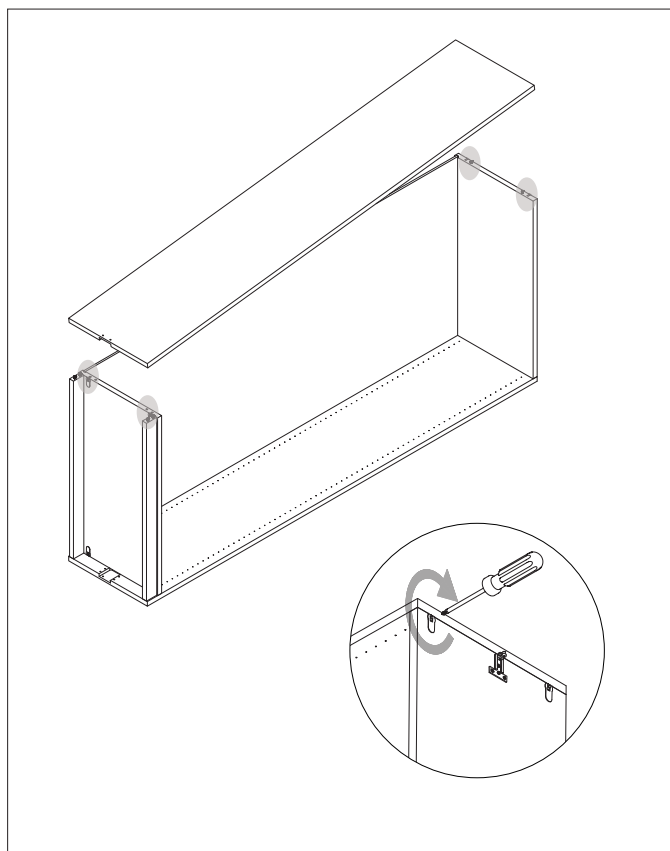

3\_ Mount second side and fix with fittings

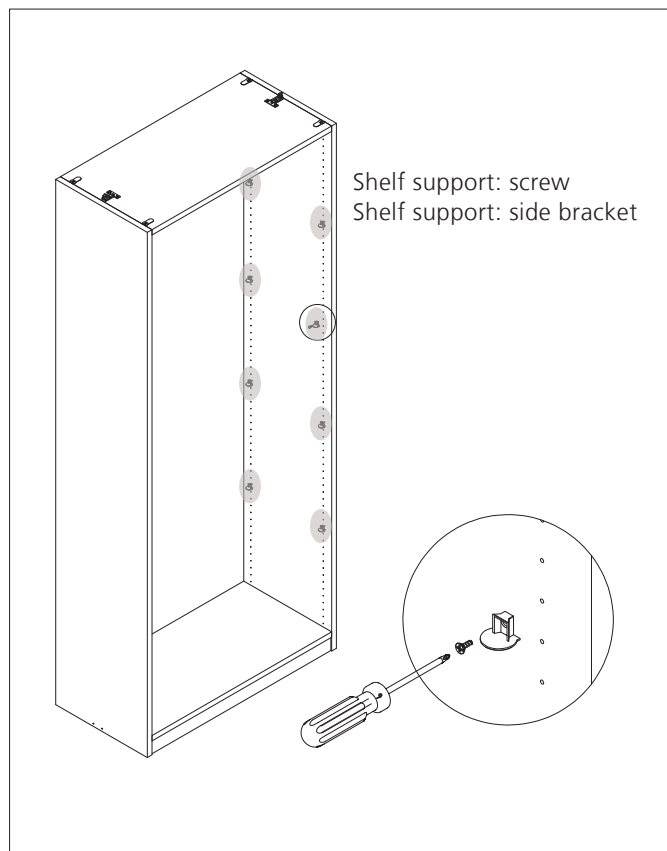

4\_ Use the euro screw to position the corpus connector

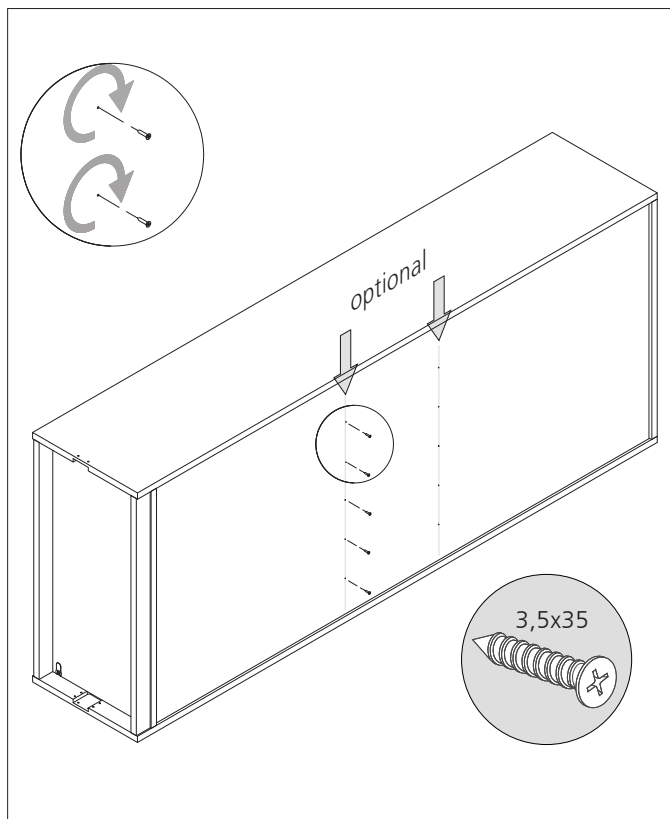

5\_ Fix the rear panel

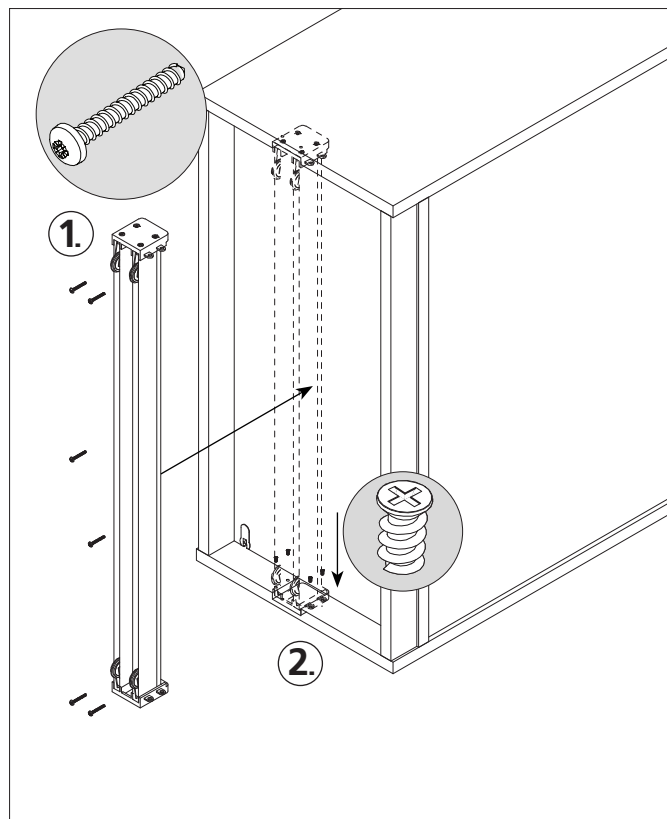

6\_ Mount lower stiles and fittings

# INSTALLATION INSTRUCTIONS

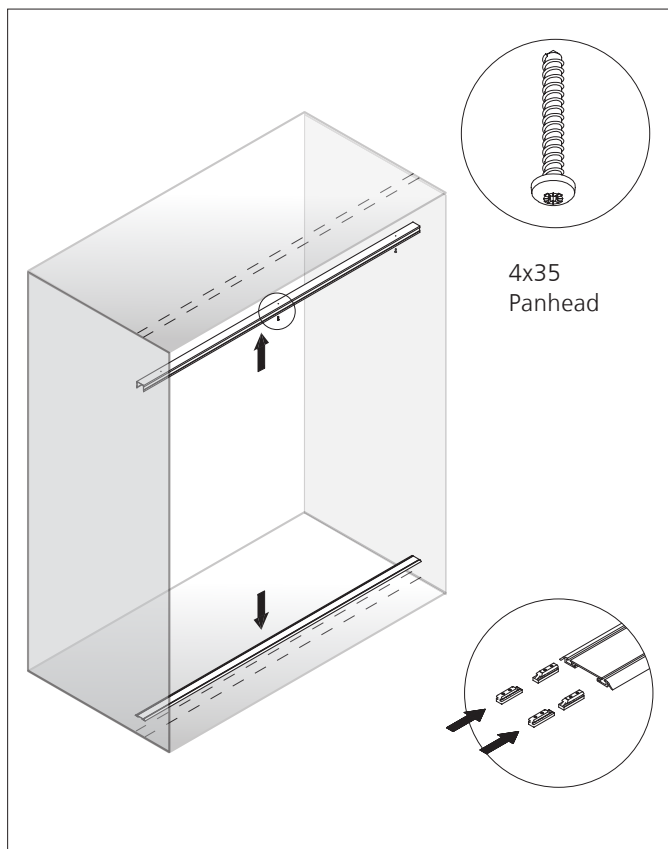

1\_ Push the stopper into the bottom track before assembly

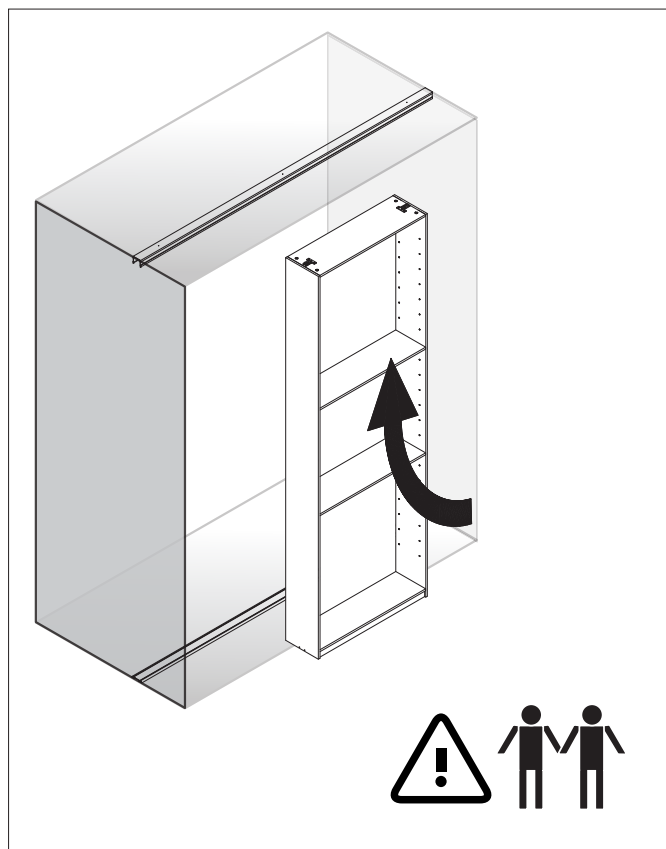

2\_ Install movable shelf with at least two persons

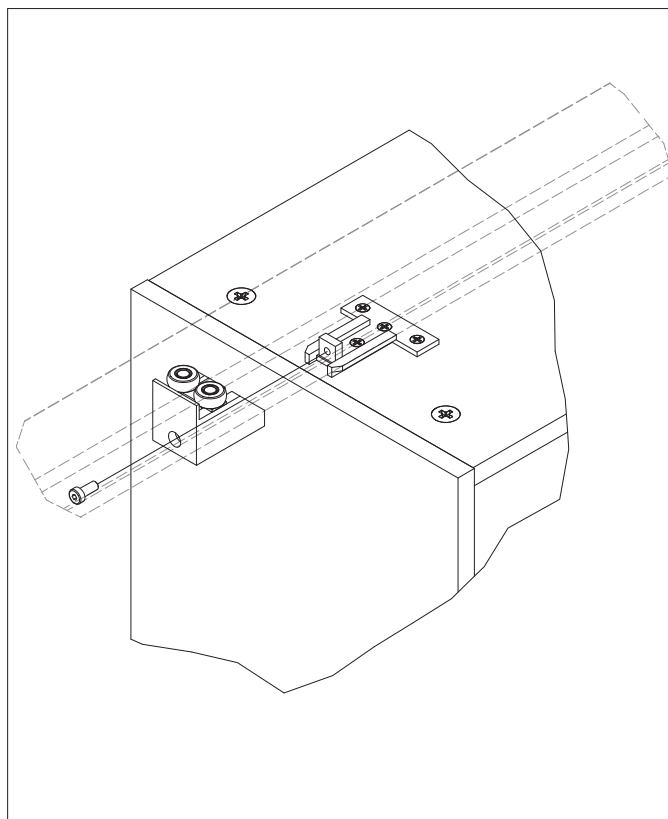

3\_ Mount top fittings

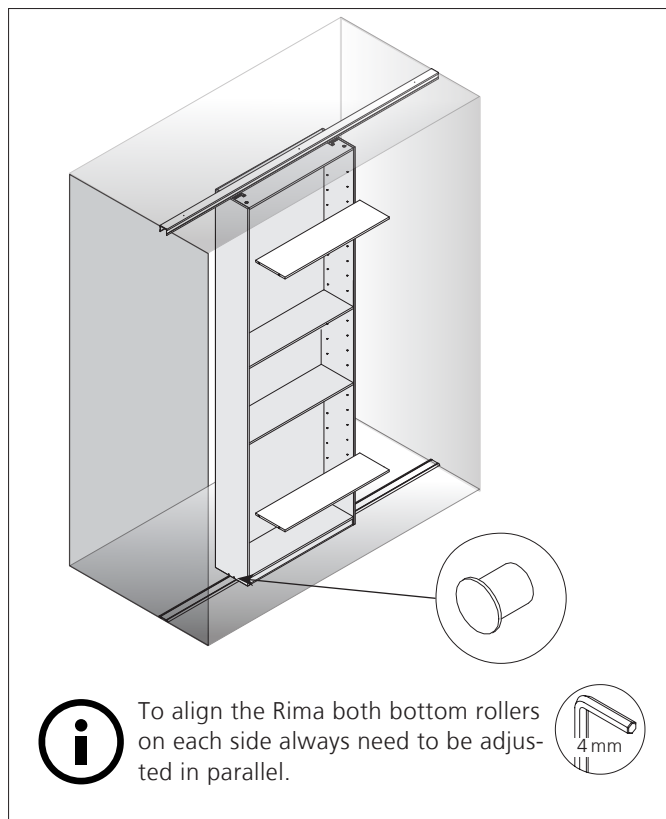

4\_ Finish Rima with the shelves and damper

# RIMA

## DIMENSIONS / POSITION BOTTOM- TOPTRACK

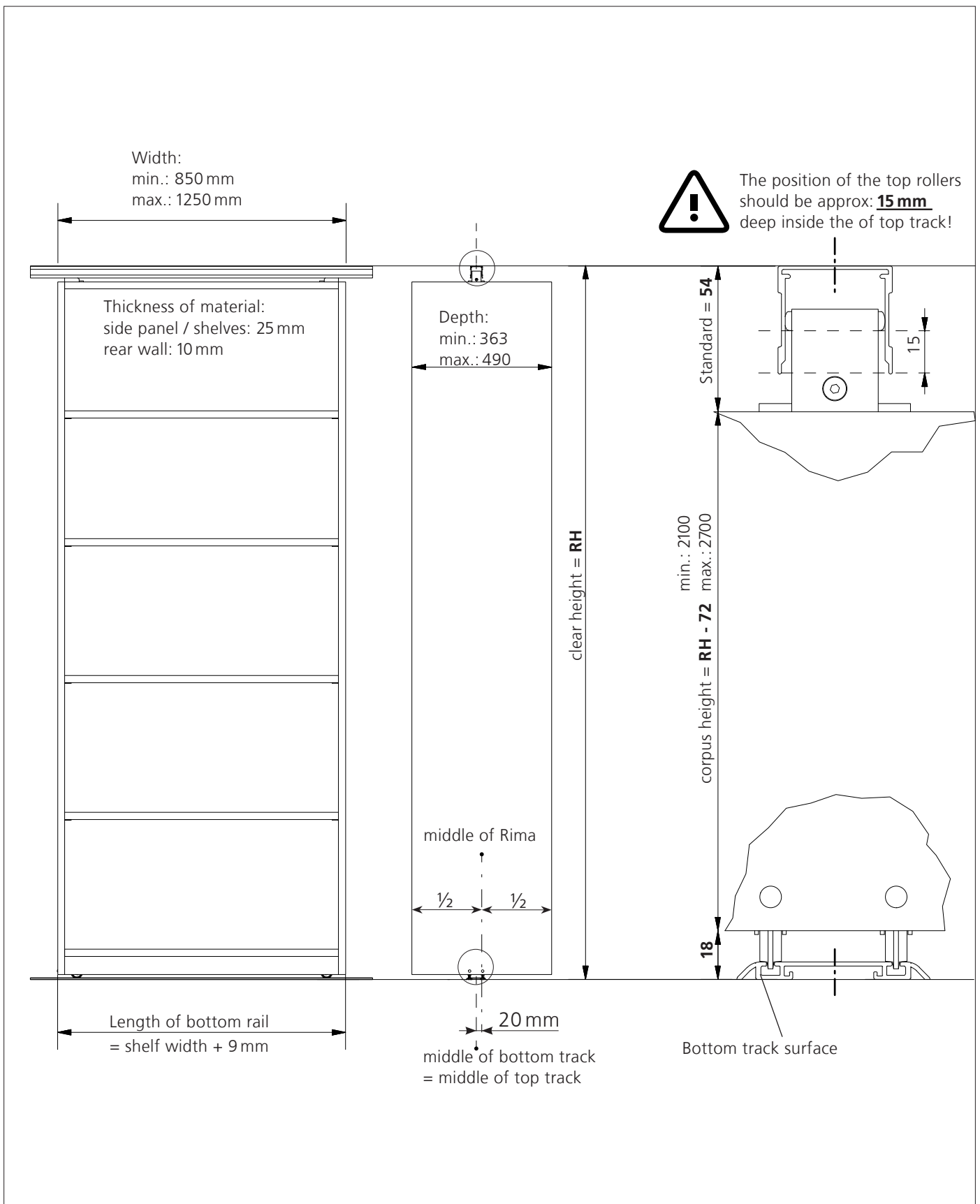

Customer:	
Commission:	
Order processing No.:	

Weight: \_\_\_\_\_ max. 360 kg

Shelf width: \_\_\_\_\_ mm

Shelf height = room height - **72** mm = \_\_\_\_\_ mm

Depth of shelf: \_\_\_\_\_ mm

Number of shelves: \_\_\_\_\_ piece

Length of horizontal profile = shelf width + 9 mm = \_\_\_\_\_ mm

Length of top track S34: \_\_\_\_\_ mm (+100 mm\*)

Length of bottom track S42: \_\_\_\_\_ mm (+100 mm\*)

Surface: \_\_\_\_\_

\*Regularly, the top tracks / bottom tracks are 100 mm longer, delete as appropriate.

Processor (name / date) \_\_\_\_\_