

INTERIOR SYSTEM: INSTALLATION INSTRUCTION

RIMA FINO

Version 1.0 (2014-04-10)

5.14.2.b

Install

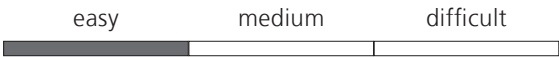

Subject to technical changes.

raumplus

CONTENT AND TOOLS

CONTENT:

Content and tools	page	02
Product information	page	03
Manual	page	05
Accessories	page	06
Assembly instruction	page	07
Installation instruction	page	10
Dimension sheet	page	11
Planning	page	12

TOOLS:

(without claim of completeness)

- | | |
|----------------------------|---------------------------------------|
| ■ Phillips screwdriver set | ■ Hack saw |
| ■ Cordless screwdriver | ■ Drilling machine |
| ■ Fitter's hammer | ■ Water level / Plumb line |
| ■ Allen key set | ■ Wood glues |
| ■ Drill set metall / stone | ■ Optionally: Vacuum cup glass lifter |
| ■ Pencil | |



VERSION INFORMATION:

PRODUCT INFORMATION

GENERAL INFORMATION: Preparation

- This manual is part of the product and describes the safe and proper installation of the system. Please read the instructions carefully before installation.
- Please note that the assembly should only be done by qualified and trained staff in strict compliance with all details indicated in this document.
Improper installation in variation from manufacturer's specification may cause defects and danger, thus endangering the safe fixing of the product as well as the safety of the prospective user. The liability of the manufacturer shall be excluded in case of defects and consequential damages resulting from incorrect assembly of this product.
- Please check the completeness of the delivered parts and check carefully if any transport damages are visible.
- If any parts are damaged or lost, please immediately contact the responsible supplier.
- It is assumed that you have exactly identified all cutting dimensions according to the measurement instruction for **raumplus** products.

SYMBOLS:

Symbol Importance



Risk or danger



Advice and information



Additional information / other documents



Directional data / direction of movement



„yes“ and „right“



„no“ and „wrong“



Follow the order

Symbol Importance



Glue the connection



Perform the production step with two persons

SYSTEM:

System Information: Rima Fino (corpus dimensions)

- max. total weight = **120 kg**
- min. / max. height = **2100 mm / 2700 mm**
- min. / max. width = **600 mm / 800 mm**
- min. / max. depth = **180 mm / 240 mm**

PRODUCT INFORMATION

GENERAL INFORMATION: **Product safety**

- The interior system Rima Fino complies with the prior of the art and the authorized safety rules at the time of delivery.

USE:

Intended use

- The prerequisite for the intended use of our products is the professional installation according to our installation instruction. Sufficient fittings must be available and durably installed in all relevant places.
The function of the fitting must not be hindered or altered during installation.
- Special solutions are only possible in consultation with **raumplus**.

Use not as intended

- Risk or danger may occur in the following cases:
 - the door system has improperly been installed or maintained.
 - the safety and installation instructions have not been followed.
 - after improper installation or inadequate fixing (e.g. to parts of buildings)
 - the maximum weight of the doors has been exceeded.
 - improper shock and case loads or other additional loads on the fittings have occurred
 - the fittings have been used outside.
 - body parts or objects got in to the closing edges or door runnings during use of the door wing.
 - the door system is not used as intended.

Structural modifications

- structural modifications that are not offered as an accessory from **raumplus** may only be attached or installed with permission of **raumplus GmbH**!

MANUAL

This manual is part of the delivered product and describes the safe and proper use.

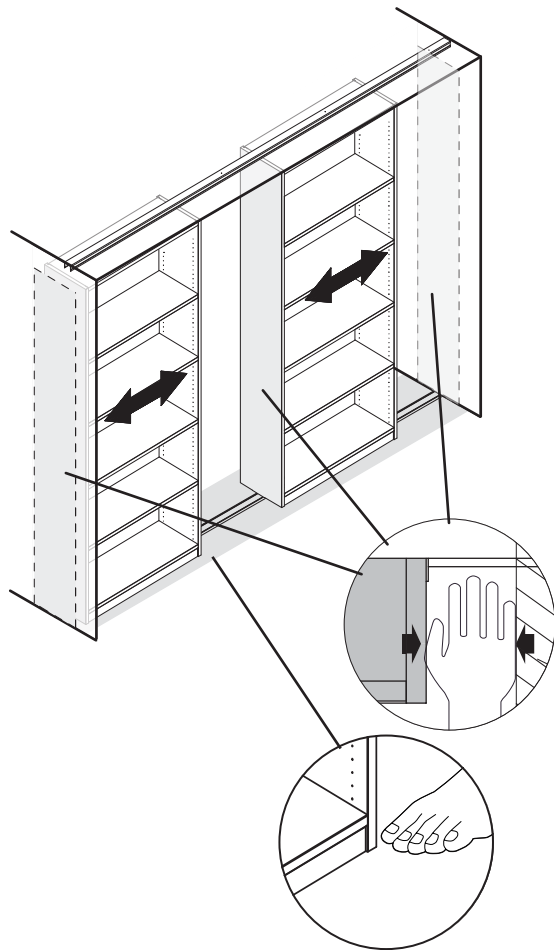

Designated use:

The product is designed and manufactured for indoor use.

The product was designed as a hand-guided movable shelf that is usually not being moved faster than walking speed and should be stopped manually when reaching the end position. The shelves are guided on top and bottom track.

Any other use that deviates from the specific proper use is not according to the **raumplus** regulations.

Manual:

Move the shelf slowly by hand.

Guide the shelf slowly to the end position.

Attention:

Preserve your hands from getting trapped during the movement of the shelf.

When moving the shelf never take hold of the side panel, only use the inner shelf areas.

Use the shelf as instructed.

Safety Information:

The product complies with the prior art and the recognized safety rules at the time of delivery.

- Pay attention to child safety.
- No additional load to the shelf.
- Structural changes, additions or modifications can only be carried out by a distributor.
- In case of malfunctions or irregularities: shut down the system and contact your dealer.
- ⚠ For Installation without wall connection: use of top / bottom stopper is obligatory 📄.

As defined in the „Law of Liability for Products“ (§4 Prod-HaftG), for the liability of the manufacturer, for his products, the above information has to be regarded. The disregard of this manual, releases the manufacturer from his liability.

ACCESSORIES

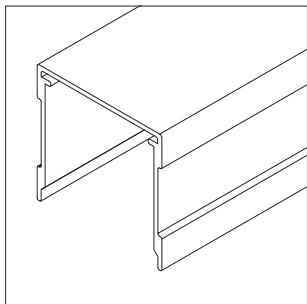

1_ 15.45.020

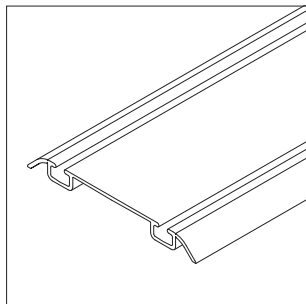

2_ 15.08.020

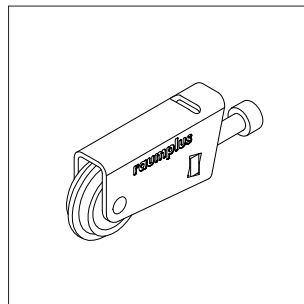

3_ 10.01.127

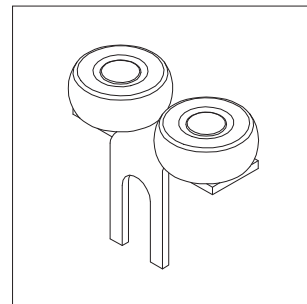

4_ 10.01.015

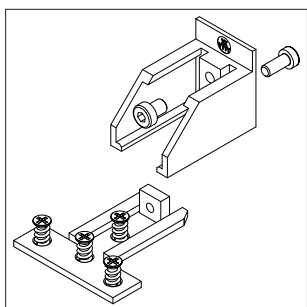

5_ 10.09.040

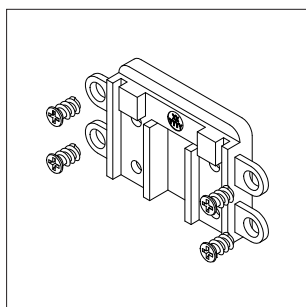

6_ 10.09.044

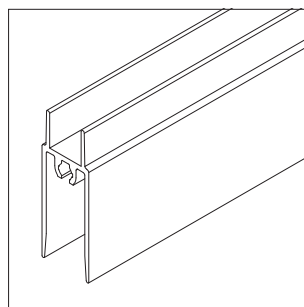

7_ 15.14.020

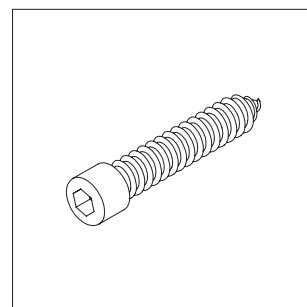

8_ 10.26.072

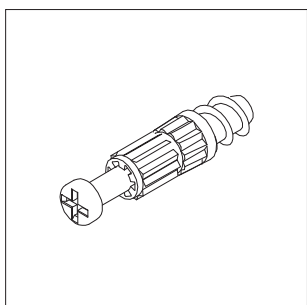

9_ 20.08.035

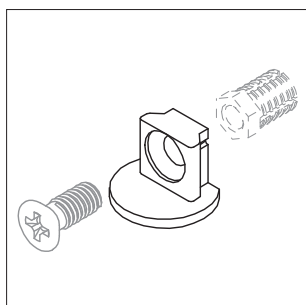

10_ 10.09.049 / 10.09.048

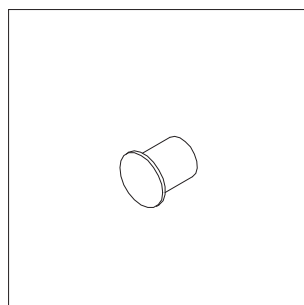

11_ 10.01.449

1_ Top track single S34

2_ Bottom track double S34 surface closed

3_ Bottom roller Ø25 mm neo (with antijump)

4_ Top roller S34

5_ Top fitting

6_ Bottom fitting

7_ Bottom rail slim

8_ Frame screws S26 neo

9_ Twister screw dowel DU 319

10_ Shelf support: screw / side bracket

11_ Damper

w/o illustrations:.

12_ Stopper for bottom roller Ø25mm (10.26.031)

13_ Stopper for top track S34 (10.08.481)

14_ Bottom track double S34 insert (optinal) (15.06.020)

15_ Insert for bottom track S34 (optinal) (15.16.020)

16_ Wooden dowel 5x30 (optional) (20.08.038)

ASSEMBLY INSTRUCTIONS

PREPARATION OF THE PARTS

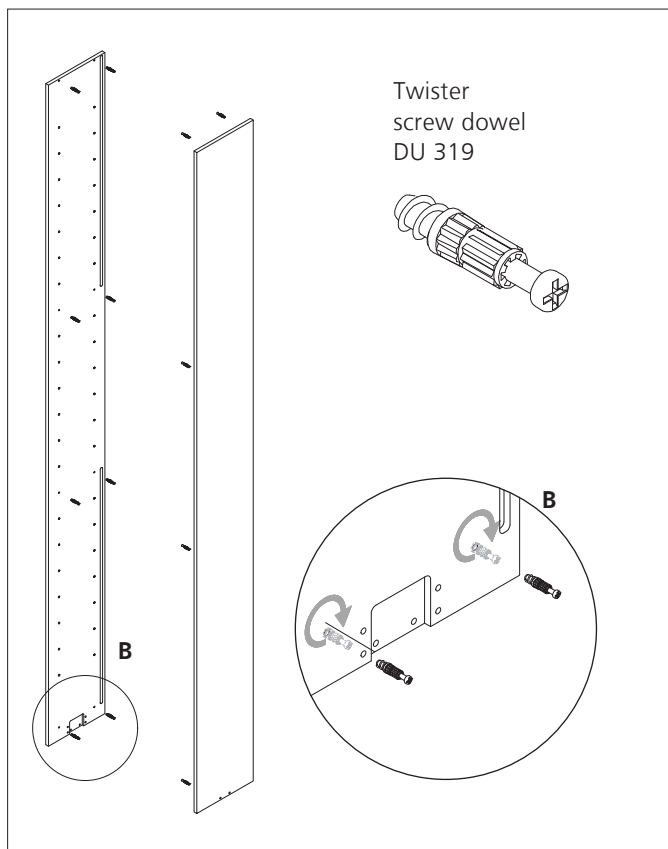

1_ Prepare sides

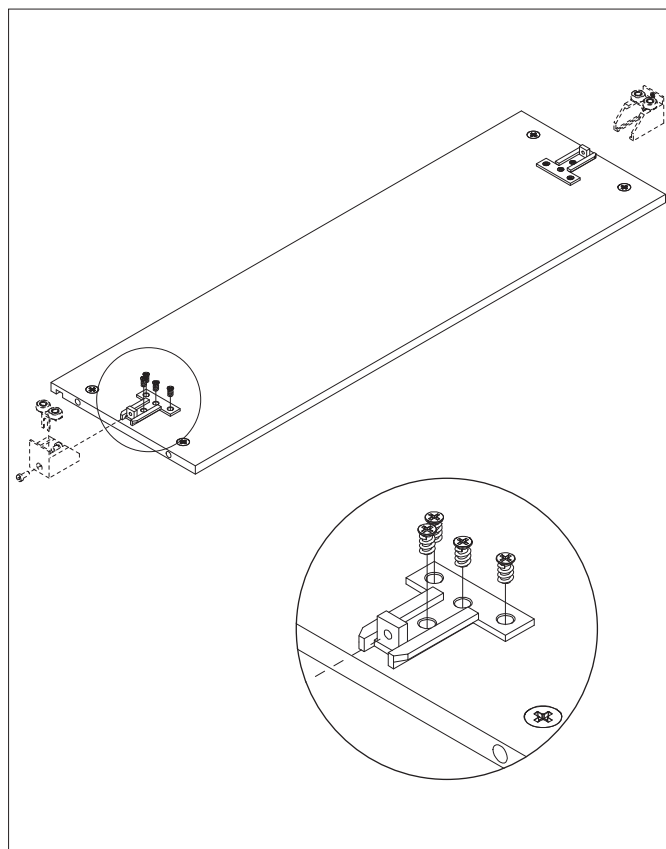

2_ Prepare top shelf with top fitting

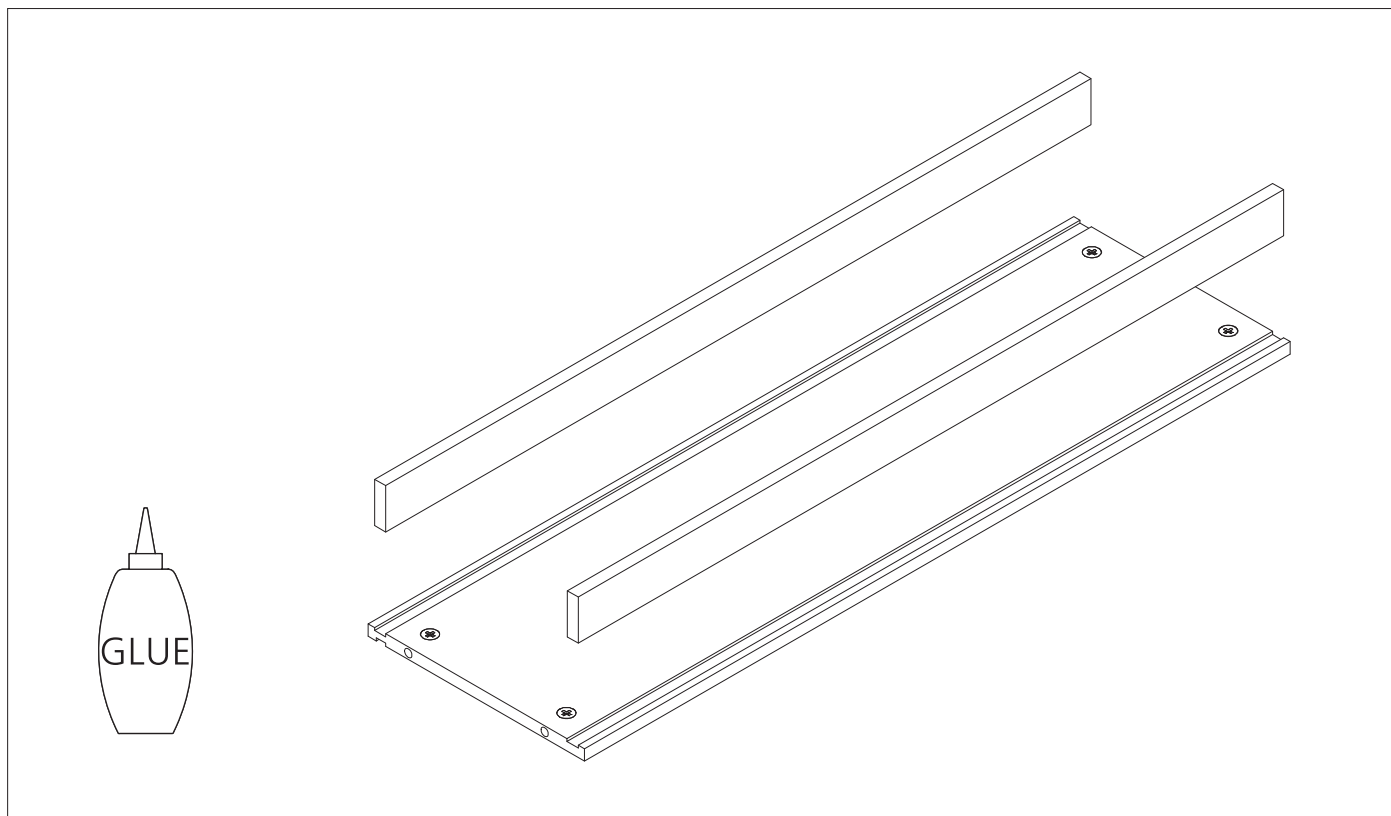

3_ Prepare bottom shelf

ASSEMBLY INSTRUCTIONS

ASSEMBLING THE SHELF

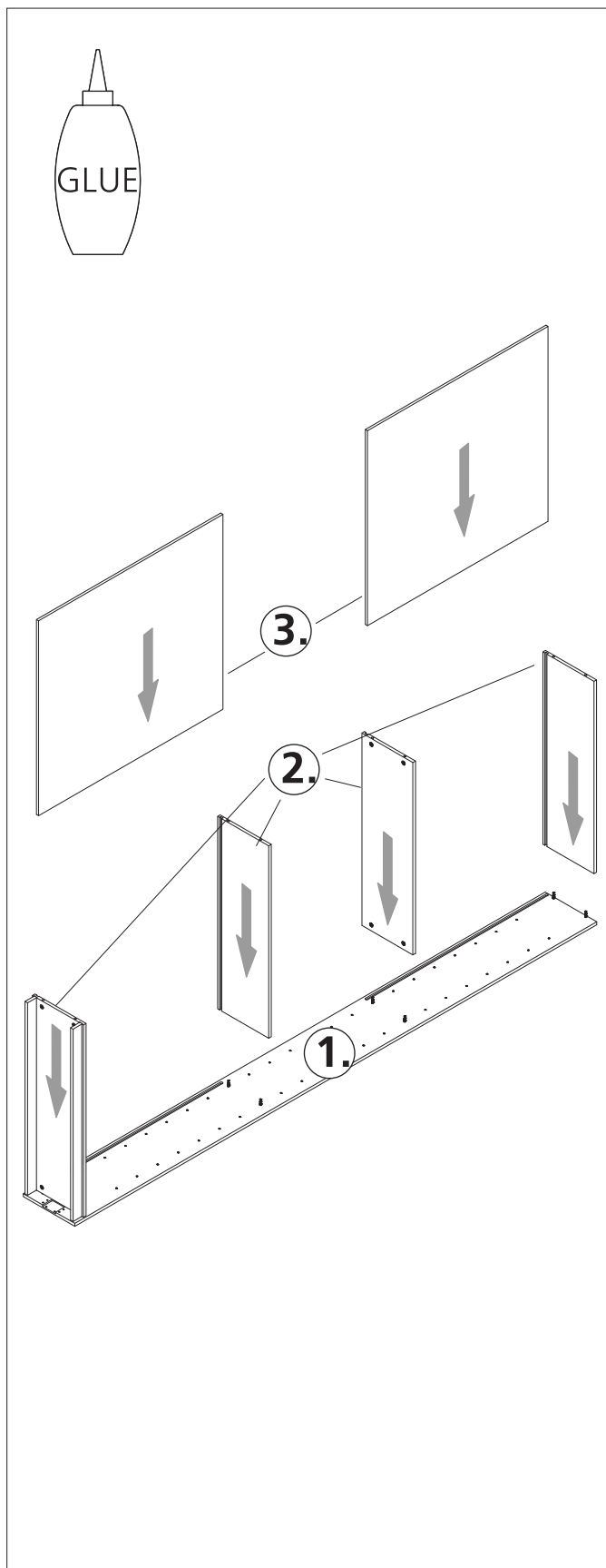

4_ Assemble construction shelf / sidewall and rear wall

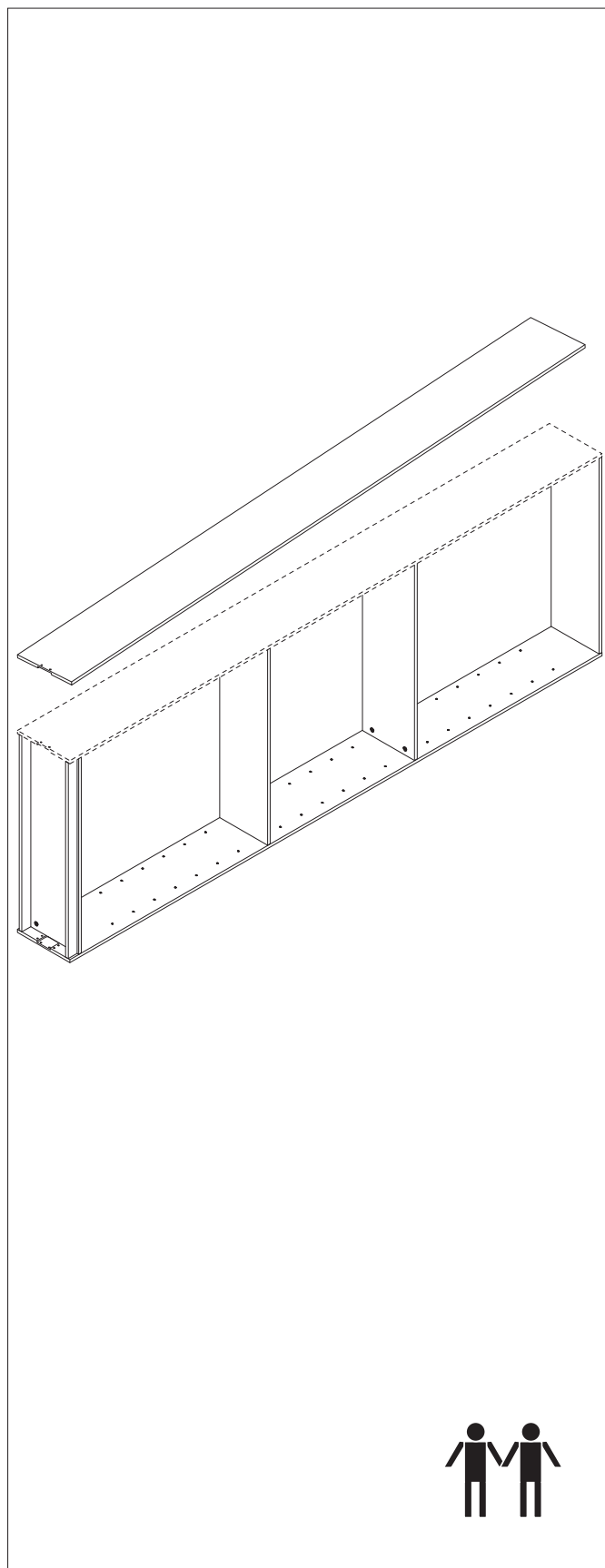

5_ Mount second side and fix it with the fittings

ASSEMBLY INSTRUCTIONS

ASSEMBLING THE SHELF

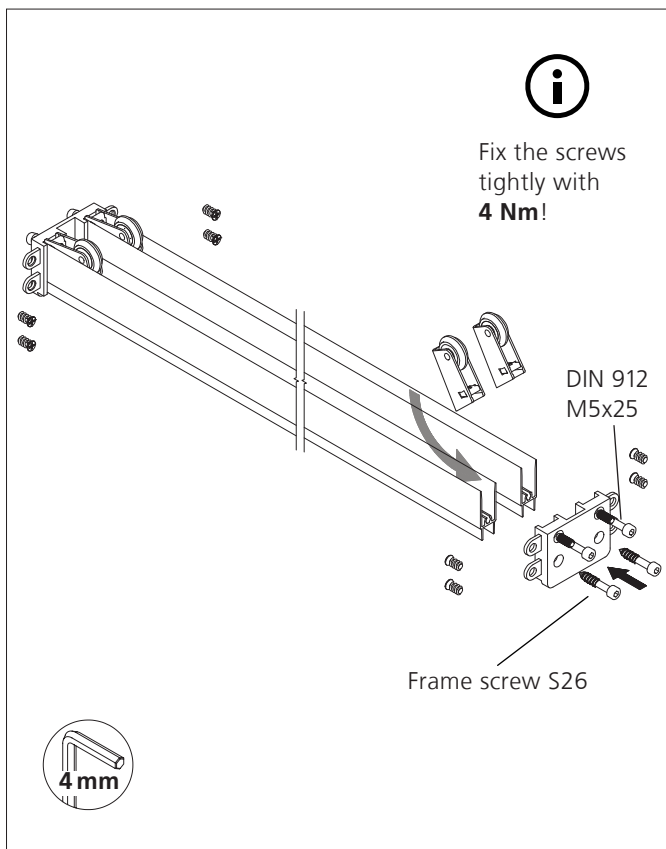

6_ Prepare for screwing the bottom rollers

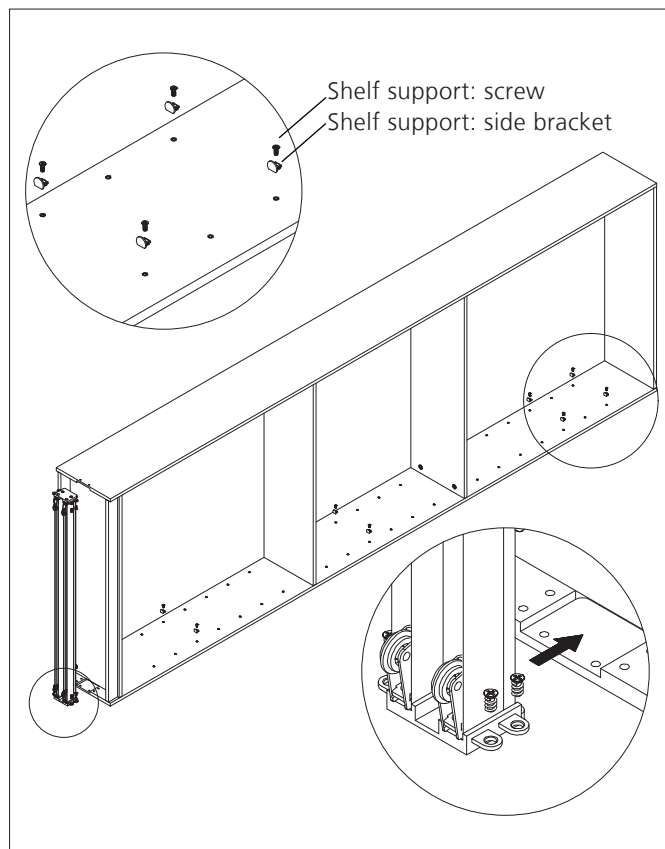

7_ Fix the bottom roller

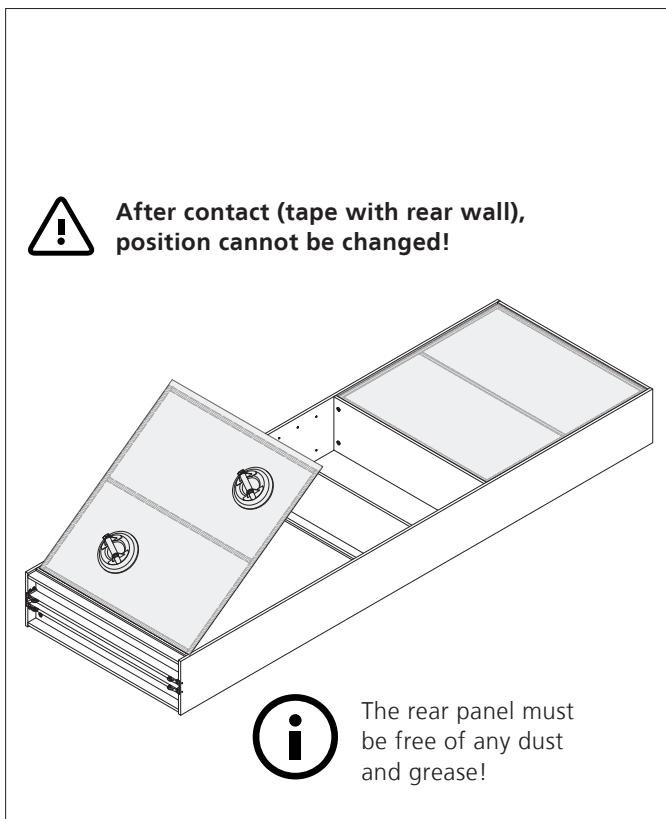

8_ Mount lower stiles and fittings

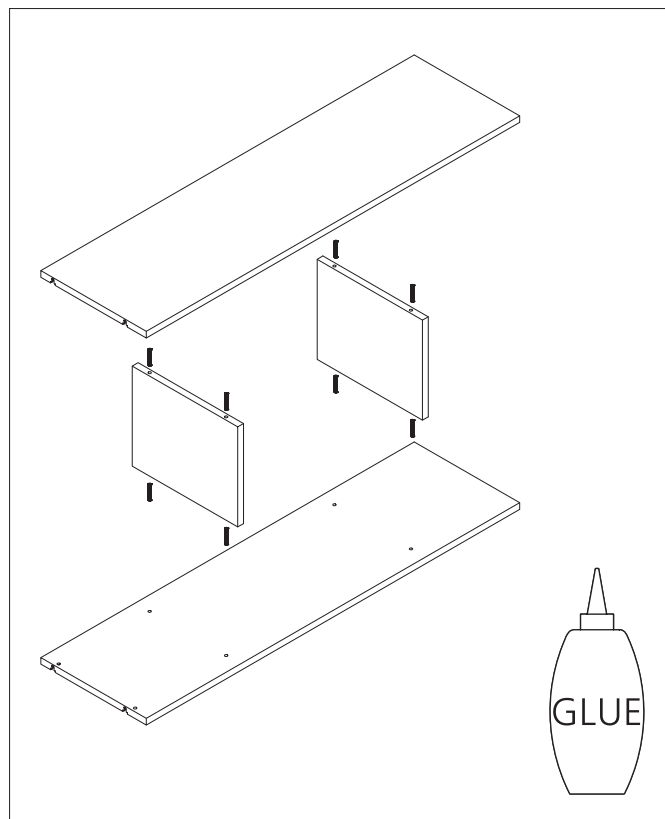

9_ Prepare dividing wall

INSTALLATION INSTRUCTIONS

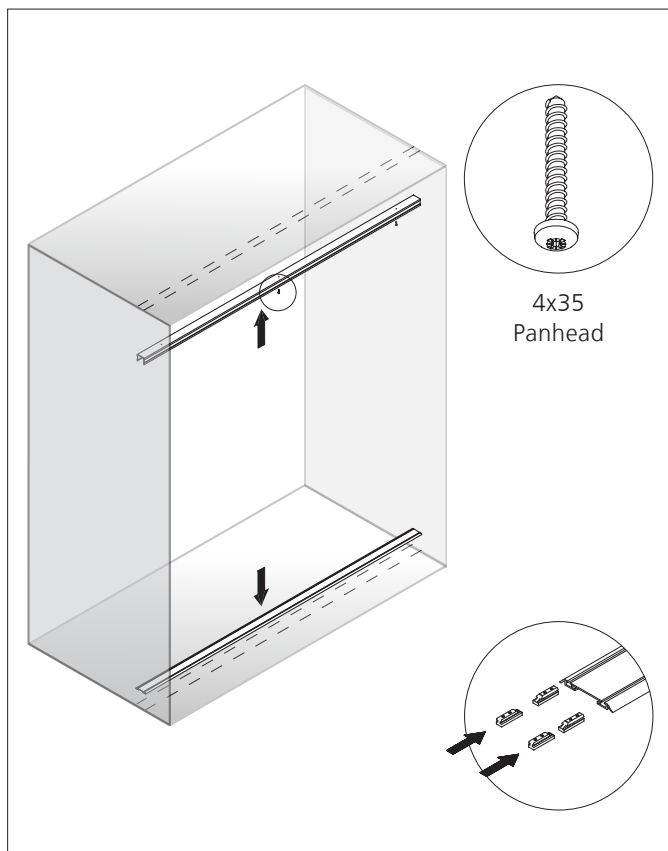

10_ Push stopper into the bottom track before assembly

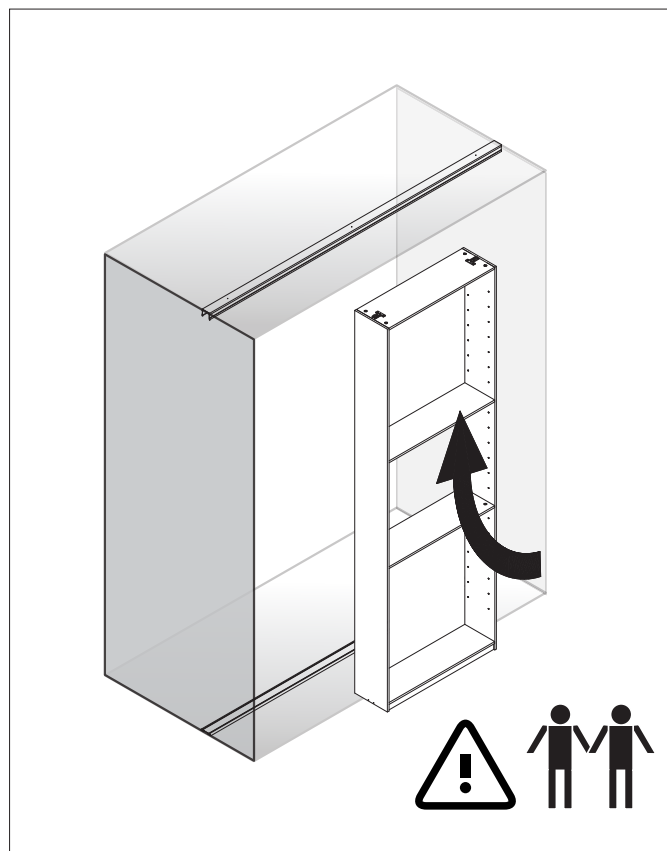

11_ Install moveable shelf with at least two persons

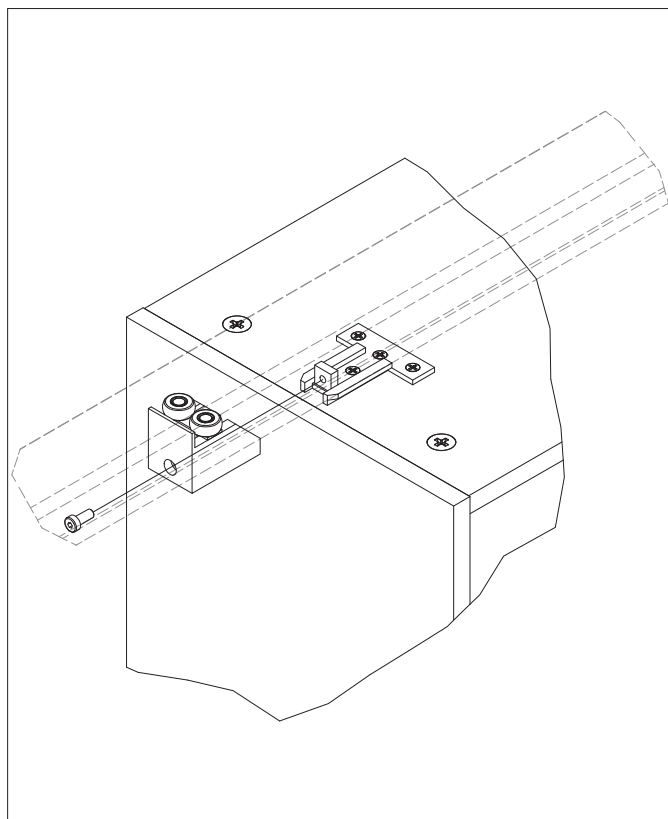

12_ Mount top fittings

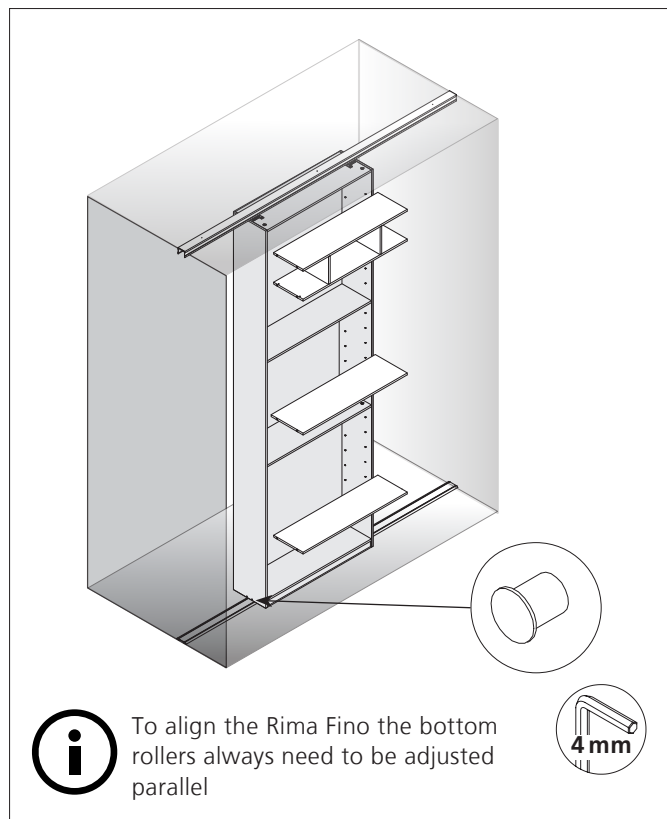

13_ Finish Rima Fino with the shelves and damper

RIMA FINO

DIMENSIONS

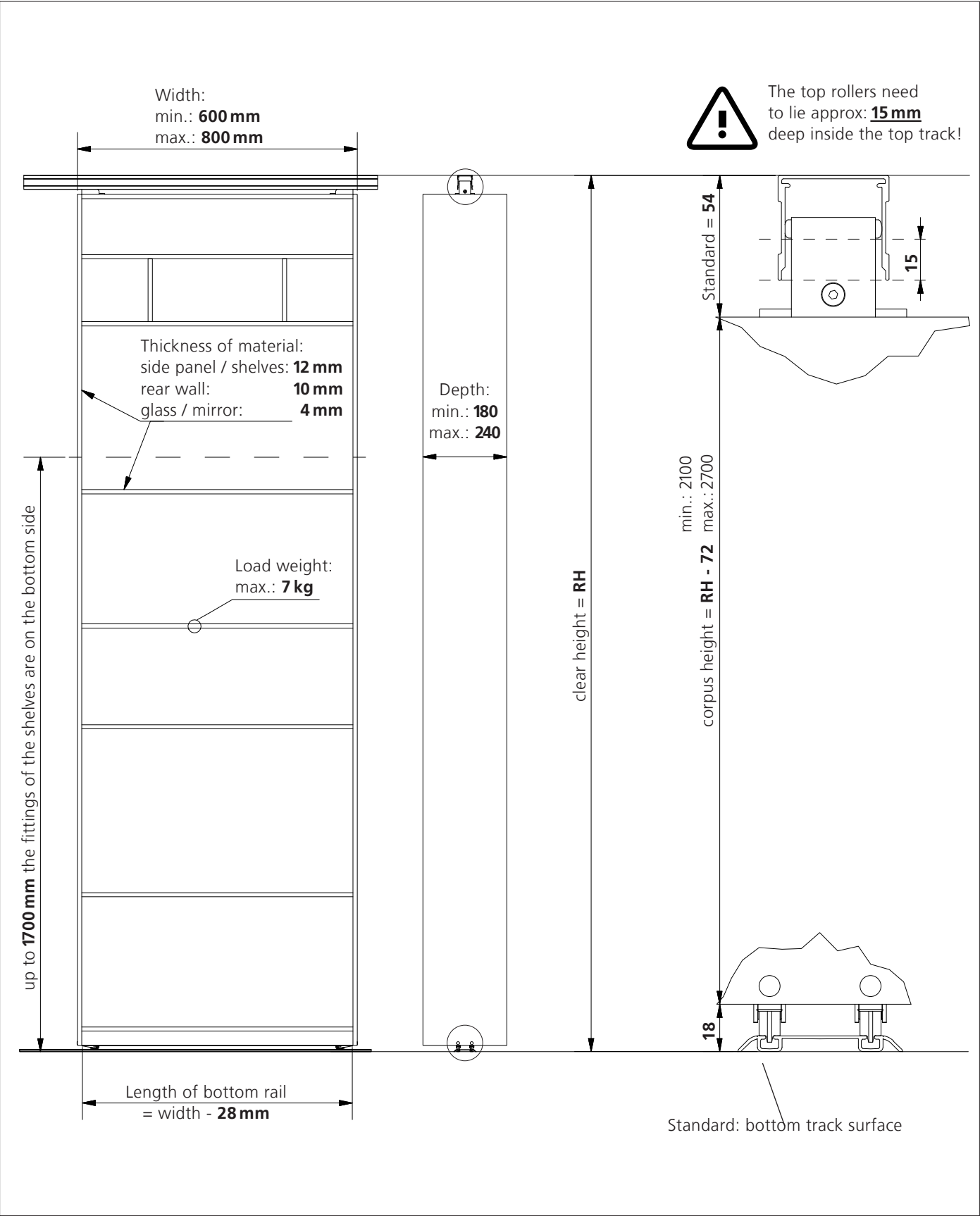

PLANNING

EXTERNAL DIMENSIONS

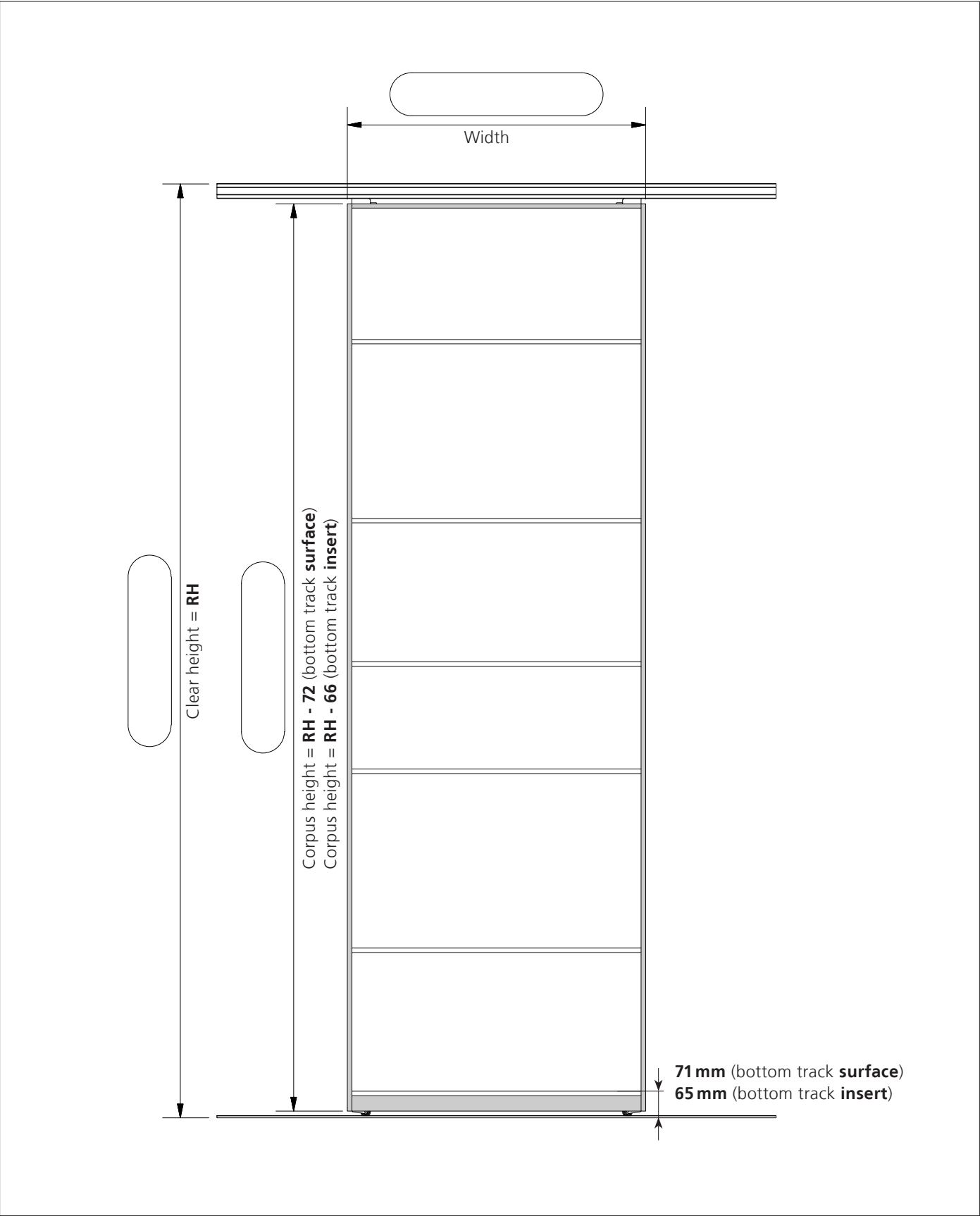

PLANNING

POSITION OF THE REAR WALL

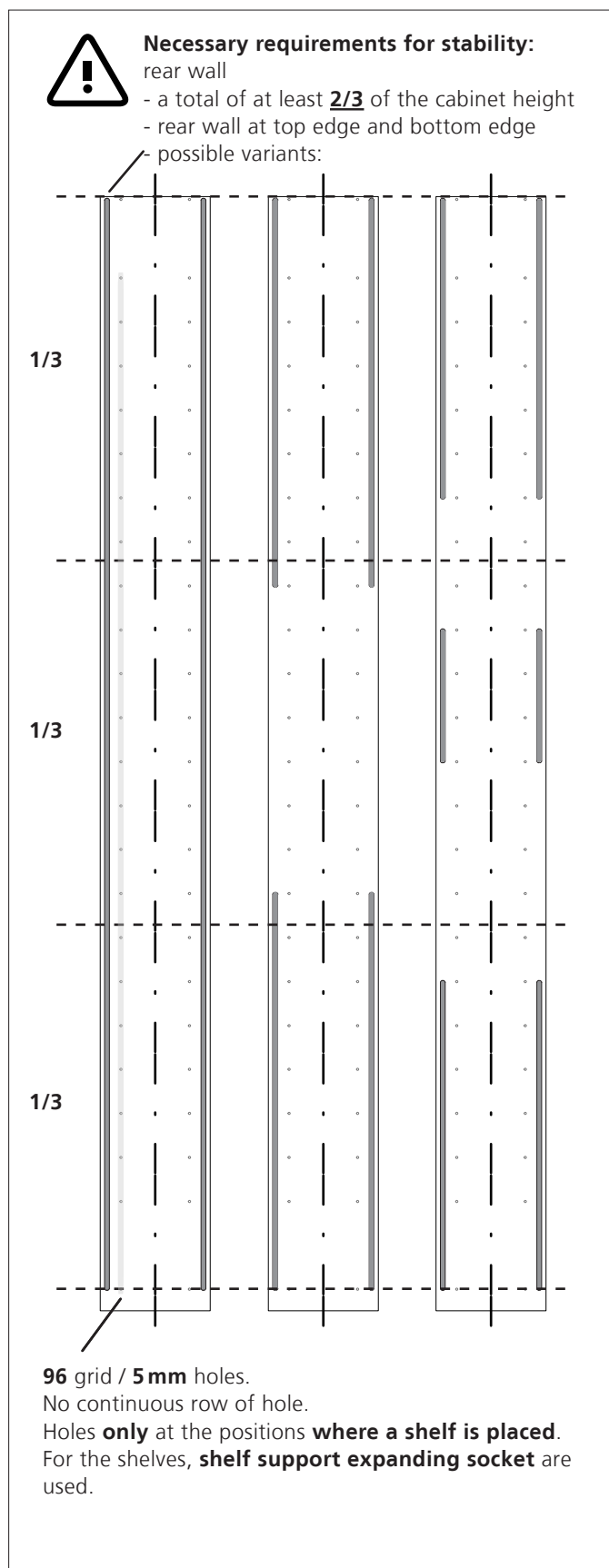

1_

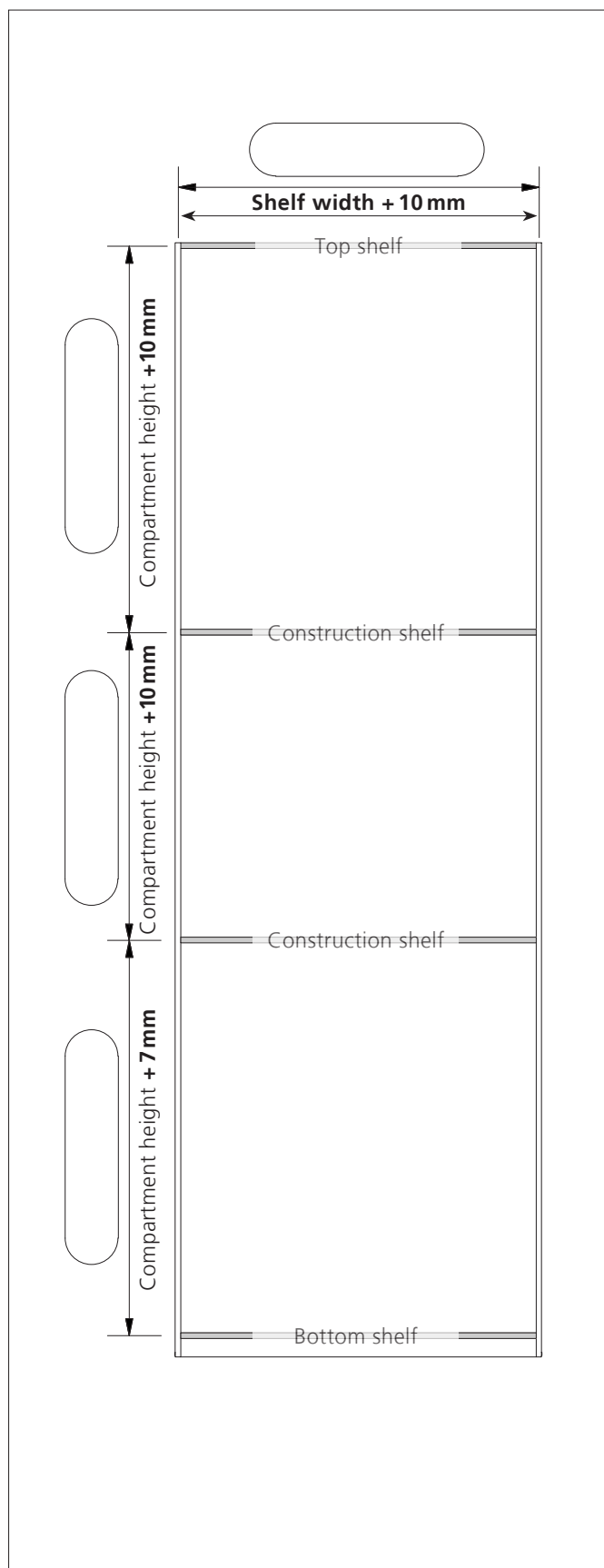

2_

PLANNING

DIVIDING WALL

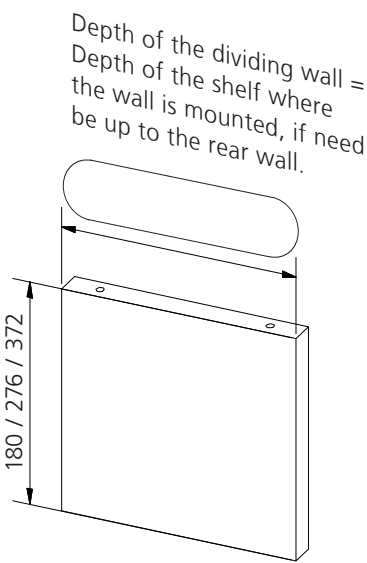
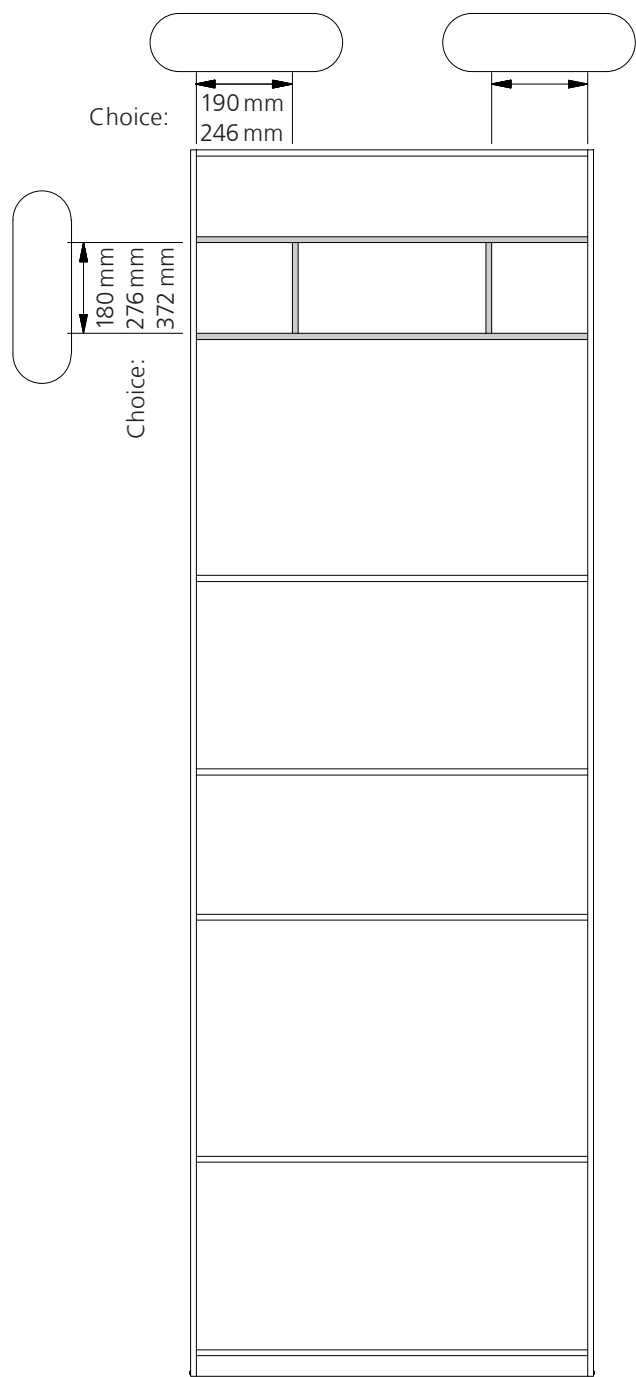

1_ Option: sketch in dimensions and positions of the dividing walls

PLANNING

POSITION OF THE TRACKS

