

INTERIOR SYSTEM: PLANNING, ASSEMBLY AND INSTALLATION INSTRUCTION

SYSTEM UNO

Version 9.0 (2019-01-08)

5.11.3.c



Subject to technical changes.

raumplus

CONTENT AND TOOLS

CONTENT:

Content and tools	page	03
Accessories	page	04
Cutting dimensions	page	05
Assembly examples/measurement	page	06
Detail drawings	page	08
Assembly instruction	page	09
Installation instruction	page	10
Accessories		
Pull out trouser with panel	page	14
Clothes lift	page	16
Uno 45 ° wall mounting	page	17
Clothes rod corner shelf	page	18
LED lighting clothes rod	page	19

TOOLS:

(without claim of completeness)

- | | |
|----------------------------|----------------------------|
| ■ Allen key set | ■ Pencil |
| ■ Drilling machine | ■ Rubber mallet |
| ■ Drill set metall / stone | ■ Threading tool 10 mm |
| ■ Cross tip screwdriver | ■ Water level |
| ■ Measuring tools | ■ Open-ended spanner 14 mm |



VERSION INFORMATION:







Version: 7.2: Item number adjusted page / various changes
7.5: calculation height
8.0: Accessories added
9.0: exchanged carrier profile uno

PRODUCT INFORMATION

GENERAL INFORMATION: Preparation

- This manual is part of the product and describes the safe and proper installation of the system. Read the instruction carefully before installation
- Please note that the assembly should only be done by qualified and trained staff in strict compliance with all details indicated in this document. Improper installation in variation from manufacturer's specification may cause defects and danger, thus endangering the safe fixing of the product as well as the safety of the prospective user. The liability of the manufacturer shall be excluded in case of defects and consequential damages resulting from incorrect assembly of this product.
- Please check the completeness of the delivered parts and check carefully if any transport damages are visible
- If any parts are damaged or lost, please immediately contact the responsible supplier.
- It is assumed that you have exactly identified all cutting dimensions according to the measurement instruction for **raumplus**-products

SYMBOLS:

Symbol	Importance
	Risk or danger!
	Advice and information
	Additional information / other documents
	Directional data / direction of movement
	„yes“ and „right“
	„no“ and „wrong“
	Follow the order

SYSTEM:

System Information: UNO

- min./max. depth of element = 300 mm / 330 mm / 600 mm
- min./max. height of element = 500 mm / 500 mm / 3000 mm
- min./max. width of element = 100 mm / 300 mm / 1248 mm
**without / with
drawer corpus**

ACCESSORIES

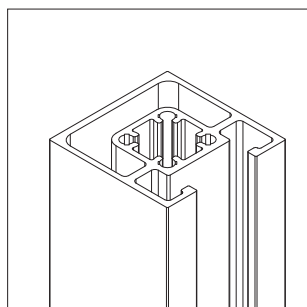

1_ 80.01.120

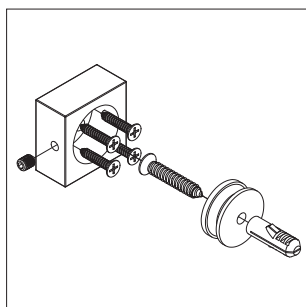

2_ 80.20.040

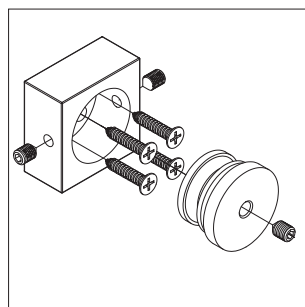

3_ 80.20.060

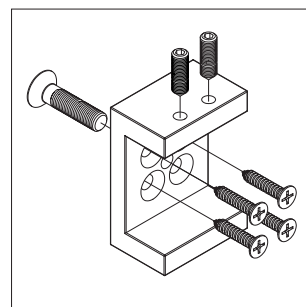

4_ 80.40.050

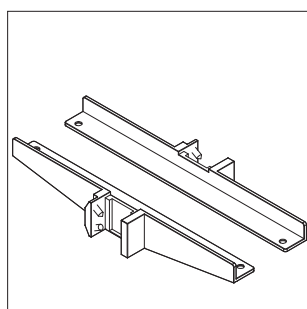

5_ 80.40.020

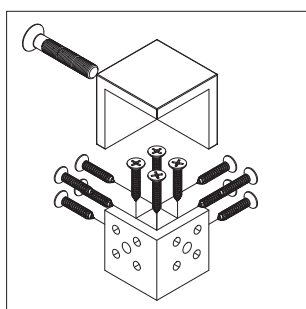

6_ 80.20.080

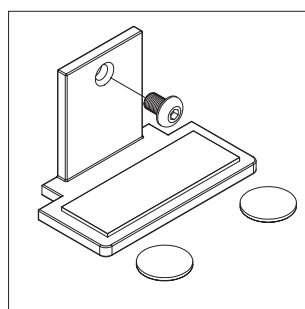

7_ 80.40.025

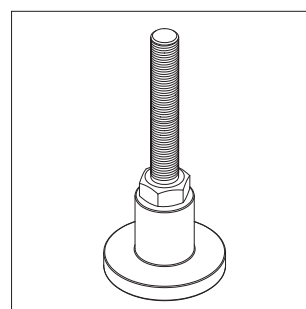

8_ 80.20.015

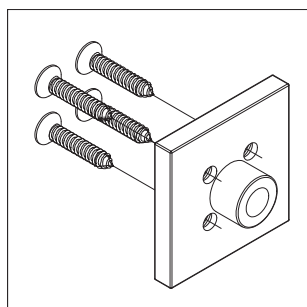

9_ 80.20.010

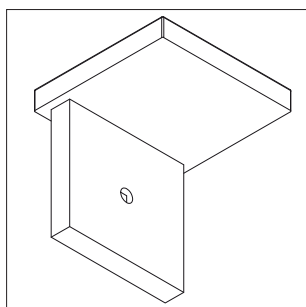

10_ 80.20.090

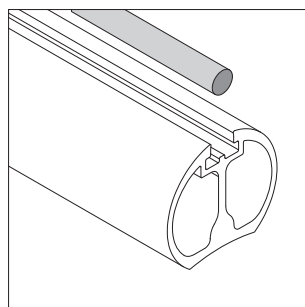

11_ 80.23.020 / 80.23.025

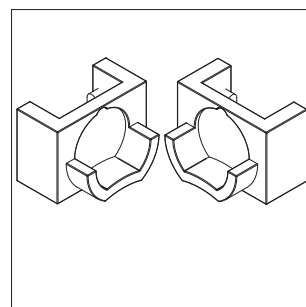

12_ 80.40.035

1_ Carrier profile 3000 mm

2_ Wall- and ceiling connection

3_ Profile connection

4_ Universal carrier

5_ L-carrier L/R

6_ Corner connection

7_ Attachment for glass shelf carrier 8/10 mm

8_ Adjustment foot

9_ Transition piece

10_ End cap

11_ Clothes rod, round & PVC rod

12_ Rod carrier round Uno

without illustration:

13_ Tie holder L/R 80.20.907 / 80.22.191

14_ Hook rail L/R 80.22.092 / 192

15_ Scarf holder L/R 80.22.093 / 193

16_ Pull-out trouser incl. front panel ACC-HOAZU01N

17_ Kleiderlifte von 440 bis 1150 mm Breite ACC-LIFx

17a_ Adapter for clothes lift 80.22.098

18_ Clothes rod corner connector 80.22.05x

19_ Mitre connector 80.x0.x70

20_ Rubber pad for mitre connector (optional) 80.20.975

21_ Profile connector for LED rod 80.20.065

22_ Rod carrier LED, round 80.40.037

23_ LED clothes rod 80.24.0xx

24_ Cover profile for LED rod 80.24.010

25_ Clothes rod corner connector LED 80.22.15x

26_ Clothes rod oval 80.22.050

26a Rod carrier L/R 80.40.030

CUTTING DIMENSIONS

Shelves up to max. **1248 mm**

Profiles up to max. **3000 mm**

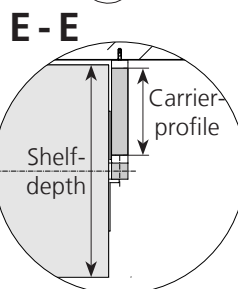
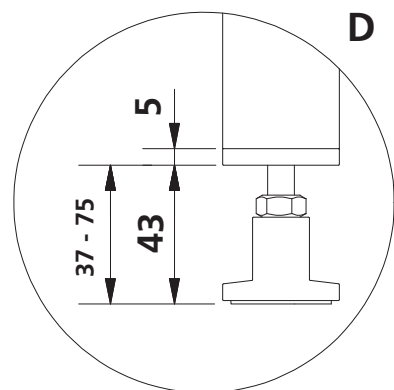
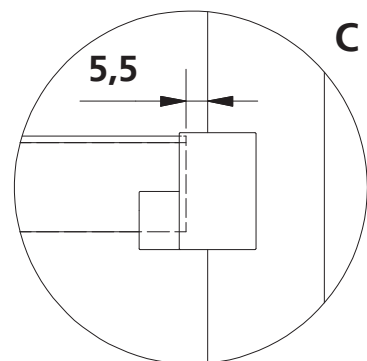
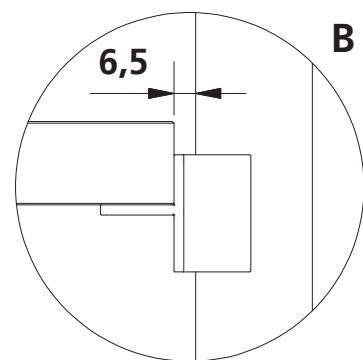
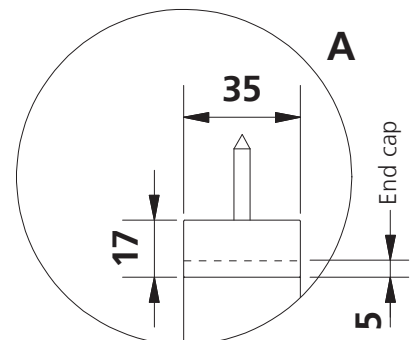
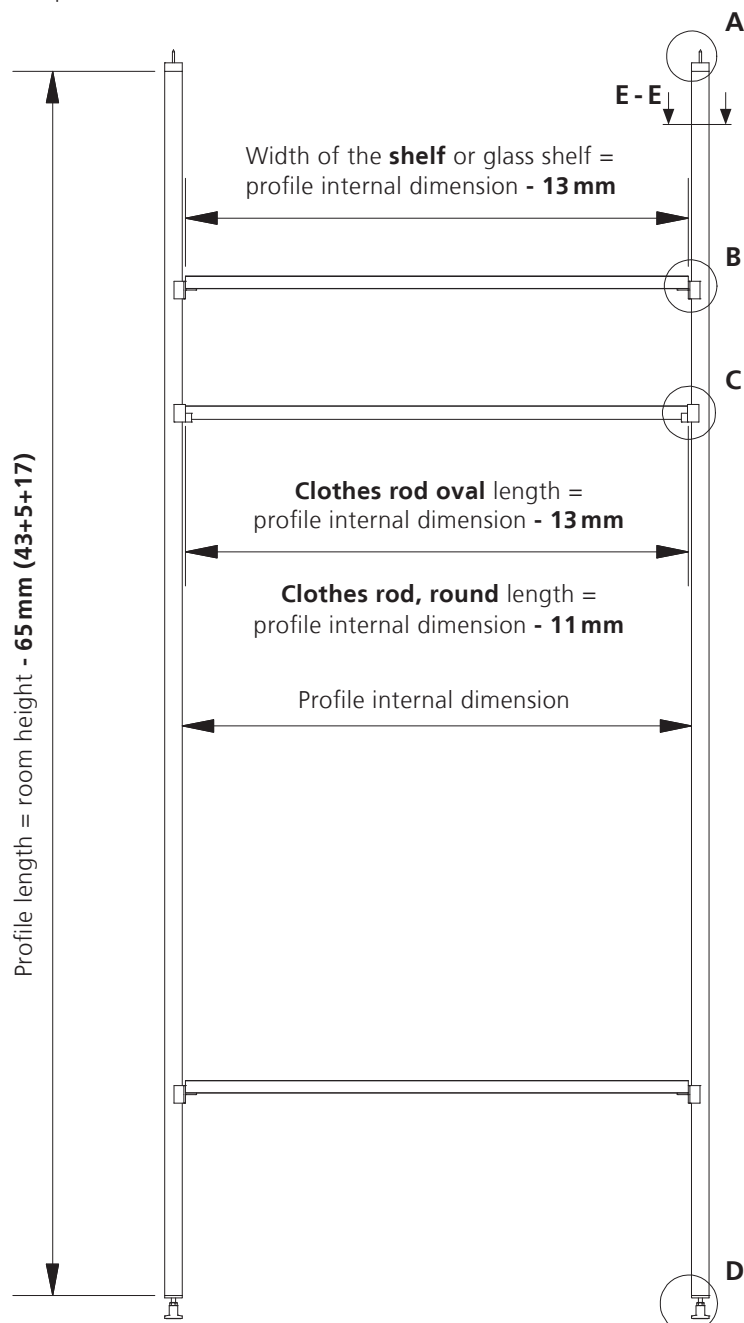

Distance from wall:

Shelf - wall = 10 mm (standard)

Wallconnection:

Length **carrier profile** = (shelf depth : 2) - 41 mm

ASSEMBLY EXAMPLES

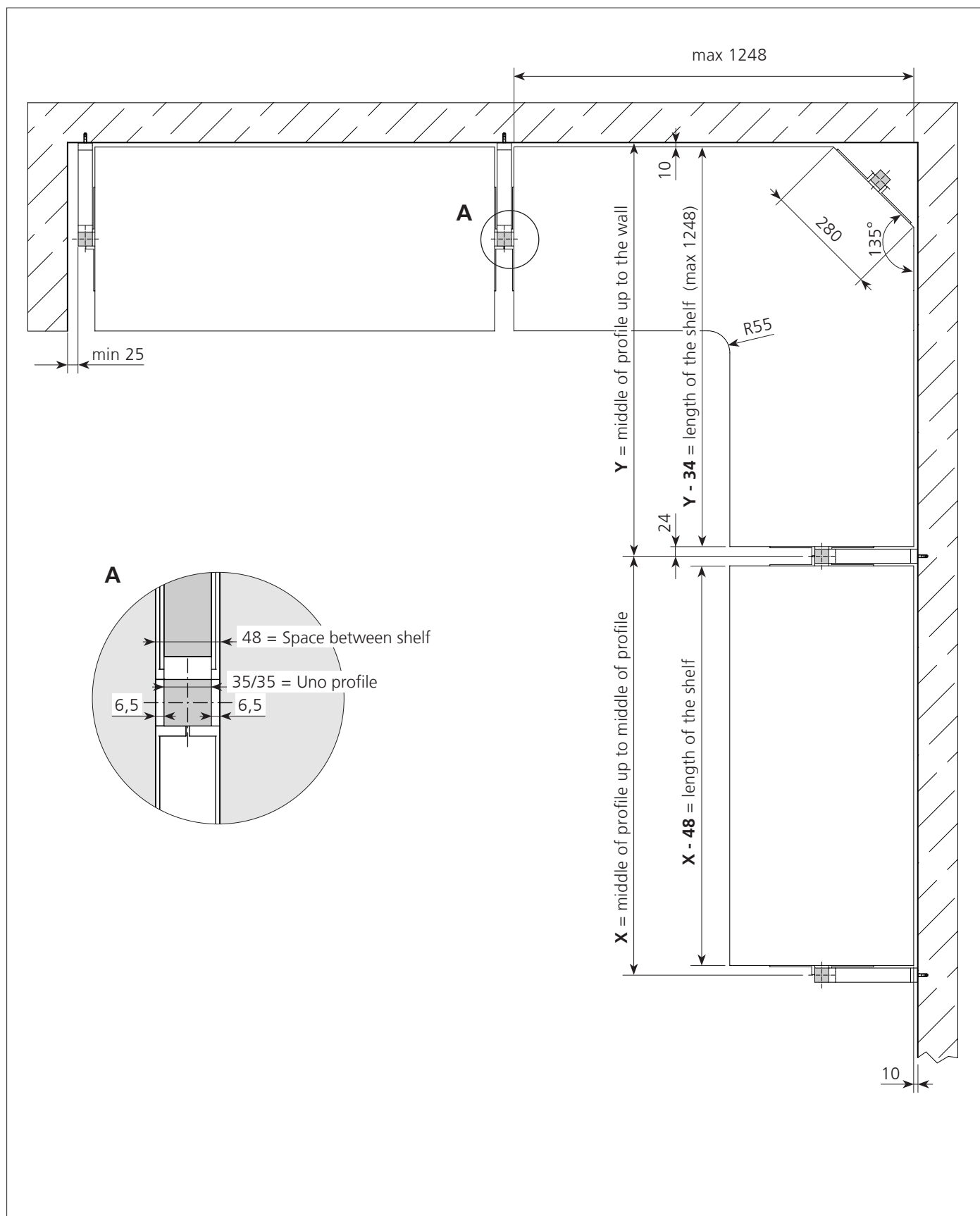

2_ Determination of the corner shelf size

MEASUREMENTS

Bending of shelves

Glass ESG	thickness =	8 mm	length in mm:	1248	1125	1000	825	750
	width =	460 mm	deflection in mm	<u>9,6</u>	<u>7,0</u>	<u>4,9</u>	<u>2,8</u>	<u>2,1</u>
	burden linear	55 kg	average utilization in %:	33,0	29,7	26,4	21,8	19,8
	"	thickness =	length in mm:	1248	1125	1000	825	750
		width =	deflection in mm	<u>4,9</u>	<u>3,6</u>	<u>2,5</u>	<u>1,4</u>	<u>1,1</u>
		burden linear	average utilization in %:	21,1	19,0	16,9	13,9	12,7
	"	thickness =	length in mm:	1248	1125	1000	825	750
		width =	deflection in mm	<u>7,3</u>	<u>5,4</u>	<u>3,8</u>	<u>2,1</u>	<u>1,6</u>
Chipboard	burden linear	55 kg	average utilization in %:	25,3	22,7	20,2	16,7	15,2
	"	thickness =	length in mm:	1248	1125	1000	825	750
		width =	deflection in mm	<u>3,8</u>	<u>2,7</u>	<u>1,9</u>	<u>1,1</u>	<u>0,8</u>
		burden linear	average utilization in %:	16,2	14,6	12,9	10,7	9,7
	"	thickness =	length in mm:	1248	1125	1000	825	750
		width =	deflection in mm	<u>3,5</u>	<u>2,5</u>	<u>1,8</u>	<u>1,0</u>	<u>0,8</u>
		Burden linear	average utilization in %:	12,0	10,8	9,6	7,9	7,2
	"	thickness =	length in mm:	1248	1125	1000	825	750
Glass ESG		width =	deflection in mm	<u>1,8</u>	<u>1,3</u>	<u>0,9</u>	<u>0,5</u>	<u>0,4</u>
		burden linear	average utilization in %:	7,7	6,9	6,1	5,1	4,6
	"	thickness =	length in mm:	1248	1125	1000	825	750
		width =	deflection in mm	<u>2,7</u>	<u>1,9</u>	<u>1,4</u>	<u>0,8</u>	<u>0,6</u>
		burden linear	average utilization in %:	9,2	8,3	7,4	6,1	5,5
	"	thickness =	length in mm:	1248	1125	1000	825	750
		width =	deflection in mm	<u>1,4</u>	<u>1,0</u>	<u>0,7</u>	<u>0,4</u>	<u>0,3</u>
		burden linear	average utilization in %:	5,9	5,3	4,7	3,9	3,5
Chipboard	thickness =	25 mm	length in mm:	1248	1125	1000	825	750
	width =	460 mm	deflection in mm	<u>9,2</u>	<u>6,7</u>	<u>4,7</u>	<u>2,6</u>	<u>2,0</u>
	burden linear	55 kg	average utilization in %:	14,1	12,7	11,3	9,3	8,4
	"	thickness =	length in mm:	1248	1125	1000	825	750
		width =	deflection in mm	<u>7,0</u>	<u>5,1</u>	<u>3,6</u>	<u>2,0</u>	<u>1,5</u>
		burden linear	average utilization in %:	10,8	9,7	8,6	7,1	6,5
	"	thickness =	length in mm:	1248	1125	1000	825	750
		width =	deflection in mm	<u>3,3</u>	<u>2,4</u>	<u>1,7</u>	<u>1,0</u>	<u>0,7</u>
Glass ESG	burden linear	20 kg	average utilization in %:	5,1	4,6	4,1	3,4	3,1
	"	thickness =	length in mm:	1248	1125	1000	825	750
		width =	deflection in mm	<u>2,6</u>	<u>1,9</u>	<u>1,3</u>	<u>0,7</u>	<u>0,6</u>
		burden linear	average utilization in %:	3,9	3,5	3,1	2,6	2,4



Attention: If the glass is damaged, the weight capacity decreases.
Do not exceed the maximum weight allowable.

DETAIL DRAWING

EXPLODED DRAWING

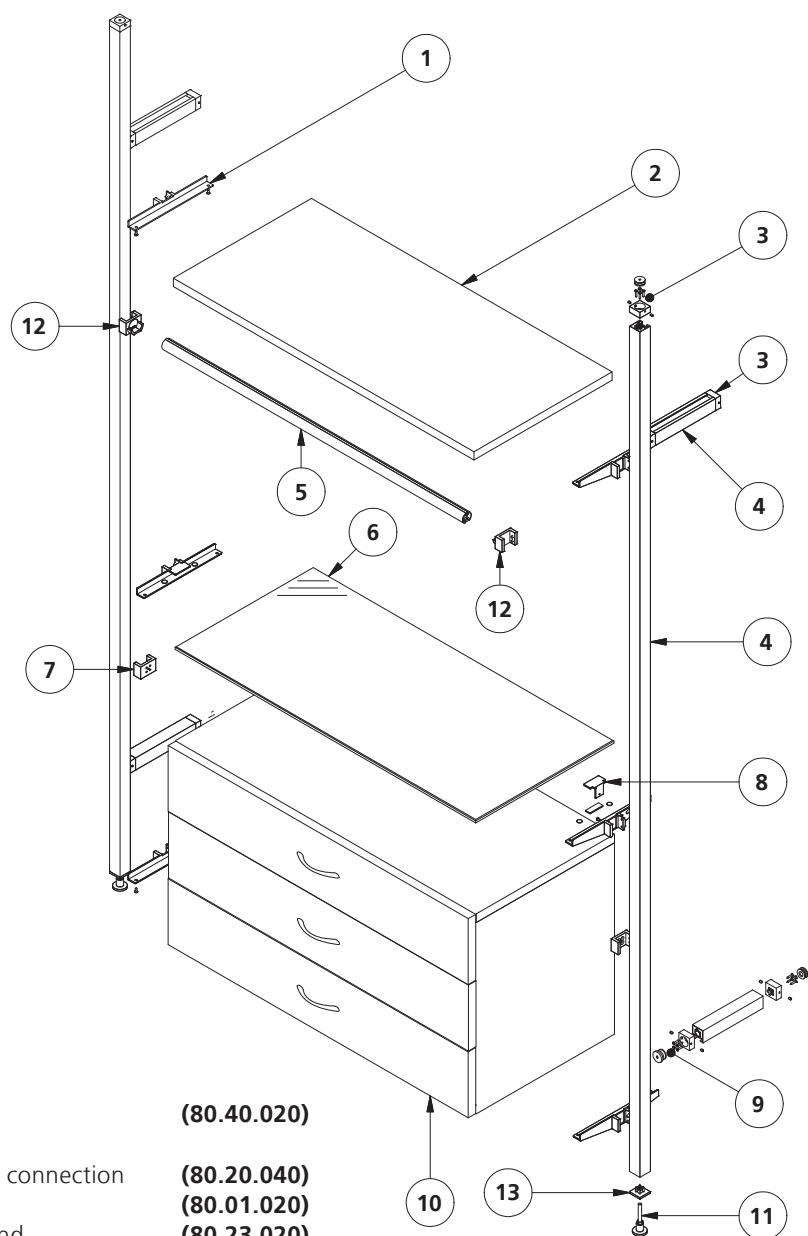

		Item list	
object	quantity	description	
1	6	L-carrier	(80.40.020)
2	1	Shelf	
3	6	Wall and ceiling connection	(80.20.040)
4	6	Carrier profile	(80.01.020)
5	1	Clothes rod round	(80.23.020)
6	1	Uno glass shelf	
7	2	Universal carrier	(80.40.050)
8	2	Attachment for glass shelf carrier	(80.40.025)
9	4	Profil connection	(80.20.060)
10	1	Drawer corpus compl.	
11	2	Adjustment foot	(80.20.015)
12	2	Rod carrier round	(80.40.035)
13	2	Transition piece	(80.20.010)

ASSEMBLY INSTRUCTIONS



In the area of clothes lift and drawer corpus are always wall connections to provide

Set the profile connector in the carrier profile, align and fix it.

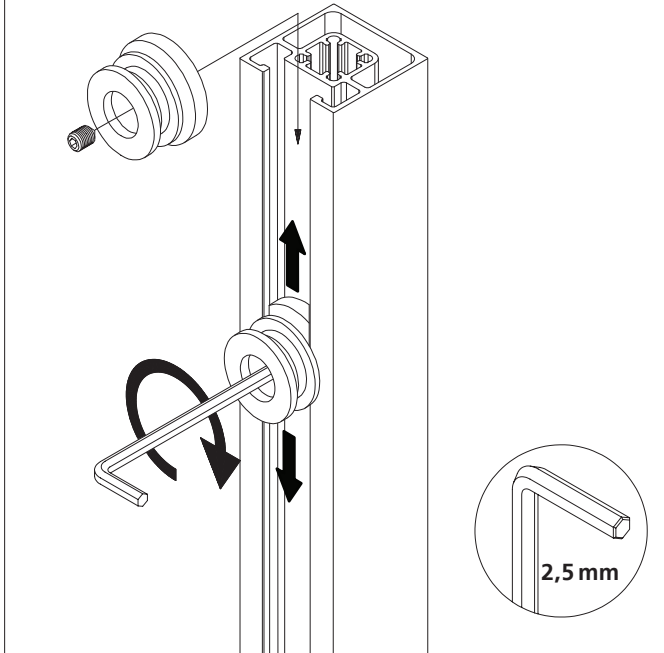

1_ Assembly of the profile connection for wall mounting

1. Pre-assemble the profile connection.

2. Put the profile connection and carrier profile on the brass bushing and fix it.

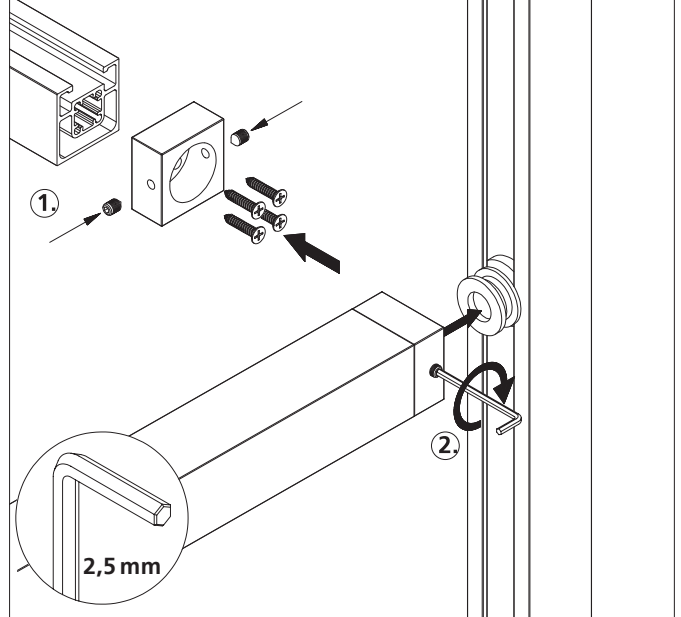

2_ Assembly of the profile connection

1. Pre-assemble the wall- and ceiling connection.
2. Mount the brass bush to the wall and ceiling, put the profile connection and carrier profile on the brass bush and fix it.

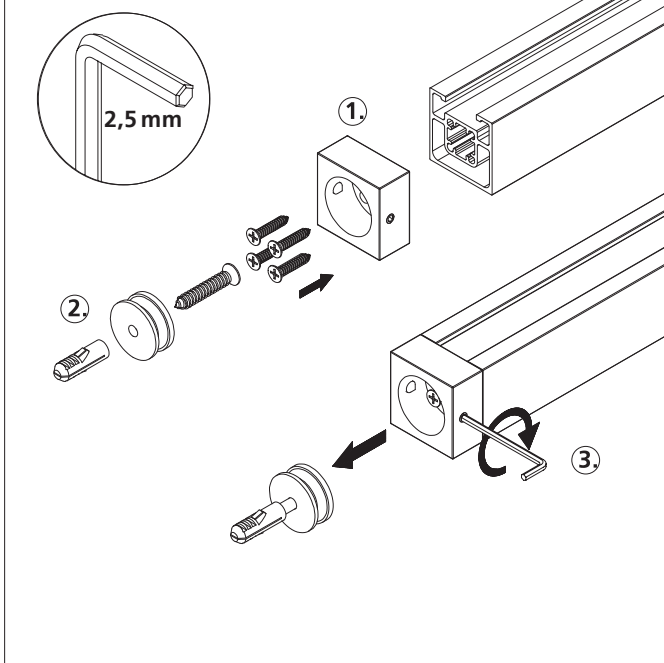

3_ Assembly of the wall- and ceiling connection

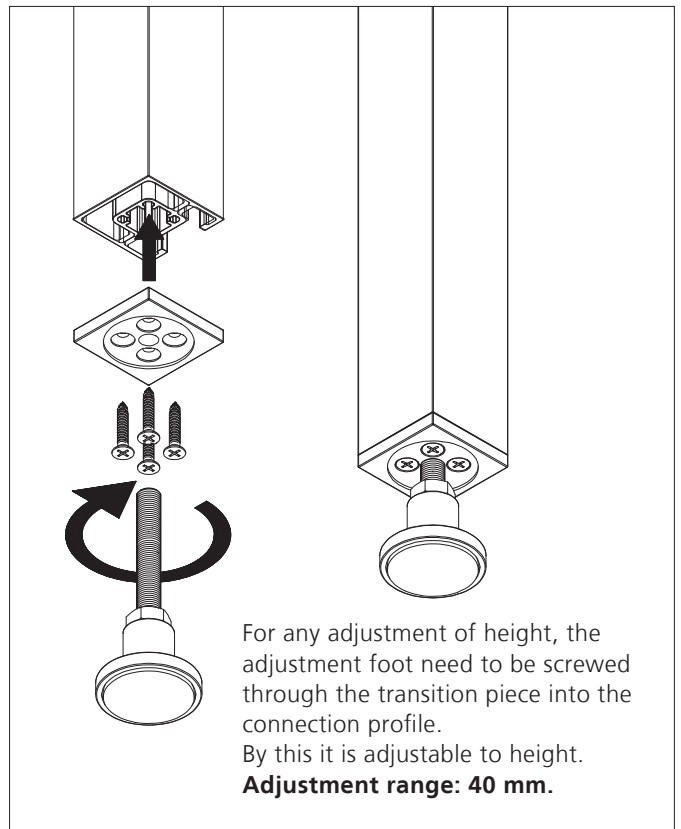

For any adjustment of height, the adjustment foot need to be screwed through the transition piece into the connection profile.
By this it is adjustable to height.
Adjustment range: 40 mm.

4_ Insert adjustment foot

INSTALLATION INSTRUCTIONS



At a ceiling attachment you have to make a additional attachment to the wall.
If there is no attachment to the ceiling is possible, you have to plan with two wall connectors per profile to the wall.

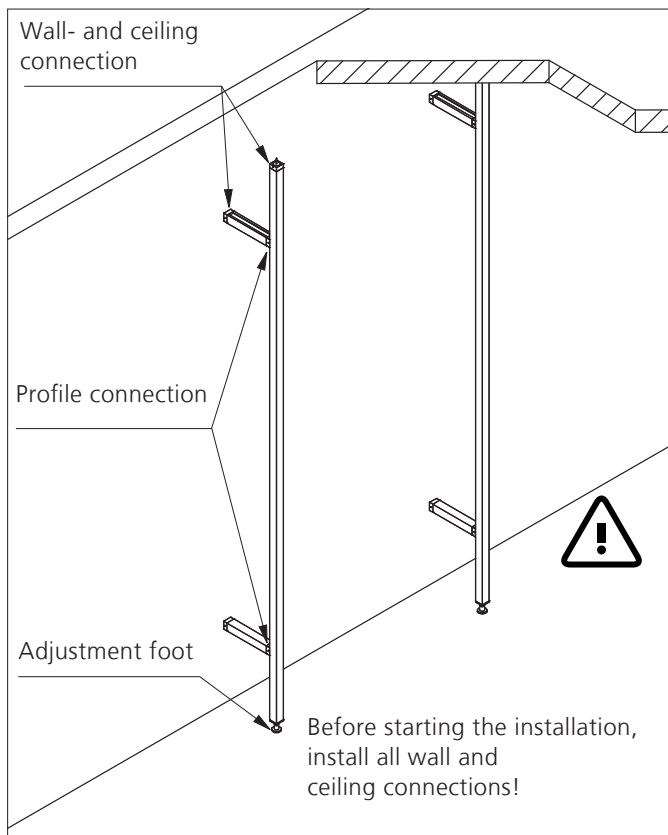

1_ Installation examples

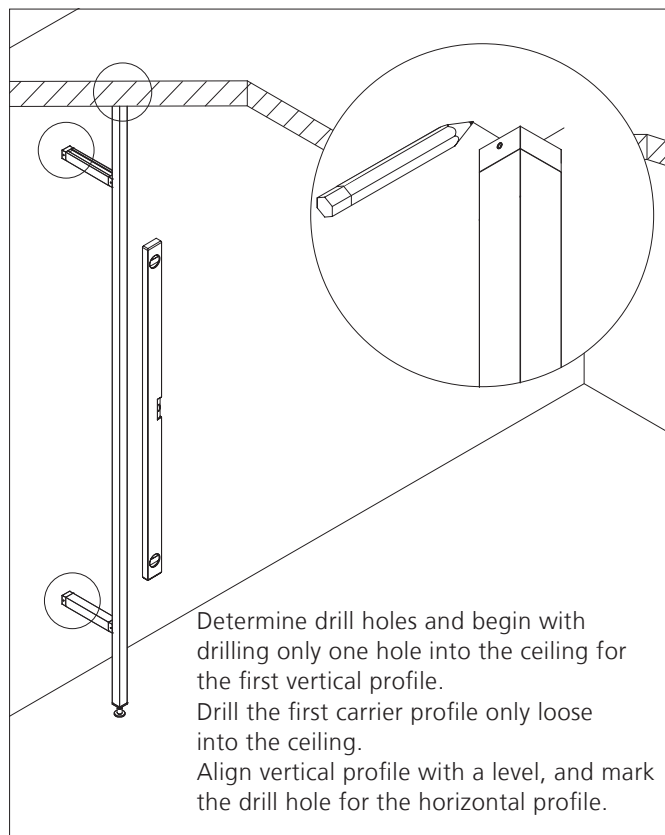

2_ Mark the holes

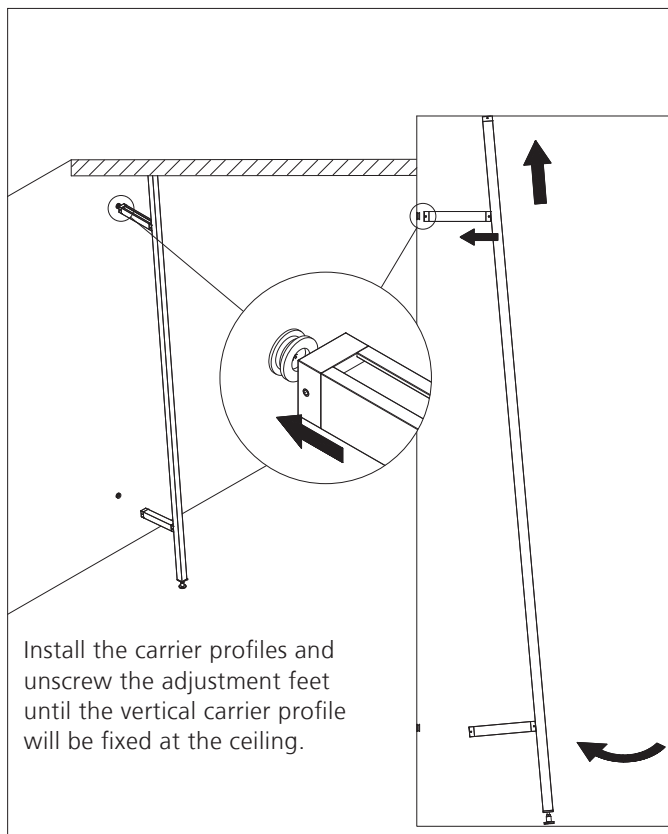

3_ Insert and fix profile

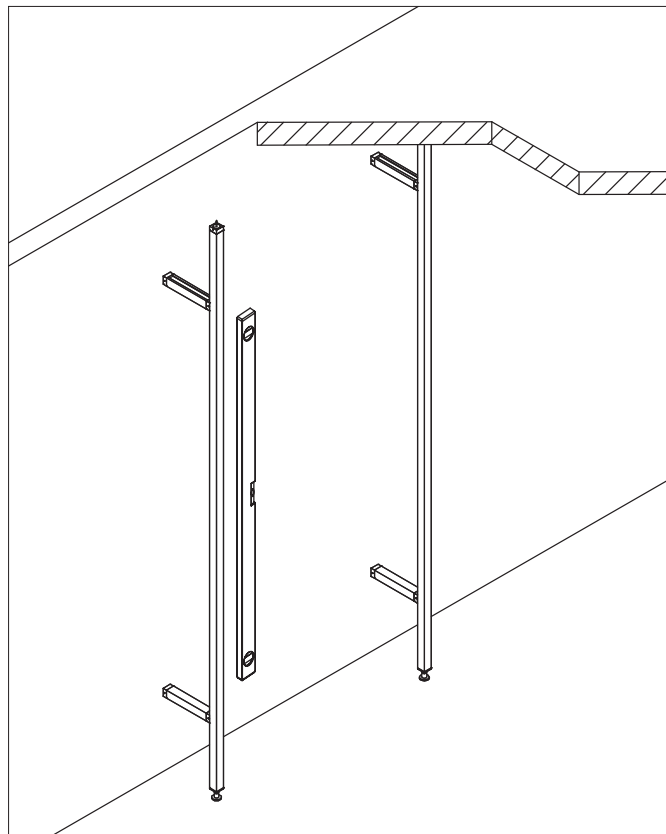

4_ Installation examples

INSTALLATION INSTRUCTIONS

SHELVES

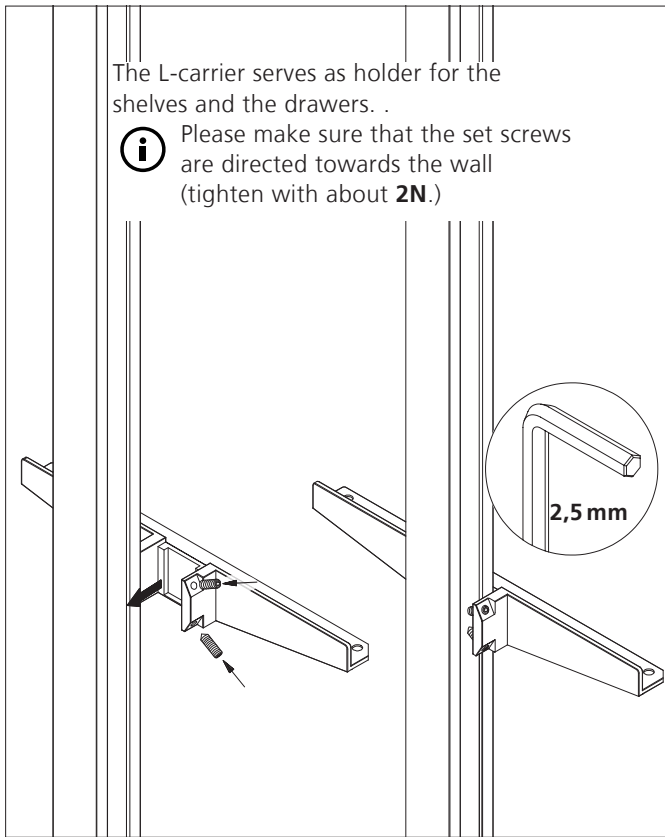

5_ Insert and fix the L-carrier (right and left)

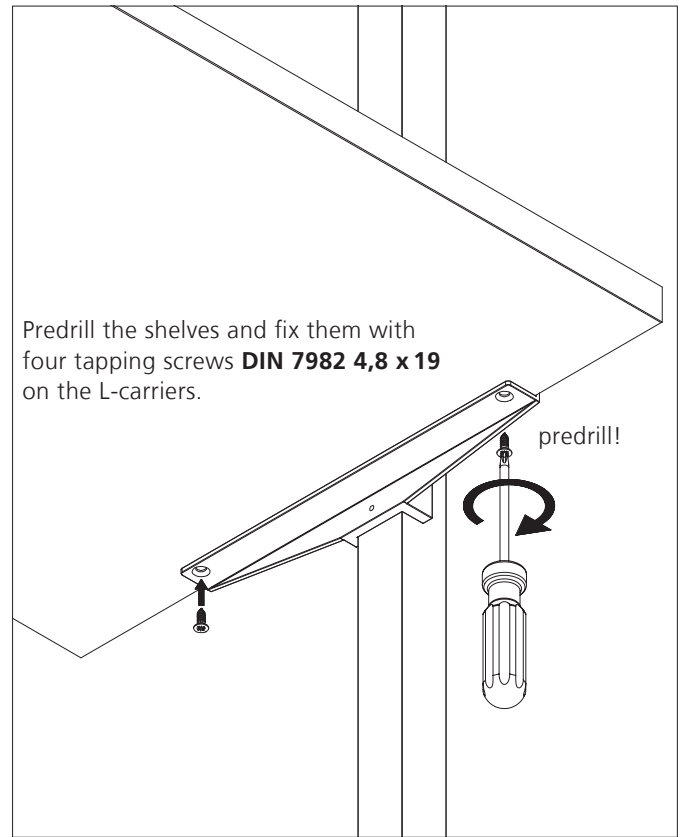

6_ Fix the shelves

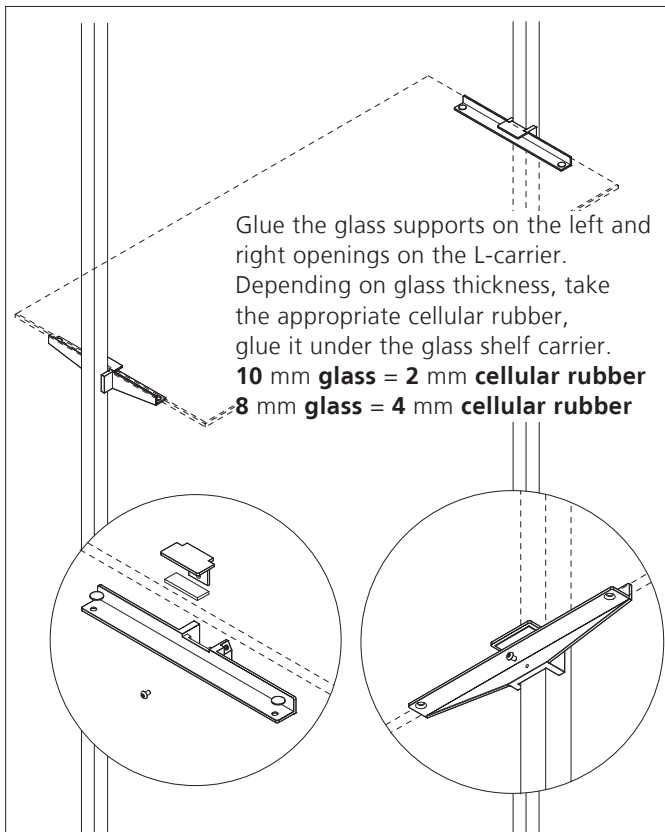

7_ Insert the attachment for glass shelf carrier

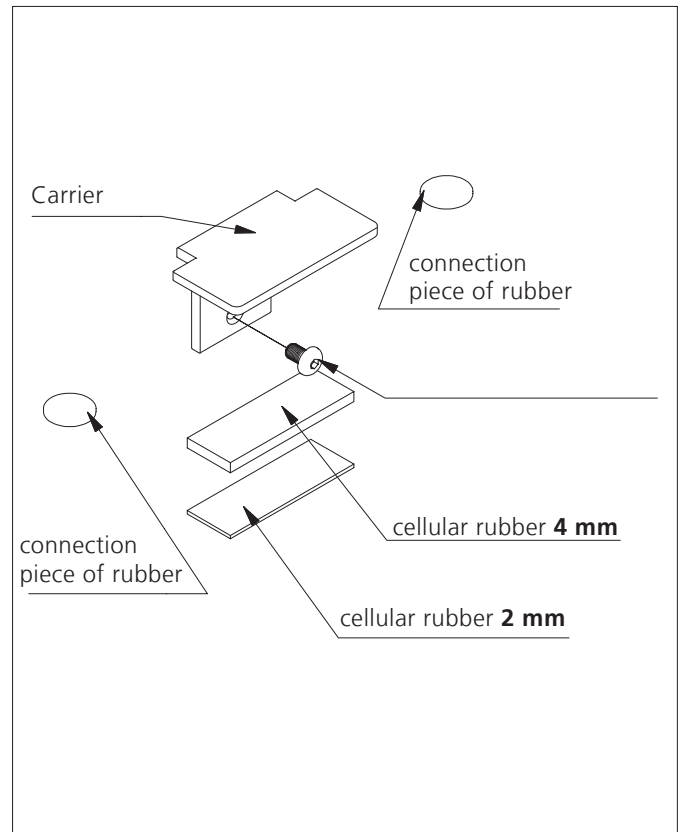

8_ Attachment for glass shelf carrier

INSTALLATION INSTRUCTIONS

DRAWER CORPUS

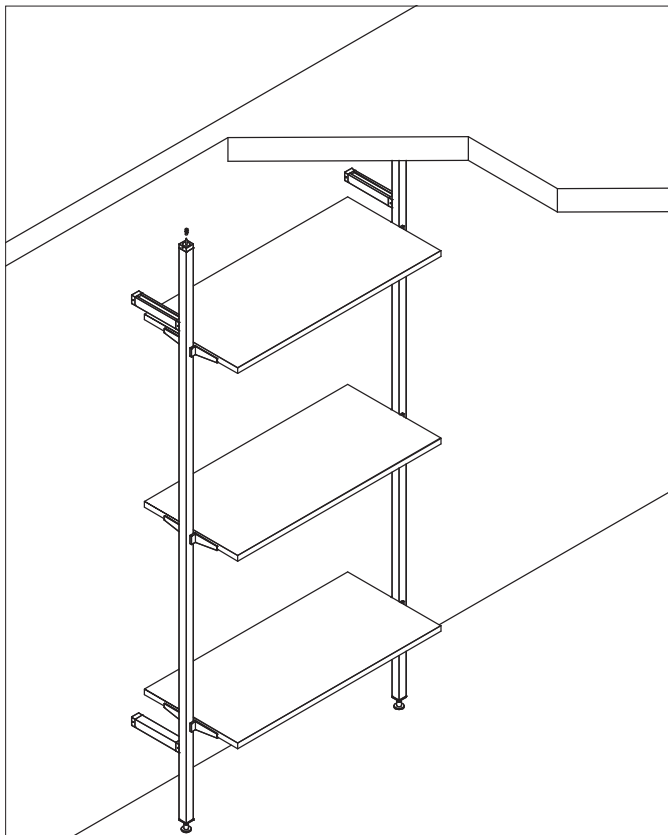

1_ Installation examples

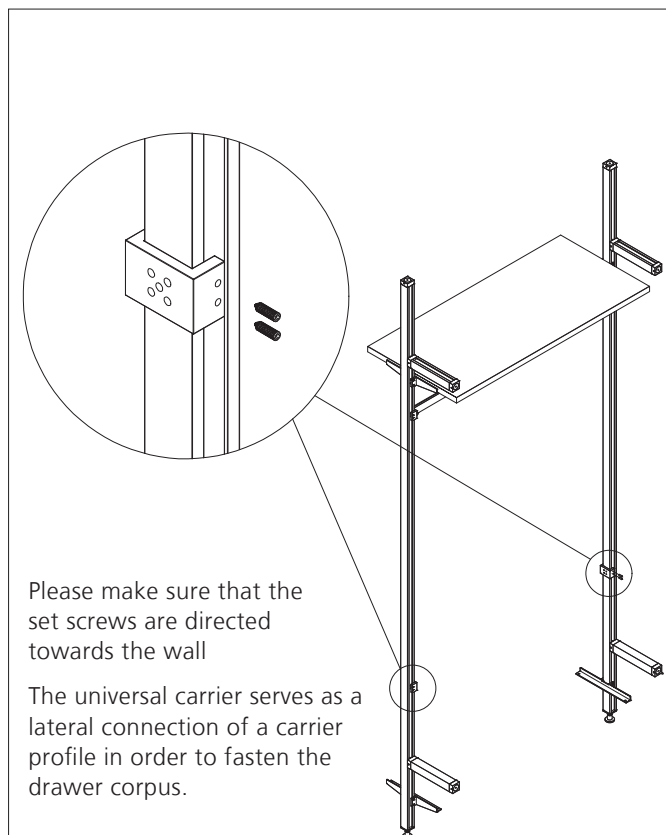

2_ Mount the universal carrier

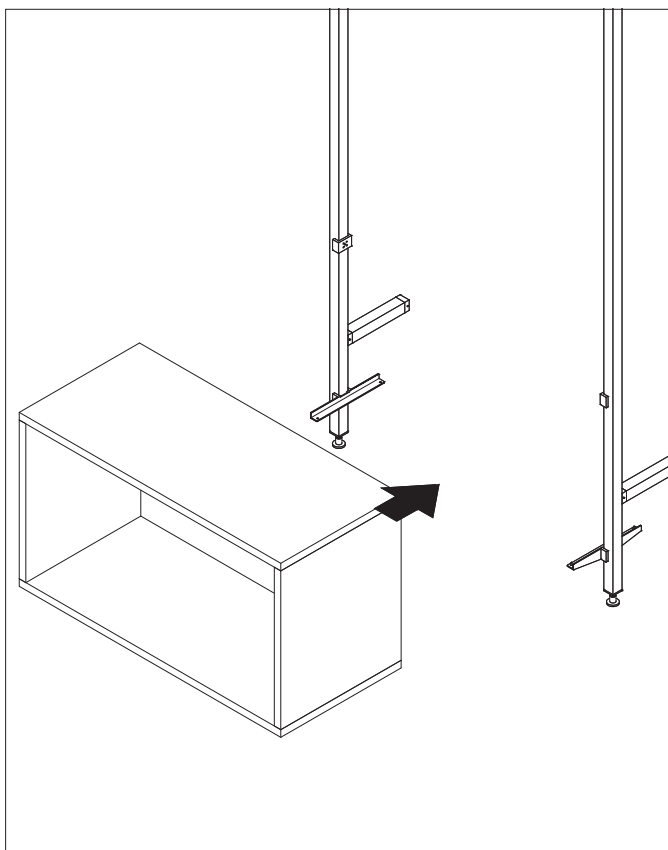

3_ Insert the drawer corpus

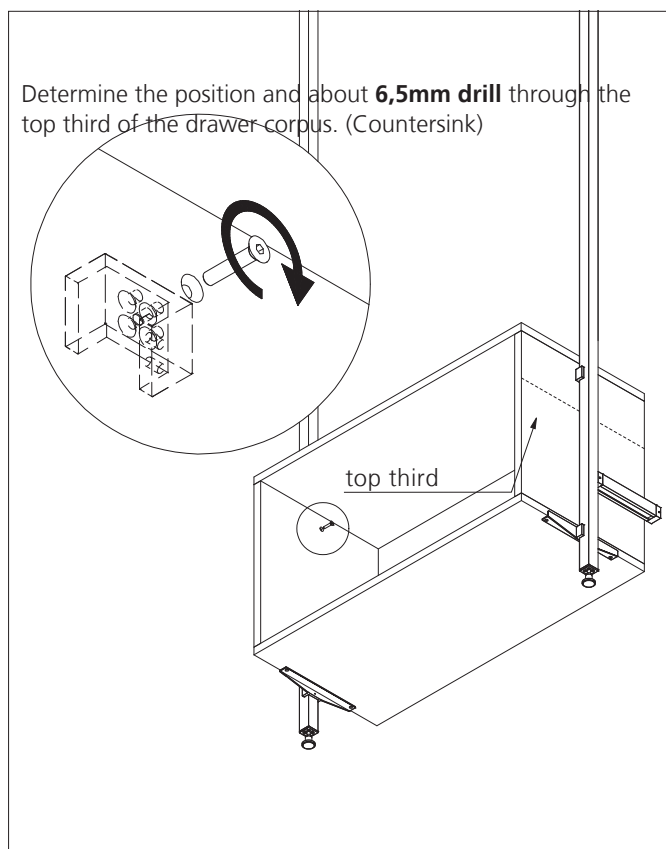

4_ Fixing with a countersink head screw **M6 x 30 mm**

INSTALLATION INSTRUCTIONS

DRAWER CORPUS

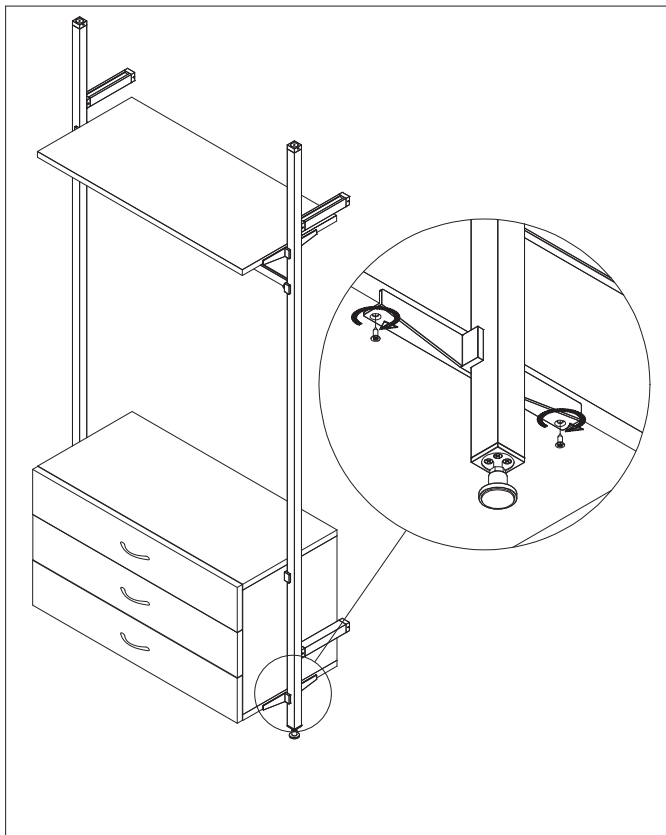

5_ Insert and fix the drawer

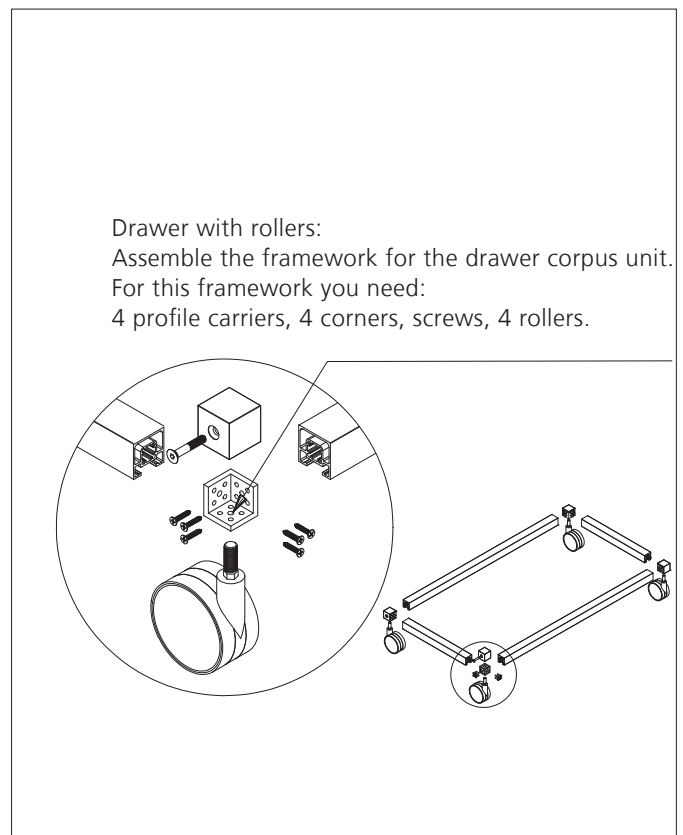

6_ Corner connection

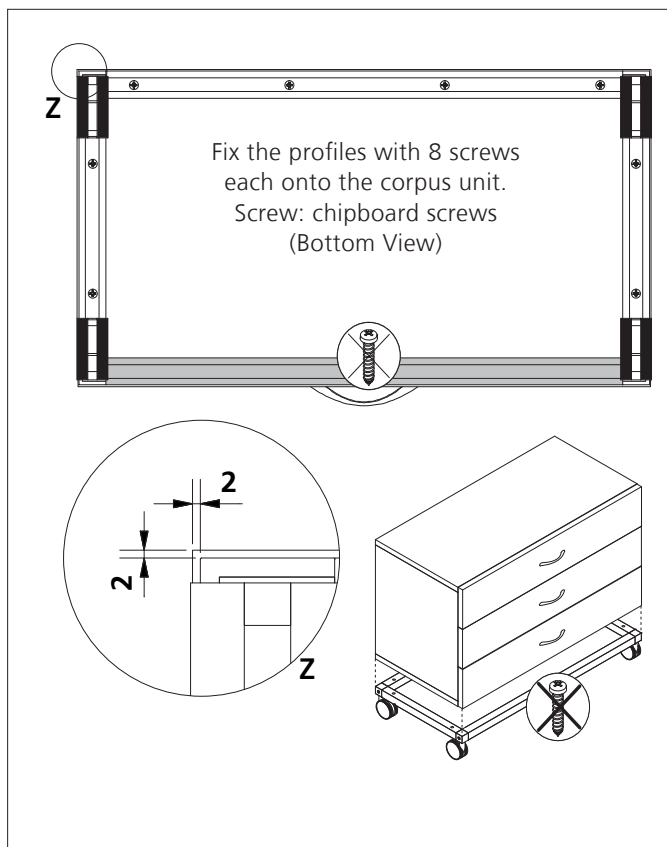

7_ Drawer with rollers

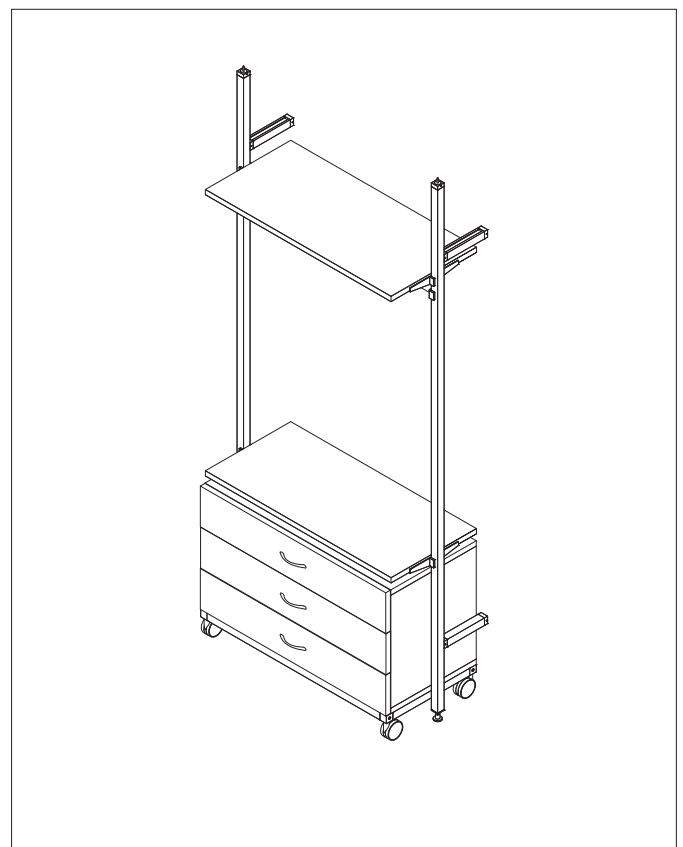

8_ Installation examples

INSTALLATION INSTRUCTIONS

CLOTHES ROD / PULL OUT TROUSER

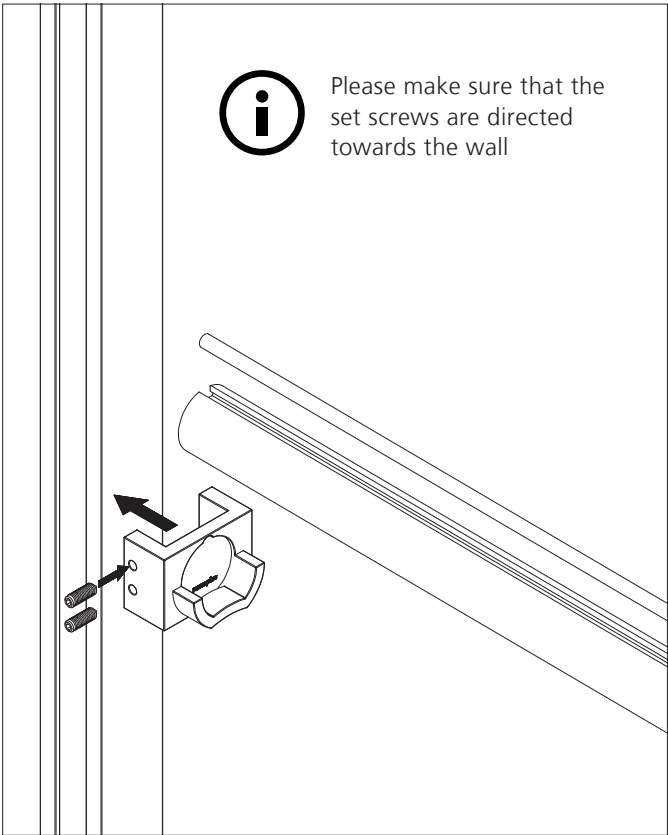

8_ Insert the Rod carrier round Uno

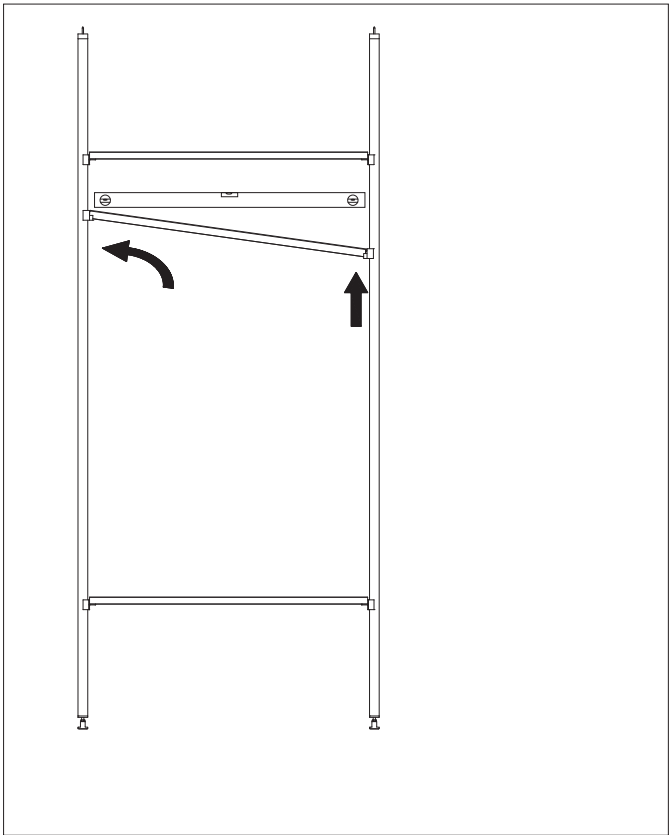

9_ Insert the clothes rod and level it

Wall mounting braket incl. accessories

quantity	description	
1	dowell	6 x 30 mm
1	chipbord screw	4,5 x 35 mm
2	chipbord screw	4,0 x 20 mm
1	bracket	

1_ Pull out trouser wiht front panel

ACCESSORIES

PULL OUT TROUSER WITH PANEL

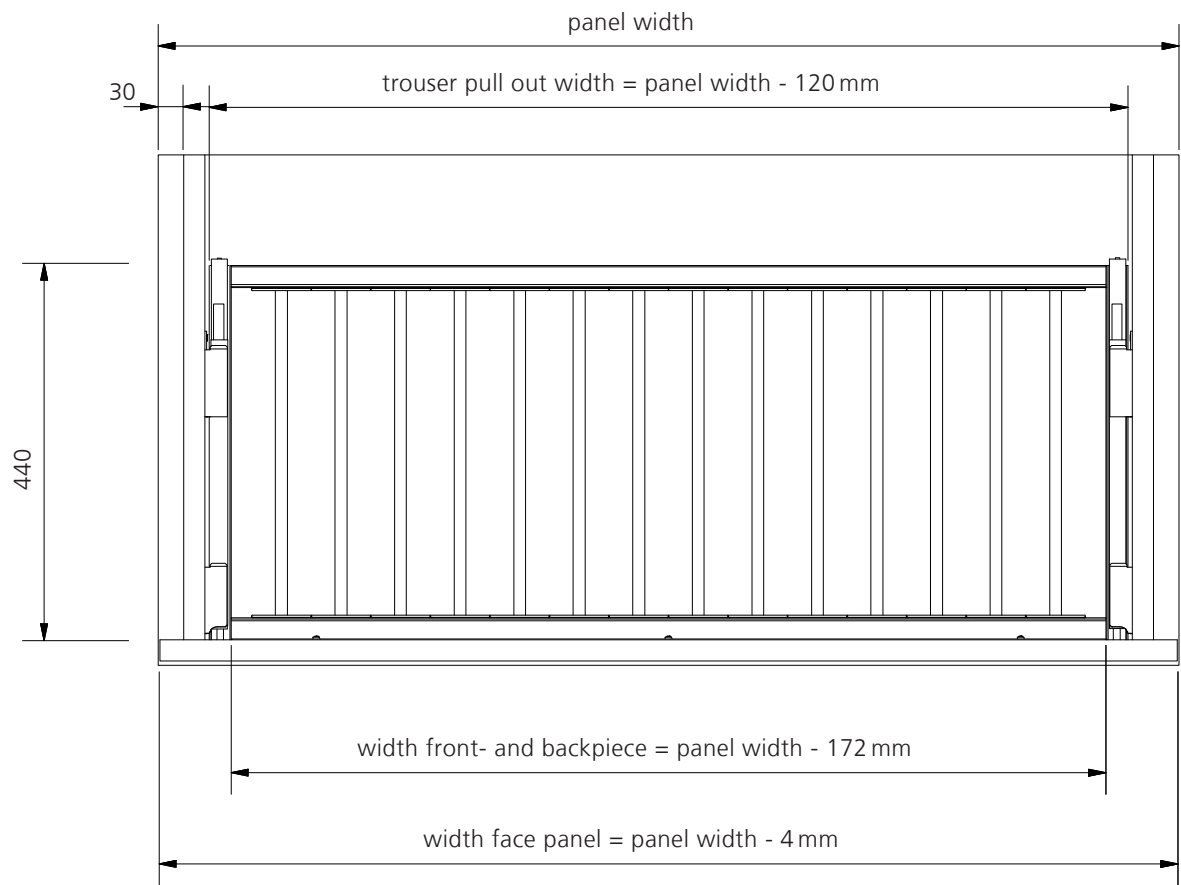

number of trousers = width front- and backpiece : 70
round results.

Maximum number of trousers per panel width:

up to	500 mm	=	4	trouser
	600	=	6	"
	700	=	7	"
	800	=	8	"
	900	=	9	"
	1000	=	10	"
	1100	=	11	"
	1200	=	12	"

ACCESSORIES



All accessories are to be mounted according to the described procedure. The set screws are directed towards the wall

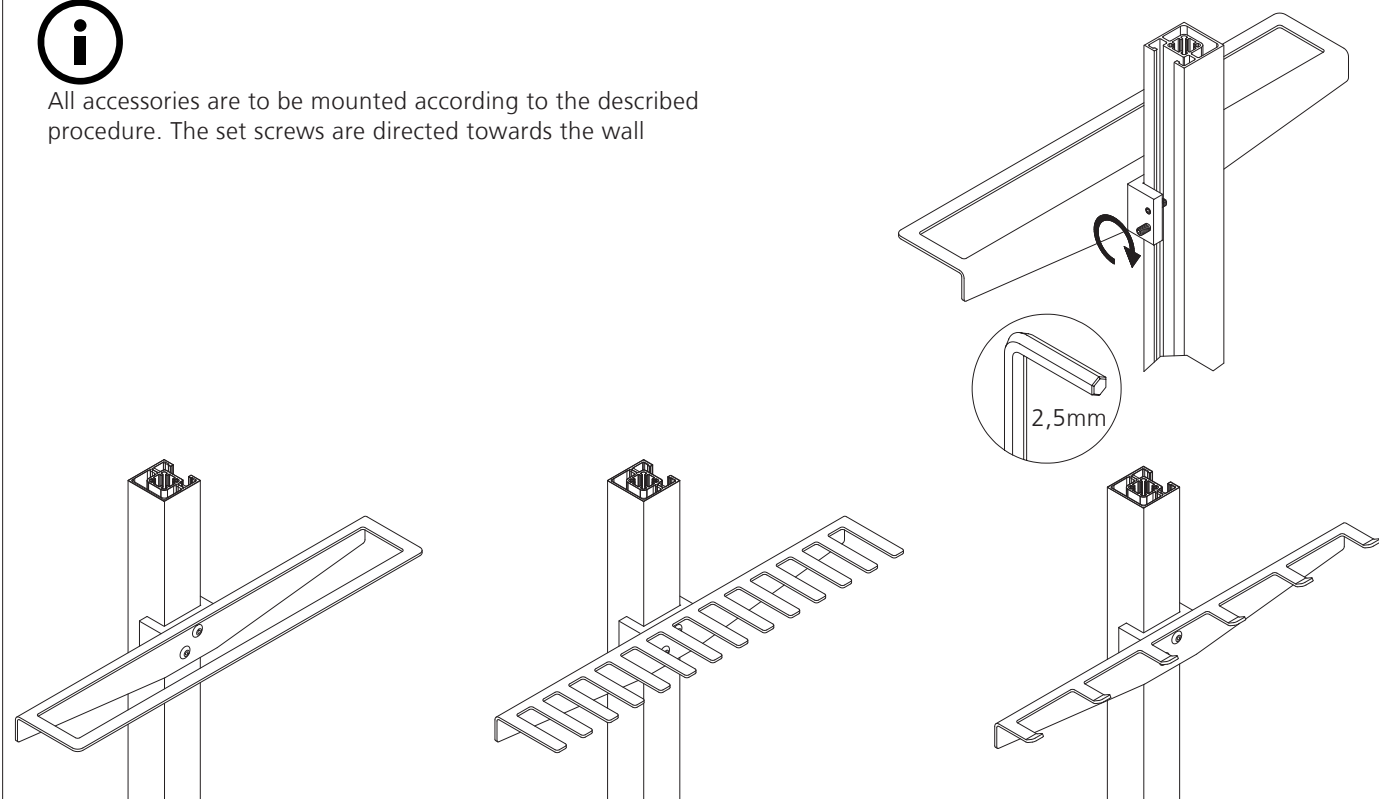

1_ Accessories: scarf holder, tie holder and hook rail (illustr, left side)

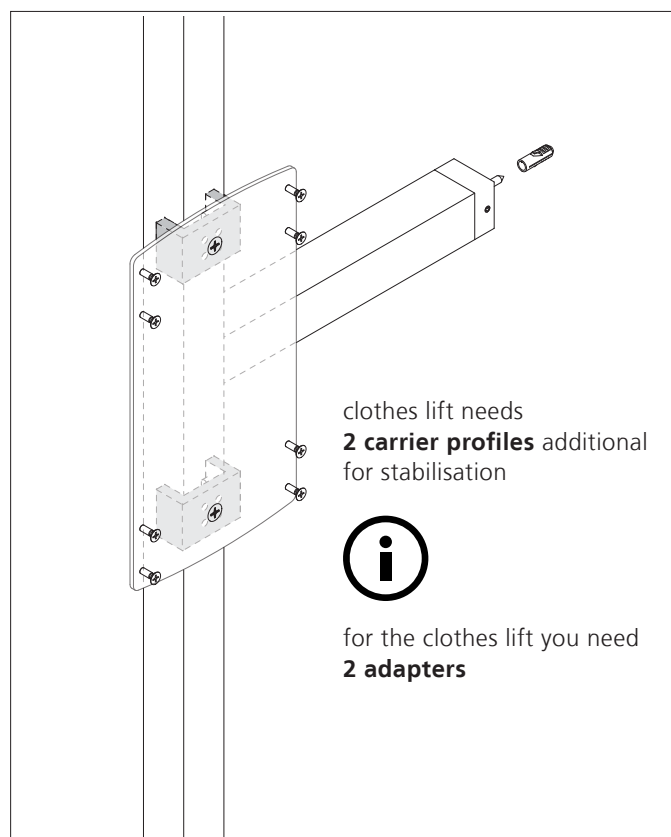

2_ Adapter for clothes lift

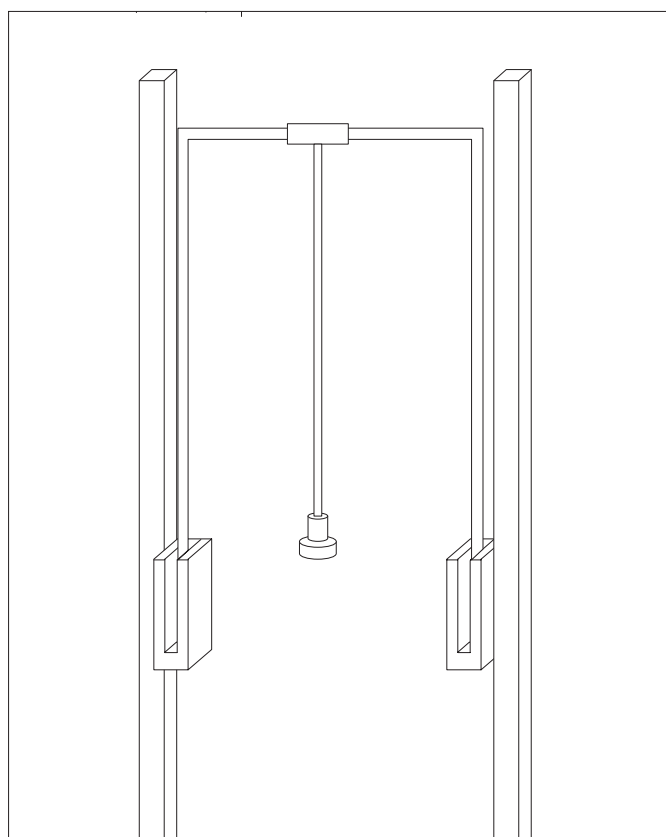

3_ Clothes lift

ACCESSORIES

UNO 45 ° WALL MOUNTING

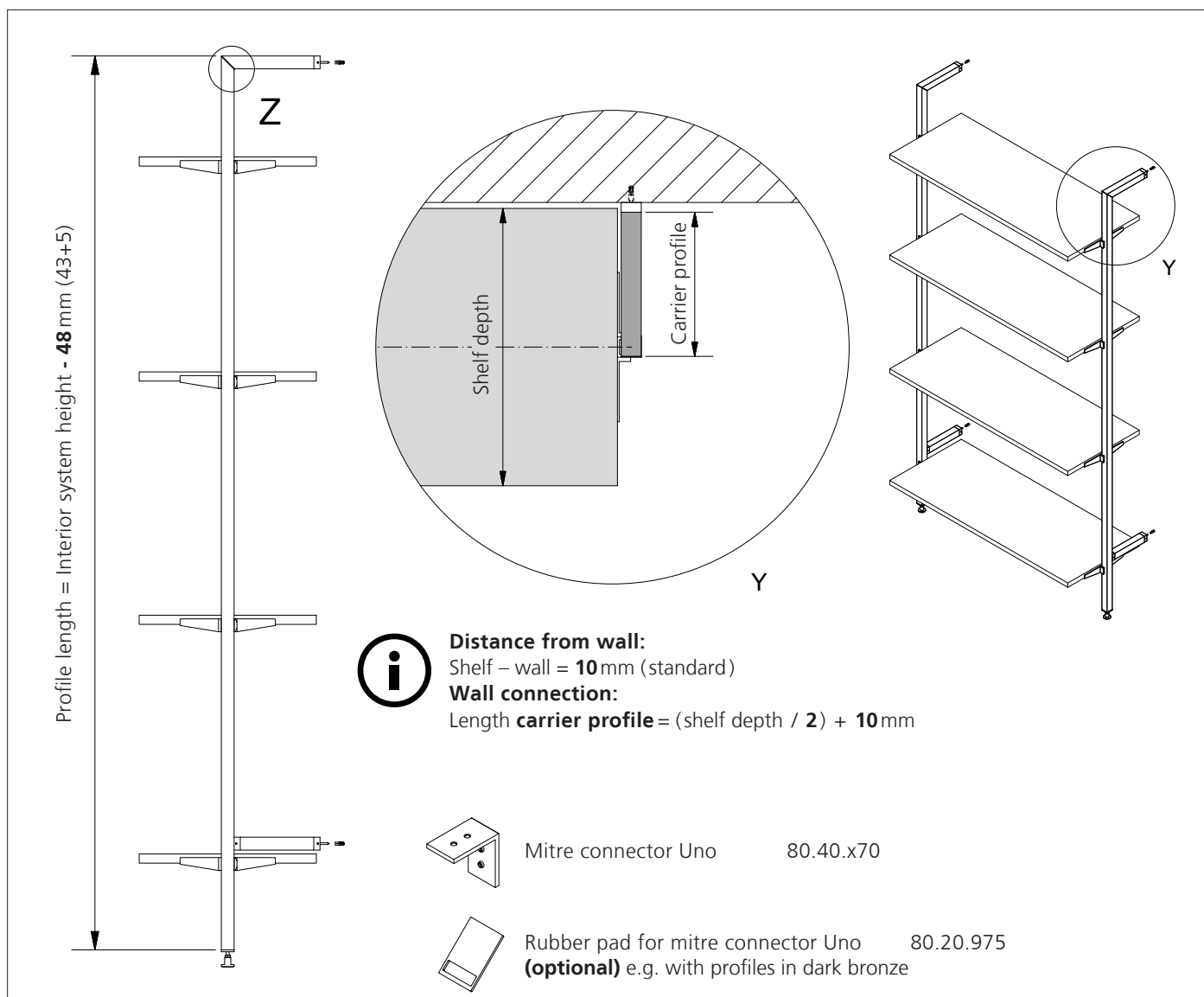

1_ Cutting dimensions for Uno 45 ° wall mounting

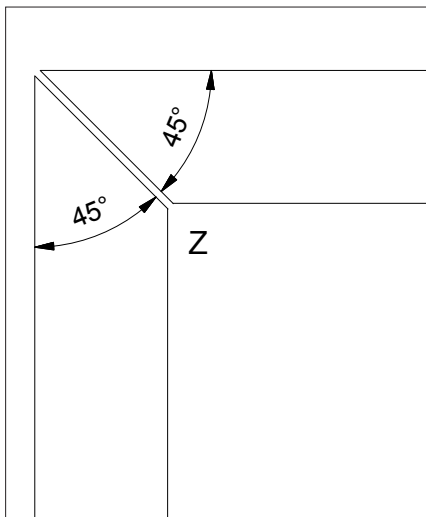

2_ Cut the profile to miter

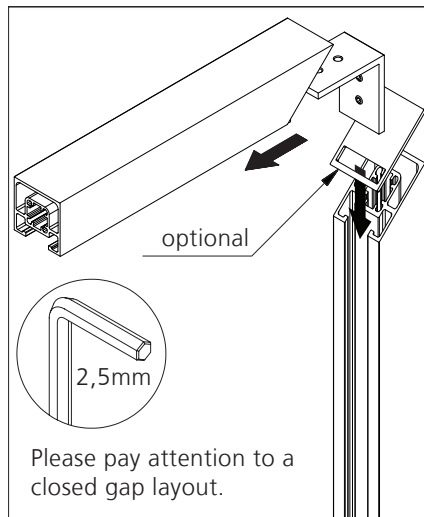

3_ Insert mitre connector Uno

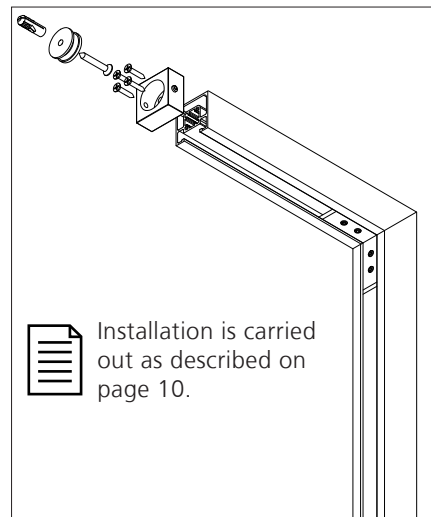

4_ Installation

ACCESSORIES

CLOTHES ROD CORNER SHELF UNO

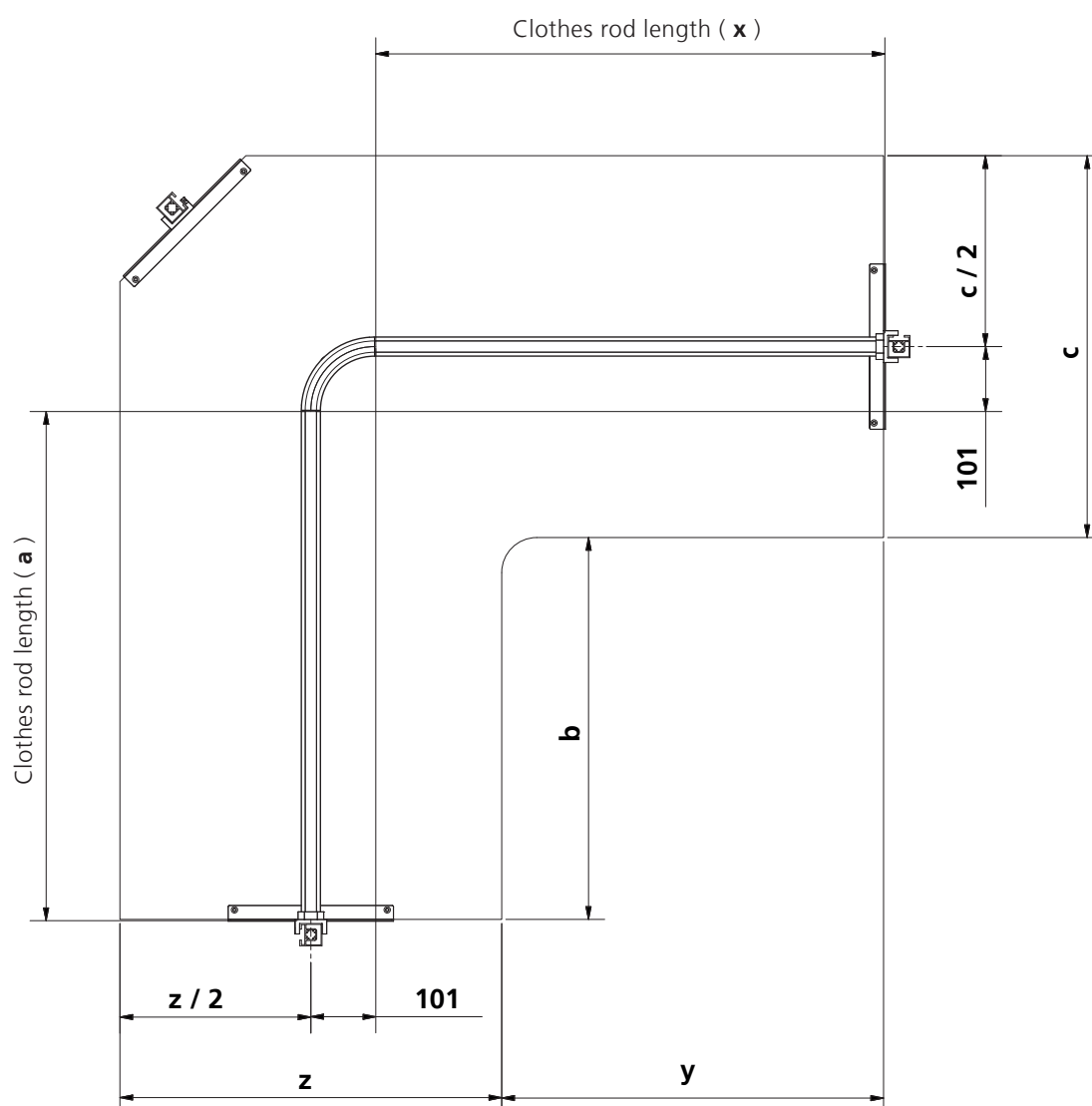

Calculating length clothes rail corner shelf Uno:

$$a = (c / 2) + b - 101$$

$$x = (z / 2) + y - 101$$

Calculating length Lisene for clothes rail:

Length Lisene = length clothes rail - 28 mm

Legend:

x / a = clothes rod length

y / b = shelf length - shelf depth

z / c = shelf depth

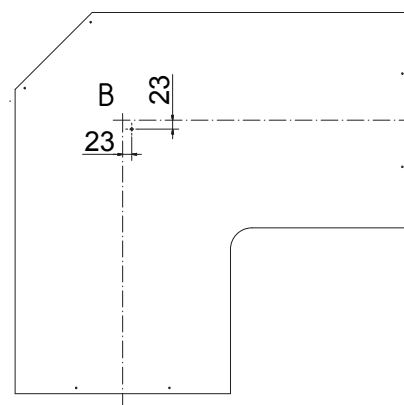

Hole B: Ø 7 mm (for the clothes rod corner connector)

ACCESSORIES

LED LIGHTING CLOTHES ROD UNO

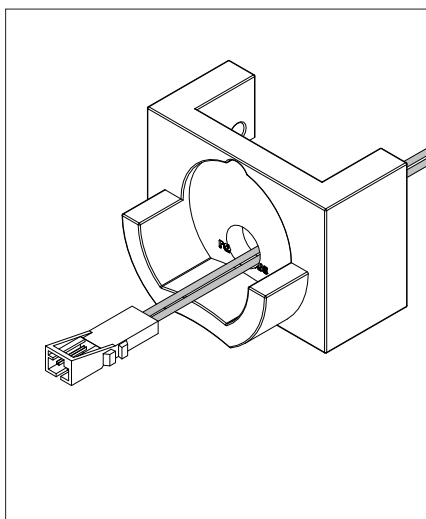

1_ Rod carrier LED, round

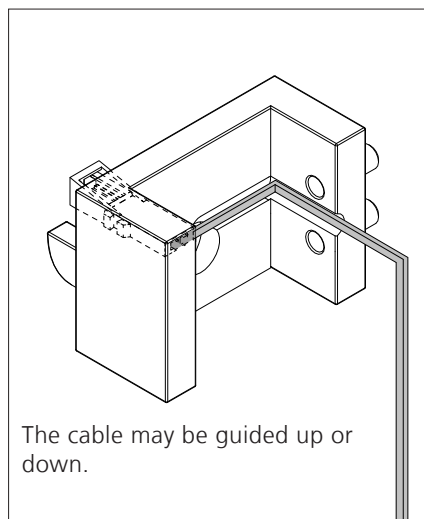

The cable may be guided up or down.

2_ Cable route

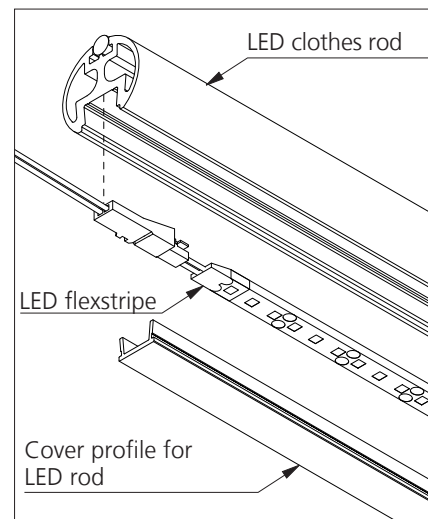

3_

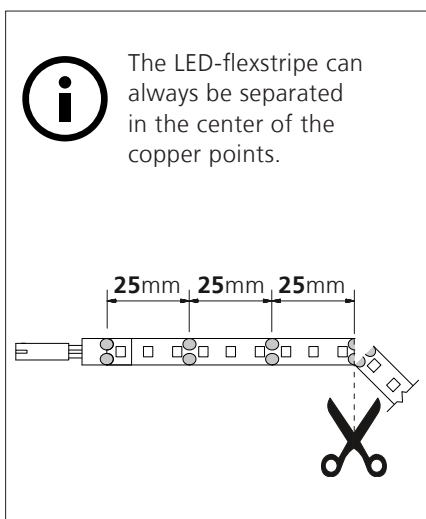

4_



The LED-flexstripe can always be separated in the center of the copper points.

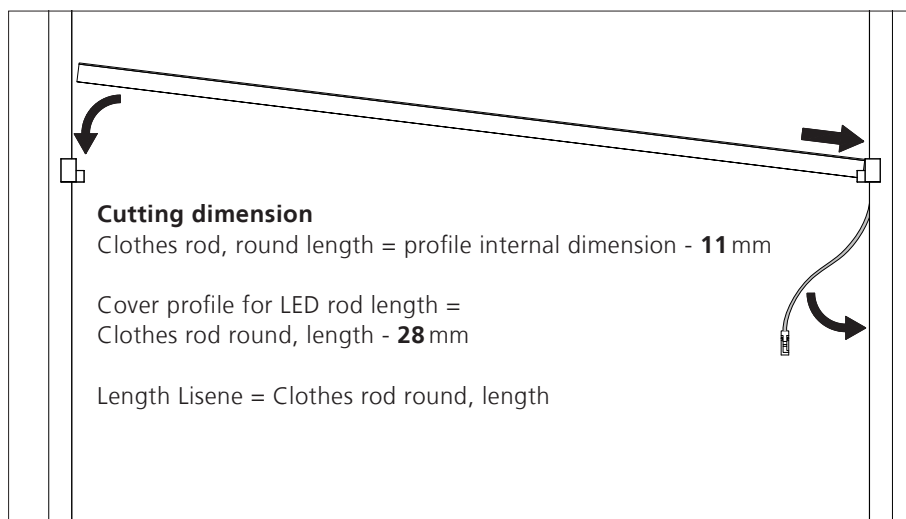

5_ Cutting dimension / inserting the Clothes rod

Cutting dimension

Clothes rod, round length = profile internal dimension - 11 mm

Cover profile for LED rod length = Clothes rod round, length - 28 mm

Length Lisene = Clothes rod round, length

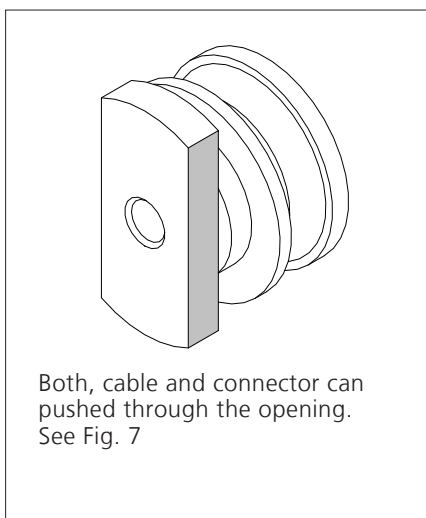

6_ Profile connector for LED stripe Uno

Both, cable and connector can be pushed through the opening. See Fig. 7

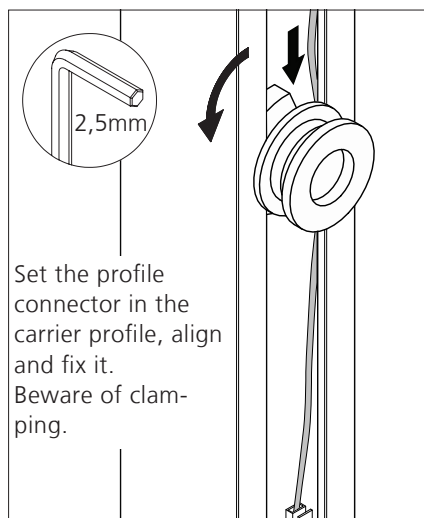

7_

Set the profile connector in the carrier profile, align and fix it. Beware of clamping.

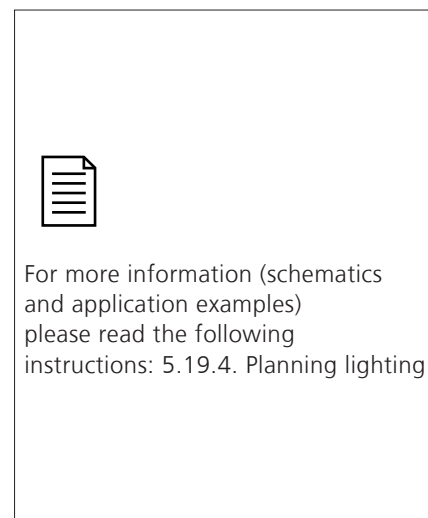

8_

For more information (schematics and application examples) please read the following instructions: 5.19.4. Planning lighting